

Remote Control Battery Replacement

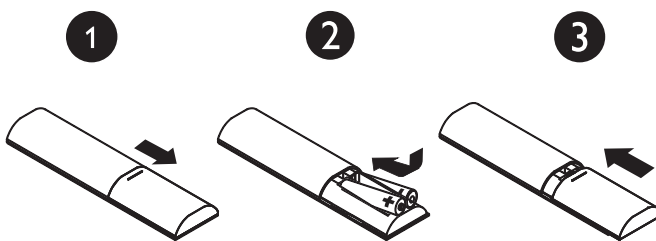

* For remote control, Do not mix old and new batteries and Do not mix alkaline, standard (carbon-zinc) or rechargeable (ni-cad, ni-mh, etc.) batteries.

Bluetooth® Connection

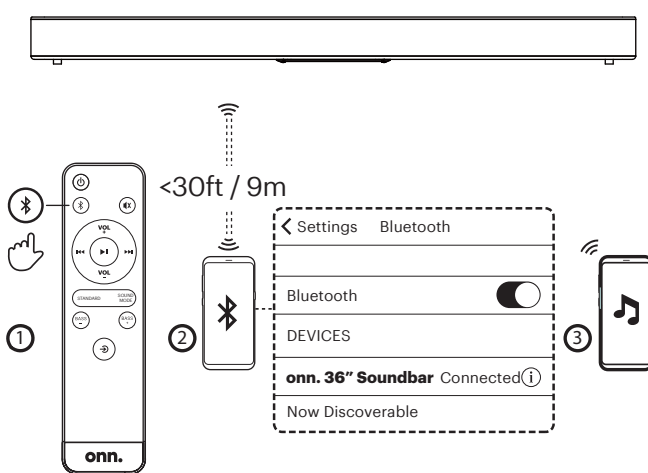

Hints and Tips

If you have a problem, check the following table for tips:

- When you switch to another channel, the Bluetooth is disconnected.
- When the LED indicator flashes slowly, the Bluetooth is paired and in disconnected status.
- When the LED indicator is solid, the Bluetooth is connected.
- The Soundbar will automatically switch to standby mode when no audio input is received for over 20 minutes, and wake up automatically with any source input again.

Problem	Solution
No power	<ul style="list-style-type: none"> • Make sure the main power cords are connected at both ends. • Make sure that the <i>On</i> mode is selected.
Remote Not Working	<ul style="list-style-type: none"> • Move closer to the unit. • Point the remote directly at the unit's sensor. • Try new batteries in the remote control. • Remove anything blocking the unit's sensor.

If the unit doesn't function correctly, unplug it, wait 30 seconds, and plug it back in.

The Fine Print

1. Warning: Changes or modifications to this unit not expressly approved by the party responsible for compliance could void the user's authority to operate the equipment.

2. NOTE: This equipment has been tested and found to comply with the limits for a Class B digital device, pursuant to Part 15 of the FCC Rules. These limits are designed to provide reasonable protection against harmful interference in a residential installation. This equipment generates, uses and can radiate radio frequency energy and, if not installed and used in accordance with the instructions, may cause harmful interference to radio communications. However, there is no guarantee that interference will not occur in a particular installation. If this equipment does cause harmful interference to radio or television reception, which can be determined by turning the equipment off and on, the user is encouraged to try to correct the interference by one or more of the following measures:

- Reorient or relocate the receiving antenna.
- Increase the separation between the equipment and receiver.
- Connect the equipment into an outlet on a circuit different from that to which the receiver is connected.
- Consult the dealer or an experienced radio/TV technician for help.

3. RF Exposure Statement
To maintain compliance with FCC's RF Exposure guidelines, This equipment should be installed and operated with minimum distance between 20cm the radiator your body: Use only the supplied antenna.

Need help? We're here for you every day 7 a.m. - 9 p.m. CST. 1-888-516-2630 Give us a call!

We'd love to hear from you. Scan with your Walmart app and let us know what you think.



onn.™

36" 2.1 Soundbar Quick Start Guide

What's in the Box?

Check to make sure you have everything below.

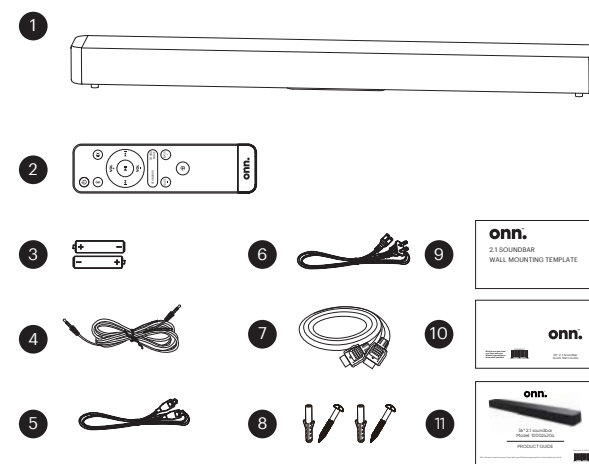

1. Soundbar
2. Remote control
3. AAA batteries
4. 3.5 mm AUX cable
5. Optical cable
6. Power cable
7. HDMI cable
8. Wall mounting kit
9. Wall mounting template
10. Quick Start Guide
11. Product Guide

Get to Know Your 36" 2.1 Soundbar

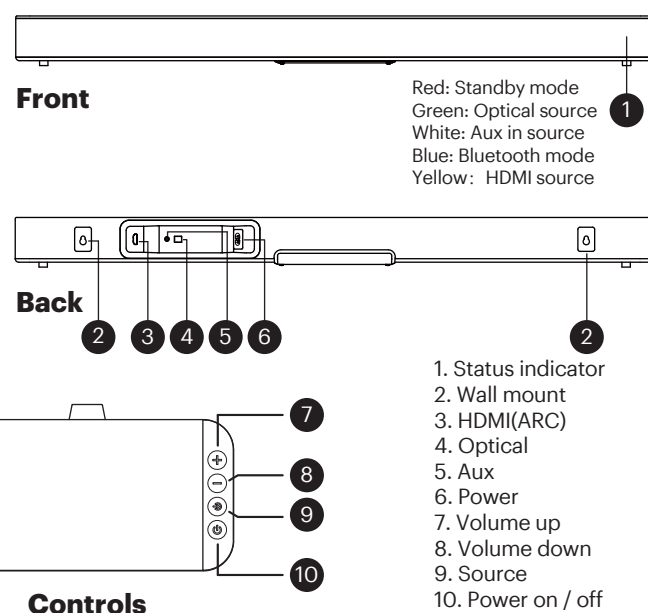

Get to Know Your Remote Control

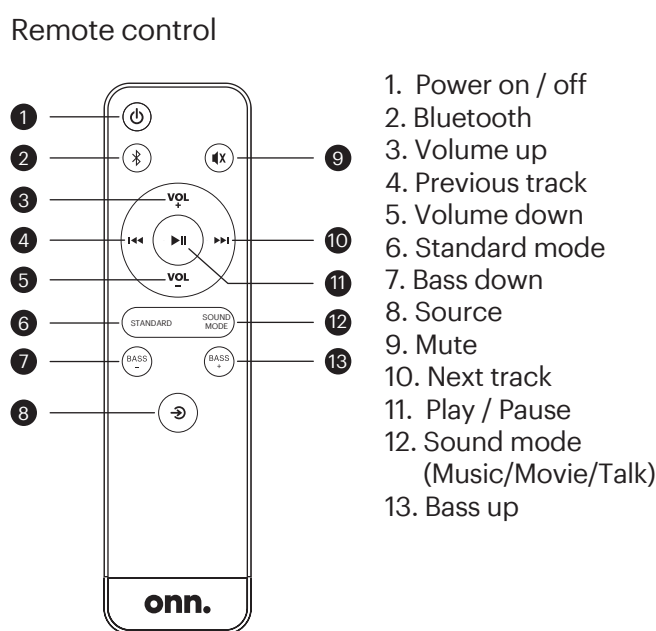

Let's Get Started!

Here's what you'll need to get set up:

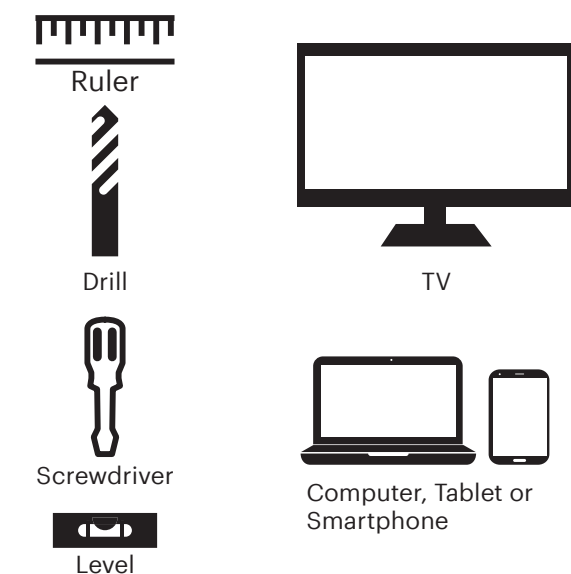

HDMI Connection

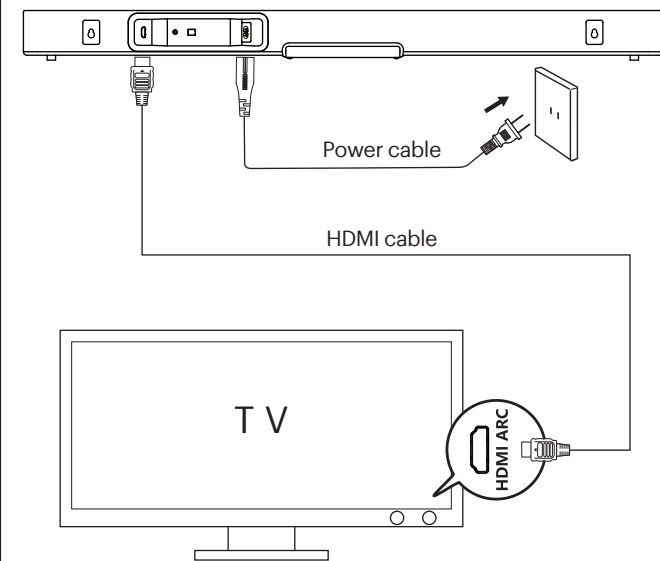

Tips of HDMI Connection

- To enjoy **Dolby** Audio content, your TV must support the HDMI-CEC and Audio Return Channel (ARC) function. Enable CEC and ARC functions on your TV.
 - The setting method of CEC and ARC may differ by TV manufacturer. See your TV's user manual for more information.
 - If you want to use the volume buttons on the TV remote control to control the soundbar, enable System Audio Control from the CEC menu.
 - CEC Function naming may differ by TV manufacturer. See your TV's user manual for more information.
 - Only HDMI 1.4 compatible cables can support the ARC function.
- * If your TV without HDMI ARC jack, you can also connect your TV with soundbar by other connections (Optical, Bluetooth or Aux in).
* For other connections, please refer to Product Guide.