



Boeing Black Quick Start Guide

Type ID: BLK1

© Copyright 2013 The Boeing Company. All rights reserved.

The information contained herein is subject to change without notice. Boeing retains ownership of and all other rights to the material expressed in this document, including without limitation, the trademark Boeing Black. Any reproduction of the content of this document without prior written permission from Boeing is prohibited. Device names, logos, brands and other trademarks featured or referred to within this document are the property of their respective owners.

DISCLAIMER AND RELEASE: UPON USING OR RELYING UPON THE BOEING BLACK DEVICE, USER HEREBY ACKNOWLEDGES AND AGREES THAT THIS GUIDE DOES NOT CONSTITUTE OR CONTAIN ANY WARRANTIES, WHETHER EXPRESS OR IMPLIED, WHATSOEVER WITH RESPECT TO THE DEVICE, OR YOUR USE OF THE DEVICE, ARISING BY LAW OR OTHERWISE. BOEING MAKES NO EXPRESS OR IMPLIED WARRANTY OF ANY KIND WITH RESPECT TO THE DEVICE OR THIS USER GUIDE, INCLUDING WITHOUT LIMITATION TO THE MERCHANTABILITY OF THE DEVICE OR ITS FITNESS FOR ANY PARTICULAR PURPOSE OR USE; THE DESIGN, CONDITION OR QUALITY OF THE DEVICE; THE PERFORMANCE OF THE DEVICE; THE WORKMANSHIP OF THE DEVICE OR THE COMPONENTS CONTAINED THEREIN; OR COMPLIANCE OF THE DEVICE WITH THE REQUIREMENTS OF ANY LAW, RULE, SPECIFICATION OR CONTRACT PERTAINING THERETO. BOEING SHALL HAVE NO OBLIGATION OR LIABILITY, WHETHER ARISING IN CONTRACT (INCLUDING WARRANTY), TORT WHETHER OR NOT ARISING FROM THE NEGLIGENCE OF BOEING, OR OTHERWISE, FOR INJURY, DEATH, OR LOSS OF DATA, USE, REVENUE OR PROFIT, OR FOR ANY OTHER DAMAGES, INCLUDING WITHOUT LIMITATION, INDIRECT, INCIDENTAL, PUNITIVE, SPECIAL, OR CONSEQUENTIAL DAMAGES, WITH RESPECT TO ANY INFORMATION, REPRESENTATION, ERRORS OR OMISSIONS CONTAINED HEREIN. UPON USING OR RELYING UPON THE BOEING BLACK DEVICE, USER HEREBY WAIVES, RELEASES, AND RENOUNCES, ANY DAMAGES, WARRANTIES, OBLIGATIONS AND LIABILITIES OF BOEING AND ITS SUPPLIERS, AND ANY OTHER ACTIONS, RIGHTS, CLAIMS AND REMEDIES OF USER AGAINST BOEING, EXPRESS OR IMPLIED, ARISING BY LAW OR OTHERWISE, RESULTING FROM THE PURCHASE OR USE OF THE DEVICE OR THIS USER GUIDE, INCLUDING WITHOUT LIMITATION: A) ANY IMPLIED WARRANTY

OF MERCHANTABILITY OR FITNESS; B) ANY IMPLIED WARRANTY ARISING FROM COURSE OF PERFORMANCE, COURSE OF DEALING OR USAGE OF TRADE; C) ANY IMPLIED WARRANTY OF SATISFACTORY QUALITY OR WORKMANLIKE EFFORT, DATA ACCURACY, SECURITY, SYSTEM INTEGRATION, TITLE RELIABILITY OR AVAILABILITY, LACK OF VIRUSES, TRADE USAGE OR COURSE OF DEALING OR TRADE, QUIET ENJOYMENT, NON-INFRINGEMENT OF THIRD PARTY RIGHTS OR OTHER VIOLATION OF RIGHTS; D) BREACH OF EXPRESS WARRANTY OR CONTRACT; E) ANY OBLIGATION, LIABILITY, RIGHT, CLAIM OR REMEDY IN TORT, WHETHER OR NOT RELATING TO DUTY TO WARN OR ARISING FROM THE NEGLIGENCE OF BOEING; AND F) ANY OBLIGATION, LIABILITY, RIGHT, CLAIM OR REMEDY FOR INJURY, DEATH, OR LOSS OF OR DAMAGE TO ANY DATA OR PROPERTY OF ANY KIND WHATSOEVER OF USER.

The Bluetooth® word mark and logos are registered trademarks owned by Bluetooth SIG, Inc. and any use of such marks is under license.

The Wi-Fi CERTIFIED Logo is a certification mark of the Wi-Fi Alliance. Other trademarks and trade names are those of their respective owners.

The Device includes certain Open Source Software (OSS) and other Third Party terms and conditions. It is User's responsibility to comply with these terms and license restrictions, which can be found by accessing the "Legal Information" directory on the Product. To access "Legal Information", go to "Settings", select "About Phone", then "Legal Information." Boeing has no responsibility whatsoever for any open source or other third party software, applications, components, features, or functions associated with the Device, whether provided by Boeing or added or accessed by User.

Contents

1	In the Box	1
1.1	Device at a Glance	2
2	Assembling	4
2.1	Charge the Battery	7
3	Getting Started	9
3.1	Turn Device On and Off . . .	9
3.2	Home Screen and Start Menu	10
4	FCC/IC Regulatory Notice	12
4.1	Modification Statement . . .	12
4.2	FCC Notice to Users	12
4.3	Industry Canada Notice to Users	14
4.4	Radiation Exposure Statement	15
4.5	Information for Consumers .	16
4.6	SAR Certification Information	17
4.7	CAN ICES-3 (B) / NMB-3 (B)	18

5	Important Health and Safety Precautions Information	19
5.1	Battery Use and Safety . . .	21
5.2	Operation Environment . . .	25
5.3	Driving	25
5.4	Vehicles Equipped with an Air Bag	26
6	Cautions Applicable to Operation in Certain Environments	28
6.1	Interference with Medical Equipment	28
6.2	Blasting Areas	29
6.3	Extreme Temperatures . . .	29
6.4	Potentially Explosive Atmospheres	30
6.5	Posted Facilities	31
6.6	Power Supply	31
6.7	Emergency Calls	32
7	Troubleshooting	33
7.1	The Device Does Not Respond	33
7.2	Factory Data Reset	34

1 In the Box

Your Device comes in a box with the following items:



micro USB cable



micro HDMI cable



battery



3.5mm headset



Boeing Black



AC charger

1.1 Device at a Glance

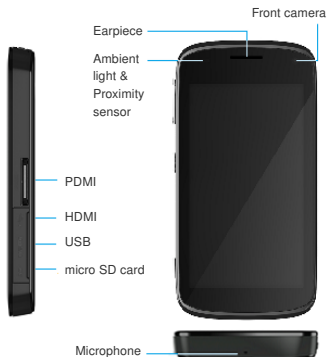

The microphone is located on the bottom of the Device, connector ports on the right hand side, and sensors in the front.



The main camera is located on the back of the Device. The volume key, User key and back cover release button are on the left hand side of the Device. The power key, notification LED, loudspeaker and 3.5mm headset connector are on the top of the Device.

2 Assembling

Insert the micro SIM card(s), battery, and micro SD card.

1. If the Device is already on, press and hold the Power key, then select **Power off** to turn it off.

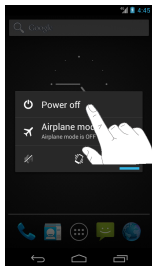

Select "Power off"

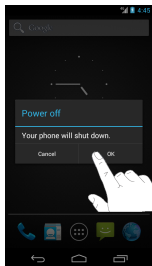

Select "OK"

2. Remove the back cover by pressing the release button, sliding the back cover up, and then lifting the cover off the Device.

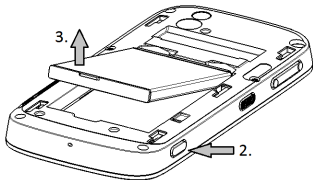

3. Remove the battery by lifting it up from the bottom.
4. Insert the micro SIM card into the 'micro SIM 1' slot.

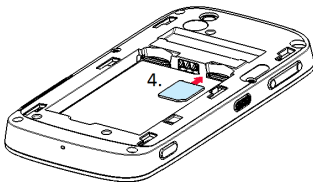

5. Insert the battery with the label facing out as shown in the diagram below.

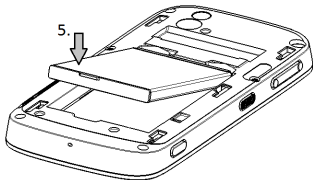

6. Open the connector door and insert the micro SD card.

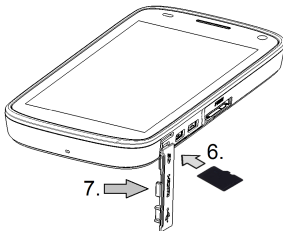

7. Close the connector door and replace the back cover.

2.1 Charge the Battery

New batteries are shipped partially charged. Before you start using your Device, it is recommended that you fully charge the battery.

To charge the battery, plug the provided charger into a standard AC outlet. Use only original Device batteries, chargers, and cords.

If the battery is completely discharged, you cannot turn on the Device. Allow a depleted battery to charge for a few minutes before you try to turn on the Device.

When the Device is turned off and being charged, the notification LED color is RED until the battery is completely charged. When the battery is completely charged, the indicator color will turn to GREEN. If the Device is turned on during charging, the charging icon is also shown on the screen at the title bar.

When the Device is ON and being charged, the color of the notification LED will indicate the charge status.

To save energy, unplug the charger from AC outlet when not in use. The charger does not have a power switch, so you must unplug the charger from the outlet when not in use to avoid wasting power.

NOTICE: When disposing of the battery, do so in accordance with local regulations.

3 Getting Started

3.1 Turn Device On and Off

Press the power key to turn on your Device. If this is the first time the Device has been powered ON, follow the on-screen instructions to personalize the Device.

To turn off the Device, press and hold the Power key and select **Power off** to turn it OFF.

Press and release the Power key to turn the display ON and OFF.

3.2 Home Screen and Start Menu

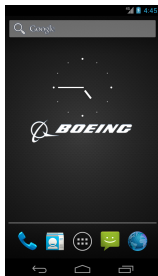

The Home screen is displayed when you turn on the Device. At the bottom of the screen, you will also find three Navigation keys.



Navigation keys

The icon on the left is the back key. By pressing the back key you can go back to the previous screen you were working with. The icon in the middle is the home key. You can access the home screen whenever you like by tapping the home key. The icon on the right is the recent applications key. Pressing this key will open the list of the applications you recently worked with.



Favorites bar

By default the home screen also contains shortcuts to your favorite applications. These are from left to right:

- Access the phone functionality
- Access your contacts
- Access all the applications installed on your Device
- Access the Messaging application
- Access the Internet Browser

4 FCC/IC Regulatory Notice

4.1 Modification Statement

The Boeing Company has not approved any changes or modifications to this device by the user. Any changes or modifications could void the user's authority to operate the equipment.

The Boeing Company n'approuve aucune modification apportée à l'appareil par l'utilisateur, quelle qu'en soit la nature. Tout changement ou modification peuvent annuler le droit d'utilisation de l'appareil par l'utilisateur.

4.2 FCC Notice to Users

This device complies with Part 15 of the FCC Rules. Operation is subject to the following two conditions: (1) this device may not cause interference, and (2) this device must accept any interference, including in-

interference that may cause undesired operation of the device.

This equipment has been tested and found to comply with the limits for a Class B digital Device, pursuant to part 15 of the FCC Rules. These limits are designed to provide reasonable protection against harmful interference in a residential installation. This equipment generates, uses, and can radiate radio frequency energy and, if not installed and used in accordance with the instructions, may cause harmful interference to radio communications.

However, there is no guarantee that interference will not occur in a particular installation. If this equipment does cause harmful interference to radio or television reception, which can be determined by turning the equipment off and on, the User is encouraged to try to correct the interference by one or more of the following measures:

- Reorient or relocate the receiving antenna,
- Increase the separation between the equipment and receiver,

- Connect the equipment into an outlet on a circuit different from that to which the receiver is connected,
- Consult the dealer or an experienced radio/TV technician for help.

4.3 Industry Canada Notice to Users

This device complies with Industry Canada license-exempt RSS standard(s). Operation is subject to the following two conditions: (1) This device may not cause interference and (2) This device must accept any interference, including interference that may cause undesired operation of the device.

Le présent appareil est conforme aux CNR d'Industrie Canada applicables aux appareils radio exempts de licence. L'exploitation est autorisée aux deux conditions suivantes : (1) l'appareil ne doit pas produire de brouillage, et (2) l'utilisateur de l'appareil doit accepter tout brouillage radioélectrique subi, même si le brouillage

est susceptible d'en compromettre le fonctionnement.

4.4 Radiation Exposure Statement

This Device complies with FCC/IC radiation exposure limits set forth for an uncontrolled environment and meets the FCC radio frequency (RF) Exposure Guidelines in Supplement C to OET65 and RSS-102 of the IC radio frequency (RF) Exposure rules. This transmitter must not be co-located or operating in conjunction with any other antenna or transmitter.

Le présent appareil est conforme à l'exposition aux radiations FCC / IC définies pour un environnement non contrôlé et répond aux directives d'exposition de la fréquence de la FCC radiofréquence (RF) dans le Supplément C à OET65 et RSS-102 de la fréquence radio (RF) IC règles d'exposition. L'émetteur ne doit pas être colocalisé ni fonctionner conjointe-

ment avec à autre antenne ou autre émetteur.

4.5 Information for Consumers

Notwithstanding the above, the U.S. Food and Drug Administration (FDA) has published information for consumers relating to Radio Frequency (RF) exposure from wireless phones, to address a concern that cell phone radiation causes cancer or other serious health hazards. This information can be accessed at [<http://www.fda.gov/Radiation-EmittingProducts/default.htm>]. In addition, if you are concerned about the exposure risk to radio frequency energy (RF) from cell phones, you can and should reduce the amount of time spent using your Device and/or use speaker mode or a headset to place more distance between your body and the Device.

4.6 Specific Absorption Rate (SAR) Certification Information

This Device has been shown to be capable of compliance for localized specific absorption rate (SAR) for uncontrolled environment/general population exposure limits specified in ANSI/IEEE Std. C95.1-1992 and had been tested in accordance with the measurement procedures specified in FCC/OET Bulletin 65 Supplement C (2001) and IEEE Std. 1528-2003 Ministry of Health (Canada), Safety Code 6. The standards include a substantial safety margin designed to assure the safety of all persons, regardless of age and health. The exposure standard for wireless mobile phones employs a unit of measurement known as the Specific Absorption Rate, or SAR. The SAR limit set by the FCC is 1.6W/kg. The standard incorporates a substantial margin of safety to give additional protection for the public and to account for any variations.

The highest SAR value reported under

these guidelines when use at the ear is 0.19 W/kg and when correctly worn on the body is 1.21 W/kg.

4.7 CAN ICES-3 (B) / NMB-3 (B)

This Class B digital apparatus complies with Canadian ICES-003.

Cet appareil numérique de classe B est conforme à la norme canadienne ICES-003.

5 Important Health and Safety Precautions Information

When using this Device, the safety precautions below must be taken to avoid possible injury, harm, liabilities or damages. Retain and follow all Device safety and operating instructions. Observe all warnings in the operating instructions on the Device.

DANGER: Only use the batteries, antennas, and chargers approved by The Boeing Company. The use of any other type may be dangerous.

DANGER: Allow only authorized personnel to service the Boeing Black and its accessories. Unauthorized service will invalidate any warranty, to the extent one is contained in your User agreement.

CAUTION: The material used in the display is glass. The display can break if the Boeing Black is dropped or if it receives significant impact. Please do not use the

Boeing Black if the screen is broken or cracked as this may cause an injury to you.

CAUTION: Any modification to the Boeing Black is prohibited and will void any warranty, to the extent one is contained in your User agreement. The opening of the unit and use of the components for purposes not otherwise authorized by this document, including any use in airplanes or any other aviation application, is prohibited and will void any warranty, to the extent one is contained in your User agreement.

CAUTION: Permanent hearing loss may occur if earphones or headphones are used at high volume for prolonged periods of time.

CAUTION: Do not allow children to play with your Boeing Black since it contains small parts that could become detached and create a choking hazard.

NOTE: When using the Boeing Black for prolonged periods of time, such as when you're talking on the phone, charging the battery or browsing the web, the Boeing

Black may become warm. Therefore in most cases this condition should not be interpreted as a problem with the Boeing Black.

NOTE: Always create a backup of data you want to keep (such as contacts and calendar notes) before sending the Boeing Black to a service facility.

5.1 Battery Use and Safety

You must handle and store batteries properly to avoid injury or damage.

Battery issues may arise from, among other things, improper handling of batteries and, particularly, from the continued use of damaged batteries.

Do not disassemble, crush, puncture, shred, or otherwise attempt to change the form of your battery. Do not put a high degree of pressure on the battery. This can cause leakage or an internal short circuit, resulting in overheating.

Do not let the Device or battery come in contact with liquids. Liquids can get into the Device's circuits, leading to corrosion. Even when the Device appears to be dry and appears to operate normally, the circuitry could slowly corrode and pose a safety hazard. If the Device and/or battery get wet, have them checked by your service Provider, or wireless carrier, even if they appear to be working properly.

Do not place the Device or your battery in or near a heat source. Excessive heating can damage the phone or the battery and could cause the phone or the battery to explode. Do not dry a wet or damp battery with an appliance or heat source such as a microwave oven, hair dryer, iron, or radiator. Avoid leaving your phone in your car in high temperatures.

Do not dispose of the Device or the battery in a fire. The phone or the battery may explode when overheated.

Do not handle a damaged or leaking battery. Do not let leaking battery fluid

come in contact with your eyes, skin or clothing.

Avoid dropping the Device. Dropping the Device or the battery, especially on a hard surface, can potentially cause damage to the Device and battery. If you suspect damage to the Device or battery, take it to a service center for inspection.

Never use any charger or battery that is damaged in any way.

Do not allow the battery to touch metal objects. Accidental short-circuiting can occur when a metallic object (coin, key, jewelry, clip, or pen) causes a direct connection between the + and - terminals of the battery (metal strips on the battery), for example when you carry a spare battery in a pocket or bag. Short-circuiting the terminals may damage the battery or the object causing the short-circuiting.

Important!: Use only provided batteries, and recharge your battery only with provided chargers which are specifically designed for your Device.

Warning!: Use of other batteries or chargers may present a risk of fire, explosion, leakage, or other hazard.

Do not use incompatible cell phone batteries and chargers. Some websites and second-hand dealers not associated with reputable manufacturers and carriers, might be selling incompatible or even counterfeit batteries and chargers. Consumers should purchase manufacturer or carrier-recommended products and accessories. If unsure about whether a replacement battery or charger is compatible, contact the manufacturer of the battery or charger.

Misuse or use of incompatible Devices, batteries, and charging devices could result in damage to the equipment and a possible risk of fire, explosion, or leakage, leading to serious injuries, damages to your Device, or other serious hazard.

5.2 Operation Environment

For body worn operation, this phone has been tested to meet RF exposure guidelines when used with an accessory that contains no metal and which positions the handset a minimum of 1.0 centimeters (3/8 inch) from the body. Use of other accessories may not ensure compliance with RF exposure guidelines.

This Device and its antenna must not be co-located or operated in conjunction with any other antenna or transmitter.

5.3 Driving

Check the laws and regulations on the use of mobile phones in the area where you drive. If you are going to use your Boeing Black while driving, please:

- Give full attention to driving.
- Use a handsfree solution, if available. The law in many jurisdictions requires a vehicle handsfree solution. Read the installation instruc-

tions carefully before installing a vehicle handsfree solution.

- Pull off the road and park before making or answering a call if driving conditions so require.
- RF energy may affect some electronic systems in motor vehicles such as car stereo, safety equipment, etc. In addition, some vehicle manufacturers do not allow use of mobile phones, unless the installation is supported by a handsfree kit with an external antenna, in their vehicles. Check with your vehicle manufacturer's representative to be sure that your mobile phone will not affect the electronic systems in your vehicle.

5.4 Vehicles Equipped with an Air Bag

An air bag inflates with great force. Do not place objects, including either installed or portable wireless equipment, in the area over the air bag or in the air bag deploy-

ment area. If in-vehicle wireless equipment is improperly installed and the air bag inflates, serious injury could result.

6 Cautions Applicable to Operation in Certain Environments

6.1 Interference with Medical Equipment

Most modern electronic equipment, for example equipment in hospitals and cars, is shielded from RF energy. However, certain electronic equipment is not, therefore: Do not use Boeing Black near medical equipment without requesting permission.

The Boeing Black may affect the operation of some implanted cardiac pacemakers and other medically implanted equipment. Pacemaker patients should be aware that the use of the Boeing Black very close to a pacemaker might cause the Device to malfunction. Avoid placing the Boeing Black over the pacemaker, i.e. in your breast pocket. When using the Boeing Black, place it at your ear opposite the pacemaker. If a minimum distance of 6 inches (15 cm) is kept between the Boeing Black

and the pacemaker, the risk of interference is limited. If you have any reason to suspect that interference is taking place, immediately turn off the Boeing Black. Contact your cardiologist for more information.

Some hearing aids might be disturbed by the Boeing Black. In the event of such disturbance, you may want to consult your service provider, or call the customer service line to discuss alternatives.

6.2 Blasting Areas

Turn off your Boeing Black when in a blasting area or in areas posted “turn off two-way radio” to avoid interfering with blasting operations. Construction crews often use remote control RF Devices to set off explosives.

6.3 Extreme Temperatures

The Boeing Black is designed and tested for use in temperatures between -10°C and 55°C (14°F and 131°F). Exposure of

Boeing Black to temperatures exceeding this range can result in malfunction or damage of the device.

6.4 Potentially Explosive Atmospheres

Turn off your Boeing Black when in any area with a potentially explosive atmosphere. It is rare, but your Boeing Black or its accessories could generate sparks. Sparks in such areas could cause an explosion or fire resulting in bodily injury or even death. Areas with a potentially explosive atmosphere are often, but not always, clearly marked. They include fuelling areas, such as gas stations, below deck on boats, fuel or chemical transfer or storage facilities, and areas where the air contains chemicals or particles, such as grain, dust, or metal powders. Do not transport or store flammable gas, liquid, or explosives in the compartment of your vehicle, which contains your Boeing Black and accessories.

6.5 Posted Facilities

Turn your Boeing Black OFF in any facility where posted notices so require. Turn off your Boeing Black whenever directed by warning signs or instructions.

6.6 Power Supply

Connect AC Power supply only to designated power sources as marked on the product

- To reduce risk of damage to the electric cord, remove it from the outlet by holding onto the AC adapter rather than the cord
- Make sure the cord is positioned so that it will not be stepped on, tripped over, or otherwise subjected to damage or stress
- To reduce risk of electric shock, unplug the unit from any power source before attempting to clean it

The charger must not be used outdoors or in damp areas.

6.7 Emergency Calls

The Boeing Black, like any mobile phone, operates using radio signals, cellular, and landline networks as well as User-programmed functions, which cannot guarantee connection under all conditions. Therefore you should never rely solely upon any mobile phone for essential communications (e.g. medical emergencies or power outages). Remember, in order to make or receive calls the Boeing Black must be switched on and in a service area with adequate signal strength. Emergency calls may not be possible on all cellular phone networks, or when certain network services and/or Boeing Black features are in use. Check with your local service provider. Some of the services mentioned in this manual are not supported by all networks or by all service agreements. This also applies to the emergency number 911 and the International Emergency Number 112. Contact your network operator or service provider if you are in doubt whether you can use a particular service or not.

7 Troubleshooting

7.1 The Device Does Not Respond

The Device may be low on power. For more information on charging the Device battery, see “Charge the Battery” section.

- If the battery is charged, turn the Device off.

Press and hold the power key to turn it off. When asked whether you want to turn the Device off, tap Yes.

Turn the Device on by pressing and releasing the power key.

- Even though your Device is state of the art, in certain circumstances it may be possible that the Device is in such a state that it is necessary to perform a hardware reset of the Device.

To generate a hardware reset for the Device, press and hold down the power key for more than 10 seconds. This will force the system to turn off. Release the Power key and turn the Device on by pressing the power key.

If your Device still does not respond, remove and reinsert the battery, turn the Device on by pressing the power key. For more information, see the chapter “Assembling”.

7.2 Factory Data Reset

To factory reset the data in the Device:

- From Home or All Apps screen, touch the Settings icon



- Under Personal, touch “Backup & reset”
- Finally, select “Factory data reset”

When this option has been selected, the Device will erase all personal data, accounts, settings, downloaded applications, music, photos, videos, and other files from internal storage.

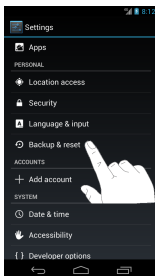

Select "Backup & reset"

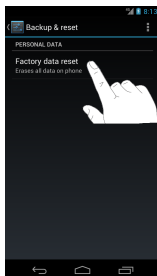

Select "Factory data reset"

After resetting your phone, you will need to re-perform the first time set up of your phone.