

User Guide

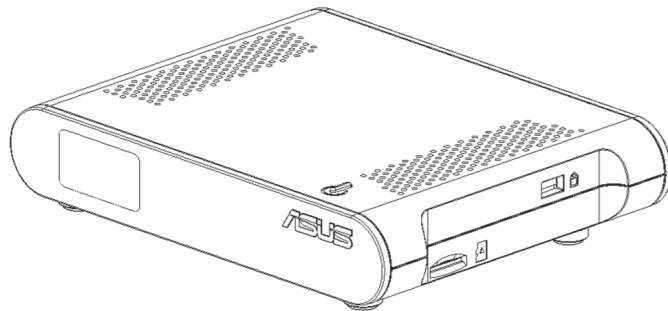

Copyright © 2015 ASUSTeK COMPUTER INC. All Rights Reserved.

No part of this manual, including the products and software described in it, may be reproduced, transmitted, transcribed, stored in a retrieval system, or translated into any language in any form or by any means, except documentation kept by the purchaser for backup purposes, without the express written permission of ASUSTeK COMPUTER INC. ("ASUS").

Product warranty or service will not be extended if: (1) the product is repaired, modified or altered, unless such repair, modification of alteration is authorized in writing by ASUS; or (2) the serial number of the product is defaced or missing.

ASUS PROVIDES THIS MANUAL "AS IS" WITHOUT WARRANTY OF ANY KIND, EITHER EXPRESS OR IMPLIED, INCLUDING BUT NOT LIMITED TO THE IMPLIED WARRANTIES OR CONDITIONS OF MERCHANTABILITY OR FITNESS FOR A PARTICULAR PURPOSE. IN NO EVENT SHALL ASUS, ITS DIRECTORS, OFFICERS, EMPLOYEES OR AGENTS BE LIABLE FOR ANY INDIRECT, SPECIAL, INCIDENTAL, OR CONSEQUENTIAL DAMAGES (INCLUDING DAMAGES FOR LOSS OF PROFITS, LOSS OF BUSINESS, LOSS OF USE OR DATA, INTERRUPTION OF BUSINESS AND THE LIKE), EVEN IF ASUS HAS BEEN ADVISED OF THE POSSIBILITY OF SUCH DAMAGES ARISING FROM ANY DEFECT OR ERROR IN THIS MANUAL OR PRODUCT.

SPECIFICATIONS AND INFORMATION CONTAINED IN THIS MANUAL ARE FURNISHED FOR INFORMATIONAL USE ONLY, AND ARE SUBJECT TO CHANGE AT ANY TIME WITHOUT NOTICE, AND SHOULD NOT BE CONSTRUED AS A COMMITMENT BY ASUS. ASUS ASSUMES NO RESPONSIBILITY OR LIABILITY FOR ANY ERRORS OR INACCURACIES THAT MAY APPEAR IN THIS MANUAL, INCLUDING THE PRODUCTS AND SOFTWARE DESCRIBED IN IT.

Products and corporate names appearing in this manual may or may not be registered trademarks or copyrights of their respective companies, and are used only for identification or explanation and to the owners' benefit, without intent to infringe.

Safety Information

- Before setting up the client box, carefully read all the documentation that came with the package.
- To prevent fire or shock hazard, never expose the monitor to rain or moisture.
- Never try to open the box cabinet. The dangerous high voltages inside the box may result in serious physical injury.
- If the power supply is broken, do not try to fix it by yourself. Contact a qualified service technician or your retailer.
- Before using the product, make sure all cables are correctly connected and the power cables are not damaged. If you detect any damage, contact your dealer immediately.
- Slots and openings on the back or top of the cabinet are provided for ventilation. Do not block these slots. Never place this product near or over a radiator or heat source unless proper ventilation is provided.
- The client box should be operated only from the type of power source indicated on the label. If you are not sure of the type of power supply to your home, consult your dealer or local power company.
- Use the appropriate power plug which complies with your local power standard.
- Do not overload power strips and extension cords. Overloading can result in fire or electric shock.
- Avoid dust, humidity, and temperature extremes. Do not place the box in any area where it may become wet. Place the box on a stable surface.
- Unplug the unit during a lightning storm or if it will not be used for a long period of time. This will protect the box from damage due to power surges.
- Never push objects or spill liquid of any kind into the slots on the box cabinet.
- The socket-outlet shall be installed near the equipment and shall be easily accessible.
- If you encounter technical problems with the client box, contact a qualified service technician or your retailer.

Client Box introduction

Front of the box

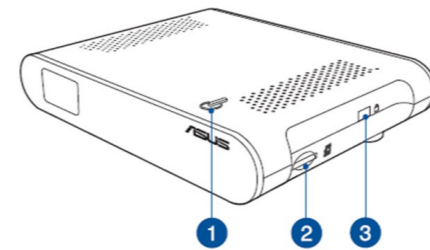

Side of the box

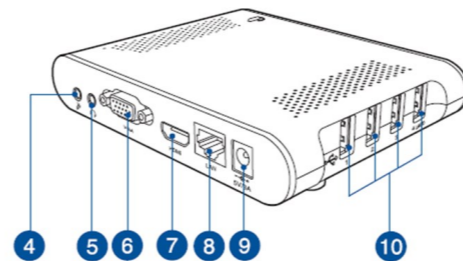

1 Power key	6 VGA
2 Micro SD slot	7 HDMI
3 Kensington lock	8 RJ45
4 Microphone input	9 Power-in jack
5 Earphone-out	10 USB connector

Client Box introduction

Rear of the box

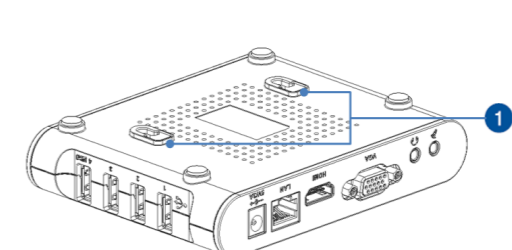

Wall mount bracket (Optional)

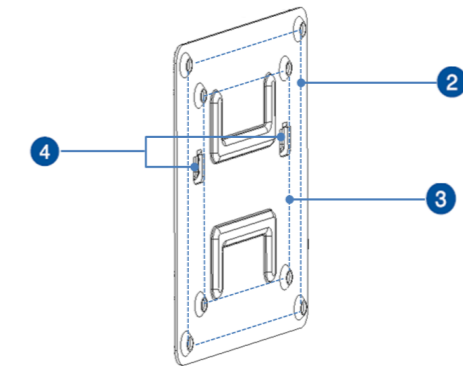

1 Hanging hole	3 Wall mount 75x75mm
2 Wall mount 100x100mm	4 Cleats

Remote Control

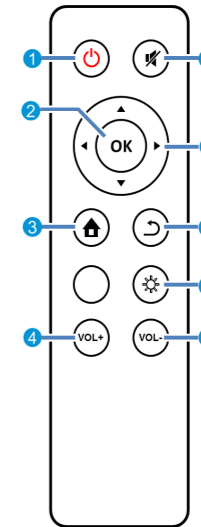

- | | |
|-----------------------------------|---|
| 1. Power button | - Press and hold the button to turns the box on/off. |
| | - Press the button once to put the box in sleep mode. |
| 2. OK button | - Confirms the selection. |
| | - Enters the submenu. |
| 3. Home button | Goes back to the main page. |
| 4. Volume Up | Increases the volume level. |
| 5. Volume Down | Decreases the volume level. |
| 6. Setting button | Turns the setting page on/off. |
| 7. Back button | Goes back to the previous Page. |
| 8. Four Directional select | - Selects a menu item |
| | - Adjusts the setting |
| 9. Mute button | Mutes the audio. Press it again to disable the mute Function. |

Installing remote control battery

1. Open the battery compartment cover.
2. Remove the insulator and insert the battery with the positive(+) symbol facing up.
3. Refit the battery compartment cover.

The incorrect use of batteries can result in leaks or bursting. Be sure to follow the instruction.

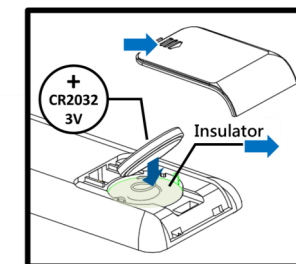

Connecting the display

Before setting up the client box, please find the HDMI or VGA input interface. After connecting the input cable, please switch HDMI/VGA signals via the monitor's input selection button.

Please follow the steps below to connect the client box:

Place the client box on the flat surface near the monitor. Let the back/rear panel facing you to clearly see the back panel I/O ports interface.

1. Plug the power cord to the client box's power interface and connect the power adapter to a socket.
2. Connect one end of the HDMI/VGA cable to the client box, the other end to the monitor's HDMI/VGA interface.
3. Press the power button (⏻) on top of the client box for 4 seconds. The monitor will then display the startup screen of the operation system.

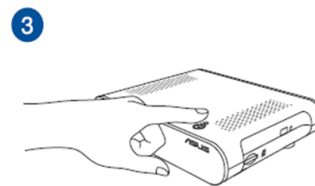
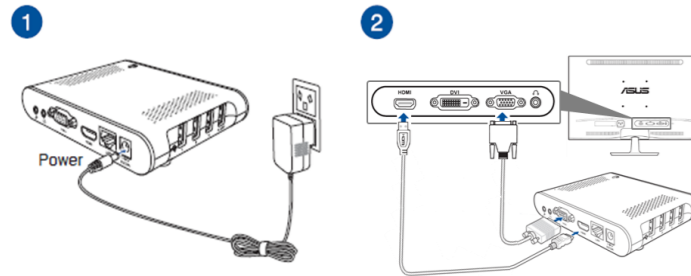

Use Wall mount bracket

Before using the wall mount bracket, please equip a 75x75mm or 100x100mm VESA wall-mounting compliant display and compatible screws.

Please follow the steps below to wall mount the client box:

1. Attach the wall mount bracket to the back of display and fix with the screw to join them tightly.
2. Connect the hanging hole at the bottom of the client box with the cleats of the wall mount bracket. Slightly pull the client box down to secure it.

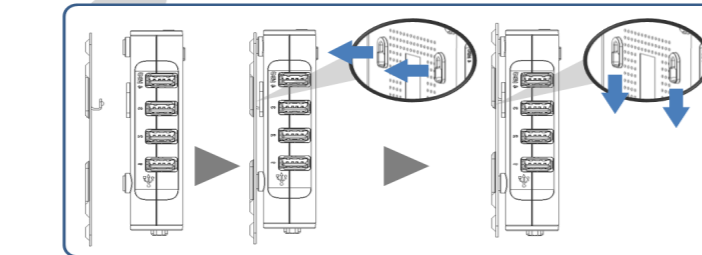
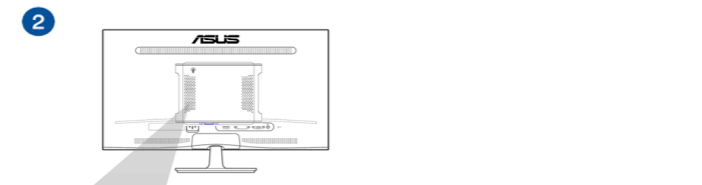
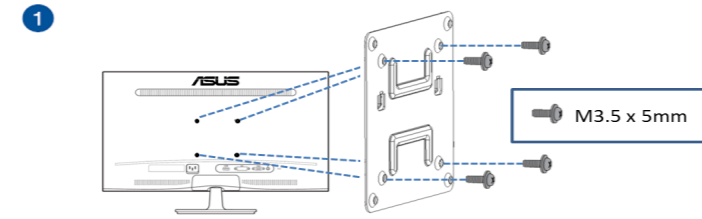

Specification

Model	CAX21
CPU	ARM quad-core Cortex-A9 1.6GHz
ROM	DDRIII 2GB
RAM	NAND FLASH 8GB
Network	RJ45 10/100Mbps WLAN 802.11b/g/n Bluetooth 4.0
Operating System	Android 4.4
I/O port	1x Micro SD slot 1x VGA, 1x HDMI 1x Earphone jack, 1x Microphone jack 3x USB2.0, 1x USB2.0 OTG
Wall mount bracket	75mm
Operating power	6.8W
Stand-By power	3.2W
Operating Temperature	0~40 °C
Power Supply	15W(5V3A) Power adaptor
Phys. Dimension (W x H x D)	129.5 x 25 x 108 mm
Box Dimension (W x H x D)	290 x 270 x 287 mm
Accessory	AC Adapter, User guide, Warranty Card Remote control
Optional	Wall mount bracket

NCC 警語 (以下警語適用台灣地區)

1. 經型式認證合格之低功率射頻電機，非經許可，公司、商號或使用者均不得擅自變更頻率、加大功率或變更原設計之特性及功能。
2. 低功率射頻電機之使用不得影響飛航安全及干擾合法通信；經發現有干擾現象時，應立即停用，並改善至無干擾時方得繼續使用。前項合法通信，指依電信法規定作業之無線電通信。低功率射頻電機須忍受合法通信或工業、科學及醫療用電波輻射性電機設備之干擾。

Federal Communication Commission Interference Statement

This equipment has been tested and found to comply with the limits for a Class B digital device, pursuant to Part 15 of the FCC Rules. These limits are designed to provide reasonable protection against harmful interference in a residential installation. This equipment generates, uses and can radiate radio frequency energy and, if not installed and used in accordance with the instructions, may cause harmful interference to radio communications. However, there is no guarantee that interference will not occur in a particular installation. If this equipment does cause harmful interference to radio or television reception, which can be determined by turning the equipment off and on, the user is encouraged to try to correct the interference by one or more of the following measures:

- Reorient or relocate the receiving antenna.
- Increase the separation between the equipment and receiver.
- Connect the equipment into an outlet on a circuit different from that to which the receiver is connected.
- Consult the dealer or an experienced radio/TV technician for help.

FCC Caution: Any changes or modifications not expressly approved by the party responsible for compliance could void the user's authority to operate this equipment.

This device complies with Part 15 of the FCC Rules. Operation is subject to the following two conditions: (1) this device may not cause harmful interference, and (2) this device must accept any interference received, including interference that may cause undesired operation. This device and its antenna(s) must not be co-located or operating in conjunction with any other antenna or transmitter.

IMPORTANT NOTE:

FCC Radiation Exposure Statement:

This equipment complies with FCC radiation exposure limits set forth for an uncontrolled environment. This equipment should be installed and operated with minimum distance 20cm between the radiator & your body.

Innovation, Science and Economic Development Canada (ISED)

This device complies with RSS210 of Industry Canada.

CAUTION: Exposure to Radio Frequency Radiation. The installer of this radio equipment must ensure that the antenna is located or pointed such that it does not emit RF field in excess of Health Canada limits for the general population. Consult Safety Code 6, obtainable from health Canada's website www.hc-sc.ca/rpb.

This device complies with Innovation, Science and Economic Development Canada license-exempt RSS standard(s). Operation is subject to the following two conditions: (1) This device may not cause harmful interference, and (2) this device must accept any interference received, including interference that may cause undesired operation.

Ce dispositif est conforme à la norme CNR Innovation, Sciences et Développement économique Canada applicables aux appareils radio exempts de licence. Son fonctionnement est sujet aux deux conditions suivantes: (1) le dispositif ne doit pas produire de brouillage préjudiciable, et (2) ce dispositif doit accepter tout brouillage reçu, y compris un brouillage susceptible de provoquer un fonctionnement indésirable.

Radiation Exposure Statement:

This equipment complies with ISED radiation exposure limits set forth for an uncontrolled environment. This equipment should be installed and operated with minimum distance 20cm between the radiator & your body.

Déclaration d'exposition aux radiations:

Cet équipement est conforme aux limites d'exposition aux rayonnements ISED établies pour un environnement non contrôlé. Cet équipement doit être installé et utilisé avec un minimum de 20 cm de distance entre la source de rayonnement et votre corps.

「產品之限用物質含有情況」之相關資訊，請參考下表

設備名稱: 雲客戶機 · 型號: CAX21						
單元	限用物質及其化學符號					
	鉛 (Pb)	汞 (Hg)	鎘 (Cd)	六價鉻 六價鉻	多溴聯苯 (PBB)	多溴二苯醚 (PBDE)
印刷電路板及電子組件	○	○	○	○	○	○
其他及其配件	○	○	○	○	○	○
備者 1. "○" 係指該項限用物質之百分比含量未超出百分比含量基準值。						

ASUS CONTACT INFORMATION

ASUSTeK Computer Inc.

Address 15 Li-Te Rd. Peitou,
Taipei 11259, Taiwan
Telephone +886-2-2894-3447
Fax +886-2-2894-7798
E-mail info@asus.com.tw
Website <http://www.asus.com/tw/>

Technical Support

Telephone +886-2-7736-0456

ASUS Computer Internal (America)

Address 800 Corporate Way,
Fremont, CA 94539, USA
Fax +1-510-608-4555
Website <http://www.asus.com/us/>

Technical Support

Telephone (English Only) +1-812-282-2787
(French Only) +1-905-370-2787
Online Support <http://support.asus.com/>

ASUS Computer GmbH (Germany and Austria)

Address Harkortstr. 21-23
D-40880 Ratingen, Germany
Telephone +49-1805-010920
Website <http://www.asus.com/de/>

Technical Support

Telephone +49-1805-010923
Support Fax +49-2102-959911
Online Support <http://support.asus.com/>