

MARK	ISSUE	DATE	REVER
------	-------	------	-------

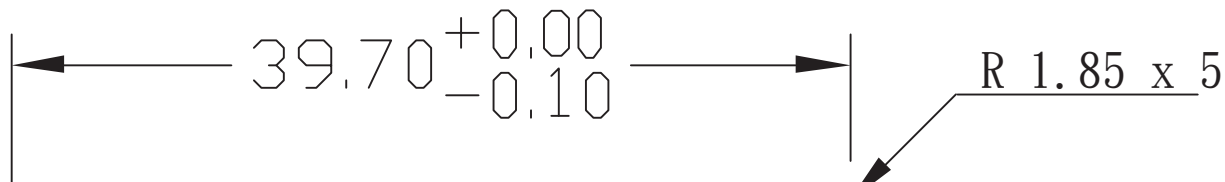

M/N(型號): SM -9061  
 RATING(輸入): 1.5V  $\equiv$  50mA  
 MADE IN CHINA 中國製造

S/N: [REDACTED]  
 P/N: [REDACTED]

LITE-ON

- NOTE:
1. MATERIAL: PP-SYNTHETIC PAPER, THICKNESS: 0.08mm.
  2. Background and Serial number color: Black.
  3. Text and Serial number background Color: White.
  4. DASH LINE FOR FACTORY SITE PRINTING.
  5. PART NUMBER: 836-00818-01A.
  6. ROHS

SELECT V	V			
LEVEL	A	B	C	D
~ 5	±0.03	±0.05	±0.08	±0.10
5 ~ 10	±0.05	±0.08	±0.10	±0.15
10 ~ 50	±0.08	±0.10	±0.15	±0.20
50 ~ 100	±0.10	±0.15	±0.20	±0.25
100 ~	±0.10	±0.15	±0.20	±0.25

CLASS 1 LED PRODUCT  
 FCC ID : H4IMS9061



20.00

36.70  
 +0.00  
 -0.10

PART NO	DESCRIPTION	QTY	MATL	TRETING	REMARK
SCALE: 1:1	TOLERANCE: UNSPECIFIED XXX ± 0.05 XX ± 0.1 X ± 0.15 ANGLE ± 0.25	<p>Silitek Corporation</p>			
UNIT: mm					
DRAWN:				TITLE: label	
DESIGER:		SHEET 1 OF 2		SM 9061	
CHECKED:		DRAWING NO: 836-00818-01A			
APPROVED:		A3		REV	0.1

Label Location

