

FRONT

SHARPER IMAGE

Behind the Neck Wireless Earbuds



User Guide SBT530

In the Box



Location of Controls

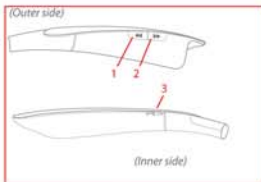

1. [◀▶] Button: Skip to previous track
2. [▶▶] Button: Skip to next track
3. [ANC] Switch: Non-functioning
4. [▶||] Button: Play/pause media playback
5. [] Button:
 - Long Press - Reject incoming phone call
 - Quick Press - Answer/end phone calls
 - Double Press - Redial last incoming phone call
6. [+] Button: Increase volume
7. [-] Button: Decrease volume
8. LED Indicator
9. [POWER] Switch: Power ON/OFF
10. Micro USB Charging Port

Pairing the Earbuds

1. Move the [POWER] switch to the ON position. The LED indicator beneath it will quickly flash BLUE and a tone will be heard.
2. Set your Bluetooth-enabled device to search for Bluetooth devices. When the Bluetooth-enabled device finds the speaker, select "SBT530" from the list of found devices.
3. After a successful pairing, a tone will be heard indicating that the device is paired and the LED indicator will slowly flash BLUE.

! If a previously paired device is in range when the headphones are turned on, the earbuds will connect to it automatically.

On an iOS or Android Device
• Go to **SETTINGS > BLUETOOTH**
(Make sure Bluetooth is turned ON)



! The items shown above are typical of many Bluetooth-enabled devices in the market today, and are used to assist in the explanation of the pairing process. Your Bluetooth-enabled device's interface and interaction with the earbuds may differ slightly from the illustrations above.

Using the Earbuds

Powering ON/OFF

- To turn the earbuds ON, move the [POWER] switch to the ON position.
- To turn the earbuds OFF, move the [POWER] switch to the OFF position.

Adjusting Volume

- Long press the [+] button to increase volume. A tone will be heard if you attempt to increase the volume past maximum level.
- Long press the [-] button to decrease volume.

Playing Media

To enjoy music on your earbuds, make sure you are paired to a Bluetooth-enabled device. Once paired, you can control media playback and volume adjustment with the controls on your paired device on with the earbuds.

Playing/Pausing Media

- To pause media playback, press the [▶||] button.
- To resume media playback, press the [▶||] button, again. While media is playing, the LED indicator will flash BLUE.

Skipping Tracks

- To skip to the previous track, press the [◀▶] button.
- To skip to the next track, press the [▶▶] button.

Answering/Ending Phone Calls

- To answer an incoming phone call, quick press the [] button.
- To end a phone call, quick press the [] button, again.

Redialing Last Incoming Phone Call

- Double press the [] button to redial the last incoming phone call.

Rejecting Phone Calls

- Long press the [] button to reject an incoming phone call and send it straight to voice mail.

Charging the Earbuds

To charge the earbuds, remove the rubber, protective seal from the micro USB charging port on the side of the neck band and attach the small end of the micro USB cable to it. Attach the large end to a USB adaptor, battery pack, or USB port on a computer. The LED indicator will turn RED while charging and turn off when charged.

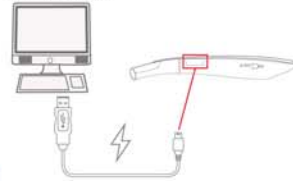

! Make sure you charge your earbuds for at least 2-3 hours before using them for the first time.

BACK

Questions and Customer Support

For further assistance or troubleshooting, please call our customer support line:

☎ Phone: 1-877-768-8481
Monday-Friday 8AM-10PM (EST)

🌐 www.southern telecom.com
Click on "Product Support"

Legal Information

READ CAREFULLY AND KEEP THIS MANUAL

Caution: Any changes or modifications not expressly approved could void the user's authority to operate the equipment.

This device complies with Part 15 of the FCC Rules. Operation is subject to the following two conditions:
(1) This device may not cause harmful interference, and
(2) this device must accept any interference received, including interference that may cause undesired operation.

Note: This equipment has been tested and found to comply with the limits for a Class B digital device, pursuant to part 15 of the FCC Rules. These limits are designed to provide reasonable protection against harmful interference in a residential installation. This equipment generates, uses and can radiate radio frequency energy and, if not installed and used in accordance with the instructions, may cause harmful interference to radio communications. However, there is no guarantee that interference will not occur in a particular installation. If this equipment does cause harmful interference to radio or television reception, which can be determined by turning the equipment off and on, the user is encouraged to try to correct the interference by one or more of the following measures:

- Reorient or relocate the receiving antenna.
- Increase the separation between the equipment and receiver.
- Connect the equipment into an outlet on a circuit different from that to which the receiver is connected.
- Consult the dealer or an experienced radio/TV technician for help.

Caution: Any changes or modifications to this device not explicitly approved by manufacturer could void your authority to operate this equipment.

This device complies with part 15 of the FCC Rules. Operation is subject to the following two conditions:
(1) This device may not cause harmful interference, and
(2) this device must accept any interference received, including interference that may cause undesired operation.

The device has been evaluated to meet general RF exposure requirement. The device can be used in portable exposure condition without restriction.

Limited Warranty

90 Days Limited Warranty
In the unlikely event that this product is defective, or does not perform properly, you may within ninety (90) days from your original date of purchase return it to the authorized service center for repair or exchange.

TO OBTAIN WARRANTY SERVICE:
• Call the Customer Support number located below, or go to our website portal to receive an SRQ number.
• Provide proof of the date of purchase within the package (dated bill of sale).

• Prepay all shipping costs to the authorized service center, and remember to insure your return.
• Include a return shipping address (no P.O. Boxes), a telephone contact number, and the defective unit within the package.
• Describe the defect or reason you are returning the product.

Your product will be repaired or replaced, at our option, for the same or similar model of equal value. If examination by the service center determines this product is defective. Products received damaged as a result of shipping will require you to file a claim with the carrier.

The shipping address of the authorized service center is:
☎ Southern Telecom, Inc.
Attention: Customer Service (2nd Floor)
14-C 53rd Street
Brooklyn, NY 11232

Should you have any questions or problems concerning this product, please contact our customer service department at:
Customer Support
☎ Phone: 1-877-768-8481
Monday-Friday 8AM-10PM(EST)

🌐 www.southern telecom.com
Click on "Product Support"

Warranty service not provided

This warranty does not cover damage resulting from accident, misuse, abuse, improper installation or operation, lack of reasonable care, and unauthorized modification. This warranty is voided in the event any unauthorized person opens, alters or repairs this product. All products being returned to the authorized service center for repair must be suitably packaged.

Limitation of Warranty:
• THE WARRANTY STATED ABOVE IS THE ONLY WARRANTY APPLICABLE TO THIS PRODUCT. ALL OTHER WARRANTIES, EXPRESS OR IMPLIED (INCLUDING ALL IMPLIED WARRANTIES OF MERCHANTABILITY OR FITNESS FOR A PARTICULAR PURPOSE) ARE HEREBY DISCLAIMED. NO VERBAL OR WRITTEN INFORMATION GIVEN BY AIT, INC. ITS AGENTS, OR EMPLOYEES SHALL CREATE A WARRANTY OR IN ANY WAY INCREASE THE SCOPE OF THIS WARRANTY.

• REPAIR OR REPLACEMENT AS PROVIDED UNDER THIS WARRANTY IS THE EXCLUSIVE REMEDY OF THE CONSUMER. AIT, INC. SHALL NOT BE LIABLE FOR INCIDENTAL OR CONSEQUENTIAL DAMAGES RESULTING FROM THE USE OF THIS PRODUCT OR ARISING OUT OF ANY BREACH OF ANY EXPRESS OR IMPLIED WARRANTY ON THIS PRODUCT. THIS DISCLAIMER OF WARRANTIES AND LIMITED WARRANTY ARE GOVERNED BY THE LAWS OF THE STATE OF NEW YORK. EXCEPT TO THE EXTENT PROHIBITED BY APPLICABLE LAW, ANY IMPLIED WARRANTY OF MERCHANTABILITY OR FITNESS FOR A PARTICULAR PURPOSE ON THIS PRODUCT IS LIMITED TO THE APPLICABLE WARRANTY PERIOD SET FORTH ABOVE.

Some states do not allow the exclusion nor limitation of incidental or consequential damages, or limitations on how long an implied warranty lasts so the above limitations on exclusions may not apply to you. This warranty gives you specific legal rights, and you also may have other rights that vary from state to state.



Sharper Image® name and logo are registered trademarks. Manufactured and marketed by Southern Telecom under license. © Sharper Image. All Rights Reserved.

SHARPER IMAGE