

**SHARPER
IMAGE**

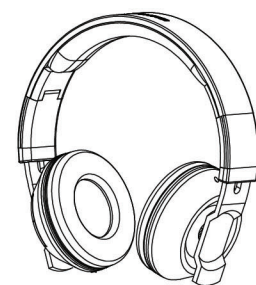

Wireless Headphones User Guide SBT564

In the box



Wireless Headphones



3.5mm
Aux IN cable

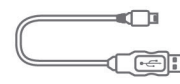

Micro USB
Charging Cable

Charging the Bluetooth Headphones

1. Connect the small end of the Micro USB cable to the charging port on the headphones.
2. Connect the large end of the Micro USB cable to your computer's USB port or an AC adapter (not included).
3. The LED indicator light turns RED when charging.
4. When fully charged, the LED indicator light turns OFF.
5. A voice prompt will be heard indicating that the headphones require charging.

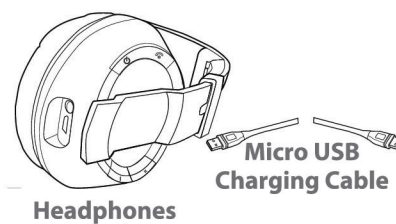

Headphones

Micro USB
Charging Cable

Computer

i Make sure you charge your headphones for at least 2 hours before using them for the first time.

Location of Controls

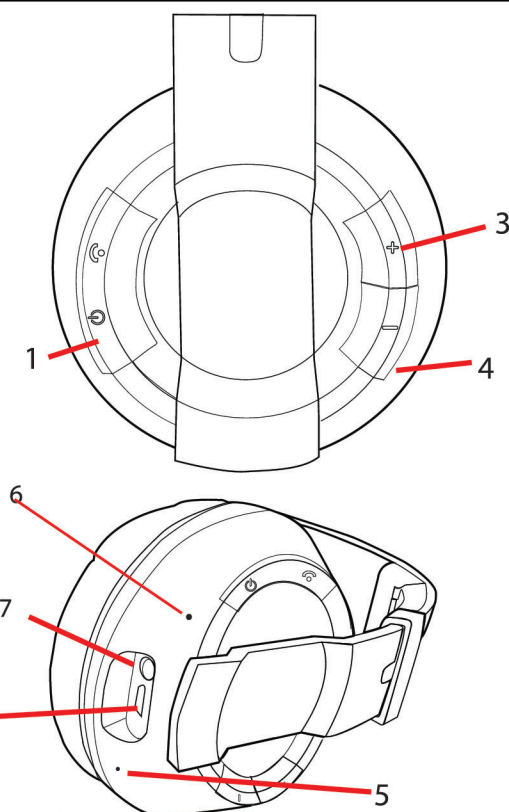

1. [Power] button:
 - Press and hold for 3 seconds to power ON
 - Press and hold for 3 seconds to power OFF
 - Quick press to answer/end call
 - Quick press to play / pause music
2. Micro USB charging port
3. [+] button:
 - quick press = next track
 - long press = increase volume
4. [-] button:
 - quick press = previous track
 - long press = decrease volume
5. Microphone
6. LED indicator light
7. Aux IN jack

Using your Bluetooth Headphones

Powering ON/OFF

- To turn ON, long press the [Power] button for 3 seconds.

- To turn OFF, long press the [Power] button for 3 seconds.

Adjusting the volume

- Long press the [+] button to increase the volume.
- Long press the [-] button to decrease the volume.

A tone will be heard when maximum volume is reached.

Play/pause

- Quick press the [Power] button to play music.
- Quick press the [Power] button to pause.

Skipping songs

- Quick press the [+] button to skip to the next track.
- Quick press the [-] button to skip to the previous track.

i NOTE: You can also adjust the volume from your mobile phone's volume control.

Answering / Ending Phone Calls

Answering/ending a call

- To answer a call, quick press the [Power] button.
- To end a call, quick press the [Power] button again.

i The music will pause automatically while a call is dialed out/incoming, and resume when the conversation has ended.

Pairing the headphones with a Bluetooth enabled device

1. Long press the [Power] button for 3 seconds to turn ON the Bluetooth headphones and enter pairing mode.
2. A tone will be heard. The BLUE indicator light will flash quickly.
3. Set your mobile phone or other Bluetooth enabled device to search for Bluetooth devices.

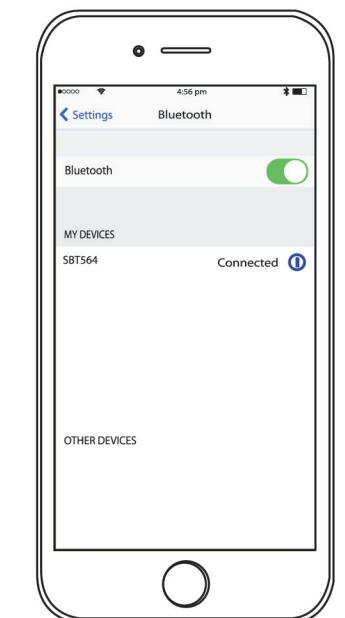
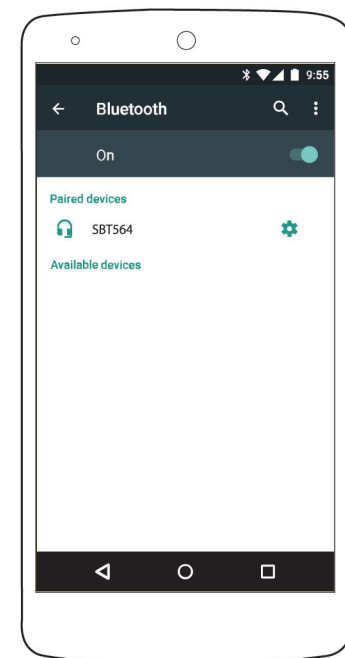

4. When the Bluetooth enabled device finds the headphones, select "SBT564" from the list of found devices.
5. After a successful registration, a tone will sound and the LED indicator light will slowly flash BLUE.

NOTE: Keep your Bluetooth headphones and Bluetooth enabled device within 3 feet of each other during the pairing process.

i The screenshots above are typical of many Bluetooth enabled devices in the market today, and are used to assist in the explanation of the pairing process. Your Bluetooth enabled device's interface and interaction with the headphones may slightly differ from the illustrations above.

Using as wired headphones



Headphones

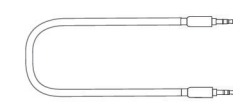

3.5mm Aux IN cable

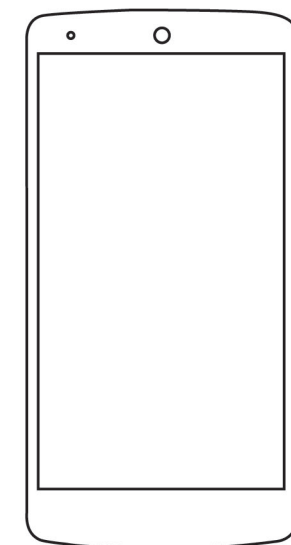

Phone

1. Turn the headphones ON.
2. Connect one end of the included 3.5mm jack into the Aux jack on the headphones and the other end to an external device's headphone jack (smartphone, tablet, or MP3 player).
3. Open a media player on your device and press play to start playing your music.
4. Use the controls on your connected device to control music playback and volume.

NOTE: Only the volume and pause/play buttons on the headphones will be operational when in aux-in mode.

i Connecting the audio cable will override Bluetooth mode. When the cable is disconnected, the headphones will automatically reconnect to the last paired device.

Legal information

FCC Part 15:
This equipment has been tested and found to comply with the requirements for a Class B digital device under Part 15 of the Federal Communications Commission (FCC) rules. These requirements are intended to provide reasonable protection against harmful interference in a residential installation. This equipment generates, uses and can radiate radio frequency energy and, if not installed and used in accordance with the instructions, may cause harmful interference to radio communications. However, there is no guarantee that interference will not occur in a particular installation. If this equipment does cause harmful interference to radio or television reception, which can be determined by turning the equipment off and on, the user is encouraged to try to correct the interference by one or more of the following measures:

- Re-orient or relocate the receiving antenna.
- Increase the separation between the equipment and receiver.
- Connect the equipment into an outlet on a circuit different from that to which the receiver is connected.
- Consult the dealer or an experienced radio/TV technician for help.

Do not attempt to repair or modify this equipment. Warning: Changes or modifications to this equipment not expressly approved by the party responsible for compliance could void the user's authority to operate the equipment. *This device complies with Part 15 of the FCC Rules. Operation is subject to the following two conditions:

- (1) this device may not cause harmful interference, and
- (2) this device must accept any interference received, including interference that may cause undesired operation.*

Limited Warranty

90 Days Limited Warranty

In the unlikely event that this product is defective, or does not perform properly, you may within ninety (90) days from your original date of purchase return it to the authorized service center for repair or exchange.

TO OBTAIN WARRANTY SERVICE:

- Provide proof of the date of purchase within the package (Dated bill of sale).
- Prepay all shipping costs to the authorized service center, and remember to insure your return.
- Include a return shipping address (no P.O. Boxes), a telephone contact number, and the defective unit within the package.
- Describe the defect or reason you are returning the product.

Your product will be repaired or replaced, at our option, for the same or similar model of equal value if examination by the service center determines this product is defective. Products received damaged as a result of shipping will require you to file a claim with the carrier.

The shipping address of the authorized service center is:

Southern Telecom, Inc.
Attention: Customer Service (2nd Floor)
14-C 53rd Street
Brooklyn, NY 11232

Should you have any questions or problems concerning this product, please contact our customer service department at:

Customer Support:
Phone: 1-877-768-8481
Monday-Friday 8AM-10PM(EST)

www.southerntelecom.com
Click on "Product Support"

Manufacturer: LINPA WORLD, Ltd

Limited Warranty

Warranty service not provided

This warranty does not cover damage resulting from accident, misuse, abuse, improper installation or operation, lack of reasonable care, and unauthorized modification. This warranty is voided in the event any unauthorized person opens, alters or repairs this product. All products being returned to the authorized service center for repair must be suitably packaged.

Limitation of Warranty:

• THE WARRANTY STATED ABOVE IS THE ONLY WARRANTY APPLICABLE TO THIS PRODUCT. ALL OTHER WARRANTIES, EXPRESS OR IMPLIED (INCLUDING ALL IMPLIED WARRANTIES OF MERCHANTABILITY OR FITNESS FOR A PARTICULAR PURPOSE) ARE HEREBY DISCLAIMED. NO VERBAL OR WRITTEN INFORMATION GIVEN BY AIT, INC. IT'S AGENTS, OR EMPLOYEES SHALL CREATE A WARRANTY OR IN ANY WAY INCREASE THE SCOPE OF THIS WARRANTY.

• REPAIR OR REPLACEMENT AS PROVIDED UNDER THIS WARRANTY IS THE EXCLUSIVE REMEDY OF THE CONSUMER. AIT, INC. SHALL NOT BE LIABLE FOR INCIDENTAL OR CONSEQUENTIAL DAMAGES RESULTING FROM THE USE OF THIS PRODUCT OR ARISING OUT OF ANY BREACH OF ANY EXPRESS OR IMPLIED WARRANTY ON THIS PRODUCT. THIS DISCLAIMER OF WARRANTIES AND LIMITED WARRANTY ARE GOVERNED BY THE LAWS OF THE STATE OF NEW YORK. EXCEPT TO THE EXTENT PROHIBITED BY APPLICABLE LAW, ANY IMPLIED WARRANTY OF MERCHANTABILITY OR FITNESS FOR A PARTICULAR PURPOSE ON THIS PRODUCT IS LIMITED TO THE APPLICABLE WARRANTY PERIOD SET FORTH ABOVE.

Some states do not allow the exclusion nor limitation of incidental or consequential damages, or limitations on how long an implied warranty lasts so the above limitations on exclusions may not apply to you. This warranty gives you specific legal rights, and you also may have other rights that vary from state to state.

SHARPER IMAGE

FCC ID warning statement

This equipment has been tested and found to comply with the limits for a Class B digital device, pursuant to part 15 of the FCC Rules. These limits are designed to provide reasonable protection against harmful interference in a residential installation. This equipment generates, uses and can radiate radio frequency energy and, if not installed and used in accordance with the instructions, may cause harmful interference to radio communications. However, there is no guarantee that interference will not occur in a particular installation. If this equipment does cause harmful interference to radio or television reception, which can be determined by turning the equipment off and on, the user is encouraged to try to correct the interference by one or more of the following measures:

This equipment has been tested and found to comply with the limits for a Class B digital device, pursuant to part 15 of the FCC Rules. These limits are designed to provide reasonable protection against harmful interference in a residential installation. This equipment generates, uses and can radiate radio frequency energy and, if not installed and used in accordance with the instructions, may cause harmful interference to radio communications. However, there is no guarantee that interference will not occur in a particular installation. If this equipment does cause harmful interference to radio or television reception, which can be determined by turning the equipment off and on, the user is encouraged to try to correct the interference by one or more of the following measures: