

# ORCHESTRA OF LIGHTS™

**Congratulations!** You are now the proud owner of a LED LIGHTSHOW. Please read the directions carefully before use.

**SAFETY WARNING:** Remove all plastic fasteners and tags. These are part of the packaging and should be discarded.

**SAVE THESE INSTRUCTIONS** — This manual contains important safety and operating instructions for power units.

## WARNING

---

ELECTRIC PRODUCT. Keep away from children. Not recommended for children under 3 years of age. As with all electrical products, precautions should be observed during handling and use to reduce the risk of electric shock. If the supply cord is damaged, it must be replaced by the manufacturer, its service agent or similarly qualified persons in order to avoid a hazard.

## WARNING

---

Strobe lights have been known to trigger seizures in people with photosensitive epilepsy.

## IMPORTANT SAFETY INSTRUCTIONS WHEN USING ELECTRICAL PRODUCTS, BASIC PRECAUTIONS SHOULD ALWAYS BE FOLLOWED INCLUDING THE FOLLOWING:

---

### READ AND FOLLOW ALL SAFETY INSTRUCTIONS

1. Do not use seasonal products outdoors unless marked suitable for indoor and outdoor use. When products are used in outdoor applications, connect the product to a Ground Fault Circuit Interrupting (GFCI) outlet. If one is not provided, contact a qualified electrician for proper installation.
2. This seasonal use product is not intended for permanent installation or use.
3. Do not mount or place near gas or electric heaters, fireplace, candles or other similar sources of heat.
4. Do not secure the wiring of the product with staples or nails, or place on sharp hooks or nails.
5. Do not let lamps rest on the supply cord or on any wire.
6. Unplug the product when leaving the house, when retiring for the night, or if left unattended.
7. This is an electric product-not a toy! To avoid risk of fire, burns, personal injury and electric shock it should not be played with or placed where small children can reach it.
8. Do not use this product for other than its intended use.
9. Do not hang ornaments or other objects from cord, wire, or light string.
10. Do not close doors or windows on the product or extension cords as this may damage the wire insulation.
11. Do not cover the product with cloth, paper or any material not part of the product when in use.
12. This product employs overload protection (fuse). A blown fuse indicates an overload or short-circuit situation. If the fuse blows, unplug the product from the outlet. Also unplug any additional strings or products that may be attached to the product. Replace the fuse as per the user servicing instructions(follow product marking for proper fuse rating)and check the product. If the replacement fuse blows, a short-circuit may be present and the product should be discarded.
13. Read and follow all instructions that are on the product or provided with the product.

**Always unplug this product before installing or replacing fuses.**

**CAUTION:** To reduce the risk of fire and electric shock:

Do not mount or support wires in a manner that can cut or damage wire insulation.

**SAVE THESE INSTRUCTIONS.**

## USE AND CARE INSTRUCTIONS

1. Before using or reusing, inspect product carefully. Discard any products that have cut, damaged, or frayed wire insulation or cords, cracks in the lampholders or enclosures, loose connections, or exposed copper wire.
2. When storing the product, carefully remove the product from wherever it is placed, including trees, branches, or bushes, to avoid any undue strain or stress on the product conductors, connections, and wires.
3. When not in use, store neatly in a cool, dry location protected from sunlight.

## USER SERVICING INSTRUCTIONS

### To replace the fuse:

1. Grasp plug and remove from the receptacle or other outlet device. Do not unplug by pulling on cord.
2. Open fuse cover. Slide open fuse access cover on top of attachment plug towards blades.
3. Remove fuse carefully. Turn fuseholder over to remove fuse.
4. **RISK OF FIRE.** Replace fuse only with 3 Amp, 125Volt fuse (provided with product.)
5. Close fuse cover. Slide closed the fuse access cover on top of attachment plug.
6. **RISK OF FIRE.** Do not replace attachment plug. Contains a safety device (fuse) that should not be removed. Discard product if the attachment plug is damaged.

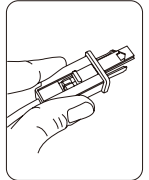

## CAUTION

This string is rated 24Watts ( 0.2Amps ), do not overload. Connect other Lighting Strings or decorative outfits end-to-end up to a maximum of 216 Watts (1.8 Amps) total.

If connecting to a lighting string that does not have a wattage (W) rating (found on the tag within 6 inches of the plug), Calculate The wattage (W) as follows: Multiply the current (0.2A) which is on the flag type tag Within 6 inches of the plug, by 120.

For example, string is rated 120V, 60Hz, 0.2Amps,  $0.2 \times 120 = 24$  Watts.

Add the wattage of each light string together for a total of 216 Watts or less. (Do not exceed 216 Watts)

Total amount of wattage that can be connected  $216W - 24W = 192W$ .

## CAUTION

To reduce the risk of fire or electric shock, do not attempt to replace lamps or modify string.

**FOR INDOOR AND OUTDOOR USE**

## PACKAGE CONTENTS

Topper	3 pieces
Pole	3 pieces
Stake	3 pieces
Extra fuse, 3A, 125V	2 pieces

## PREPARATION

Before beginning assembly, remove all parts from carton. Compare parts list and diagram above. If any part is missing or damaged, do not attempt to assemble or use the product.

- Estimated assembly time: 10-15 minutes.

## ASSEMBLY INSTRUCTIONS

1. Set out all contents on a clear, flat surface.
2. Begin assembly by securing the stake into the ground.
3. Place the pole on top of stake. (see illustration)
4. Attach the topper onto the pole. (see illustration)
5. Repeat the process until complete.
6. Plug power cord into standard wall socket.

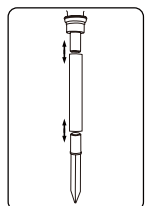

**NOTE:** This item is not a toy and should be used for decorative purposes only.

## WARNING

---

This device complies with Part 15 of the FCC Rules. Operation is subject to the following two conditions: (1) this device may not cause harmful interference, and (2) this device must accept any interference received, including interference that may cause undesired operation.

**CAUTION:** Changes or modifications not expressly approved by the party responsible for compliance could void the user's authority to operate the equipment.

**NOTE:** This equipment has been tested and found to comply with the limits for a Class B digital device, pursuant to Part 15 of the FCC Rules. These limits are designed to provide reasonable protection against harmful interference in a residential installation. This equipment generates, uses, and can radiate radio frequency energy and, if not installed and used in accordance with the instructions, may cause harmful interference to radio communications. However, there is no guarantee that interference will not occur in a particular installation. If this equipment does cause harmful interference to radio or television reception, which can be determined by turning the equipment off and on, the user is encouraged to try to correct the interference by one or more of the following measures:

- Reorient or relocate the receiving antenna.
- Increase the distance between the equipment and receiver.
- Connect the equipment into an outlet on a circuit different from that to which the receiver is connected.
- Consult the dealer or an experienced radio/TV technician for help important announcement

**Important Note:**

**Radiation Exposure Statement**

This equipment complies with FCC radiation exposure limits set forth for an uncontrolled environment. This equipment should be installed and operated with minimum distance 20cm between the radiator and your body.

This transmitter must not be co-located or operating in conjunction with any other antenna or transmitter.

## THESE INSTRUCTIONS ARE FOR THESE ITEM NUMBERS

---

880108

QD ID:91274

FCC Caution.

This device complies with part 15 of the FCC Rules. Operation is subject to the following two conditions:

- (1) This device may not cause harmful interference, and
- (2) this device must accept any interference received, including interference that may cause undesired operation.

Any Changes or modifications not expressly approved by the party responsible for compliance could void the user's authority to operate the equipment.

Note: This equipment has been tested and found to comply with the limits for a Class B digital device, pursuant to part 15 of the FCC Rules. These limits are designed to provide reasonable protection against harmful interference in a residential installation. This equipment generates uses and can radiate radio frequency energy and, if not installed and used in accordance with the instructions, may cause harmful interference to radio communications. However, there is no guarantee that interference will not occur in a particular installation. If this equipment does cause harmful interference to radio or television reception, which can be determined by turning the equipment off and on, the user is encouraged to try to correct the interference by one or more of the following measures:

- Reorient or relocate the receiving antenna.
- Increase the separation between the equipment and receiver.
- Connect the equipment into an outlet on a circuit different from that to which the receiver is connected.
- Consult the dealer or an experienced radio/TV technician for help.

This equipment complies with FCC radiation exposure limits set forth for an uncontrolled environment. This equipment should be installed and operated with minimum distance 20cm between the radiator & your body.