

## Stand-alone Charge Alarm Security Display Stand

# Showhi<sup>TM</sup> (H81 Series) Introduction

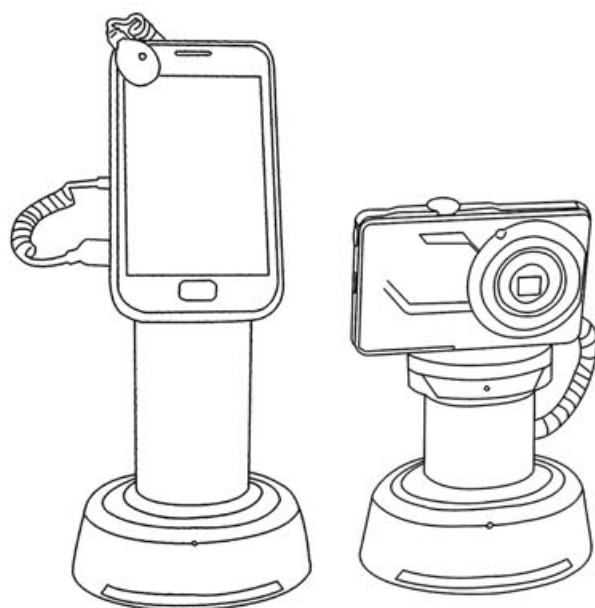

**Showhi<sup>TM</sup>** H81 Series are specially designed for security retail display of Smart Phone , tablet PC, Camera , MP3, MP4, MP5 and GPS, PSP and other similar consumer electronics. This user guide is specifically for phones and camera retail display.

# Content

Product Introduction .....	1
Multi-Alarm Function .....	2
Installation	
Fix security stands .....	3
Fix phones .....	4
Fix cameras .....	5
Indication Light under different conditions .....	6
Operation of Password Enabled .....	7
Remote control .....	7
Remove Stand from showcase .....	9
Specifications .....	10
Safety information and cautions .....	11

**Product Introduction**

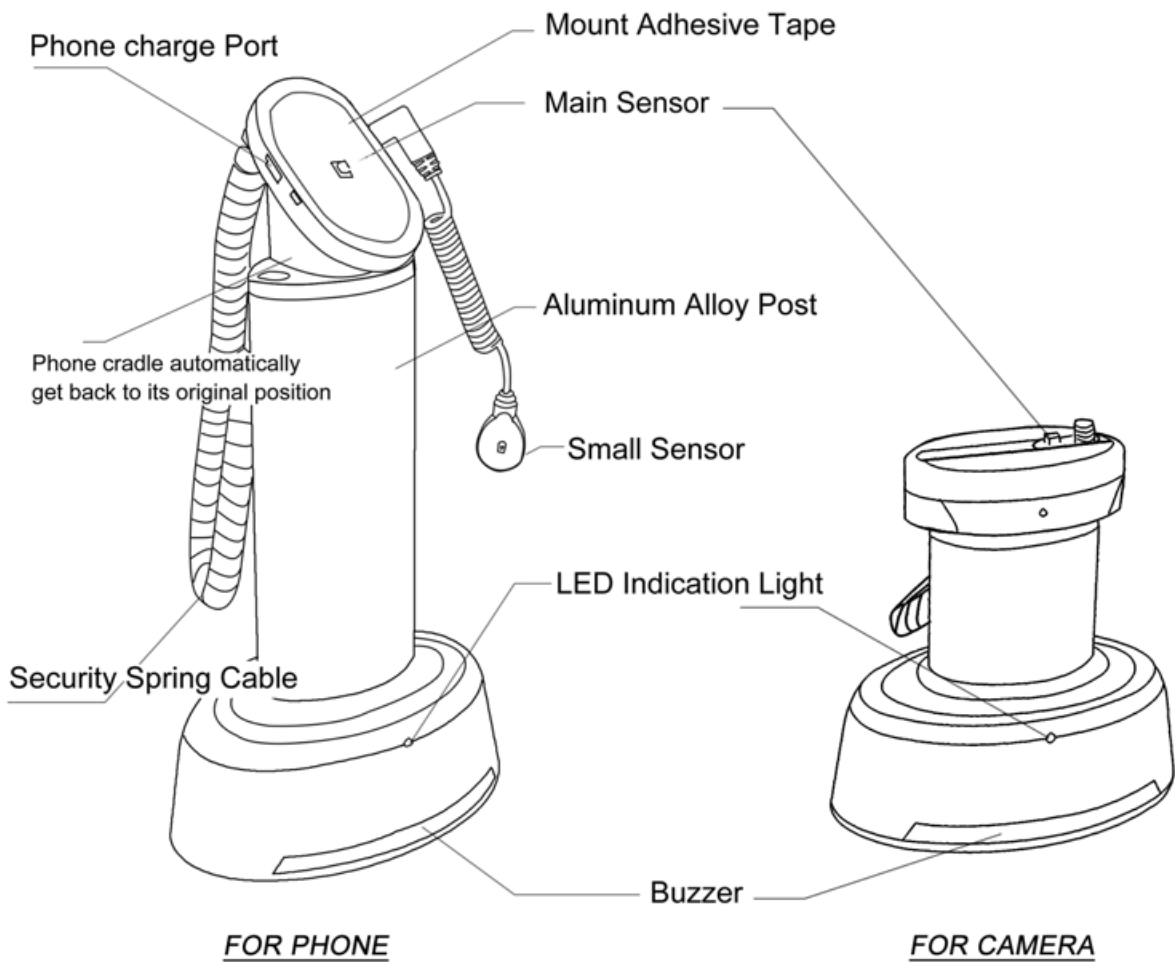

For phone cradle



Mains Power port

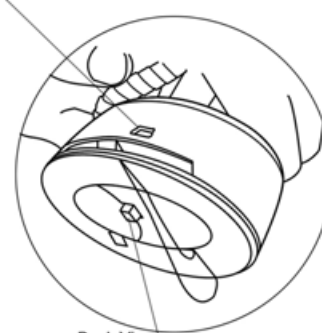

Detachable RJ11 port

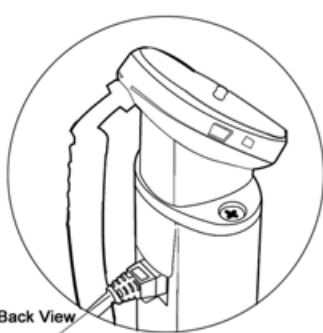

Bottom Alarm-Sensor

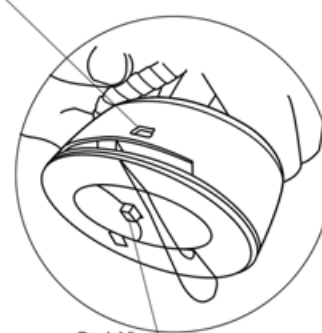

## Multi-alarm function



Multi-alarm function to protect exhibits from theft in all aspects:

- Trigger alarm if any part of the stands is removed off
- Trigger to alarm if any cable is cut
- Trigger to alarm if the phone charge cable is remove off
- Trigger to alarm if the exhibit is removed from the stand under work condition
- Trigger to alarm if the stand is removed under the work condition

## Fix security stands

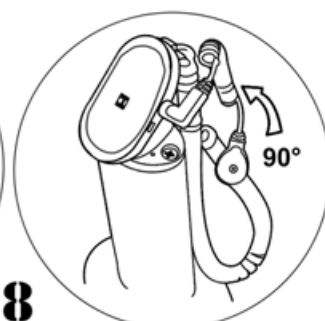
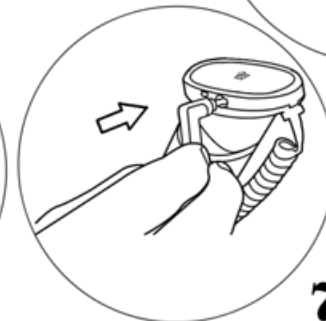
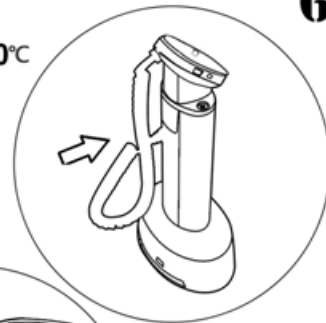
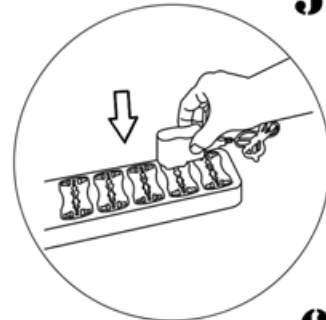
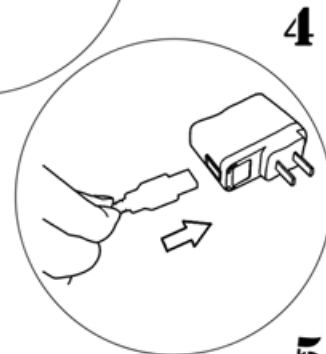
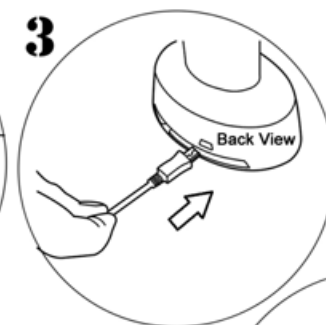
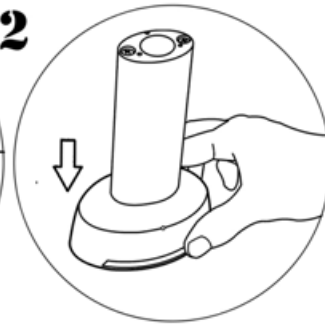
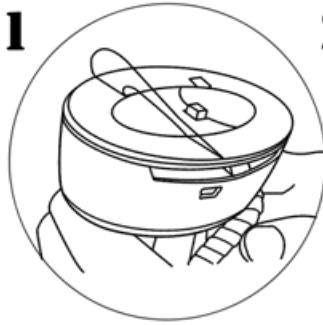

1-2, remove the adhesive protection film and paste the stand onto the display showcase

3-4-5, connect the mains power

6, Connect the spring cable with the stand

7-8, Insert the small sensor to the sensor port according to its shape, and turn upward 90 degree to ensure the tight connection.

9, Connect phone charge cable and the phone cradle

### Note:

1. In order to have strong adhesivity, Please confirm that the Environmental temperature is not lower than 10°C when to paste the adhesive tapes.
2. Please confirm contact surface is clean, no dirty mark.
3. Please press at 30 seconds when after paste the adhesive tape.

## Fix phones

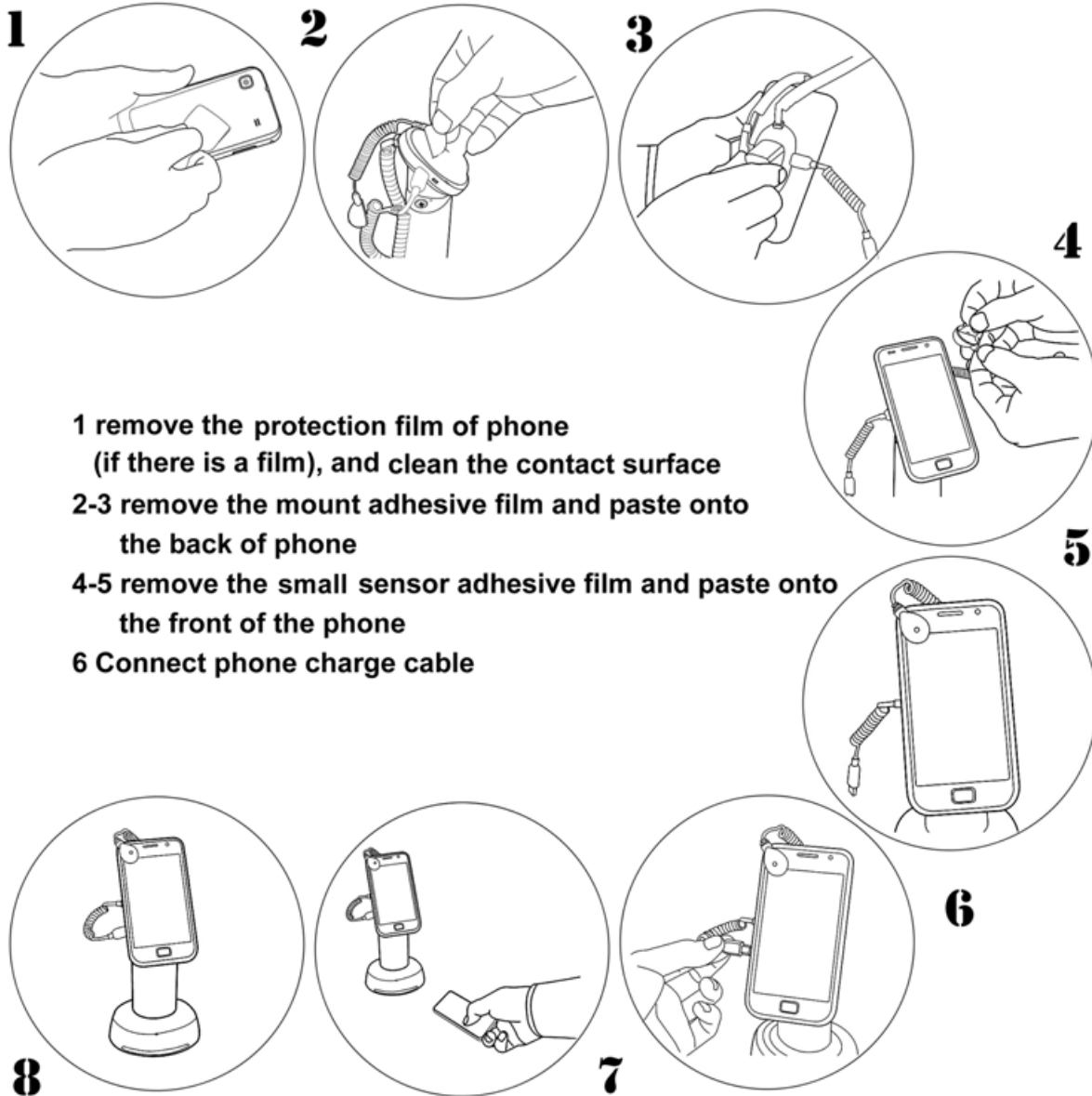

### Note:

1. In order to have strong adhesivity, Please confirm that the Environmental temperature is not lower than 10°C to when pasting the adhesive tapes.
2. Please confirm contact surface is clean, no dirty mark.
3. Please press at least for 30 seconds after pasting the adhesive tape.

## Fix Cameras

**1**

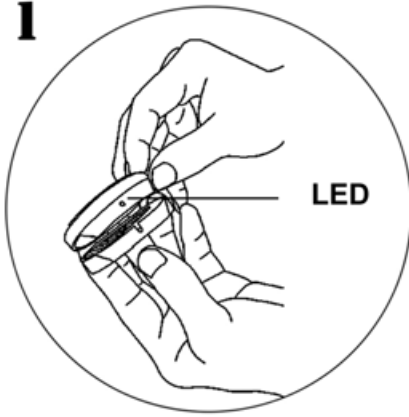

**2**

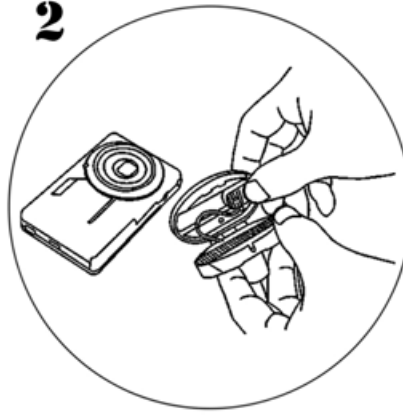

**3**

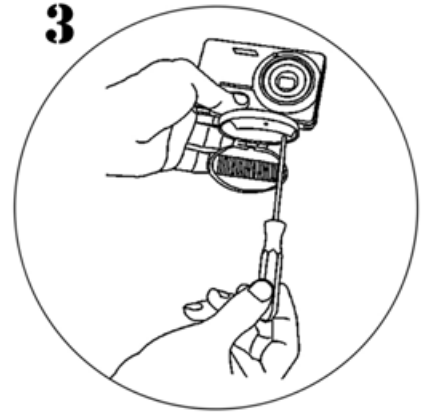

**4**

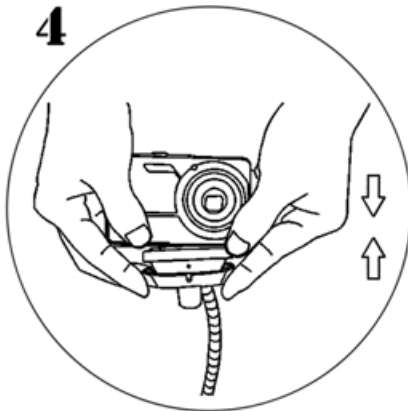

**5**



- 1** Open the camera cradle
- 2** Adjust the screw-fixture to fit for camera
- 3** Tighten the screw with screwdriver
- 4** lock the cradle (pay attention not to damage the LED light)
- 5** The camera will be installed correctly on the display showcase.

## Indication Light under different conditions

**1**



After first installation, the LED will have a red blink at the moment the stand is fixed on the display showcase.

**2**



LED blink in blue under normal work condition.

**3**

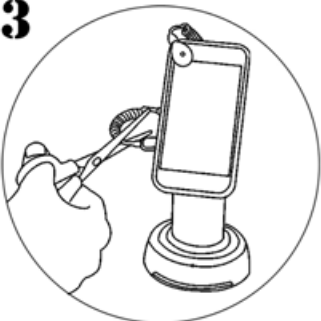

LED blink in blue rapidly when the security stand alarms.



## Operation of Password enabled remote control

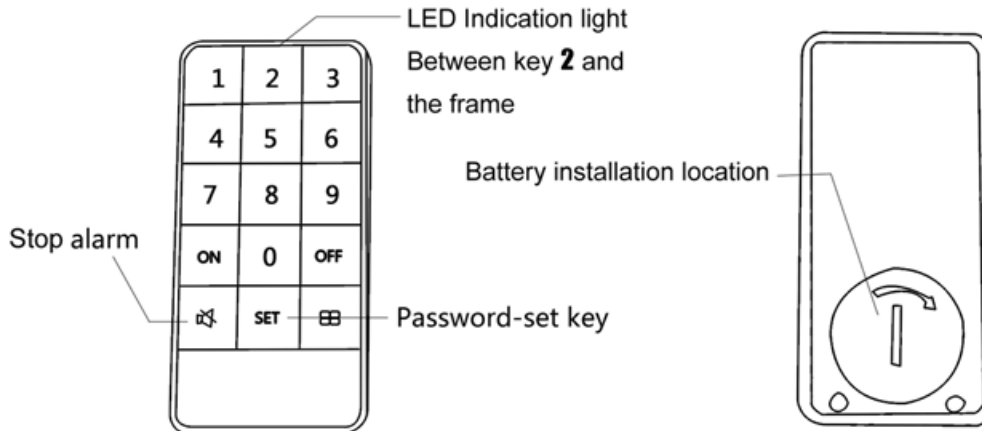

### Operation steps

Set Password: Press SET + password + password + SET. LED indication light will have a blink after pressing the second SET.

Set password 1234 for example, please press "SET+1234+1234+SET" .

1. Turn on the device: First put or paste the stand onto the table, confirming the bottom security contact fully contacting with the table; then press ON.
2. Stop Alarm: Stop the alarm by pressing the mute key when the device alarms. Then the device will be back into the working condition again.
3. Turn off: Trigger the device to alarm and press OFF. The device isn't under work condition.
4. Modify the password
  - (1) Trigger the device to alarm
  - (2) Turn off the device
  - (3) Set new password, see step 1
  - (4) Turn on the device, see step 2

### Note

1. Please set a password which is easy to remember. Otherwise the alarming device could not be stopped if the password is forgotten.
2. The LED indication light will have a blink after successfully setting or modifying the password. No blink means new password isn't activated.
3. If the remote control is missing, please use new remote control, setting the password same as that of the missing remote control. For security purpose, Turning off each device, which under the same remote control, then set a new password according to [operation steps / set password].
4. Please replace the battery if the remote is insensitive or the remote control distance becomes shorter.
5. The password will be lost after remote control running out of battery or during replacing battery .so, please set password same as that set before.
6. If the password is forgotten, to trigger the device alarm three times to set the password automatically to default "0000" .and then set a new password according to [operation steps / set password].

## Operation of Password enabled remote control



**1. Unlock**



**2. Knock**



**3. +Pole outwards**



**4. Lock**

### Replace the battery

1. Press and rotate the battery cover in anti-clockwise direction until you cannot move it.
2. Knock the remote to the desk and get the battery out.
3. Replace the battery with +pole outwards
4. Lock the battery cover

## Remove Stand from showcase

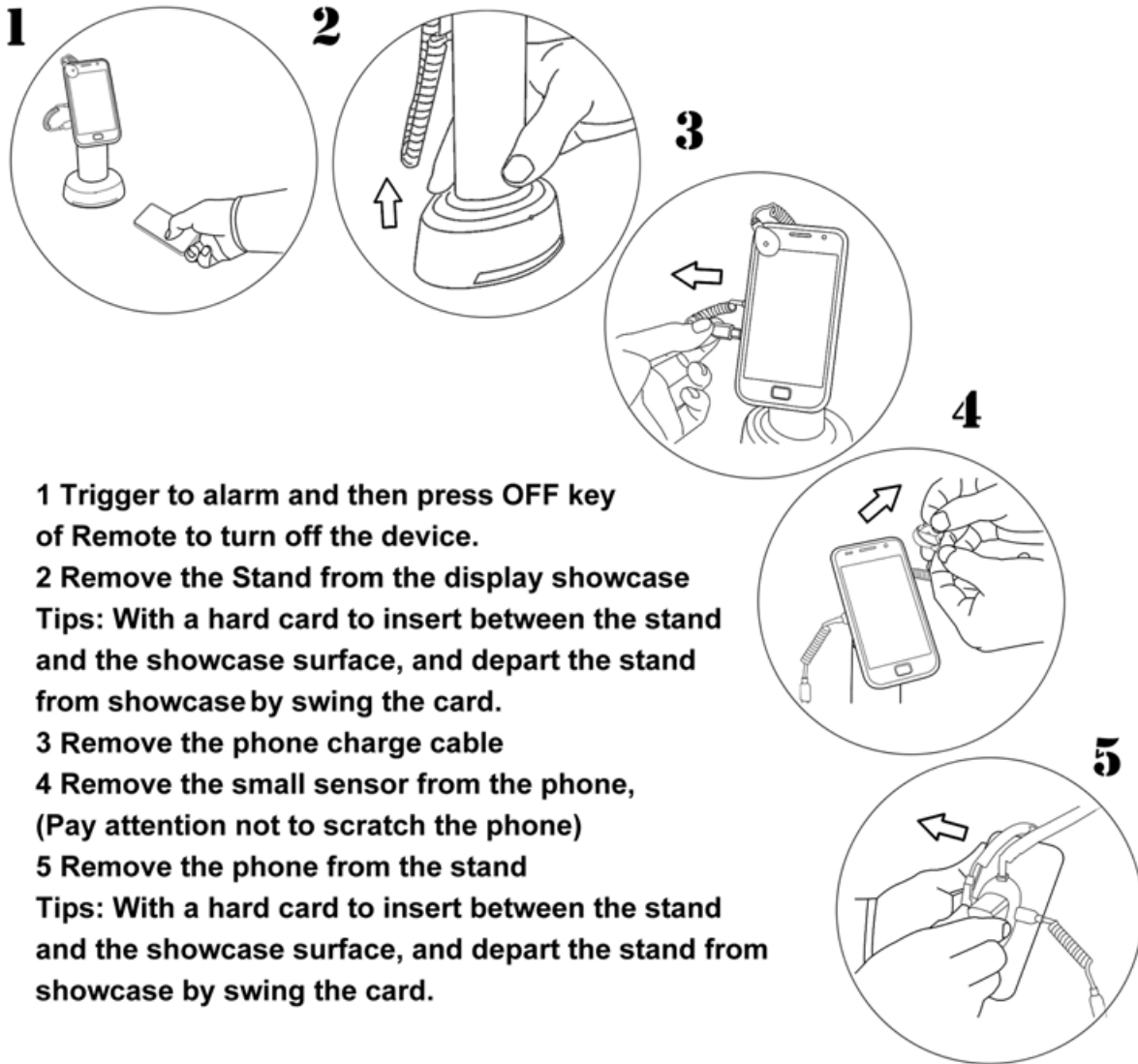

**1** Trigger to alarm and then press OFF key of Remote to turn off the device.

**2** Remove the Stand from the display showcase  
Tips: With a hard card to insert between the stand and the showcase surface, and depart the stand from showcase by swing the card.

**3** Remove the phone charge cable

**4** Remove the small sensor from the phone,  
(Pay attention not to scratch the phone)

**5** Remove the phone from the stand

Tips: With a hard card to insert between the stand and the showcase surface, and depart the stand from showcase by swing the card.

## Specifications

### USAGE

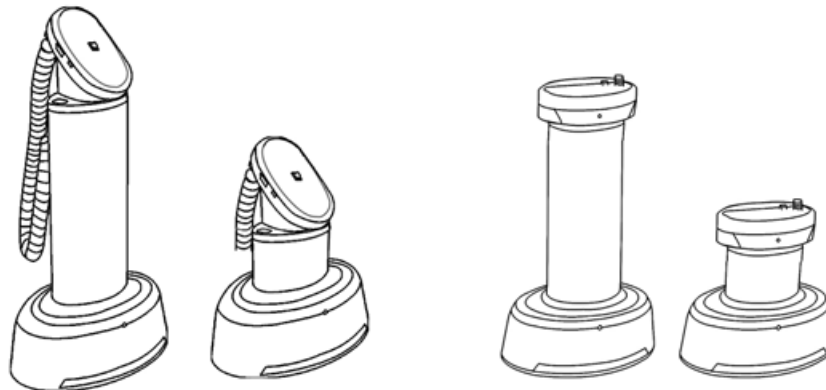

Phone / tablet PC / MP x / PSP / GPS

CAMERA

### SIZE

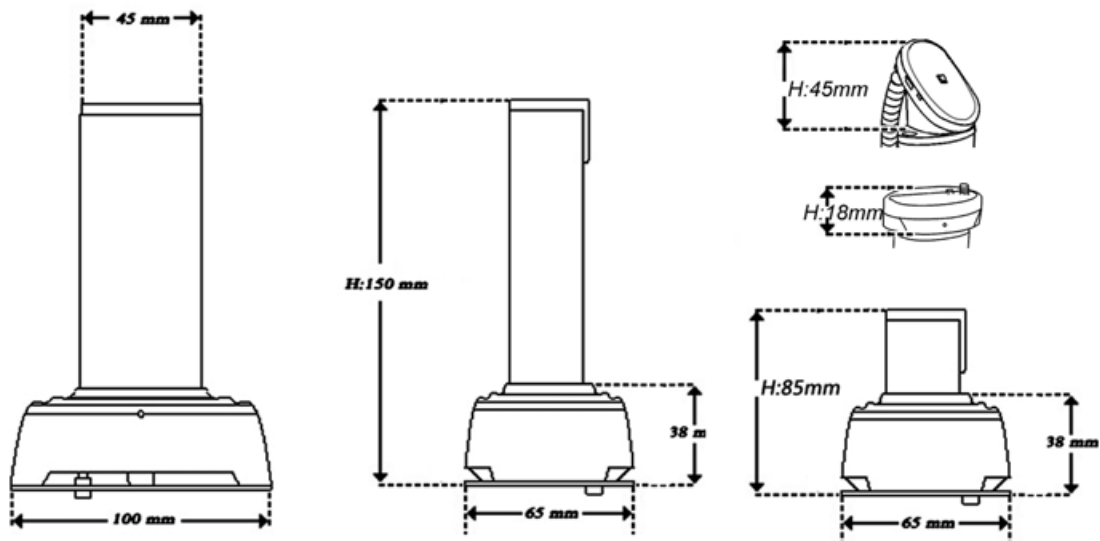

Input Voltage: 110~220V

Adapter: 7V 750mA

Alarm Volume: 100 dB

## **Safety information and cautions**

Please read the following guide carefully to operate the device properly and securely

### **SAFETY WARNINGS**

1. Do not dispose of batteries in a fire as they may explode. Dispose of batteries according to local regulations. Please recycle when possible. Do not dispose as household waste.
2. When using alcohol towel, please keep away from heat sources to avoid the cause of fire.

### **ELECTRONIC DEVICE**

This device is without waterproof protection, when installation should pay attention to the waterproof and moisture-proof. Keep away from the heat sources, and assure the airiness as they may damage the device when overheating.

### **ENVIRONMENTAL PROTECTION**

Please comply with the local regulations regarding packing materials and dispose of discarded materials, please recycle when possible.

### **CARE AND MAINTENANCE**

1. Take routine testing regularly to find troubleshooting in time to guard against the loss because of the malfunction of alarming.
2. Check the battery power regularly to avoid the malfunction of alarming because of low battery.
3. Do not attempt to open the device other than as instructed in this guide.
4. Do not drop and knock the device. Rough handling can break the internal circuit boards and fine mechanics.
5. Use a damp fine cloth to clean the device, do not use harsh chemicals, like alcohol and cleaning solvents to clean.
6. Do not store the device in hot and cold areas. High temperature can shorten the life of electronic device, damage batteries, and warp or melt certain plastics. When the device returns to its normal temperature, moisture can from inside the device and damage electronic circuit boards.

### **CAUTIONS**

1. When alarming please release the device and stop alarming to save power.
2. Keep away from strong interference source, like powerful motor, electric welder, radio transmitter. It can shorten the life of battery.
3. The adhesive is self-adhesive and disposable. Stick it one-time in place.

### **WARM PROMPT**

When alarming, stop it in time. Long time alarming can affect listening and mood.



## FCC Statement

*This equipment has been tested and found to comply with the limits for a Class B digital device, pursuant to part 15 of the FCC Rules. These limits are designed to provide reasonable protection against harmful interference in a residential installation. This equipment generates uses and can radiate radio frequency energy and, if not installed and used in accordance with the instructions, may cause harmful interference to radio communications. However, there is no guarantee that interference will not occur in a particular installation. If this equipment does cause harmful interference to radio or television reception, which can be determined by turning the equipment off and on, the user is encouraged to try to correct the interference by one or more of the following measures:*

*—Reorient or relocate the receiving antenna.*

*—Increase the separation between the equipment and receiver.*

*—Connect the equipment into an outlet on a circuit different from that to which the receiver is connected.*

*—Consult the dealer or an experienced radio/TV technician for help.*

*This equipment complies with Part 15 of the FCC Rules. Operation is subject to the following two conditions:*

*(1) This device may not cause harmful interference, and*

*(2) This device must accept any interference received, including interference that may cause undesired operation.*

## Caution!

*The manufacturer is not responsible for any radio or TV interference caused by unauthorized modifications to this equipment. Such modifications could void the user authority to operate the equipment.*