

Wireless Calculator Keypad

User's Manual



Version: 1.0 2003/05

ID NO: PAK-131W2701-01

Introduction

Congratulations on your purchase of the **WKP-270**. This new wireless keypad combines special Tax, Euro and Currency rate calculating functions. It makes the calculation process more easily and more convenient.

System Requirements

- Microsoft® Windows® 98/Me/2000/XP and MAC OS compatible
- One USB v. 1.1 or 2.0 Compliant Port

Installation

Connection with Windows®98/Me

1. Plug the USB receiver connector to your PC.
2. The Add New Hardware Wizard appears.
3. Click **Next**. The locate driver screen appears.
4. Select “Search for the best driver for your device. (Recommended),” and then click **Next**. The wizard searches for the appropriate device driver.
5. Click **Finish** to complete the driver installation.

You are now ready to begin using your wireless keypad.

Windows 2000/XP Operating System

1. Plug the USB receiver connector to your PC.
2. The Found New Hardware Wizard appears and the OS will install the driver automatically. No other steps are necessary.

You are now ready to begin using your wireless keypad

Using the Wireless Calculator/Keypad

Turning the keypad Off and On

To turn on the keypad, press the CE/AC key, located directly above the number seven key. The keypad starts in calculator mode and displays “0”.

The keypad automatically turns off itself after two minutes of non-operation. Or you can press the CE/AC key for two seconds and it will turn off.

ID setting

Plug the receiver into your notebook’s USB port and turn on the wireless keypad. The LED of the receiver will start flashing. Press the ID button under the keypad, the LED will turn off. It means the ID setting accomplished.

● **Description of the function keys**

Key Functions	Definition
M+	Adds the current display from the content of memory.
M-	Subtracts the current display from the content of memory.
MRC	I. First push, as MR key, transfers the contents of the memory register into the display register. II. Second push, as MC key, clears the memory.
DEC	I. Specifies the number of decimal places for rounding II. In keypad mode, as the TAB function.
+/-	Switches the sign of the displayed value between positive (+) and negative (-).
%	I. Use this key in combination with arithmetic operator keys to perform percent. II. Setting TAX rate.
€	I. Setting Euro rate. II. In keypad mode, can input “€” symbol.

CUR	Setting currency and exchange rate.
$\sqrt{\quad}$	Extracts the square root of a positive number displayed in the entry register.
MODE	Change mode between the calculator and the keypad status.
SEND	Send the calculation result to PC when the device is in calculator mode or in keypad mode.
Fn	Combination key with Tax- and Tax+ function. When you completed the setting of Tax rate, press the Fn key with Tax- or Tax+ key; the calculation result will be changed.
Tax -	Price-less-tax calculation.
Tax +	Price-plus-tax calculation. When Num Off, the input symbol will be “=”.

Special Function:

This new keypad has no synchronized problem; users can use the keypad and inputting characters from a notebook at the same time. Especially, it doesn't need any drivers and fully support Plug & Play.

No matter the Host's Num Lock function status, users can choose the Num Key or direction key on the keypad. When users press the keypad's Num Lock key once, it can change the keypad's Num Lock status. If press the Num Lock key until 0.8 sec, then the Host's Num Lock status will be changed. This function is designed for some special software, like Excel. Users can know the Num Lock status on the screen and don't need to care the keypad's Num Lock status. It makes the method of operation easily.

About the Display

The display shows the number you input, calculation results, and various indicators showing the status of the calculator.

-MINUS	Negative value indicator
MEMORY	Independent memory indicator
ERROR	Error indicator
'	3-digit separator (apostrophe)
CALC	Indicate you are in calculator status
KEYPAD	Indicate you are in keypad status
GT	Grant total
CUR	Price-multiply-CUR calculation
EURO	Price-multiply -CURO calculation

Rounding Selector & Decimal Place Selector

➤ Rounding Selector

Specified the rounding system

F	Floating decimal point system, which displays the value without rounding.
0,2,4	Number of decimal places for the 5/4 setting of the Rounding Selector.
A	The “Add Mode” automatically adds a decimal point and two decimal places to all values, even if you don’t input a decimal point. This mode is very useful when performing calculations in dollars or other monetary systems that require two decimal places. Two decimal places are not added in this mode if you press the DEL key while inputting a value, or for any operation other than addition and subtraction.

Setting EURO and CUR Function

CUR and €: Press CUR or € key for 1~1.5 sec, the “CUR” or “Euro” indicator on the LCD will start flashing. Input your desire parameter then press CUR or € key again. The “CUR” or “Euro” indicator will disappear; it means the setting is accomplished.

When LCD displays “0”, you can press the “CUR” and “Euro” to enable or disable the indicator on the LCD. When the numerals

display on the LCD. Press the “CUR” or “Euro” button, and then it will exchange to the currency or tax rate.

For example : Supposing the CUR parameter is 34 and the Euro parameter is 105; the calculation result is 180.

The “CUR” or “Euro” indicator display on the LCD: Press CUR key, then the calculate result will be 6120 (180×34). Press Euro key, then the calculation result will be 18900 (180×105).

The “CUR” or “Euro” indicator didn’t display on the LCD: Press CUR key, then the calculate result will be 5.29 ($180/34$). Press Euro key, then the calculation result will be 1.17 ($180/105$).

Setting Tax Function:

Press “%” key for 1~1.5 sec, the “TAX” indicator on the LCD will start flashing. Input your desire parameter then press “%” key again. The “TAX” indicator will disappear; it means the setting is accomplished.

For example : Supposing the Tax parameter is 10 and the calculation result is 180.

Press Fn & Tax+ key, then the calculate result will be 198($180 \times (1+0.1)$).

Press Fn & Tax- key, then the calculate result will be 162 ($180/(1+0.1)$)

Rechargeable and Extendable cable

This addition cable can use for two ways. One is for rechargeable cable and the other is for extendable cable.

- For rechargeable:**
1. Pull out the mini USB plug and the USB connector into two different directions as the graphic shows. And extend the cable to the desired length.
 2. Plug the mini USB plug into the keypad and plug the USB connector to your Notebook.

- For extendable(Choose):**
1. Pull out the mini USB plug and the USB connector into two different directions as the graphic shows. And extend the cable to the desired length.
 2. Using the adapter to the Mini USB and plug the connector to your Notebook and receiver.

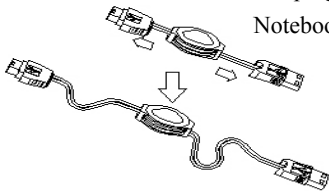

Specification of WKP-270

Operation Force	60±15gm
Weight	150gm
Total Travel	2.2 mm
Operation Frequency	27 MHz/ 1 communication channel/ 1.5M distance
Battery type	1 * AAA Rechargeable battery
Dimension: L×W×H	136×75×21.95mm
Receiver Connector	USB
Power consumption	TX Working mode: 6mA max Suspend mode: <100 uA RX Working mode: 16mA max Suspend mode: <500uA
Switch Life	8 million cycles
Keycaps type	Low profile
Agency Approvals	FCC, CE

Troubleshooting

When you turn on the keypad, if the keypad's LCD shows abnormal or nothing, check your battery first. If the battery is working fine, try to find an acicular metal and plug into the reset hole (in the back of the keypad). Then the keypad will work normally. If the problem was still unsolved, please contact the technical support.

FEDERAL COMMUNICATIONS COMMISSION STATEMENT

Notice 1

You are cautioned that changes or modifications not expressly approved by the part responsible for compliance could void the user's authority to operate the equipment.

Notice 2

This equipment has been tested and found to comply with the limits for a Class B digital device, pursuant to part 15 of the FCC rules. These limits are designed to provide reasonable protection against harmful interference in a residential installation. This equipment generates, uses and can radiate radio frequency energy and, if not installed and used in accordance with the instructions, may cause harmful interference to radio communications.