

Bluetooth® Remote Control & Touchpad User's Manual

About This Manual

This manual is designed to assist you in installing and using the Bluetooth® touchpad. Information in this document has been carefully checked for accuracy; however, no guarantee is given to the correctness of the contents. The information in this document is subject to change without notice.

Edition

1st Edition,

Copyright

© Copyright 2020

This document contains proprietary information protected by copyright. All rights are reserved. No part of this manual may be reproduced by any mechanical, electronic or other means, in any form, without prior written permission of the manufacturer.

Trademarks

All trademarks and registered trademarks are the property of their respective owners.

FEDERAL COMMUNICATIONS COMMISSION STATEMENT

This device complies with FCC Rules Part 15. Operation is subject to the following two conditions:

- This device may not cause harmful interference.
- This device must accept any interference received, including interference that may cause undesired operation.

This equipment has been tested and found to comply with the limits for a class B digital device, pursuant to Part 15 of the Federal

Communications Commission (FCC) rules. These limits are designed to provide reasonable protection against harmful interference in a residential installation. This equipment generates, uses, and can radiate radio frequency energy and, if not installed and used in accordance with the instructions, may cause harmful interference to radio communications. However, there is no guarantee that interference will not occur in a particular installation. If this equipment causes harmful interference to radio or television reception, which can be determined by turning the equipment off and on, the user is encouraged to try to correct the interference by doing one or more of the following measures:

- Reorient or relocate the receiving antenna.
 - Increase the separation between the equipment and receiver.
 - Connect the equipment into an outlet on a circuit different from that to which the receiver is connected.
 - Consult the dealer or an experienced radio/TV technician for help.
- FCC Caution

Any changes or modifications not expressly approved by the party responsible for compliance could void the user's authority to operate the equipment.

The antenna(s) used for this transmitter must not be co-located or operating in conjunction with any other antenna or transmitter.

Radiation Exposure Statement:

This equipment complies with FCC radiation exposure limits set forth for an uncontrolled environment. End users must follow the specific operating instructions for satisfying RF exposure compliance. To maintain compliance with FCC exposure compliance requirement, please follow operation instruction as documented in this manual

Introduction

Thank you for purchasing the Bluetooth Remote Control & Touchpad. This User's Manual contains information that will help to operate the device as well as answering questions about certain special keys and buttons. Please keep this manual in a safe place for future reference.

System Requirements:

- iOS / Android OS / Mac OS / Windows OS
- Bluetooth 3.0 or higher

Package includes:

Bluetooth Remote Control & Touchpad * 1
USB-C to USB-A charging cable * 1
Manual * 1

Note:

There is a power switch under the Bluetooth Remote Control & Touchpad. When not in use, please turn to OFF to save battery power.

Technical Specifications:

Logo Name	Bluetooth Remote Controller
Bluetooth chip	CYPRESS : CYW20730 A2
Bluetooth Technology meets	V5.1
SIG DID No	D051804
Operation distance	10 meters
Output power	Bluetooth Power Class 2
Battery Capacity	Li-ion battery 160 mA
Operating Voltage	3.3-4.2 V
Power Consumption	Working: under Touchpad < 10 mA Sleep: under < 100 uA
Charging Time	about 1.5 - 2 hrs
Weight	35 g
Dimension	123.5 x 40 x 8 mm

Appearance Function Description:

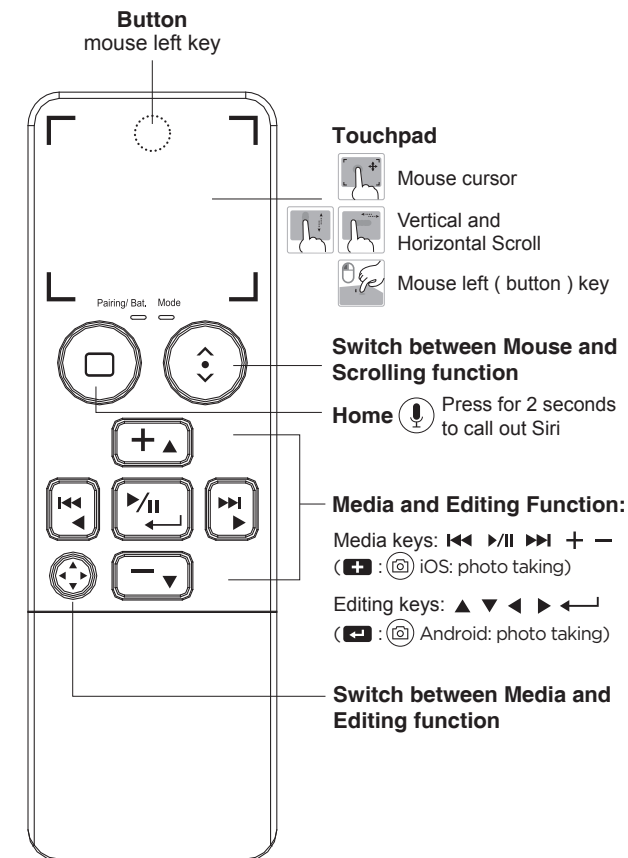

Bluetooth Pairing:

- Turn on the power, and press ID key to enter pairing mode.

USB TypeC charging port

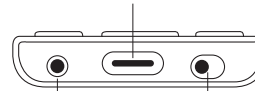

Pairing ID Power switch
(green bottom = on)

- Pairing blue light flashes.

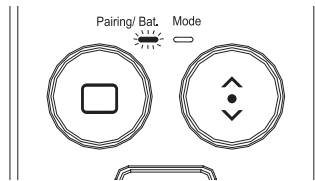

PS: Pairing will stop when not paired, if needed, press ID key for pairing again.

- Turn on Bluetooth from iPad / iPhone / MacBook / PC

- Search device

- Select "Bluetooth Remote Controller".

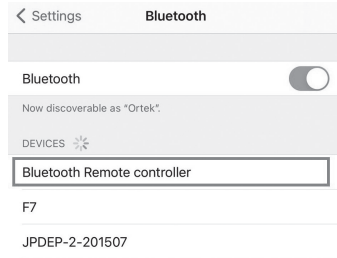

- Pairing complete.



Key Function Description:

	Function
	Go Home For iPad series w/o Home key, Siri can be called out by pressing for 2 seconds
	Switch Mouse cursor and Mouse Scroll function
	Media: V+/iOS: photo taking Edit: Upwards
	Media: V- Edit: Downwards
	Media: Pre-track Edit: Leftwards
	Media: Next track Edit: Rightwards
	Media: Play/Pause Edit: Enter/Android: photo taking
	Switch Media and Edit function

Touchpad Description:

Mouse Cursor	Function
	Button
	Tap
	Mouse Cursor
Mouse Scroll	Function
	Finger slides vertically
	Finger slides horizontally

LED Lights:

Action	Features	Pairing/ Bat. LED 1	Mode LED 2
ID Key	Pairing	Slow flashing Blue light	×
Low Battery	3.2v-3.3v	Fast flashing Blue light	×
Power on	Power ON	Blue light flashes 1s	Blue light flashes 1s
	Pairing OK	×	×
	Linking NG	Blue light flashes and out	Red light flashes and out
USB TypeC Charging	Charging	Constant Red light	×
	Fully Charged	Red light out	
Button	Scroll Mode	×	Constant Blue light
Button	Edit Mode	×	Constant Red light

OS Switching Steps:

Press and hold and , turn on Power, the LED light will be on.



Press or to switch the right LED for:
1. No light, 2. Blue light, and
3. Red light, for different OS.



Press for OS switching completion.

	Pairing/Bat.		Mode	
iOS & Android		Blue	×	
Mac OS		Blue		Blue
Windows OS		Blue		Red

Note:

- After 5 minutes of non-operating, the Bluetooth Remote Controller will go to sleep mode. Press any key or touchpad to wake up Bluetooth.
- When Power Switch turns to ON, both Blue lights will be on and then off after 1 second.
- Battery low: Pair LED Blue light shows fast flashing.
- Charging: Pair LED Red light on. (Lights are out after fully charged.)



ID NO: PAKL-F31BR304-00