

## EXHIBIT 10. FCC ID LABEL & SKETCH OF LABEL LOCATION

### ULTRATECH GROUP OF LABS

3000 Bristol Circle, Oakville, Ontario, Canada L6H 6G4

Tel. #: 905-829-1570, Fax. #: 905-829-8050, Email: [yhk.ultratech@sympatico.ca](mailto:yhk.ultratech@sympatico.ca), Website: <http://www.ultratech-labs.com>

File #: TEK-197FTX  
Sep. 21, 1999

- Assessed by ITI (UK) Competent Body, NVLAP (USA) Accreditation Body & ACA/AUSTEL (Australia)
- Recognized/Listed by FCC (USA), Industry Canada (Canada)
- *All test results contained in this engineering test report are traceable to National Institute of Standards and Technology (NIST)*

**NOTES:**

1. Material - .005" thickness, computer imprintable white mylar with mat lamination
2. Graphics & lettering to appear as per a/w on file 20599-062a.pdf (from TEKLOGIX).
3. Labels to be supplied on an 8.5 x 11 release liner.
4. Rear surface to be pressure sensitive V23 acrylic adhesive coated with release paper backing, adhesive to be compatible with polycarbonate/polyester blend plastic (Bayer Makroblend UT403) material over a temperature range of -40 to +125 deg. C.

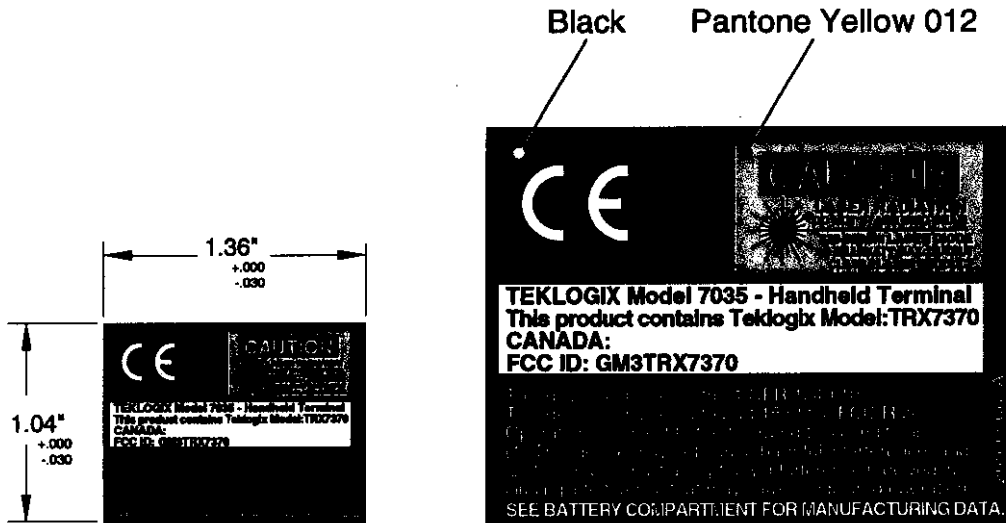

Actual Size

ECO Date	SIGNATURES	DATE	<b>TEKLOGIX</b> Mississauga, Ontario Canada  LBL US/CA 7035 7370 NB 4L WS	Dwg No.
	DRAWN David Madrick	99.09.20		20599-062
	CHKD APPVD			REV. A
	PROJ. SPEC./ PROD. ENG. <i>[Signature]</i>	99.09.21		Sheet 1 of 1
	MECH. ENG.			
	REGULATORY			



**NOTES:**

1. Material - .002" thickness, computer imprintable white mylar with clear matte lamination on front (.001").
2. Graphics & lettering to appear white and background to appear black as per a/w on file 21500-025a.pdf (from TEKLOGIX).
3. Labels to be supplied on an 8.5 x 11 release liner
4. Labels to be supplied with adhesive back & adhesive must be compatible with textured baked enamel paint.
5. Adhesive must not separate from -30 to +70 deg.C @ 0 to 100% R.H.

<b>SIGNATURES</b>		<b>DATE</b>	<b>TEKLOGIX</b> Mississauga, Ontario Canada
DRAWN	David Madrick	99.09.20	
CHKD		APPVD	LBL US/CA 8255/60 7370 NB (4L)
PROJ. SPEC/ PROD. ENG.			
MECH. ENG.			
REGULATORY			
ECO			Dwg No. <b>21500-025</b>
Date			REV. A Sheet 1 of 1

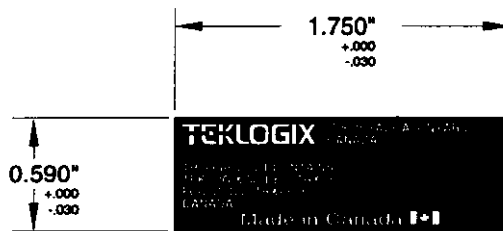

**NOTES:**

1. Material - .005" thickness, computer imprintable white mylar with clear matte lamination.
2. Graphics & lettering to appear as per a/w on file 30207-047a.pdf (from TEKLOGIX).
3. Labels to be supplied on an 8.5 x 11 release liner
4. Labels to be supplied with adhesive back & adhesive must be compatible with textured polyurethane paint.
5. Adhesive must not separate from -30 to +70 deg.C @ 0 to 100% R.H.

		<b>SIGNATURES</b>	<b>DATE</b>	<b>TEKLOGIX</b> Mississauga, Ontario Canada	
		DRAWN David Madrick	99.09.20		
		CHKD APPVD		LBL US/CA 9150 7370 NB 4L	REV. A
		PROJ. SPEC/ PROD. ENG.			Sheet 1 of 1
		MECH. ENG.			
ECO	Date	REGULATORY			

NOTES:

1. Material - .002" thickness, computer imprintable white mylar with matte lamination (.001").
2. Background to appear white as per a/w file 17804C.ai (from TEKLOGIX)
3. Graphics & lettering to appear black as per a/w 17804C.ai.
4. Labels to be supplied on an 8.5 x 11 release liner.
5. Labels to be supplied with adhesive back and adhesive must be compatible with semi gloss, medium textured enamel paint and textured polycarbonates.
6. Adhesive must not separate from -30°C to +70°C @ 0 to 100% R.H.
7. Material and adhesive must be electrically non-conductive.

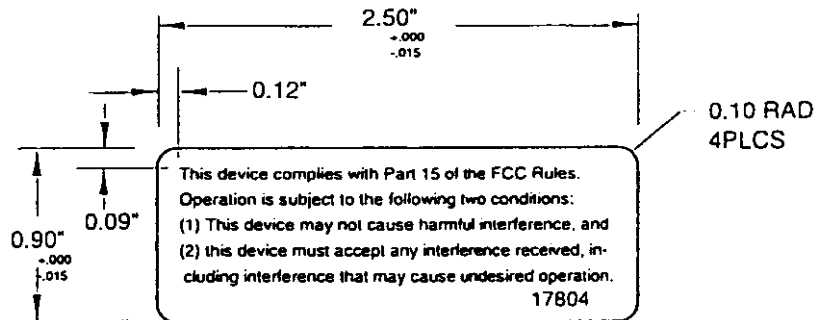

ERN No.      Date	SIGNATURES		DATE	<b>TEKLOGIX</b> 1331 Crestfawn Drive, Mississauga, Ontario Canada	Dwg No. 17804 REV. C Sheet 1 of 1
	DRAWN	L.Szawiola	24/8/94		
	CHKD.	APPVD.		Label, F.C.C. 7410 Radio VERIFICATION	
	PROJ. ENG.				
	OTHER				

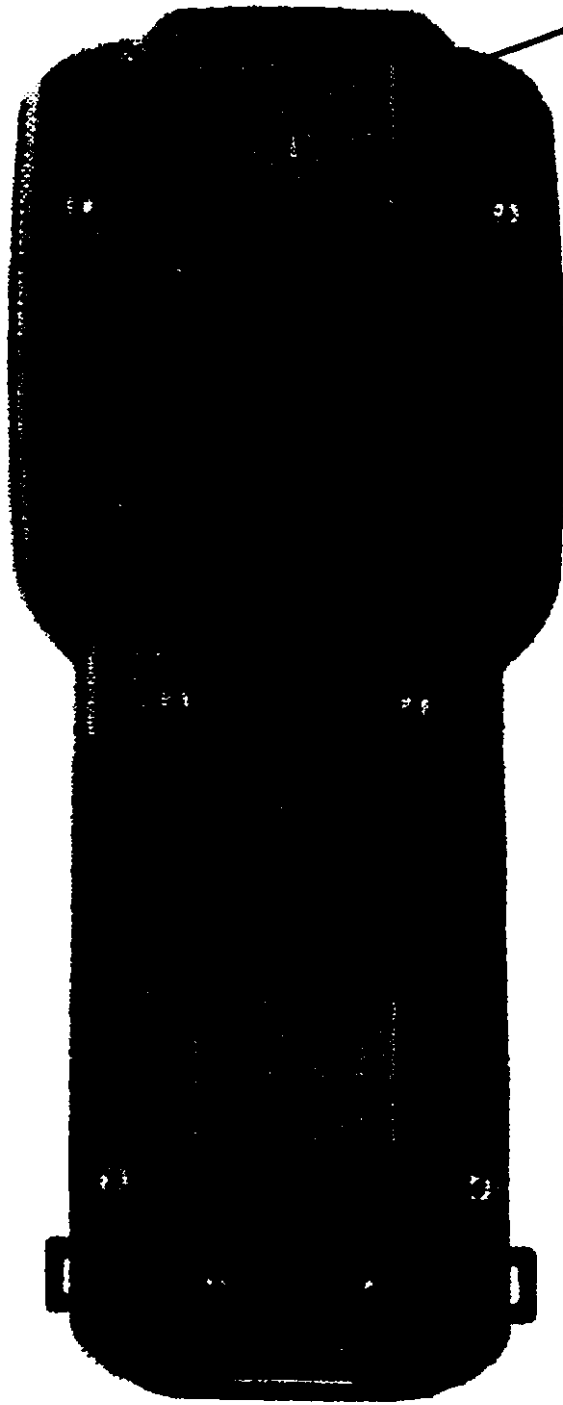

FCC LABEL  
# 20599-062

REAR VIEW OF 7035

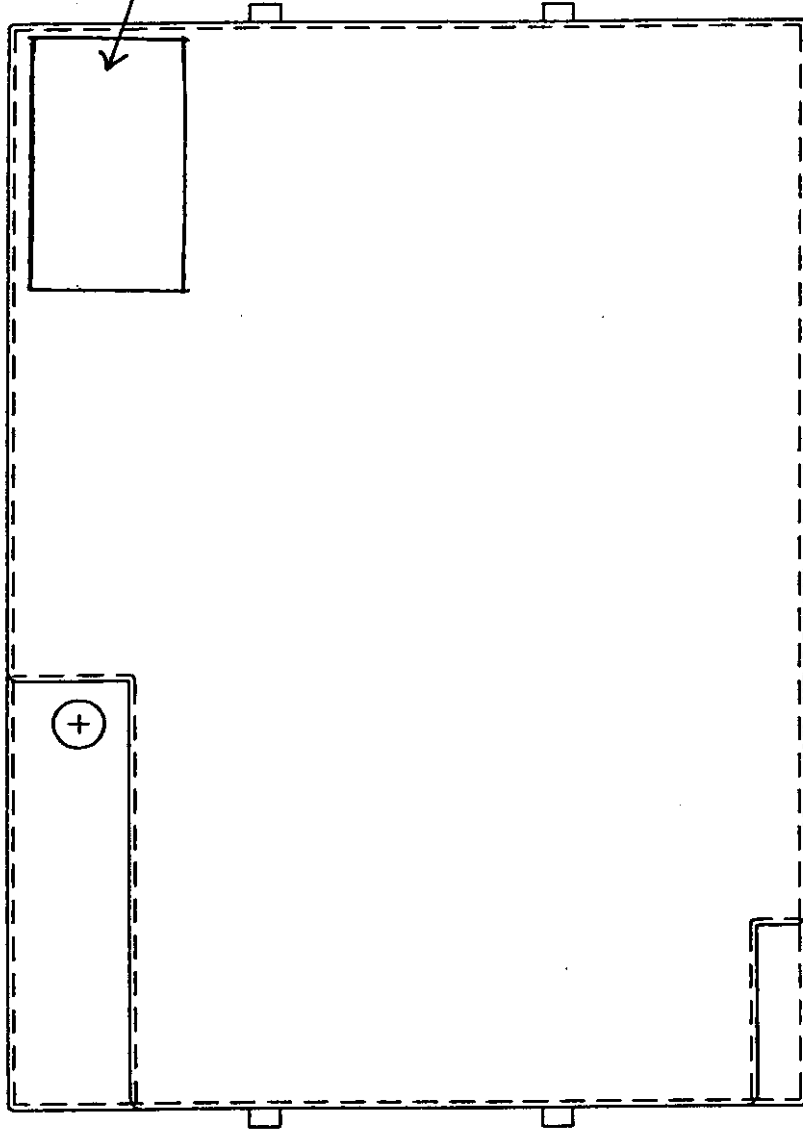

FCC LABEL  
# 21500-025

REAR VIEW OF 8255

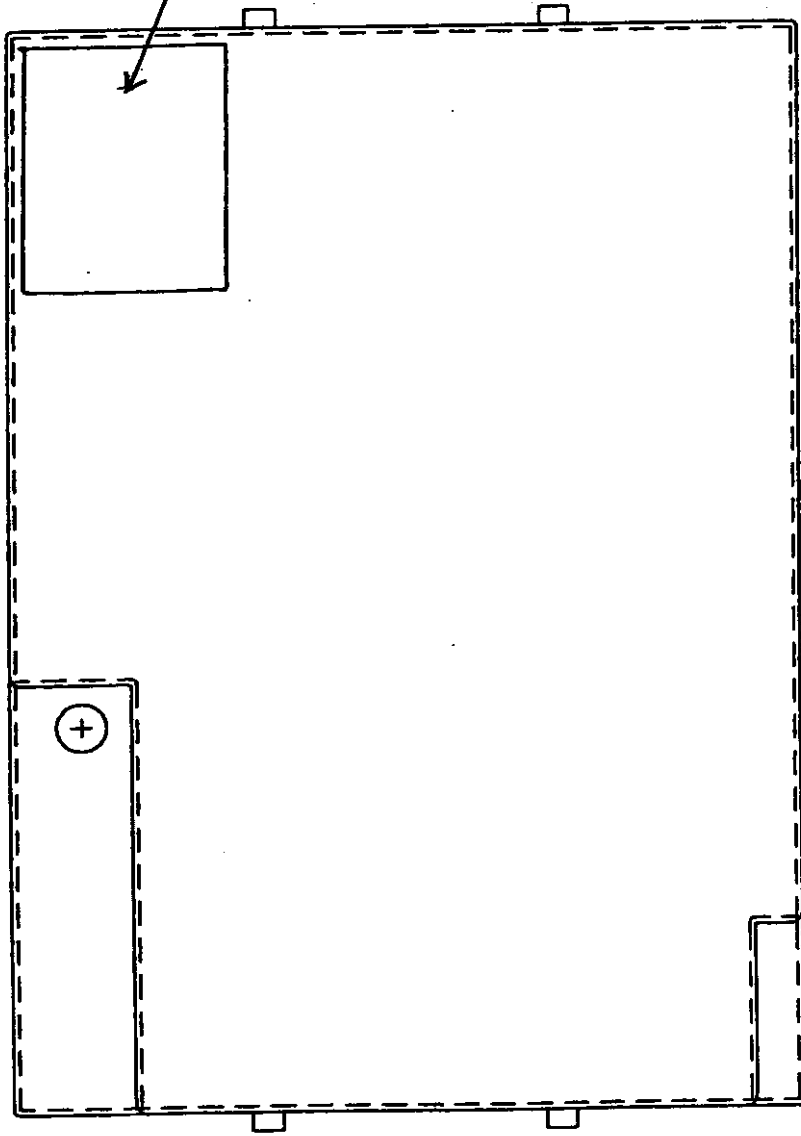

FCC LABEL  
# 21500-025

REAR VIEW OF 82-60



REF. ASSY., M.L.B. P/N 30183-001

DETAIL E  
MAIN LOGIC BOARD/CONNECTOR PLATE

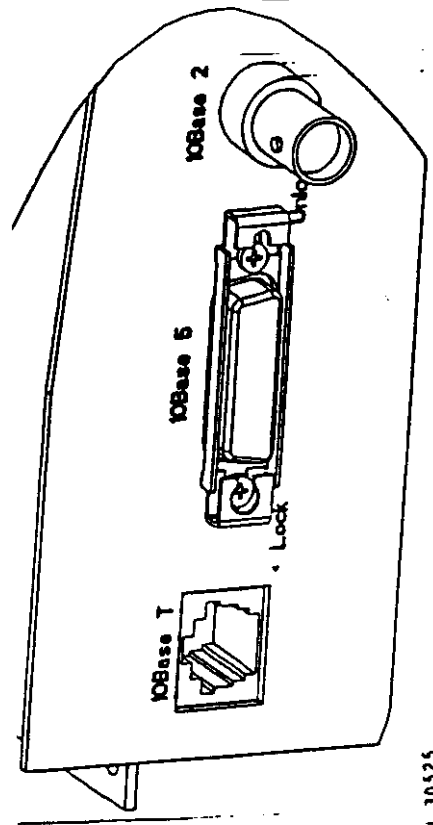

5 P/N 30525

KIT, SCREWLOCK P/N 90824 (2 PLCS.)

DETAIL F  
SCALE 2.000  
SLIDE LATCH ORIENTATION  
SHOWN IN UNLOCKED POSITION

21 REF. LABEL  
ETHERNET ADDRESS  
(SUPPLIED  
WITH M.L.B.)

21 REF. LABEL, P/N 17804  
(NORTH AMERICA ONLY)  
FCC LABEL OF TWO CONDITIONS  
#17804

21 REF. LABEL, 9150 COUNTRY  
FCC ID LABEL  
#30207-047

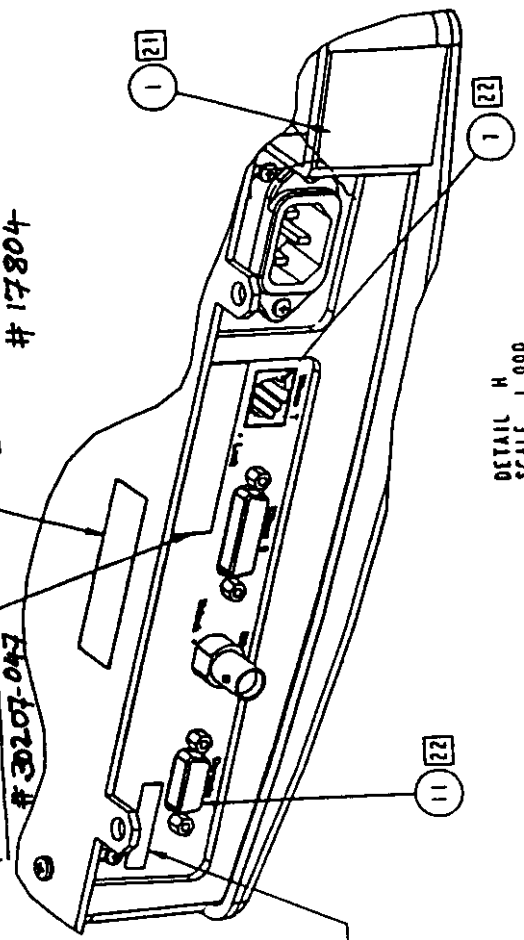

DETAIL H  
SCALE 1.000

REF. CONNECTOR PLATE P/N 30186-003

REF. ASSY., M.L.B. P/N 30183

REF. P/R 30211-001

THIS DRAWING IS GENERATED FROM 'PRO/ENGINEER' RELEASE 17.  
ALL FUTURE UPDATES SHALL BE INCORPORATED TO BOTH 2-D DRAWING AND 3-D DATABASE.

**TEKLOGIX**  
MISSISSAUGA, ONTARIO

ASSY., 9150  
SINGLE RADIO, S.S.

UNLESS OTHERWISE SPECIFIED: DIMENSIONS ARE IN INCHES	SIGNATURES D. TAYLOR	DATE REVISION
DESIGNED BY	DATE	
CHECKED BY	DATE	
APPROVED BY	DATE	
SCALE	DO NOT SCALE DRAWING	

CODE	INSTR NO	SIZE	DRAWING NO.	REV.
	38481	D	30202-001	A
SCALE			SHEET	
			3 OF 3	

ECO DATE