

REVISIONS			
REV	DESCRIPTION	SIGNATURE AND DATE	
		CHK	ENGR

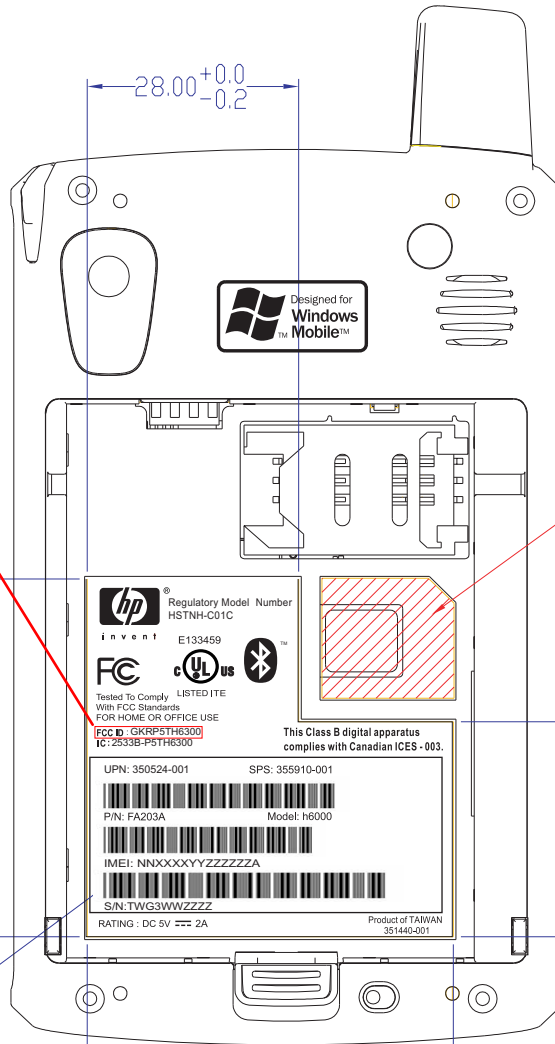

FCC ID

Tamper Label

Rating Label size

28.00<sup>+0.0</sup><sub>-0.2</sub>

47.40<sup>0.0</sup><sub>0.2</sub>

28.50<sup>+0.0</sup><sub>-0.2</sub>

48.50<sup>+0.0</sup><sub>-0.2</sub>

Regulatory Model Number HSTNH-C01C  
 invent E133459  
 FC cULus Bluetooth  
 Tested To Comply With FCC Standards FOR HOME OR OFFICE USE LISTED ITE  
 FCC ID: GKRPS1F6300 IC: 2335B-F51H6300 This Class B digital apparatus complies with Canadian ICES - 003.  
 UPN: 350524-001 SPS: 355910-001  
 P/N: FA203A Model: h6000  
 IMEI: NNXXXXYYZZZZZA  
 S/N: TWG3WWZZZZ  
 RATING: DC 5V 2A Product of TAIWAN 351440-001

MODEL: P5T			PARTNO. EJ4T00P0000			REMARK	
SCALE	1:1	UNIT	mm	SIGNATURE	DATE	<b>Compal Electronics, Inc.</b> TITLE <b>P5T Battery Rating label</b>	
TOL.	1PLC	2PLC	ANGLE	DRNBY. StacyLo	01/07-04*		
MATERIAL:				PRJ ENGP			
				ENGR APPO		DRAWINGNO. P5T-PDA RATING Label/	
FINISH:				SIZE A4	SHEET OF 1	REV 7	

Note :

THIS SHEET OF ENGINEERING DRAWING IS THE PROPRIETARY PROPERTY OF COMPAL ELECTRONICS, INC. AND CONTAINS CONFIDENTIAL AND TRADE SECRET INFORMATION. THIS SHEET MAY NOT BE TRANSFERRED FROM THE CUSTODY OF THE COMPETENT DIVISION OR R&D DEPARTMENT EXCEPT AS AUTHORIZED BY COMPAL ELECTRONICS, INC. NEITHER THIS SHEET NOR THE INFORMATION IT CONTAINS MAY BE USED BY OR DISCLOSED TO ANY THIRD PARTY WITHOUT PRIOR WRITTEN PERMISSION OF COMPAL ELECTRONICS, INC.