

# User Quick Setup

## VOICE HUB GATEWAY

Model: DBX81



## Specification

Memory	DDR3L 1GB-1600MHz
Storage	eMMC 8GB/16GB(Typical 8GB)
Audio	Speaker 5W
	MEMS Microphone: D-Mic x 4
I/O	DCIN
	USB 2.0
Communication	WiFi 802.11 a/b/g/n/ac BT
	ZigBee (Option)
Dimension	71.55 mm x 84.9~134.4 mm
Power supply	100~240V, DC-Out 12V@1A

## How to use App:

### 1] Settings page

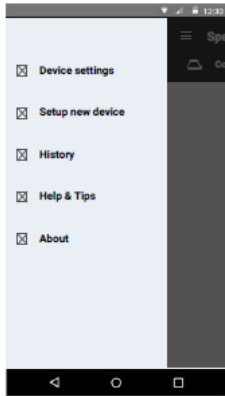

Connecting Wi-Fi network → Setting your password  
→ Setup finished → Account sign in

### 2] Main screen operation

#### 1) Default screen



## 2) Connected device list

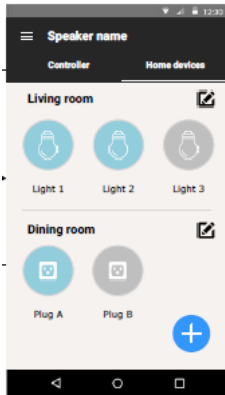

## 3) Time setting

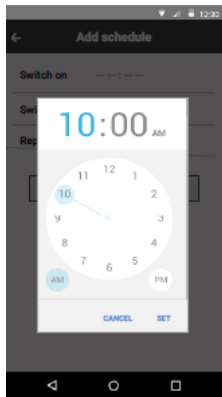



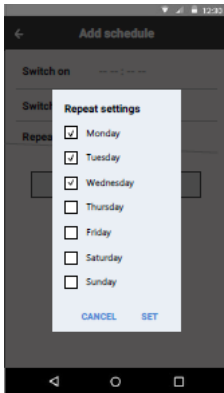
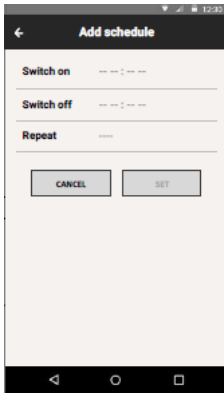

#### 4) Add schedule



### 3]Light device:

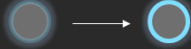

-  **AP mode (try to connecting)**  
Amber continuous light
-  **RF connection abort**  
Continuous oscillating light (100% brightness)

- **Launch Voice assist** 
  -  \* Blue (0~100% brightness) Continuous lighting
- **Cortana is active & search**
  -  \* Blue spinning clockwise in low speed till command done
- **Cortana is responding**
  -  \* Blue breathing till done

## **Warnings**

**For regulatory and safety notices refer to the product notices included with your product.**

**在 5.25G~5.35G 在頻帶內操作之無線資訊傳輸設備僅適於室內使用**

**Wireless Lan 802.11 devices/Bluetooth devices/short-range devices**

**電波法により 5GHz (W52, W53)帯は屋内使用**

**に限ります; 電波法により 5150 ~ 5350 MHz**

**の周波数範は屋内使用に限ります**

**The device is restricted to indoor use only when operating in the 5150 to 5350 MHz frequency range. 5GHz (W52, W53): Indoor Use Only**

