

# Vehicle

## Vehicle Assembly

Vehicle is shipped in 3 separate pieces. Follow the steps below to assemble.

1. Locate the long tube.
2. Align the tube with the hole in the Transporter Base, as shown.
3. Insert the tube until it is locked into place.
4. Locate the Transporter Dashboard.
5. Align the hole on the underside of the Dashboard with the tube.
6. Press down firmly until the Dashboard is in place.

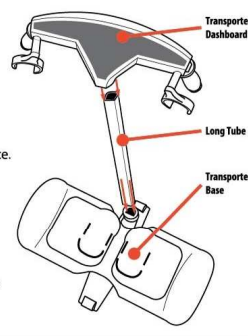

## Cautions & Care

### PROPER USE AND CARE

Wipe with soft rag or cloth.  
Do not use chemicals or water to clean.  
Brush areas where dirt gets trapped.  
Switch vehicle to OFF when not in use.

Do not leave out in the sun.  
Do not run into hard objects.  
Do not drive on sand.  
Do not get wet.

### CAUTION!

Do not recharge Internal Battery if vehicle is hot or warm to the touch. Allow Battery to cool before recharging. Recharging a hot or warm Battery will shorten the life of the unit.  
Do not recharge the Internal Battery if it appears to be damaged or leaking.  
Always store charging cord in storage compartment when not in use.  
Do not dispose batteries in fire. Leakage, explosion and personal injury may occur.  
Do not attempt to disassemble or remove Internal Battery or charging cord.  
Only an adult should charge Batteries.  
Do not attempt jumps or tricks with this vehicle.

# Support

## Trouble Shooting

### Problem - Vehicle does not move or moves slowly.

- Has the rechargeable Internal Battery been fully charged?
- Make certain there are fresh alkaline batteries in the transmitter and that they have been installed in the correct position.
- Are the (+) and (-) markings on the alkaline batteries in the same position as the (+) and (-) markings in the Transmitter Battery Compartment?
- Make certain that the vehicle ON/OFF switch is in the "ON" position.

### Problem - Vehicle moves by itself or exhibits reduced range from the transmitter.

- Make certain there is no outside radio interference in your area. The best way to test this is to take the vehicle as far away from radio towers, electrical lines or tall buildings as possible to ensure no further radio interference will occur.

Contact New Bright Industries Customer Service Toll Free at:  
1-877-NBI-TOYS  
(1-877-624-8697)  
Monday through Friday, 8:00 AM to 5:00 PM Eastern Time

U.S. Toy Sales and Marketing Co., Inc.  
30260 Oak Creek Drive - 2nd Floor  
Wisconsin WI 48393  
1-877-624-8697  
http://www.newbright.com/

### FCC CAUTION:

Changes or modifications not expressly approved by the party responsible for compliance could void the user's authority to operate the equipment.

**NOTE:** This equipment has been tested and found to comply with the limits for a Class B digital device, pursuant to Part 15 of the FCC Rules. These limits are designed to provide reasonable protection against harmful interference in a residential installation. This equipment generates, uses and can radiate radio frequency energy and, if not installed and used in accordance with the instructions, may cause harmful interference to radio communications. However, there is no guarantee that interference will not occur in a particular installation. If this equipment does cause harmful interference to radio or television reception, which can be determined by turning the equipment off and on, the user is encouraged to try to correct the interference by one or more of the following measures:

- Reorient or relocate the receiving antenna.
- Increase the separation between the equipment and receiver.
- Connect the equipment into an outlet on a circuit different from that to which the receiver is connected.
- Consult the dealer or an experienced radio/TV technician for help.

# Vehicle

## Vehicle Features

Vehicle has working lights. When vehicle is powered ON, lights will glow Red. When vehicle is in motion the lights will glow Blue. When vehicle stops, lights will glow Red again.

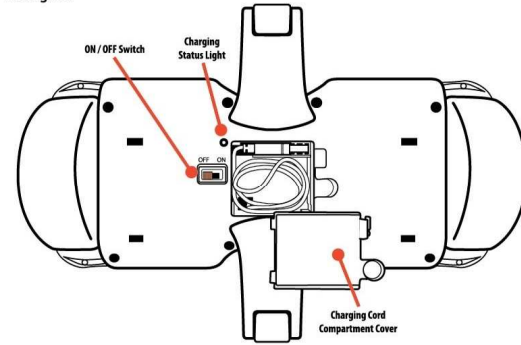

## Recharging the Vehicle

This vehicle is equipped with an internal Lithium-Ion battery that is recharged via USB. ON/OFF Switch must be in the OFF position prior to charging.

1. Locate the Charging Cord Compartment Cover on the underside of vehicle.
2. Open Storage Compartment Cover.
3. Remove USB cable from the Storage Compartment. (Use care when extending cord as it is attached to inside internal battery). Cord can be plugged into any computer or USB outlet brick (not included).
4. Insert the USB connector into a computer or other USB power source.
5. While charging, the Charging Status Light under the vehicle will be on. Once fully charged the light will turn off. Charging is completed in approximately 1.5-2 hours (when charging from a computer).
6. After charging is complete, store the USB cord in the Charging Cord Compartment. Replace the Compartment cover.

# Transmitter

## Installing Batteries & Syncing

Batteries come pre-installed in this transmitter. To ensure the batteries remain fresh, there is a protective tab that must be removed prior to use.

1. To open battery compartment cover, remove the small screw and slide it in the direction indicated by the arrow. Locate and remove protective plastic tab. The tab can be discarded.
2. To replace old batteries, open the compartment as described above. Insert 2 "AA" size batteries. Make sure the positive (+) and negative (-) markings on the batteries match up to the ones inside the Battery Compartment.
3. Replace the Battery Compartment Cover making certain that the Compartment tab has "snapped" into the locked position. Secure cover with screw.

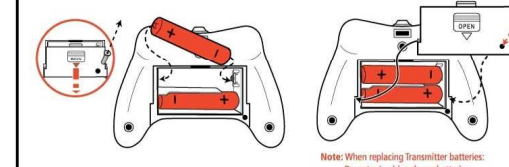

**Note:** When replacing Transmitter batteries:  
Do not mix old and new batteries.  
Do not mix alkaline, standard or rechargeable batteries.  
Use alkaline batteries only.

This transmitter is equipped with 2.4GHz technology which allows up to 6 vehicles to be used at the same time. To sync transmitter and vehicle, follow these steps:

1. Install batteries in Transmitter.
2. Turn on Vehicle.
3. Once the batteries are installed and the vehicle is turned on, the Transmitter will sync automatically with the vehicle.

## How to Drive



Push BOTH joysticks forward for straight Forward Driving.  
Pull BOTH joysticks back for straight Reverse Driving.  
Push LEFT joystick forward to turn right while driving forward.  
Pull LEFT joystick back to turn right in reverse.  
Push RIGHT joystick forward to turn left while driving forward.  
Pull RIGHT joystick back to turn left in reverse.

# APP

## App Download

Additional features and functions are available and require the user to download and install the 'Code Expert' app onto a smart device to access. No charge to download. Data rates may apply.

Download on the App Store  
Apple Users: Search "Code Expert" in the App Store; Install.

ANDROID APP ON Google play  
Android™ Users: Search "Code Expert" in Android Market or Google Play; Install.

## App Set Up

1. Install app to device.
2. Make certain the vehicle is fully charged (See charging instructions in 'Recharging the Vehicle').
3. Move ON/OFF switch to the 'ON' position (See 'Vehicle Features' for Switch location). Vehicle lights will turn on.
4. Vehicle and app communicate via Bluetooth. If Bluetooth is not enabled on your device, you will be prompted to enable.
5. Launch the Code Expert App on your smart device. (If a proper connection has not been made, you will be prompted to repeat steps 2-4).
6. The vehicle and app are now communicating.

### The App features 3 ways to control your vehicle:

1. Select 'Remote Control' for traditional radio control driving using the controller interface on your device. Music, sound and light controls are also available. See instructions in 'Using the App'.
2. Selecting 'Draw Path' allows you to draw a path and have the vehicle travel along that path. Music, sound and light controls are also available. See instructions in 'Using the App'.
3. Selecting 'Code Path' allows you to program each segment of the vehicle's path adding sounds, music, and controlling the lights along the way. See instructions in 'Using the App'.

This device contains license-exempt transmitter(s)/receiver(s) that comply with Innovation, Science and Economic Development Canada's license-exempt RSS(s). Operation is subject to the following two conditions:  
(1) This device may not cause interference.  
(2) This device must accept any interference, including interference that may cause undesired operation of the device.  
REF U01616 JN274-19

# USING the APP

## Home Screen

Below is the App Home Screen. Start by Choosing a Character. When the image of your desired character is displayed you can then select a mode from the 3 mode options on the left.

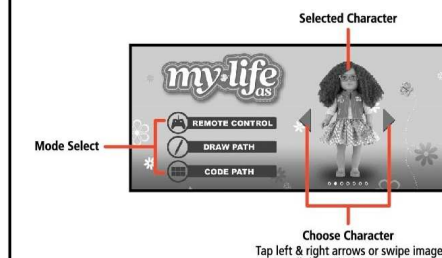

## Remote Control Mode

Remote Control Mode allows you to use your device to control the vehicle in a traditional manner. Mode, Speed, Sound, Light and Music options are available. Refer to the 'More Info' section for details on these options. Features that are unavailable will appear grey on screen.

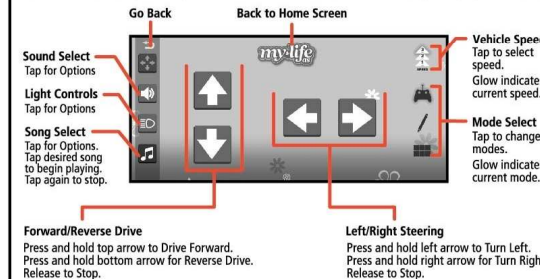

# USING the APP

## Draw Path Mode

Draw Path Mode allows you to use your finger to draw any path on the screen and the vehicle will drive that path. Mode, Speed, Voice, Lights, Music, Save and Load options are also available. Refer to the 'More Info' section for details on these options.

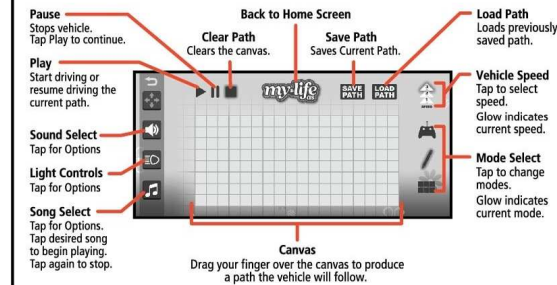

## More Info

Individual menu options are explained below in-depth.

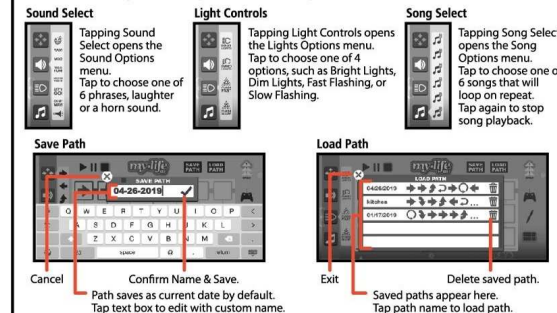

# USING the APP

## Code Path Mode

Code Path Mode allows you to select a sequence of directions that the vehicle will follow. Mode, Speed, Voice, Lights, Music, Save and Load options are available. Refer to the 'More Info' section for details on these options.

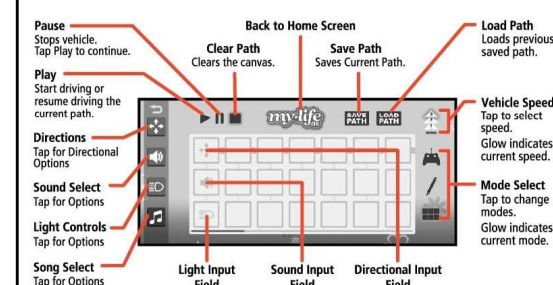

Below is an example of a coded path.

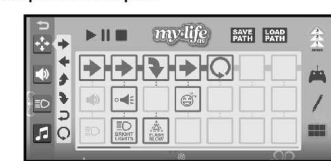

To code a path, tap the Directions Icon to open the Directional Options Menu. Tap or drag and drop desired directions in the Directional Input Field.

Add Sounds by opening the Sound Options Menu and dragging a sound to your desired location in the Sound Input Field.

Open the Light Control Menu and drag the desired option into the Light Input Field to adjust the lights.

To move an item to a different location, tap and hold for 2 seconds, then drag to desired location. To remove an item, tap and hold, then drag it off of the canvas.

Filename: 61610U Eng (274-19) CU.ai  
Software: Adobe Illustrator CS  
Color: 4C + 1788CVC  
By: Jie  
Date: 2019-09-24