

COMPONENT CHECKLIST

- 1 RC Vehicle
- 1 Controller
- 2 AA Batteries (located inside controller)
- 1 Pair of Sunglasses
- 1 Hat

TRANSMITTER BATTERIES

Batteries come pre-installed in this transmitter. To ensure the batteries remain fresh, there is a protective tab that must be removed prior to use.

1. Open battery compartment cover on transmitter by sliding it in the direction indicated by the arrow. Locate and remove protective plastic tab. The tab can be discarded.
2. To replace old batteries, open the compartment as described above.
3. Insert 2 "AA" size batteries. Make sure the positive (+) and negative (-) markings on the batteries match up to the ones inside the Battery Compartment.
4. Replace the Battery Compartment Cover making certain that the Compartment tab has "snapped" into the locked position.

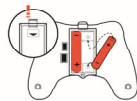

Note: When replacing transmitter batteries:
Do not use alkaline, standard or rechargeable batteries.
Use alkaline batteries only.

This transmitter is equipped with 2.4GHz technology which allows up to 6 vehicles to be used at the same time. To sync transmitter and vehicle, follow these steps:

1. Install batteries in Transmitter.
2. Turn on vehicle.
3. Keep Transmitter in close proximity to vehicle.
4. The Transmitter will sync automatically with the Vehicle.

Battery Requirements (Included):
Transmitter – 2 AA Batteries
Vehicle – 1 9.6V Internal Lithium-Ion battery (non-replaceable)

CHARGING THE VEHICLE BATTERY

This vehicle is equipped with an internal Lithium-Ion battery that is recharged via USB.

ON/OFF Switch must be in the OFF position prior to charging.

1. Locate the Charging Cord Compartment Cover on the underside of vehicle.
2. Remove USB cable from the Storage Compartment. (Use care when extending cord as it is attached to inside internal battery). Cord can be plugged into any computer or USB outlet brick (not included).
3. Insert the USB connector into a computer or other USB power source.
4. While charging, the Charging Status Light under the vehicle will be on. Once fully charged the light will turn off. Charging is completed in approximately 1.5 hours. The charging time will be different due to the use of different charging devices.
5. After charging is complete, store the USB cord in the Charging Cord Compartment. Replace the Compartment cover.

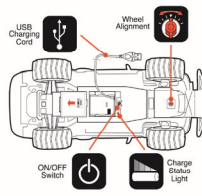

VEHICLE OPERATION

Features Operated by the controller:

- DRIVING**
- Move left joystick up to move the vehicle FORWARD.
- Move left joystick down to move the vehicle in REVERSE.
- Move right joystick left or right to move vehicle LEFT or RIGHT.

This vehicle has working headlights.
• When driving forward or reverse the headlights will turn on.

This vehicle has sounds. In sound mode the sounds will continue until START/MUTE button is pressed or vehicle is turned off.

- Press HORN button on controller to hear horn sound.
- Press START/MUTE button on controller to hear engine sounds.
- Press START/MUTE button again to stop engine sounds.

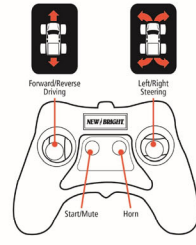

PROPER USE AND CARE

- Wipe body with soft rag or cloth.
- Do not use chemicals or water to clean.
- Brush areas where dirt gets trapped.
- Switch vehicle to OFF when not in use.
- Do not leave out in the sun.
- Do not run into hard objects.
- Do not drive on sand.
- Do not get wet.



CAUTION!

- Always remove Batteries from transmitter when not in use.
- Do not dispose batteries in fire. Leakage, explosion and personal injury may occur.
- Do not attempt jumps or tricks with this vehicle.
- Do not attempt to remove internal battery.
- Do not use included USB cord for anything other than its intended purpose.
- Always keep USB cord stored when not in use.
- Adult supervision recommended.

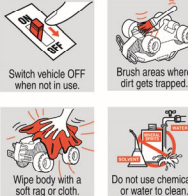

TROUBLE SHOOTING

- Problem - Vehicle does not move or moves slowly.**
Is the rechargeable Internal Battery been fully charged?
- Make certain there are fresh alkaline batteries in the transmitter and that they have been installed in the correct position.
- Are the (+) and (-) markings on the alkaline batteries in the same position as the (+) and (-) markings in the Transmitter Battery Compartment?
- Are the metal contact tabs touching, rusty or dirty in the transmitter?
- Make certain that the vehicle ON/OFF switch is in the "ON" position.

- Problem - Vehicle moves by itself or exhibits reduced range from the transmitter.**
- Make certain there is no outside radio interference in your area. The best way to test this is to take the vehicle as far away from radio towers, electrical lines or tall buildings as possible to ensure no further radio interference will occur.

FCC CAUTION:
Changes or modifications not expressly approved by the party responsible for compliance could void the user's authority to operate the equipment.

This device complies with Part 15 of the FCC Rules. Operation is subject to the following two conditions:
(1) This device may not cause harmful interference, and (2) this device must accept any interference received, including interference that may cause undesired operation.

NOTE: This equipment has been tested and found to comply with the limits for a Class B digital device pursuant to Part 15 of the FCC Rules. These limits are designed to provide reasonable protection against harmful interference in a residential installation. This equipment operates, uses and can radiate radio frequency energy and, if not installed and used in accordance with the instructions, may cause harmful interference to radio communications. However, there is no guarantee that interference will not occur in a particular situation. If the equipment does cause interference to radio reception, which can be determined by turning the equipment off and on, the user is encouraged to try to correct the interference by one or more of the following measures:

- Reorient or relocate the receiving antenna.
- Increase the separation between the equipment and receiver.
- Connect the equipment into a circuit or a circuit different from that to which the receiver is connected.
- Consult the dealer or an experienced radio/TV technician for help.

**USA & Canada
30-Day Limited Warranty**

New Bright Industries warrants to the original purchaser that this product will be free of defects in materials and workmanship for thirty (30) days from the date of purchase. In the event of such a defect within the warranty period, New Bright will repair or replace the product at our sole discretion. This warranty does not cover damage resulting from unauthorized modifications, accident, misuse, or abuse.

In the event of a defect covered under this warranty, first call the toll-free number listed below. Many problems can be resolved in this manner. If necessary, you will be issued a return authorization (RA) number, and instructions on how to obtain a Product Return Form. The Product Return Form is to be used when returning a product to us (postage pre-paid and insured by the consumer).

When returning a defective product, please package the product, the Product Return Form and a copy of the dated sales receipt as proof of purchase. Be sure to mark the RA number on the Product Return Form. If the product is returned without a dated sales receipt, it will be excluded from coverage under this warranty. Please allow 4 to 6 weeks for delivery of repaired or replacement vehicles (depending on your location).

New Bright Industries' liability for defects in material and workmanship under this warranty shall be limited to repair or replacement at our sole discretion. In no event shall we be responsible for incidental, consequential, or contingent damages (except in those states that do not allow this exclusion or limitation).

Valid only in U.S.A. and Canada
Contact New Bright Industries Customer Service Toll Free at:
1-877-NBI-TOYS
(1-877-624-8971)
Monday through Friday 8:00 AM to 5:00 PM Eastern Time
U.S. Toy Sales and Marketing Co. Inc.
30200 Oak Creek Drive - 2nd Floor
Wauwatosa WI 53222
1-877-624-8971
<http://www.newbright.com/>

REF U11606

2011-5-21