

Ergo 9000S 說明書



Ergo 9000S
Wireless Bluetooth
Mini Ergo Silent Mouse

Ergo 9000S Pro
Wireless Bluetooth Rechargeable
Mini Ergo Silent Mouse



Ergo 9000S



Ergo 9000S Pro

Multi-language Quick Guide

Copyright © KYE SYSTEMS CORP.

Overview

Ergo 9000S

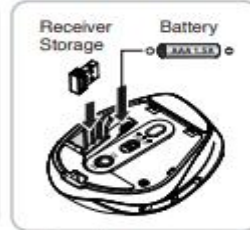

* Battery life may vary based on user and computing conditions

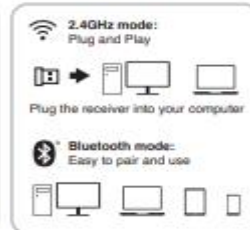

Button A

Front

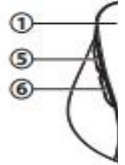

Back



Bluetooth Easy



Assignment

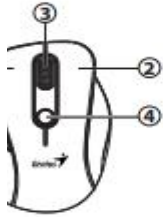

- ① Left button
- ② Right button
- ③ Scroll wheel with middle button
- ④ DPI switch
- ⑤ Forward
- ⑥ Backward

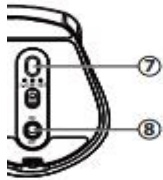

USB-C rechargeable port (Ergo 9000S Pro)



- ⑦ Mode button
Red : 2.4GHz (Default)
Orange : Bluetooth BT1
Green : Bluetooth BT2
- ⑧ Power: On/Off

Bluetooth mode:
/ to pair and use



2.4GHz mode:
Plug and Play



Connection Process

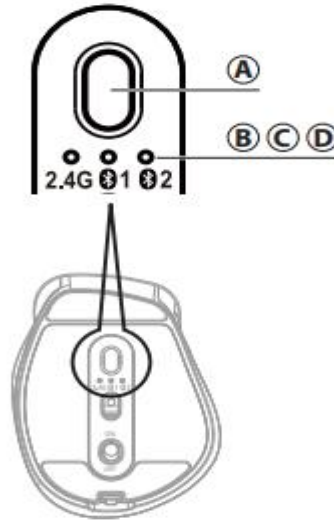

1. **2.4GHz mode** (Red light flashes): Plug and start working.
2. **Bluetooth mode installation:** • BT 1
• BT 2
 - Step (A) : **Starting BT pairing**
Long press Mode Button for
 - Step (B) : **Pairing**
Confirm the light flashes turn
 - Step (C) : **Select pairing name**
Choose Genius Bluetooth™
 - Step (D) : **Pairing process done**
Start working
3. **Mode switching:** Press Mode Button

English

Plug the receiver into USB port,

1 (Orange light flashes)

2 (Green light flashes)

or 2 seconds into pairing mode

Turn into the orange/green

M1 or Genius BluetoothM2

Push **(A)** to switch 2.4GHz/BT1/BT2

FCC Warning Statement: Changes or modifications to this unit not expressly approved by the party responsible for compliance could void the user's authority to operate the equipment. This equipment has been tested and found to comply with the limits for a Class B digital device, pursuant to Part 15 of the FCC Rules. These limits are designed to provide reasonable protection against harmful interference in a residential installation. This equipment generates, uses and can radiate radio frequency energy and, if not installed and used in accordance with the instructions, may cause harmful interference to radio communications.

However, there is no guarantee that interference will not occur in a particular installation. If this equipment does cause harmful interference to radio or television reception, which can be determined by turning the equipment off and on, the user is encouraged to try to correct the interference by one or more of the following measures:

- **Reorient or relocate the receiving antenna.**
- **Increase the separation between the equipment and receiver.**
- **Connect the equipment into an outlet on a circuit different from that to which the receiver is connected.**
- **Consult the dealer or an experienced radio/TV technician for help.**

This device complies with Part 15 of the FCC Rules. Operation is subject to the following two conditions: (1) this device may not cause harmful interference, and (2) this device must accept any interference received, including interference that may cause undesired operation.

FCC Radiation Exposure Statement

The device has been evaluated to meet general RF exposure requirement. The device can be used in portable exposure condition without restriction.