

展開尺寸: 328 x 480 mm,

摺完尺寸: 80 x 120 mm

HS-M920BT / 12030110400-B, MANUAL,

印刷色: 單色黑, 雙面印刷, 60P模造紙

80

120

HS-M920BT

Bluetooth Earbuds



Bluetooth 5.3

Genius RAYKEY

KYE Systems Corp.

#492, Sec. 5, Chongpin Rd., Sanhong Dist.,
New Taipei City 241017, Taiwan
Tel: 886-2-2995-6645
Fax: 886-2-2995-6649
Email: support@geniusnet.com.tw (Tech. Support)
http://www.geniusnet.com

FCC ERI

For actual items, refer to the physical goods contained herein.
Product storage conditions: Temperature: -20°C~50°C / Humidity: 5%~85%.

12030110400-B

Multi-language Quick Guide

Copyright © KYE SYSTEMS CORP.

CE Prehlásenie o zhode

Nariadením o súlade...
This declaration is prepared for the manufacturer:

CE Declaratie de conformitate

Prezentul este produs...
This declaration is prepared for the manufacturer:

CE Декларация о соответствии

Соответствие...
This declaration is prepared for the manufacturer:

CE Δηλώση Συμμόρφωσης

Με το παρόν...
This declaration is prepared for the manufacturer:

CE Vastavusavaldus

Siin on toodetud...
This declaration is prepared for the manufacturer:

CE Atbilstības deklarācija

Turpinājums...
This declaration is prepared for the manufacturer:

CE Atitikties deklaracija

Čia parodytas...
This declaration is prepared for the manufacturer:

CE Uyumluluk Deklarasyonu

Azraklıklar...
This declaration is prepared for the manufacturer:

Simbolo de recogida selectiva en países europeos

Este símbolo indica que este producto debe eliminarse por separado.

Simbolo para a recolha separada em países da Europa

Este símbolo indica que este produto tem de ser recolhido separadamente.

Symbol voor gescheiden afvalophaling in Europese landen

Dit symbool geeft aan dat dit product afzonderlijk moet worden opgehaald.

Symbol pro třídění odpadu v evropských zemích

Tento symbol označuje, že tento výrobek je třeba zlikvidovat jako tříděný odpad.

Simbolo per la raccolta differenziata nei paesi europei

Il simbolo indica che questo prodotto si può raccogliere separatamente.

CE Declaration of Conformity

The following certified product...
This declaration is prepared for the manufacturer:

CE Konformitätserklärung

Dieses technische Produkt...
Diese Erklärung wurde ausgearbeitet für den Hersteller:

CE Declaration de conformité

Cette déclarations...
Cette déclaration est préparée à l'attention du fabricant:

CE Dichiarazione di Conformità

Il prodotto...
Questa dichiarazione è stata preparata per il fabbricante:

CE Declaracion de conformidad

El siguiente producto...
Esta declaración es realizada por el fabricante:

FCC STATEMENT

1. This device complies with Part 15 of the FCC Rules. Operation is subject to the following two conditions:
(1) This device may not cause harmful interference, and
(2) This device must accept any interference received, including interference that may cause undesired operation.

NOTE:

This equipment has been tested and found to comply with the limits for a Class B digital device, pursuant to Part 15 of the FCC Rules. These limits are designed to provide reasonable protection against harmful interference in a residential installation.

NOTE:

This equipment has been tested and found to comply with the limits for a Class B digital device, pursuant to Part 15 of the FCC Rules. These limits are designed to provide reasonable protection against harmful interference in a residential installation.

Ayrı biriktirme için Avrupa ülkelerinin sembolü

Bu sembol bu ürünlerin ayrı toplanması gerektirgin göstergesidir.

Simbol eraldi kogumiseks Euroopa maades

See sümbol näitab, et seda toodet tuleb koguda eraldi.

Simbolis atskiram atlieku iŕmetimui įvairiose Europos šalyse

Sis simbolis nurodo, kad šis produktas turi būti išmetamas atskirai.

Symbolis atskiram atlieku iŕmetimui įvairiose Europos šalyse

Sis simbolis nurodo, kad šis produktas turi būti išmetamas atskirai.

CE Declaracion de conformidad

El siguiente producto...
Esta declaración está preparada para el fabricante:

CE Conformiteitsverklaring

Dit technische product...
Deze verklaring is opgesteld voor de fabrikant:

CE Prohlášení o shodě

Dle následujícího...
Tato prohlášení byla připravena pro výrobce:

CE Megfelelőségi nyilatkozat

A következő termék...
Ez a nyilatkozat készült a gyártó számára:

CE Declaracija zgodnosti

Spodnja tabela...
Ta izjava je pripravljena za proizvajalca:

Symbol for Separate Collection in European Countries

This symbol indicates that this product is to be collected separately.

Symbol für Mülltrennung in der Europäischen Union

Dieses Symbol bedeutet, dass dieses Produkt separat entsorgt werden muss.

Symbole de collecte séparée dans les pays européens

Ce symbole indique que ce produit doit faire l'objet d'une collecte séparée.

HS-M920BT Product Overview

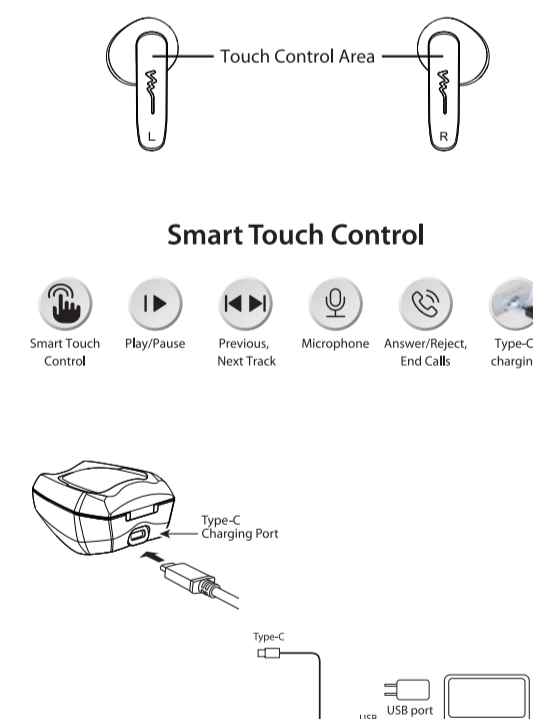

Status	LED Status	Description
Charge case opened	Blue light stays on	Charge case turn on blue light
Take out Bluetooth earbuds	Red and blue lights flashing alternately	After L/R earbuds auto paired, the right of Bluetooth earbuds will be red and blue lights flashing alternately. The left of Bluetooth earbuds will be blue light flashing every 0.5 seconds.
Bluetooth earbuds PAIR	Blue light flashing alternately	L/R earbuds auto pairing connect phone after L/R paired, the blue light flashing alternately.
Charging mode	Red light stays on	Put the Bluetooth earbuds to charge case, the earbuds charge full and power off (under close the charge case).
Charge case full charge mode	Red light stays on	Charging case full charge.
Bluetooth earbuds full charge mode	The light turn off	The light of Bluetooth earbuds will be turn off (under close the charge case).
Low Battery Mode	Bluetooth earbuds: Red light flashes every 5 seconds. Charging case: Blue light flashes quickly	Bluetooth earbuds and charging case in low battery status.

Operation function	IOS / Android	IOS / Android
Power on	Charge case opened	Open case, take L/R earbuds out of charge case / Long press 2s to power on
Power off	Charge case closed	Put L/R earbuds into Charge case and Close case / Long press 5s to power off
Pairing (mono)	Charge case closed	Search "HS-M920BT" by phone and connect
Power on and connect phone automatic	Charge case opened	Open case (L and R earbud paired before), L/R earbuds auto pairing, connect phone after L/R paired
Disconnect	Standby	Put the Bluetooth function on the phone/disconnect by long distance
Play/Pause		Touch press one time on L/R SIRI
Volume Adjustment		Touch press 2 seconds on L/R
Music Switch		Double touch press left or right earbuds to decrease or increase the volume when listening music
Pick Up / Hang Up / Rec'd Call		Triple touch press Left or Right earbuds go to the previous or next songs when music playing
Charge Mode		Short press one time on L/R
Charge		Bluetooth earbuds full charge, get into dormant mode (under close the charge case) / Put the Bluetooth earbuds to charge case, the earbuds charge full and power off (under close the charge case)

English

English