

# **MICHELIN TMS AF-02**

## **USER MANUAL**

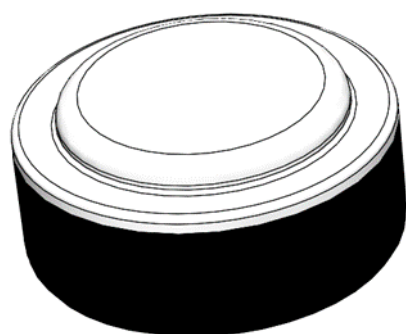

## PRODUCT NOTICE

### **PRODUCT NAME**

MICHELIN TMS AF-02

### **PRODUCT DESCRIPTION**

The MICHELIN TMS AF-02 advertises, via BLE, temperature, voltage and identifier data. Those information's are to be received by a BLE antenna.

### **INSTALLATION**

The MICHELIN TMS AF-02 is mounted inside the vehicle tire using a specific tool.

The MICHELIN TMS AF-02 must not be installed in an explosive environment.

### **SYSTEM MODES**

There are two functioning modes:

- Stationary Mode: Stationary mode is used when the TMS is not in motion. There is no transmission to conserve battery life.
- Advertising Mode: Advertising mode is used when the TMS detects continuous motion. This mode has a regular transmission at the interval of 1 sec. If motion stop for more than 30 seconds, it will return to stationary mode.

### **FCC / IC CERTIFICATION**

Model : TMS AF-02

FCC ID : F15TMSAF02

IC : 5056A-TMSAF02

*This device complies with part 15 of the FCC Rules and with Industry Canada's licence-exempt RSSs. Operation is subject to the following two conditions: (1) This device may not cause harmful interference, and (2) this device must accept any interference received, including interference that may cause undesired operation.*

*“Le Présent appareil est conforme aux CNR d'Industrie Canada applicables aux appareils radio exempts de licence. L'exploitation est autorisée aux deux conditions suivantes : (1) l'appareil ne doit pas produire de brouillage, et (2) l'utilisateur de l'appareil doit accepter tout brouillage radioélectrique subi, même si le brouillage est susceptible d'en compromettre le fonctionnement.”*

*Changes or modifications not expressly approved by Michelin may void the user's authority to operate the equipment.*

*NOTE: This equipment has been tested and found to comply with the limits for a Class B digital device, pursuant to part 15 of the FCC Rules. These limits are designed to provide reasonable protection against harmful interference in a residential installation. This equipment generates, uses and can radiate radio frequency energy and, if not installed and used in accordance with the instruction, may cause harmful interference to radio communications. However, there is no guarantee that interference will not occur in a particular installation. If this equipment does cause harmful interference to radio or television reception which can be determined by turning the equipment off and on, the user is encouraged to try to correct interference by one or more of the following measures:*

- Reorient or relocate the receiving antenna.

## PRODUCT NOTICE

- Increase the separation between the equipment and receiver.
- Connect the equipment into an outlet on circuit different from that to which the receiver is connected.
- Consult the dealer or an experienced radio/TV technician for help.

*This device complies with FCC and ISED radiation exposure limits set forth for general population. This device must not be co-located or operating in conjunction with any other antenna or transmitter.*

*Le présent appareil est conforme aux niveaux limites d'exigences d'exposition RF aux personnes définies par FCC et ISDE. L'appareil ne doit pas être installé à proximité ou être utilisé en conjonction avec une autre antenne ou un autre émetteur.*

*Under Industry Canada regulations, this radio transmitter may only operate using an antenna of a type and maximum (or lesser) gain approved for the transmitter by Industry Canada. To reduce potential radio interference to other users, the antenna type and its gain should be so chosen that the equivalent isotropically radiated power (e.i.r.p.) is not more than that necessary for successful communication.*

*Conformément à la réglementation d'Industrie Canada, le présent émetteur radio peut fonctionner avec une antenne d'un type et d'un gain maximal (ou inférieur) approuvé pour l'émetteur par Industrie Canada. Dans le but de réduire les risques de brouillage radioélectrique à l'intention des autres utilisateurs, il faut choisir le type d'antenne et son gain de sorte que la puissance isotrope rayonnée équivalente (p.i.r.e.) ne dépasse pas l'intensité nécessaire à l'établissement d'une communication satisfaisante.*

### **PRODUCT SPECIFICATION**

#### Operating Conditions

- Temperature: -40°C to 125°C, -40°F to 257°F
- Hygrometry: 5 to 95% (non-condensing)
- Pressure: up to 20 bar
- Altitude: up to 3000m



This product complies with European Union directives

### **INFORMATIONS REGARDING BATTERY**

MICHELIN TMS AF-02 battery cannot be replaced

MICHELIN TMS AF-02 must not be disposed of into a fire or a hot oven, must not be mechanically crush or cut.

MICHELIN TMS AF-02 must not be used in operating conditions different than those listed in the present notice.

## PRODUCT NOTICE

### **DISPOSAL**

The MICHELIN TMS AF-02 must not be disposed of in a landfill.



This product complies with the WEEE Directive (2002/96/EC) marking requirements. The affixed label indicates that you must not discard this electrical/electronic product in domestic household waste.

Product Category: With reference to the equipment types in the WEEE Directive Annex I, this product is classed as category 9 “Monitoring and Control Instrumentation” product.

At the end of its life, the MICHELIN TMS AF-02 must be removed from the vehicle and deposited in a container dedicated to the recycling of electronic equipment. If users do not have access to the appropriate recycling facility, your local Michelin TMS representative is able to provide a container dedicated to the purpose of collecting TMS equipment

Do not dispose of this product as unsorted municipal waste.

Features, specifications are subject to change without notification.

Document version 1.0

*MFP MICHELIN © 2017 All rights reserved.  
Exclusive property of Manufacture Française des Pneumatiques  
Michelin.  
Any reproduction or utilization prohibited without the consent  
of Michelin.*