



USER MANUAL

ABOUT THIS DOCUMENT

This document describes the user interface and controls for the DSC Touch, a “Smart home” control and automation system. Within these pages you will find how to enable and simplify home security, home control, energy management, home healthcare, and other services. The DSC Touch uses wireless technology to communicate with a broad set of wireless peripherals and sensors, and can also communicate with your security and home control provider’s monitoring and safety systems, your smart phone and remote access from your personal computer. If you have questions about the use, features, or any aspect of this product, please consult your security and home control dealer or visit .

CERTIFICATION



Intertek

Document#: DSC Touch-UM-02-15
 Revision Date: 2/18/15
 DSC Part #: XXXXXXXXXX
 Software Version: 1.4.2

Conforms to UL Std. 1023, 985 & 1635
 Certified to ULC Std. C1023 & S545



CONGRATULATIONS!

We'd like to thank you for making the decision to purchase the DSC Touch. We hope you'll enjoy using it as much as we enjoyed developing it. It's got everything you need in a single, easy to use device, and because we developed the software using an upgradeable operating system, we can continue to refine your experience over time with software updates and innovative new devices.

The DSC Touch is more than just a security panel, its a security and smarthome platform, giving you access and control over what is going on in your home at all times. To take full advantage of the power of this amazing device you'll want to download the free Alarm.com app to your smartphone or tablet. This will be your link to your home when you are away, keeping you connected and ensuring you have the control you need. We've tried to make the panel easy to use, and provide this manual as a reference to help you take advantage of all the features available. If you have questions on anything, don't hesitate to contact your security or home control provider.

Welcome to the future!

The DSC team

HARDWARE OVERVIEW

FRONT

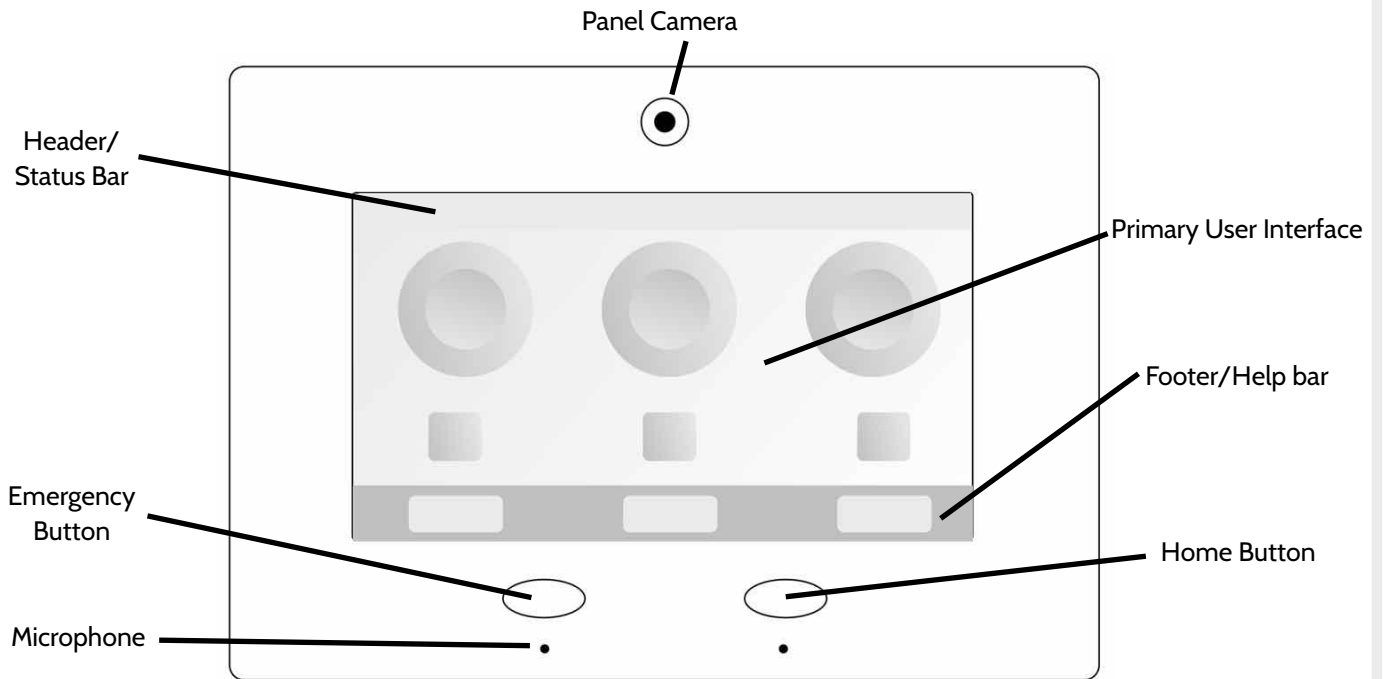

BACK

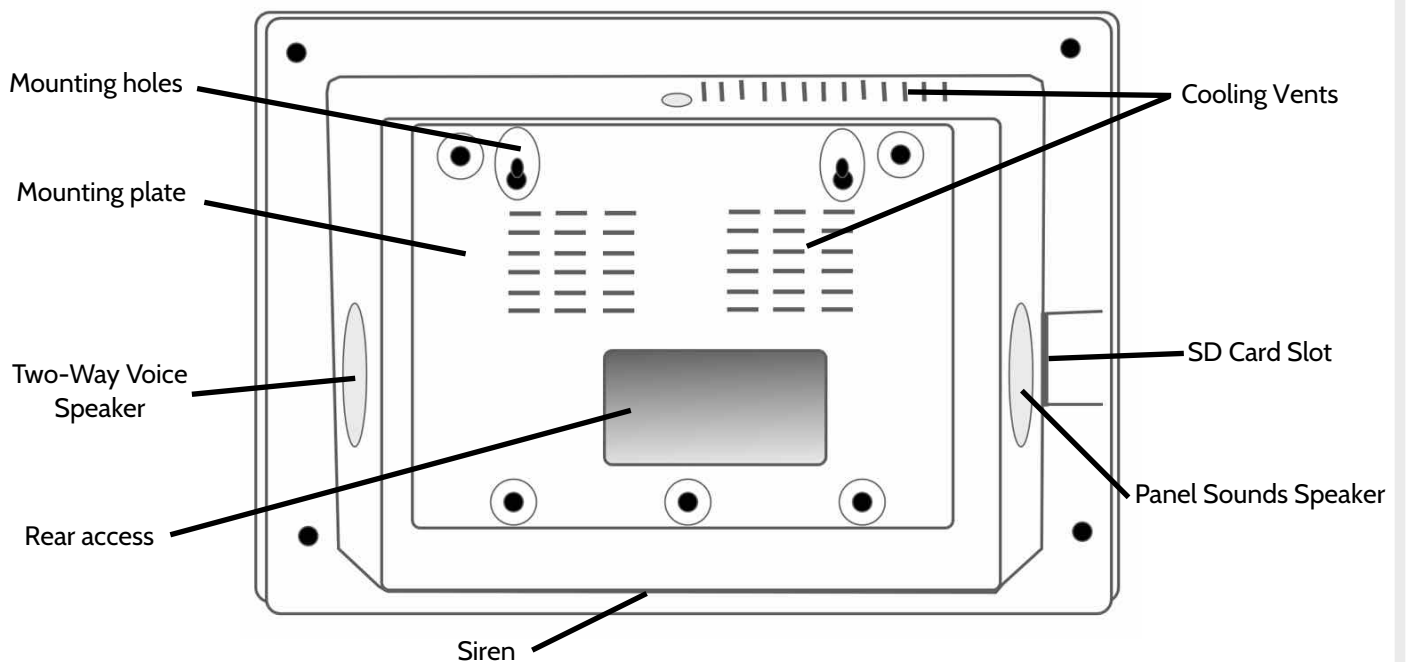

HOME SCREEN

The home page is the primary page shown on the DSC Touch. It is the first page the user will see, and it is the default page when the user pushes the home button on the panel. It is divided into three sections: The header/status bar, the primary user interface, and the footer/help bar.

The home page displays the most important and most frequently used Apps. It allows the user to arm or disarm the security system; monitor the overall status of the system; view weather, time, and date information; and execute various security, home control, and other functions of the system.

FIND IT



Header or Status Bar



Primary User Interface

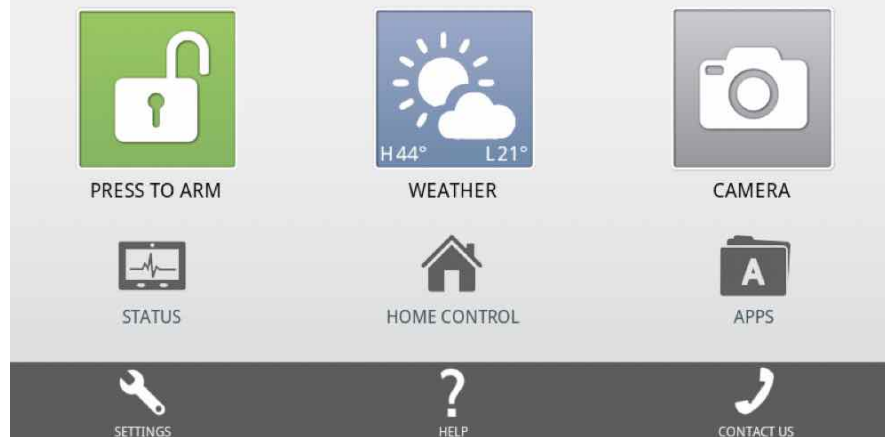

Footer or "Help" Bar



7" TOUCHSCREEN



TOUCHSCREEN

In an emergency you need an immediate response to your touch, so we built the DSC Touch with a 7" RESISTIVE TOUCH screen so it even works with gloves, fingernails, etc.

ALERTS



ALERTS

The DSC Touch uses a common alerts system to draw your attention to various items. When you see the alert, touch the screen to find out what information is being shared.

UPGRADE SERVICES



UPGRADE SERVICES

The DSC Touch is always improving. As new features are developed they may be made available to you. Contact your security provider for details.

STATUS TYPES & COLOR CODES

The header bar is color coded based on system status, and shows the date, time, and current status.

August 11, 2014

SYSTEM READY - DISARMED

Mon - 03:24 PM

The **green** header is labeled "System Ready - Disarmed" and indicates that all of the sensors are closed and the system is ready to be armed.

August 11, 2014

SYSTEM NOT READY - DISARMED

Mon - 03:25 PM

The **yellow** header is labeled "System Not Ready - Disarmed" and indicates that one or more of the sensors are open. Touch this yellow bar to see a list of open sensors.

August 11, 2014

SYSTEM ARMED - STAY MODE

Mon - 03:25 PM

The **orange** header is labeled "System Armed- Stay Mode" and means that any entry through a protected door or window will trigger the alarm. Note: When armed, the home button and panic button will glow red.

August 11, 2014

SYSTEM ARMED - AWAY MODE

Mon - 03:27 PM

The **orange** header is labeled "System Armed- Away Mode" and means that any entry through a protected door or window or crossing the path of a motion detector will trigger the alarm. Note: When armed, the home button and panic button will glow red.

STATUS



If you want to know whether your sensors are open or closed, touch the "Status" app on the Home Screen

STATUS					
SYSTEM READY - DISARMED Tue - 08:00 AM					
CURRENT STATUS	ALARM	ALARM	HISTORY		
No.	Name	Group	Chime	Status	History
1	Front Door	10-Entry-Exit-Normal Delay	High wire	Closed	view
2	Back Door	13-Instant Perimeter B/W	High wire	Closed	view
3	Door from garage	12-Entry-Exit-Long Delay	High wire	Closed	view
4	Garage Tilt	12-Entry-Exit-Long Delay	High wire	Closed	view

BACKLIT BUTTONS

The panel's "Panic" and "Home" buttons also illuminate to show panel status.

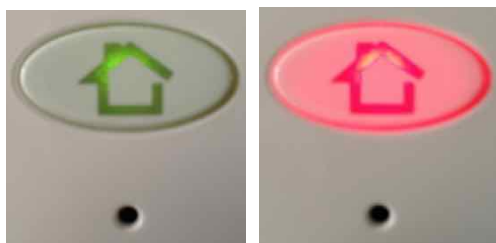

Green LED when Disarmed

Red LED when Armed

During a power outage these LED lights will NOT illuminate to save battery life if the panel is running on battery only

CHECKING STATUS OUTSIDE THE HOME



You can also see the status of your home from your Alarm.com mobile application, or from any web browser by logging into your Alarm.com account.



Go to your device and search for "Alarm.com"



EMERGENCY BUTTON

Below the 7" Touchscreen are two buttons: Emergency and Home.



The Emergency Button is marked with a "+" sign. This button can be pressed at any time, regardless of the panel's status or the page currently displayed on the screen.

When pressed, the panel will display the emergency services page, with access to police, fire, and medical emergency alarms.

FIND IT

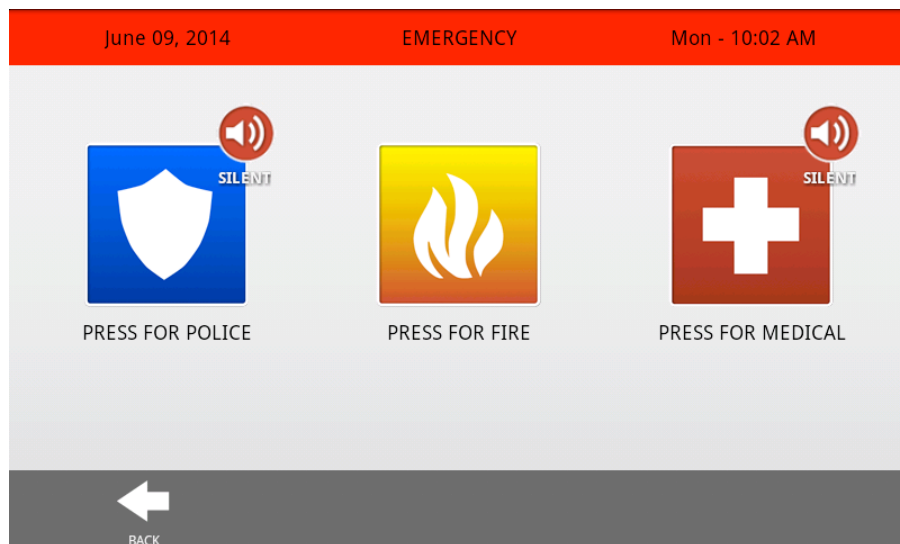

WHOOPS!



If you press the emergency button by mistake, simply tap the "Home" button or click "Back" to return to the previous page.

EMERGENCY TYPE



Select the icon that represents your emergency type. As soon as you tap the icon the siren will sound and an "emergency sent" message will appear.

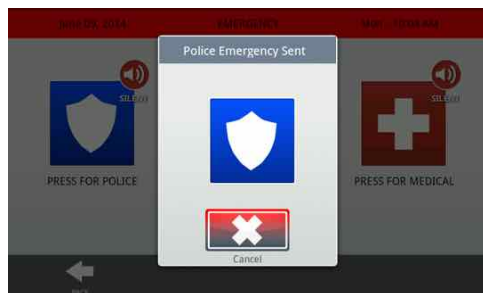

SILENCE SIREN

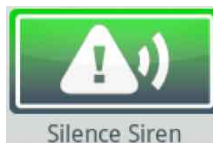

On medical and fire emergencies you can silence the siren by pressing the green button.

CANCEL REQUEST

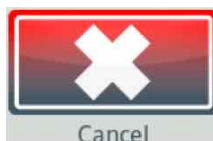

To cancel an emergency request press the "cancel" button. For security purposes, you will be required to enter a valid user code.

If your security and home control provider offers 2-Way voice service you may receive a call from a monitoring agent through your panel's speaker and microphone.



ALARM EVENTS

When the alarm is triggered the DSC Touch will sound the siren and display a red alarm screen.

If your security provider offers monitoring service, the panel will automatically contact the monitoring center using the built in cellular connection.

To disarm, touch the screen and enter your passcode.



POLICE



When the system is armed and the alarm is tripped or you touch the “Police” emergency button the alarm sounds with the “Intrusion” siren and then activates the Two-Way Voice microphone and speaker, if available.

TWO-WAY VOICE

Note that Two-Way Voice services are only activated after an alarm event and may not be available in all areas or with all security providers.

FIRE



When a Smoke or Carbon Monoxide detector is triggered or someone taps the “Fire” panic on the DSC Touch:
 •The alarm sounds with the “Fire” siren and then activates the Two-Way Voice microphone and speaker, if available.

HARDWARE

The built in microphone on the front of the panel and the dedicated Two-Way Voice speaker on the side of the panel activate after a connection to the monitoring station has been made.

MEDICAL



When you press a Medical Pendant or trigger a “Medical” emergency from the DSC Touch:
 •The alarm sounds with the “Medical” siren and then activates the Two-Way Voice microphone and speaker, if available.

FALSE ALARM

In the event of a false alarm, press disarm and enter your user code. If your system is monitored, be ready to provide your verbal password to your security provider’s monitoring agent if they contact you. If you are unable to provide the correct verbal passcode, the authorities may be contacted.

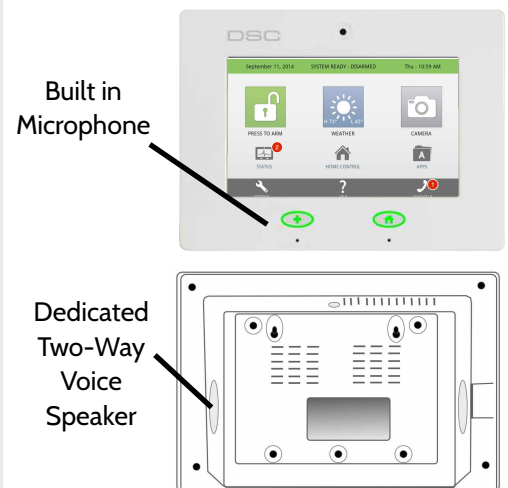

EMERGENCY PANIC

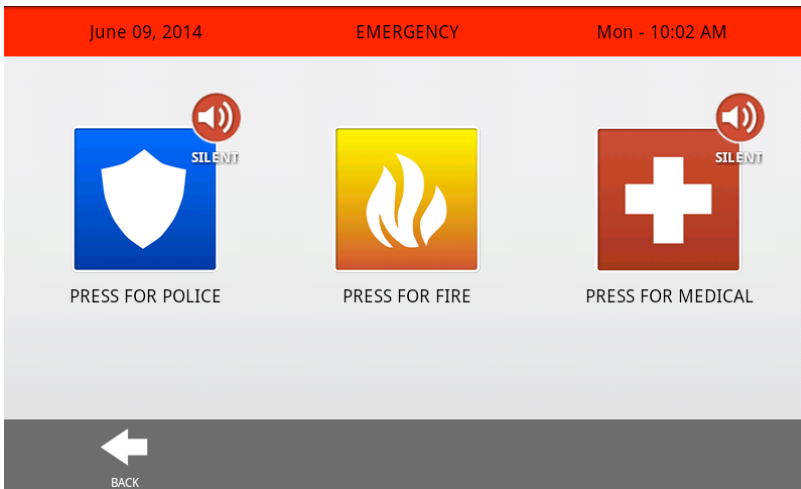

When you press the Emergency Button the Emergency Panic screen appears. Touching any of the buttons will trigger an alarm manually.

POLICE

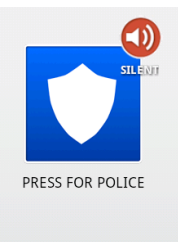

An "Intrusion" alarm is triggered when you touch the "Police" panic button. (touching "silent" triggers a silent alarm.)
For your security, once a police siren has been triggered it cannot be silenced without a passcode.



The alarm will sound until you touch cancel.

Note: Touching cancel requires your user code and will cancel the alarm reported to your security provider.

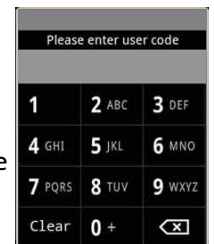

FIRE



A "Fire" alarm is triggered when you touch the "Fire" panic button.
Note: There is no "Silent" function on the button itself, but once you touch it you can silence it.

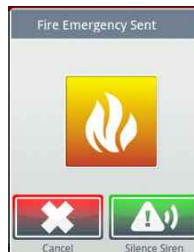

The alarm will sound until you touch cancel or touch "silence siren"

Note: Touching cancel requires your user code and will cancel the fire alarm reported to your security provider.

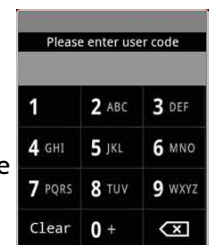

MEDICAL



A "Medical" alarm is triggered when you touch the "Medical" panic button. (touching "silent" triggers a silent alarm.)

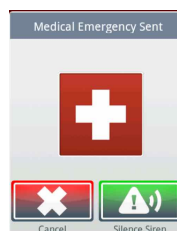

When the alarm is going off you can cancel it (requires passcode) or silence it until authorities arrive



If you create a silent alarm only the cancel button appears. Touching it requires your user code and will cancel the alarm reported to your security provider.

ARMING

The first icon on the home screen is used for arming and disarming.



PRESS TO ARM

The green “unlocked” icons means your system is currently disarmed and ready to arm and will coincide with a “System Ready” message in the Header/Status Bar. Touching this icon will provide you with two arming modes and several optional

FIND IT

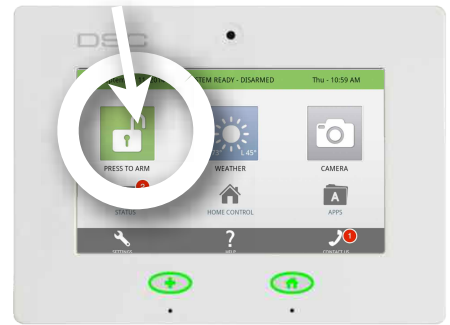

July 31, 2014
SYSTEM READY - DISARMED
Thu - 12:57 PM

ARM STAY

ARM AWAY

Exit Sound On

Entry Delay On

Name	Status	Bypass
Front Door	Closed	<input type="checkbox"/>
Back Door	Closed	<input type="checkbox"/>
Door from garage	Closed	<input type="checkbox"/>
Garage Tilt	Closed	<input type="checkbox"/>
lroom window	Closed	<input type="checkbox"/>
Nursery window	Closed	<input type="checkbox"/>

BACK

ARMING OPTIONS



EXIT SOUNDS

The panel beeps as the arming timer counts down. You can silence these beeps before you choose an arming type.



ENTRY DELAY

The panel will give you time to disarm once a “delay door” has been opened. Turn this off with a touch.

BYPASS

Bypass sensors easily by checking the buttons next to the sensor name on the right side of the screen. The panel shows you the status of each device for easy reference and open sensors pop to the top of the list.



ARM STAY

Arming in “Stay” mode indicates that people will remain inside the home while the system is armed. Devices such as a Motion Detector and an Image Sensor may not be activated in this mode. We encourage users to activate this regularly, especially as they retire for the evening.



ARM AWAY

Arming in “Away” mode indicates that the home will be vacant while the system is armed. All devices, including Motion Detectors and Image Sensors will be activated in this mode. We encourage users to activate this whenever they leave the home.

COUNTDOWN TIMER

When you arm “Away” a timer will appear, giving you time to leave the home before the system is activated.

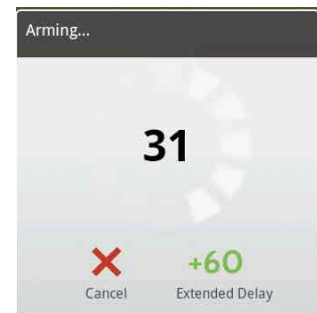

NEED MORE TIME?

Extend the exit delay by either touching the +60 or by re entering your home if you had forgotten something.

DISARMING

The first icon on the home screen changes appearance when the system is armed.



ARMED

When the system is armed, whether in “Stay” or “Away” mode, the icon turns red (or orange) and appears “locked.” To disarm, tap this icon.

If a “delay” door is opened the panel will go into a countdown, allowing the user time to enter their code without triggering the alarm. The camera will take a picture and save the image in the camera app.

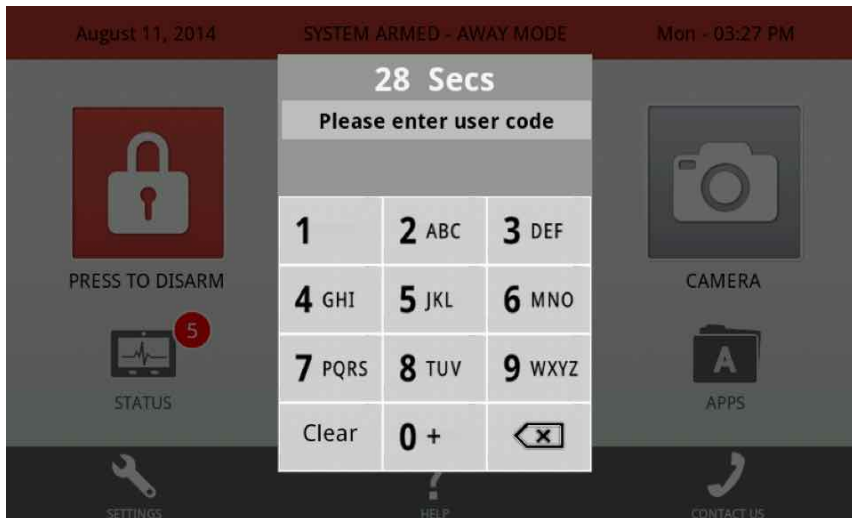

FIND IT



COLOR CODED STATUS

The DSC Touch is designed to make knowing panel status easy. When armed, the buttons, arming button, and header bar will all appear red.

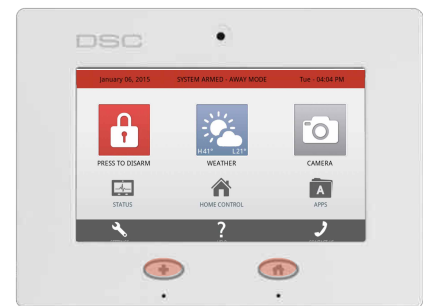

QUICK EXIT



QUICK EXIT (STAY MODE ONLY)

Need to grab the paper? Let the dog out? Head to work early and don't want to wake those asleep? When the system is armed, press “Quick Exit” for a 120 second period where you can open doors without deactivating the system.



DISARM PHOTOS

When you disarm the system from the panel, the built-in Camera will automatically take a photograph and store it in your Camera App, along with the date, time the panel was disarmed and user name. (Note: If an invalid user code was attempted, the system will log this as well)



ALARM PHOTOS

If your alarm IS triggered, the panel will take a photograph when the siren sounds and again when the siren ends. These images can be accessed from the “Alarm Photos” inside your Camera App

WEATHER

The second icon on the home screen is for weather



TODAY'S FORECAST

Today's forecast is displayed on the weather icon with a graphical representation of expected precipitation, as well as the High and Low temperatures for the day.

FIND IT

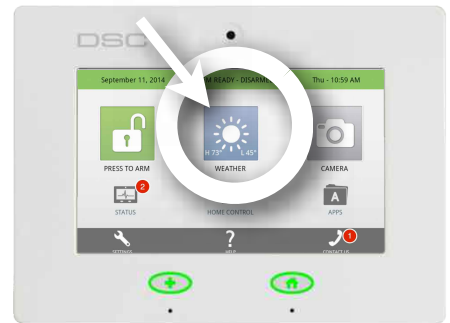

PRECIPITATION

The forecasted precipitation will be depicted visually on the panel, and will change based on the day's outlook.



SUNNY



PARTLY SUNNY



MOSTLY SUNNY



MOSTLY CLOUDY



FOG



CLOUDY



RAIN



STORMY



SNOW



SLEET



ICE



DUST/HAZE

LOCATION



Your weather reporting is based on your location, which is set by your dealer. When the DSC Touch is installed your dealer indicates your zip code in your Alarm.com account.

FORECAST

4

DAY FORECAST

If you touch the weather icon, you will get a four day weather forecast.

Weather		SYSTEM READY - DISARMED		Tue - 11:01 AM	
Extended Forecast					
Tuesday	Wednesday	Thursday	Friday		
Partly Cloudy 44°F	Mostly Sunny 44°F	Partly Cloudy 42°F	Mostly Cloudy 41°F		
High 21°F	High 24°F	High 25°F	High 27°F		
Low	Low	Low	Low		

CAMERA

The third icon on the home screen is Camera app.

**CAMERA APP**

The Camera app is used to access the images taken by your built in panel camera and up to 5 Image Sensors.

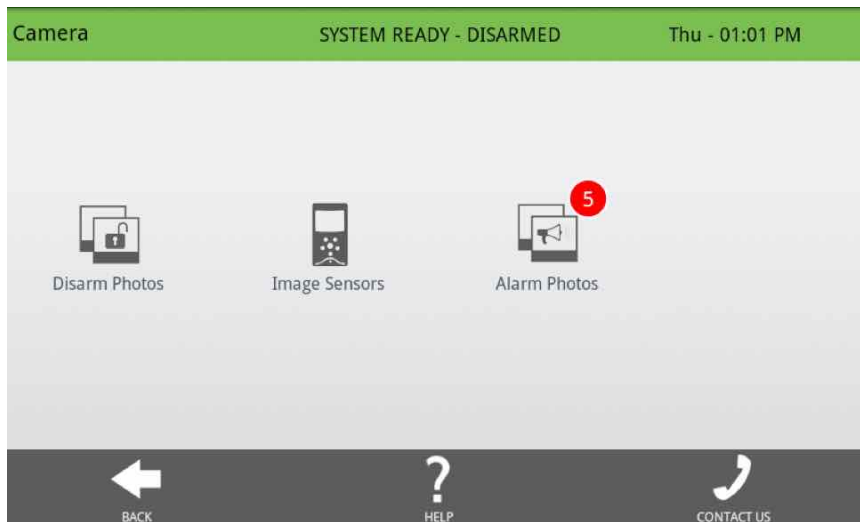
**DISARM PHOTOS**

The DSC Touch will automatically take a photo every time a user attempts to disarm the panel. The 20 most recent images are saved in the camera app under "Disarm Photos" and also store the date, time, user and whether the code used was valid.

**IMAGE SENSOR**

The DSC Touch can support up to 5 Image Sensors. When pictures are taken, they will be saved and can be viewed from this app.

**ALARM PHOTOS**

The DSC Touch will automatically take a photo when the alarm is triggered, and another when the siren times out. The 20 most recent images are saved in the camera app under "Alarm Photos" and also store the date and time they were captured.

FIND IT



CODE REQUIRED?

PROTECT YOUR IMAGES

You can protect the images taken by your cameras in one of two ways:

1- Require code to access the app.

This will require anyone trying to access the entire app to enter a valid user code.

2- Require code to delete images

This allows anyone to view the images, but only those with a valid user code can delete pictures.

To change these settings, contact your security and home control provider.

DISABLED

**DISABLED APPS**

In some cases these apps may be disabled by your security and home control provider. If this is the case the icon will appear light grey and give you an error message when you try to access them. Contact your provider for more information.

STATUS

The first icon on the second row is Status.



STATUS APP

The Status app is divided into four sections: Current Status, Alerts, Alarms and History.

Status					
SYSTEM READY - DISARMED					
Tue - 08:40 AM					
CURRENT STATUS		ALERTS ¹	ALARMS ⁵	HISTORY	
No	Name	Group	Chime	Status	History
1	Front Door	10-Entry-Exit-Normal Delay	High wire	Closed	View
2	Back Door	13-Instant Perimeter D/W	High wire	Closed	View
3	Door from garage	12-Entry-Exit-Long Delay	High wire	Closed	View
4	Garage Tilt	12-Entry-Exit - Long Delay	High wire	Closed	View

BACK FILTER

CURRENT STATUS

The individual security sensors are listed by zone/area. The status and settings for each of the sensors are shown in a list. Use your finger to swipe up or down to see the entire list. To see the history for a specific sensor, click "View."

ALERTS

Alerts are messages about tampered sensors, low batteries, and failed communications. The total number of unacknowledged Alerts messages appears in the red bubble counter on this tab. The user may acknowledge each message separately, which will then eliminate the message from the list.

ALARMS

Alarms lists all unacknowledged messages about alarm events.

HISTORY

The last tab displays a history for all sensor activity connected to the DSC Touch . The system will store up to 100 events in the history listing.

FIND IT



ALERTS



If the DSC Touch is reporting a new issue, it will display a bubble above the app showing the number of new items that may require your attention.

ACKNOWLEDGE

<input type="checkbox"/>	Acknowledge	Time, Date
<input type="checkbox"/>		12:08 am, Jul 0...

Acknowledge a single alert by tapping the check box to the left. Acknowledge all the alerts by tapping the check box at the top of the table.

FILTER



You can view specific results by touching the "Filter" button

HOME CONTROL

The house icon on the second row is Home Control.



HOME CONTROL

Control all your home automation devices from one place.

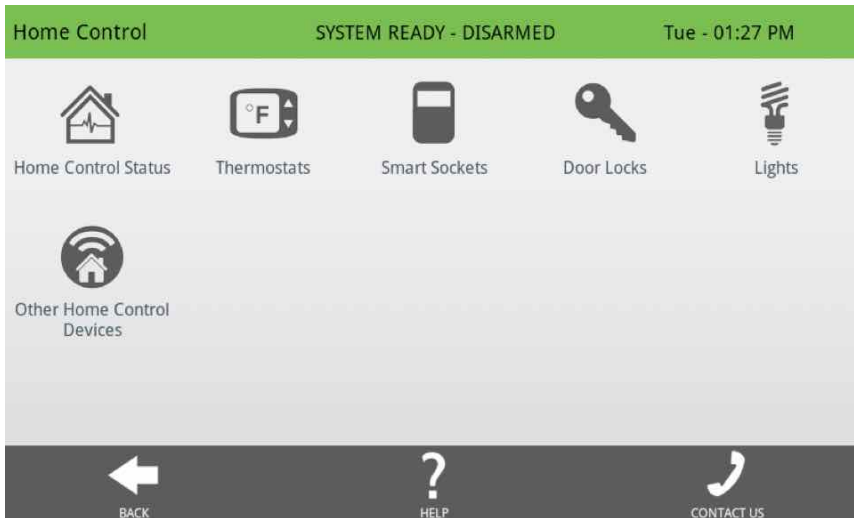

Home Control Status

See the status of all your home control devices



Thermostat

See the current temperature, adjust target temps as desired, switch from heat to cool, auto or off



Smart Socket

Control each side of the smart socket, see current energy usage



Door Locks

See lock status, battery level and send a lock or unlock command.



Lights

Control light modules from the DSC Touch, Turns lights on or off as needed



Other Home Control Devices

Devices such as Z-Wave repeaters and other misc devices that do not fall into the categories above are grouped here.

FIND IT

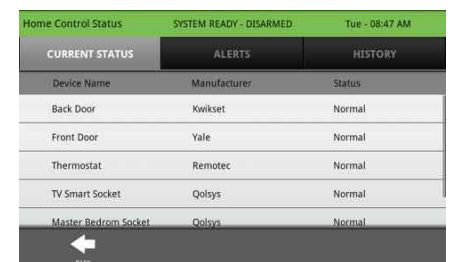

Home Control Status



Thermostats

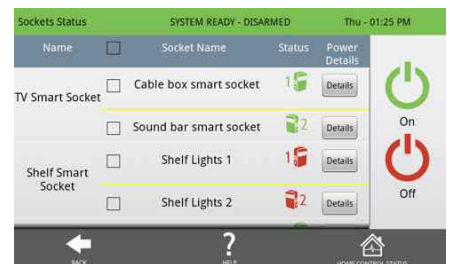

Smart Sockets



Door Locks

APPLICATIONS

The folder icon on the second row is labeled Apps.



APPS

Since the DSC Touch is built on the Android operating system, you have access to a variety of useful applications, and more to come as they are developed.



CLEAN SCREEN

Pressing this will completely deactivate the touchscreen for 30 seconds, giving you time to clean it off. Press the home button to deactivate.



SAFETY SENSORS

Add sensors in this group to be “self” monitored locations, such as pool gates, gun safes, medicine cabinets and other areas of your home that may pose a safety concern.



HISTORY

See a complete history of all the panel’s sensors and systems. (Most recent 100 items are displayed)



ALERTS

See what issues the panel may be experiencing.



PHOTO FRAME

Turn your DSC Touch into a digital photo frame when it’s not being used.



SOUND SETTINGS

Adjust the sound settings for every aspect of your DSC Touch.



LANGUAGE TOGGLE

Quickly toggle your panel’s primary language between English, Spanish and French.

FIND IT

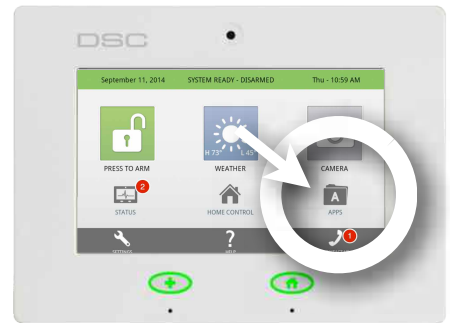

ANDROID DEVELOPERS



The DSC Touch is built on Android, which allows DSC to add Apps developed by our team as well as by others in the Android Developer Community.

NOTE: For security purposes, the DSC Touch is not open to the Android Market.

UPGRADE SERVICES



Because the DSC Touch is built on the Android platform, new applications are sure to appear in the future. These new apps will appear on your panel using the upgrade services inside in your panel.

SAFETY SENSORS

Safety Sensors are created when the system is installed, and can be accessed from the Apps page.



SAFETY SENSORS

A way to protect specific areas of your home without triggering false alarms.

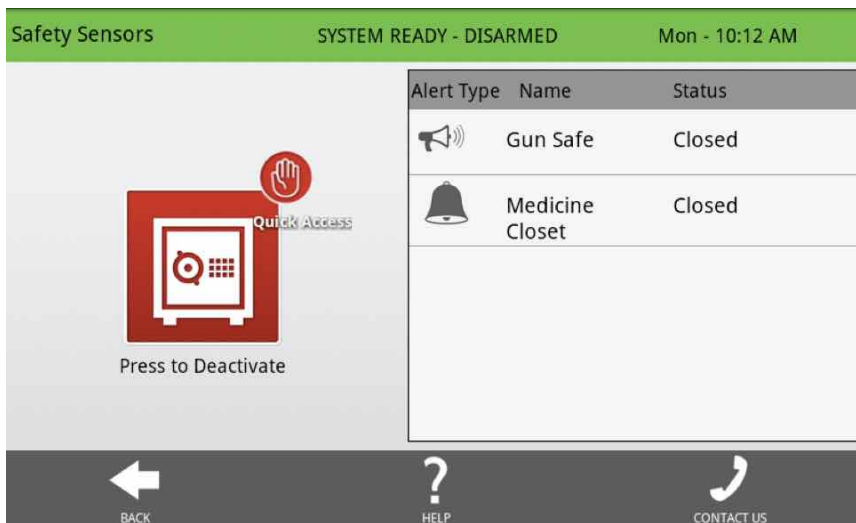

Safety sensors function independently from the intrusion security system on the DSC Touch. Safety sensors provide warning information via voice prompts and/or chimes. The warning notifications will be announced anytime that a safety sensor is opened or closed (or motion detected for motion sensors). Safety sensors are defined at the time of installation.

The Safety Sensor app allows the user to manage safety sensor behaviors. Functions are provided to Disable (turn off) the warning notifications, Quick Access (temporarily turn off the warning voice prompts and chimes), and to Enable (turn on) the warning notifications.

The right side of the display includes a list of all of the safety sensors by name and their respective status information (open, closed, or active). The right side of the display contains the safety sensor control functions.

HOW TO DISABLE SAFETY SENSORS

To turn off all of the safety sensor voice prompts and chimes, press the "Deactivate" button on the left side of the display, then enter your user code to authorize. Once disabled, safety sensors will not chime or set off the alarm.

FIND IT



ARMED ALARM

If a safety sensor is tripped while the panel is armed, it will not sound the alarm and the alarm will remain in its current state.

QUICK ACCESS



Need to access a safety sensor? Open the Safety Sensor app and press "Quick Access." You will have 300 seconds to open and close the sensor without triggering the chime.

SENSOR LOCATIONS

The following could be great areas of the home to place a safety sensor:

- Pool gate
- Garage door
- Home office
- Toddler bedroom door
- Gun safe
- Medicine cabinet
- Tool shed
- Utility room
- Cleaning supply closet

PHOTO FRAME

Press “Apps” and then select “Photo Frame.”



PHOTO FRAME

Turn your DSC Touch into a digital photo frame. Navigate. View pre loaded images or add some of your own!

When you open the Photo Frame app, you will see thumbnails of the images saved in the panel, as well as buttons to play, remove and add photos as well as a settings button.

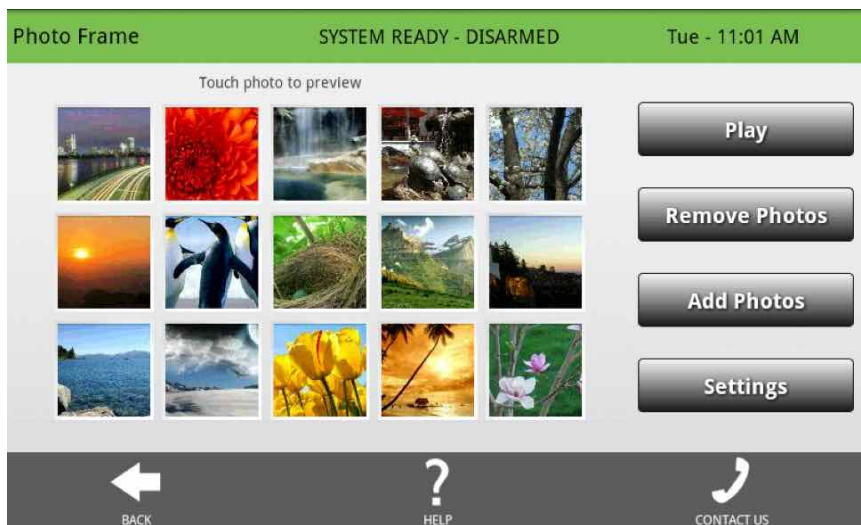

Tapping the “Settings” icon will allow you to customize your photo frame experience with preferences like duration, effects and display type .

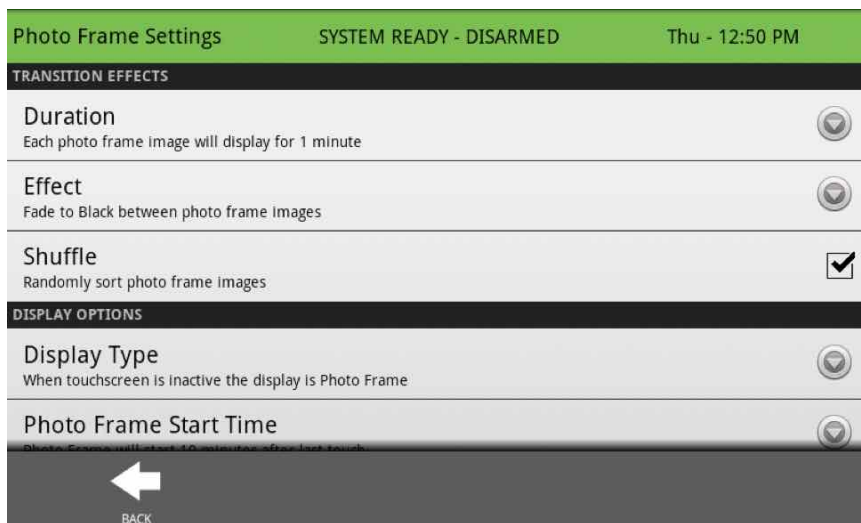

FIND IT



PREVIEW



To preview a photo, touch the picture from the photo frame app. It will expand to full screen. You can use the arrows to view the next or previous image, touch the trash can to delete an image, or go back to the Photo Frame Menu

DISPLAY TYPE



Choose a display type for your photo frame. You can opt to turn it off completely, scroll through pre loaded images or view a “weather clock”

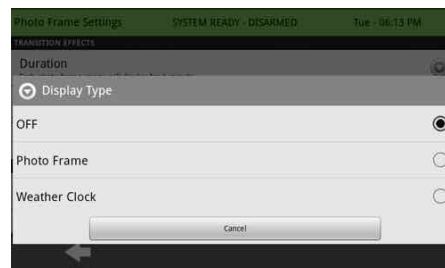

ADDING PHOTOS





- 1 Insert an SD Card* into your computer *We recommend using a "class 4" or higher SDHC card with 4gb - 16gb storage space
- 2 Open the SD Card folder and create a new folder called "Photos"
- 3 Located the new pictures you want to use, making careful note of the requirements on the right.
- 4 Copy your pictures into the "Photos" folder on the SD Card.
- 5 Safely eject the SD Card from your computer.
- 6 Insert* the SD Card into the slot on the left side of the DSC Touch.
**Do not insert SD Card into panel if power is off*



Insert card with the label facing you



Card will slide all the way in.

- 7 Touch "Apps" 
- 8 Touch "Photo Frame" 
- 9 Touch "Add Photos" 
- 10 Choose  or 
deletes all the old ones, puts your new ones on *adds your new photos to the ones already there*

The panel will load the pictures and then "unmount" the SD Card so you can safely remove it. Your new photos will appear in the preview pane. Touch a photo to view full screen or press "Play" to test.

FIND IT



PHOTO REQUIREMENTS

Any photos you put on an SD Card to use on the DSC Touch must meet the following requirements:

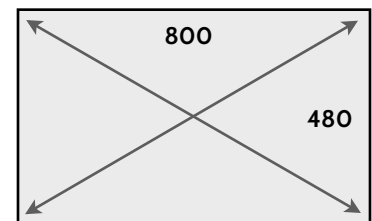

DIMENSIONS

No larger than 800x480 pixels



FILE SIZE

Less than 1MB each

FILE TYPE

jpgs only



LOCATION

Saved on a SD Card in a folder called "Photos"

QUANTITY

No more than 20 total photos

20
MAX

SOUND SETTINGS

Choose to customize your panel's sounds.



SOUND

Navigate to the "Sound" icon through the "Apps" folder or through your panel's "System Settings" to manage and customize your panel's volume, chimes, etc.

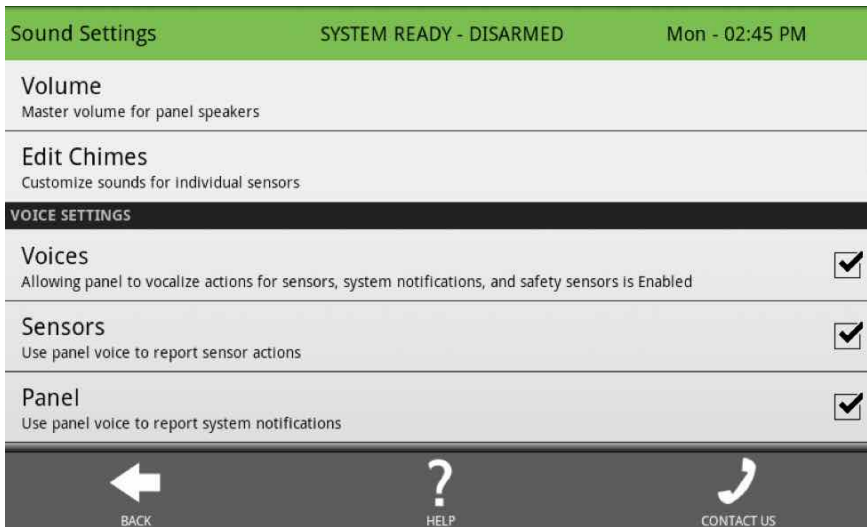

Voice Settings: Enable or disable the panel from speaking sensor names, panel status etc.

Chime Settings: The panel will "beep" or play a tone during certain system events, actions, etc. Turning these off will eliminate the beeping for most sensor and panel sounds.

Trouble Beeps: The panel will beep or sound when there is a problem that needs your attention, such as a low battery or a problem with one of your devices. Turning these off will silence the beeping, but will not dismiss the problem. Check the "Status" icon on the home screen for details.

FIND IT

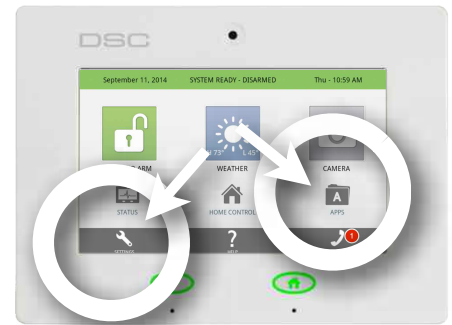

SPEAKER

Panel sounds come from the left speaker just behind the screen.

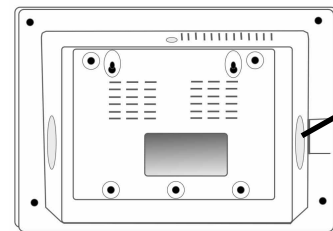

Dedicated panel sounds speaker

MASTER VOLUME

Selecting "Volume" allows you to control the panel's master volume. To adjust, touch the bar on the slider and move it from left to right.



CHANGING LANGUAGE

FIND IT



ENGLISH, FRENCH OR SPANISH

Your panel can easily switch from English to French or Spanish to accommodate your language of choice. Note: This toggle changes the words on the screen and the spoken words, but will NOT change your sensor



1



Touch "Apps"

2



Touch the "Globe" icon to toggle between English, French or Spanish. Hold the icon to set favorites.

3

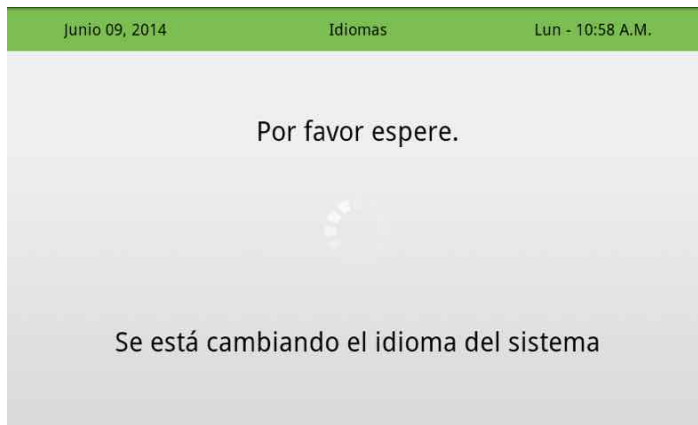

Wait while the panel switches languages

4



The panel will go back to the home screen, now shown in selected language, in this case Spanish. To reverse the process repeat the steps above.

SETTINGS

The first icon in the footer/help section is “Settings.”



SETTINGS

Inside settings you'll access a variety of options to customize the panel's interface and abilities to your location and situation. A valid master code is required to access this part of the system.

Users have the ability to adjust various settings to customize their experience. To access this area you will need to enter your master code.

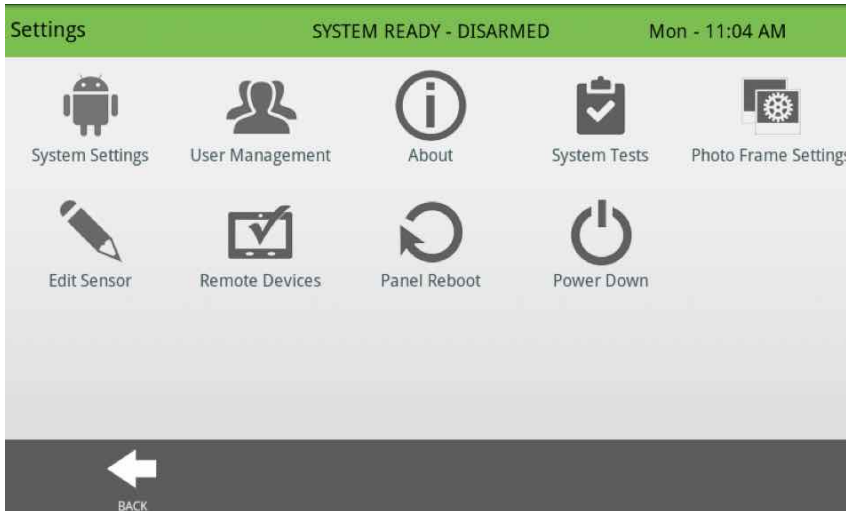

FIND IT



MASTER CODE



In order to access the system settings you'll need to enter the MASTER CODE on the account.

To add, edit, or delete user codes, select “User Management” in Settings”

While the account can have many different codes, only the master code has permission to adjust system settings.

DEFAULT CODE

For security purposes the default master code should be changed when the system has been installed in your home:

DEFAULT MASTER CODE:

1234

SYSTEM SETTINGS

From the home page, press “Settings” and then “System Settings.”



SYSTEM SETTINGS

Access basic system settings like Wi-Fi, sound, and display settings.

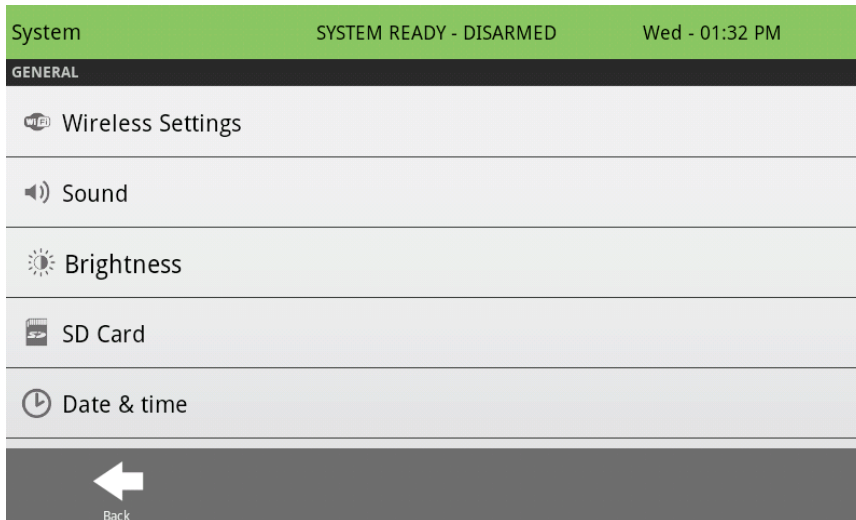

Wireless Settings

View your current network or connect to new ones

Sound

Adjust the sound settings for your panel

Brightness

Change the panel's brightness

SD Card

See whether the panel detects an SD Card, and safely “eject” that SD Card when you are done using it.

Date and Time

Your date and time should set itself automatically based on your location, but you can also set it manually here.

FIND IT



CONNECTING WI-FI



CONNECTING WI-FI

Connecting to a local Wi-Fi network will allow a wide variety of features and benefits.

To connect your panel to Wi-Fi, follow the steps below:

- 1

Press "Settings"

- 2

Enter your master code

- 3

Select "System Settings"

- 4

Select "Wireless Settings"

- 5

Select "Wi-Fi Settings"

- 6

Choose your network from the list. (You may be required to enter your wi-fi network password if you have one)

FIND IT



USERS

Access "User Management" through the "Settings" icon.



USERS

Add, delete, or edit names, access levels and individual user codes for those who access your system. You can add up to 242 users, so make sure everyone who should have access has their own code!

User Management					
SYSTEM READY - DISARMED					
Wed - 01:39 PM					
Id	Name	Type	Expiration Date	Edit	Delete
1	Admin	Master	unlimited		
2	Jeremy	Master	unlimited		
3	Erin	User	unlimited		
4	Jake	User	unlimited		
5	Grammy	User	unlimited		

Add User

BACK

The DSC Touch allows multiple users to control the system. Each user can have their own unique user code to arm, disarm and allow the panel to track user logs. Users have the ability to add, edit, or delete users by pushing the corresponding buttons on the screen. Make the desired changes and tap "Save" to exit.

Add User	
SYSTEM READY - DISARMED	
Wed - 01:40 PM	
Name	<input type="text" value="Enter Name"/>
User code	<input type="text" value="Please enter user code"/>
Confirm user code	<input type="text" value="Please confirm user code"/>
Type	User
Expiration Date	Unlimited

Add User

BACK

FIND IT



AUTO-UPDATE



When you make a change to a user, it will automatically update the information on your Alarm.com account.

If you make a change to a user on your Alarm.com portal, it will automatically update the information on your DSC Touch.

CODE TYPES



You can create users in the following categories:

Master:

Access panel functions, camera, and system settings.

User:

Access panel functions, camera, but NOT system settings.

Guest:

Used to give arm and disarm access to those users who will use the panel on a temporary basis.

SYSTEM TESTS

Press "Settings" and select "System Tests"



SYSTEM TESTS

Testing your panel's various communication paths are essential in the upkeep of your alarm.

The panel provides a variety of different tests you can use to make sure everything is communicating accurately and effectively.

FIND IT

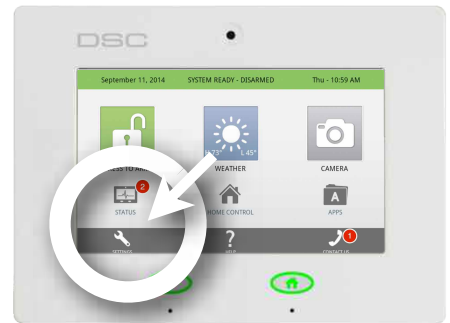

TEST WEEKLY



Test your system regularly (we suggest on a weekly basis). Ask your security provider for details.

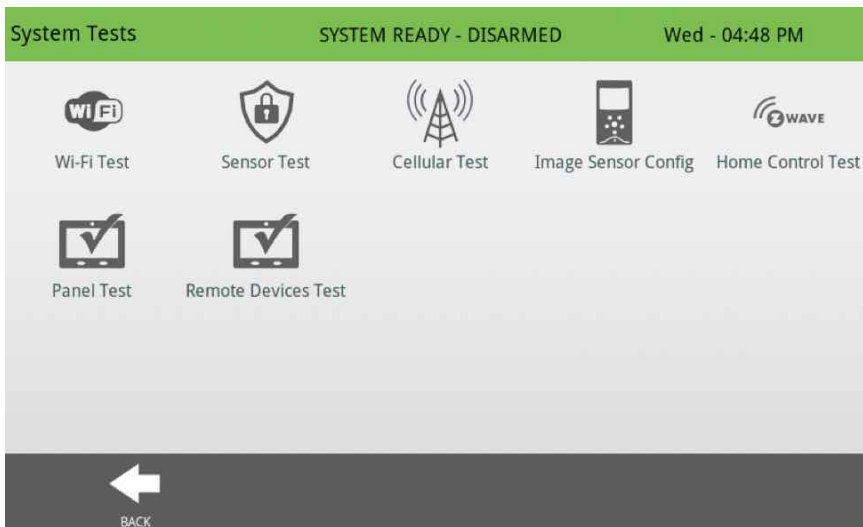

WI-FI TEST

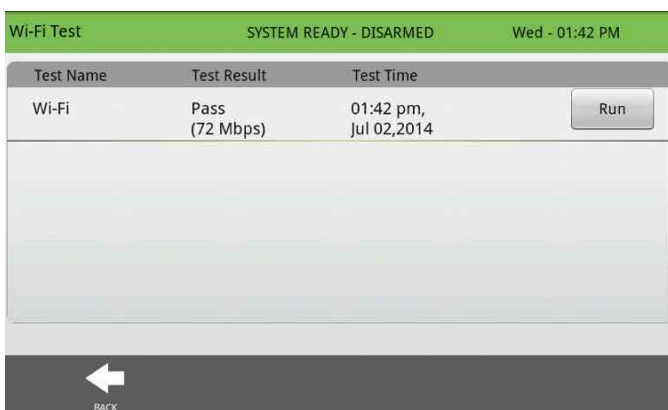

Test your Wi-Fi connection often to ensure a strong connection. *Please note: The test will check the panel's connection to your network or router, but will NOT verify if the router has internet connectivity*

SENSOR TEST



Perform a sensor test regularly. We recommend once a week to ensure all devices keep a strong signal.

EDIT SENSOR

Edit the name and behavior of a sensor in the system.



EDIT SENSOR

Edit a sensor name and chime with which it's associated. Navigate to "Settings" then "Edit Sensors"

Edit Sensor						
SYSTEM READY - DISARMED						
Wed - 01:04 PM						
No	Id	Type	Name	Group	Chime	Edit
1	D203A0	Door/Window	Front Door	10-Entry-Exit-Normal Delay	High wire	
2	DA03A0	Door/Window	Back Door	13-Instant Perimeter D/W	High wire	
3	6A83A6	Door/Window	Door from garage	12-Entry-Exit-Long Delay	High wire	
4	5D1DA1	Tilt	Garage Tilt	12-Entry-Exit - Long Delay	High wire	
		Door/	Girls bedroom	13-Instant Perimeter		

← BACK

Edit a sensor by using our list from the drop down or customize your own. Choose a chime that suits it's location and whether or not yo'd like the panel to announce the sensor name by toggling voice prompts.

Show Details	
SYSTEM READY - DISARMED	
Tue - 11:52 AM	
Sensor DL Id	BB03A0
Sensor Name	Master Bedroom Door
Chime Type	High Wire
Voice Prompts	On
Save	

← BACK

Make any changes you like and click "save" to exit.

FIND IT



CUSTOM TEXT TO SPEECH



Because the DSC Touch uses an Android operating system, it can read almost any name and speak it when the sensor is opened.

Customize your system with specific names like "Megan's Upstairs Window"

To customize a sensor name, select "Custom Description" under "Sensor Name"

Custom Description

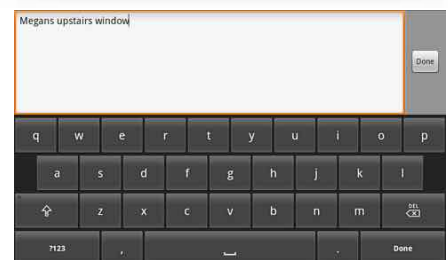

PANEL REBOOT



PANEL REBOOT

Sometimes technology needs a swift kick. Simply reboot your panel to keep it in line!

1



Touch "Settings"

2



Enter your master code

3

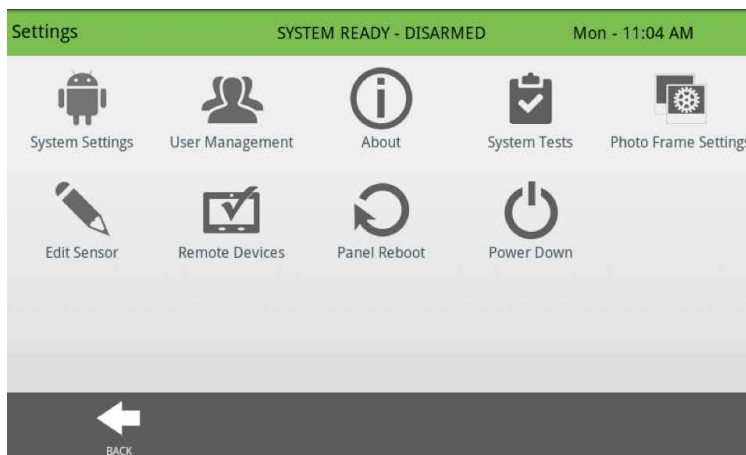

Touch "Panel Reboot"

4

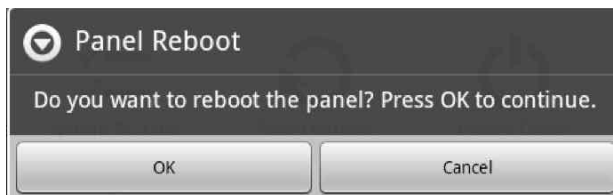

Touch "OK" when the panel reboot pop up appears. Allow up to 5 mins for your panel to come back online.

FIND IT

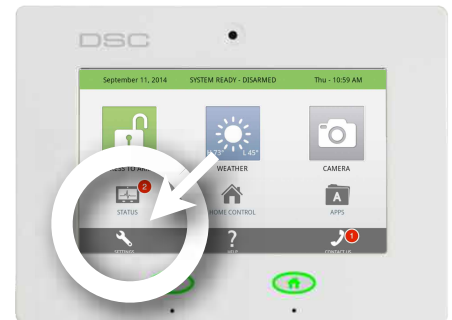

HELP

The second icon in the footer is “Help”



HELP APP

The “Help” app is divided into three sections: Video tutorials, FAQs, and Contact Us

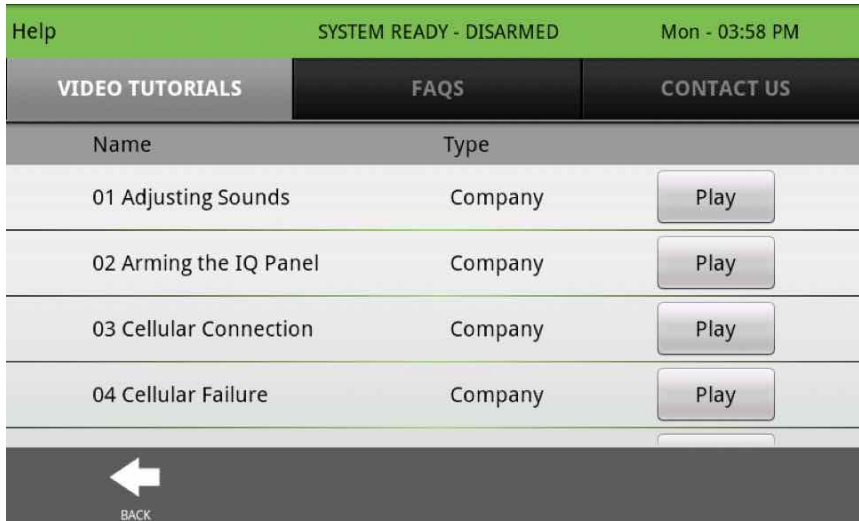

To watch a video, select the Video Tutorials tab and press “Play”

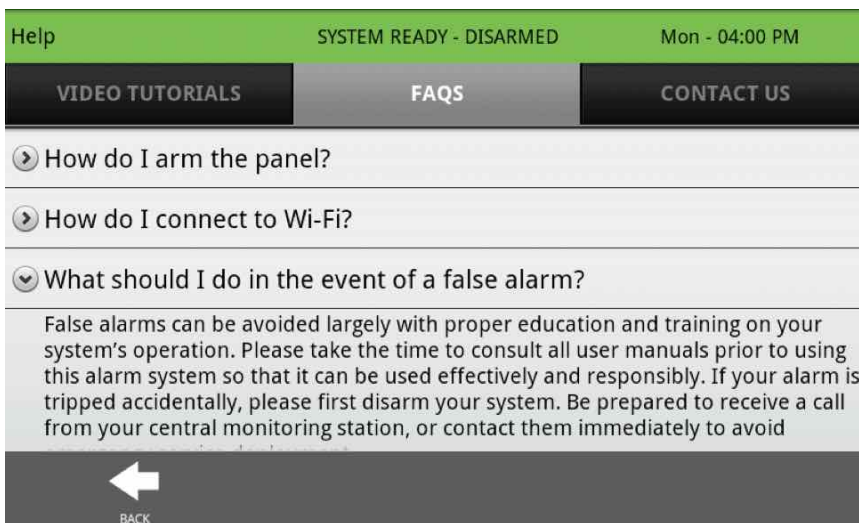

The FAQs tab shows answers to “Frequently Asked Questions”.

FIND IT



VIDEO TUTORIALS

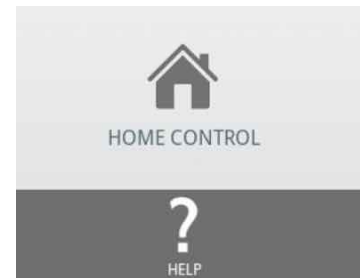

The built in library of video tutorials includes video instructions on common questions like “User Codes” and “Connecting Wi-Fi”

FAQs



The panel also has a tab with frequently asked questions that allow a user to find an answer the most common questions.

To access these questions, tap the “Help” icon and select “FAQs”. The questions appear in a list and can be expanded by touching the arrow on the left.

CONTACT US

Select the “Contact Us” icon in the bottom right corner.



CONTACT US

Touching the “Contact Us” icon on the bottom right of your screen allows you to view your security provider’s contact information.

(NOTE: the information shown here is for demonstration purposes only. Please refer to your own panel for your provider’s information)

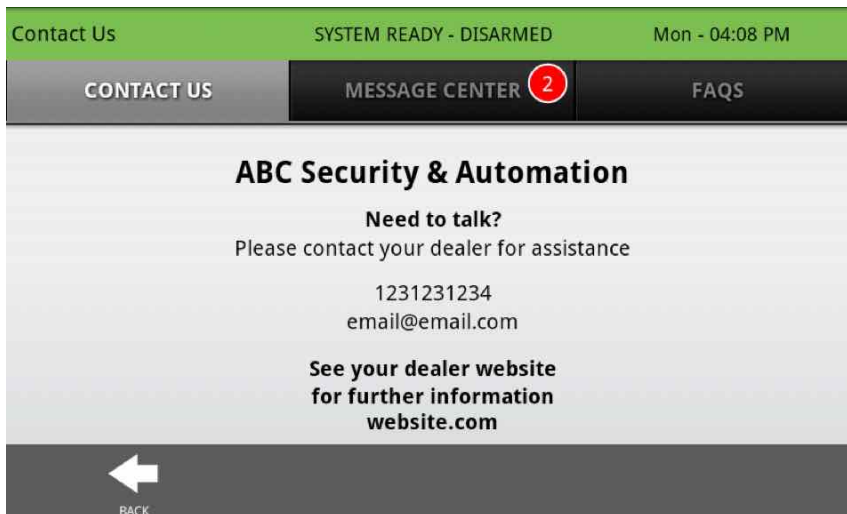

The message center tab holds messages from your security provider. To dismiss a message, touch the box to the left.

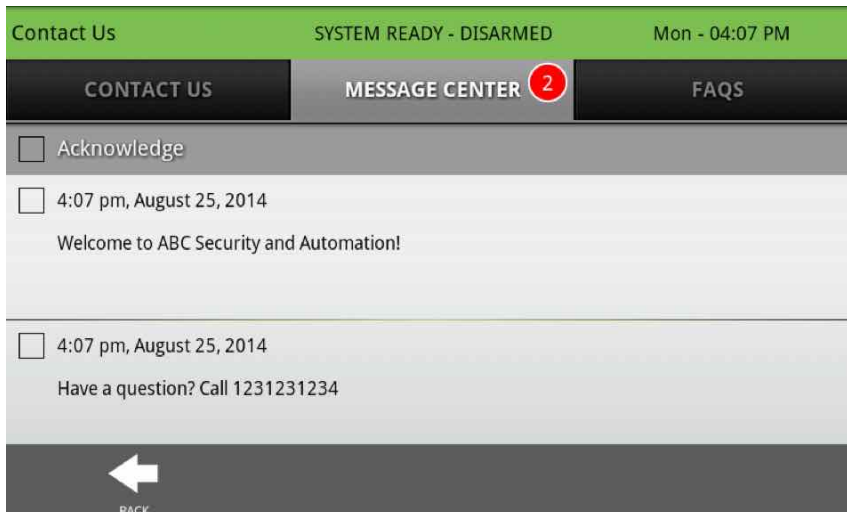

FIND IT



NOTE:

In some cases, the “phone” icon shown here may be replaced with your security and home control provider’s logo.

LEGAL

This document is subject to change without notice. Tyco Safety Products Canada, Ltd. ("DSC") assumes no responsibility for errors or omissions and disclaims any liabilities and losses experienced as a result of using this document. For the most recent documentation, contact your local vendor.

This document may contain images or information used in normal operations of the DSC Touch (the "Product"). These may include fictitious names of people and companies. Any similarity to actual names and addresses of businesses or persons is coincidental.

A. EULA WARNING: READ CAREFULLY

Note to Installers

This warning contains vital information. As the only individual in contact with system users, it is your responsibility to bring each item in this warning to the attention of the users of this system.

System Failures

This system has been carefully designed to be as effective as possible. There are circumstances, however, involving fire, burglary, or other types of emergencies where it may not provide protection. Any alarm system of any type may be compromised deliberately or may fail to operate as expected for a variety of reasons. Some but not all of these reasons may be:

• Inadequate Installation

A security system must be installed properly in order to provide adequate protection. Every installation should be evaluated by a security professional to ensure that all access points and areas are covered. Locks and latches on windows and doors must be secure and operate as intended. Windows, doors, walls, ceilings and other building materials must be of sufficient strength and construction to provide the level of protection expected. A reevaluation must be done during and after any construction activity.

An evaluation by the fire and/or police department is highly recommended if this service is available.

• Criminal Knowledge

This system contains security features which were known to be effective at the time of manufacture. It is possible for persons with criminal intent to develop techniques which reduce the effectiveness of these features. It is important that a security system be reviewed periodically to ensure that its features remain effective and that it be updated or replaced if it is found that it does not provide the protection expected.

• Access by Intruders

Intruders may enter through an unprotected access point, circumvent a sensing device, evade detection by moving through an area of insufficient coverage, disconnect a warning device, or interfere with or prevent the proper operation of the system.

• Power Failure

Control units, intrusion detectors, smoke detectors and many other security devices require an adequate power supply for proper operation. If a device operates from batteries, it is possible for the batteries to fail. Even if the batteries have not failed, they must be charged, in good condition and installed correctly. If a device operates only by AC power, any interruption, however brief, will render that device inoperative while it does not have power. Power interruptions of any length are often accompanied by voltage fluctuations which may damage electronic equipment such as a security system. After a power interruption has occurred, immediately conduct a complete system test to ensure that the system operates as intended.

• Failure of Replaceable Batteries

This system's wireless transmitters have been designed to provide several years of battery life under normal conditions. The expected battery life is a function of the device environment, usage and type. Ambient conditions such as high humidity, high or low temperatures, or large temperature fluctuations may reduce the expected battery life. While each transmitting device has a low battery monitor which identifies when the batteries need to be replaced, this monitor may fail to operate as expected. Regular testing and maintenance will keep the system in good operating condition.

• Compromise of Radio Frequency (Wireless) Devices

Signals may not reach the receiver under all circumstances which could include metal objects placed on or near the radio path or deliberate jamming or other inadvertent radio signal interference.

• System Users

A user may not be able to operate a panic or emergency switch possibly due to permanent or temporary physical disability, inability to reach the device in time, or unfamiliarity with the correct operation. It is important that all system users be trained in the correct operation of the alarm system and that they know how to respond when the system indicates an alarm.

• Smoke Detectors

Smoke detectors that are a part of this system may not properly alert occupants of a fire for a number of reasons, some of which follow. The smoke detectors may have been improperly installed or positioned. Smoke may not be able to reach the smoke detectors, such as when the fire is in a chimney, walls or roofs, or on the other side of closed doors. Smoke detectors may not detect smoke from fires on another level of the residence or building.

Every fire is different in the amount of smoke produced and the rate of burning. Smoke detectors cannot sense all types of fires equally well. Smoke detectors may not provide timely warning of fires caused by carelessness or safety hazards such as smoking in bed, violent explosions, escaping gas, improper storage of flammable materials, overloaded electrical circuits, children playing with matches or arson.

Even if the smoke detector operates as intended, there may be circumstances when there is insufficient warning to allow all occupants to escape in time to avoid injury or death.

• Motion Detectors

Motion detectors can only detect motion within the designated areas as shown in their respective installation instructions. They cannot discriminate between intruders and intended occupants. Motion detectors do not provide volumetric area protection. They have multiple beams of detection and motion can only be detected in unobstructed areas covered by these beams. They cannot detect motion which occurs behind walls, ceilings, floor, closed doors, glass partitions, glass doors or windows. Any type of tampering whether intentional or unintentional such as masking, painting, or spraying of any material on the lenses, mirrors, windows or any other part of the detection system will impair its proper operation.

Passive infrared motion detectors operate by sensing changes in temperature. However their effectiveness can be reduced when the ambient temperature rises near or above body temperature or if there are intentional or unintentional sources of heat in or near the detection area. Some of these heat sources could be heaters, radiators,

LEGAL (Cont.)

stoves, barbeques, fireplaces, sunlight, steam vents, lighting and so on.

- **Warning Devices**

Warning devices such as sirens, bells, horns, or strobes may not warn people or waken someone sleeping if there is an intervening wall or door. If warning devices are located on a different level of the residence or premise, then it is less likely that the occupants will be alerted or awakened. Audible warning devices may be interfered with by other noise sources such as stereos, radios, televisions, air conditioners or other appliances, or passing traffic. Audible warning devices, however loud, may not be heard by a hearing-impaired person.

- **Telephone Lines**

If telephone lines are used to transmit alarms, they may be out of service or busy for certain periods of time. Also an intruder may cut the telephone line or defeat its operation by more sophisticated means which may be difficult to detect.

- **Insufficient Time**

There may be circumstances when the system will operate as intended, yet the occupants will not be protected from the emergency due to their inability to respond to the warnings in a timely manner. If the system is monitored, the response may not occur in time to protect the occupants or their belongings.

- **Component Failure**

Although every effort has been made to make this system as reliable as possible, the system may fail to function as intended due to the failure of a component.

- **Inadequate Testing**

Most problems that would prevent an alarm system from operating as intended can be found by regular testing and maintenance. The complete system should be tested weekly and immediately after a break-in, an attempted break-in, a fire, a storm, an earthquake, an accident, or any kind of construction activity inside or outside the premises. The testing should include all sensing devices, keypads, consoles, alarm indicating devices and any other operational devices that are part of the system.

- **Security and Insurance**

Regardless of its capabilities, an alarm system is not a substitute for property or life insurance. An alarm system also is not a substitute for property owners, renters, or other occupants to act prudently to prevent or minimize the harmful effects of an emergency situation.

B. Trademarks and patents *DSC, the DSC Touch name, and the DSC logo are trademarks of Tyco Safety Products of Canada Ltd.*

You agree that all of DSC's trademarks, trade names, service marks and other DSC logos and brand features, and product and service names are trademarks and the property of Tyco Safety Products of Canada Ltd. (the "DSC Marks"). Without DSC's prior permission, you agree not to display or use in any manner the DSC Marks. Trade names used herein may be trademarks or registered trademarks of the manufacturers or sellers of the respective products. This Product and the use of this Product may be covered by one or more patents.

C. Limited warranty.

Digital Security Controls warrants the original purchaser that for a period of twelve months from the date of purchase, the product shall be free of defects in materials and workmanship under normal use. During the warranty period, Digital Security Controls shall, at its option, repair or replace any defective product upon return of the product to its factory, at no charge for labour and materials. Any replacement and/or repaired parts are warranted for the remainder of the original warranty or ninety (90) days, whichever is longer. The original purchaser must promptly notify Digital Security Controls in writing that there is defect in material or workmanship, such written notice to be received in all events prior to expiration of the warranty period. There is absolutely no warranty on software and all software products are sold as a user license under the terms of the software license agreement included with the product. The Customer assumes all responsibility for the proper selection, installation, operation and maintenance of any products purchased from DSC. Custom products are only warranted to the extent that they do not function upon delivery. In such cases, DSC can replace or credit at its option.

International Warranty

The warranty for international customers is the same as for any customer within Canada and the United States, with the exception that Digital Security Controls shall not be responsible for any customs fees, taxes, or VAT that may be due.

Warranty Procedure

To obtain service under this warranty, please return the item(s) in question to the point of purchase. All authorized distributors and dealers have a warranty program. Anyone returning goods to Digital Security Controls must first obtain an authorization number. Digital Security Controls will not accept any shipment whatsoever for which prior authorization has not been obtained.

Conditions to Void Warranty

This warranty applies only to defects in parts and workmanship relating to normal use. It does not cover:

- damage incurred in shipping or handling;
- damage caused by disaster such as fire, flood, wind, earthquake or lightning;
- damage due to causes beyond the control of Digital Security Controls such as excessive voltage, mechanical shock or water damage;
- damage caused by unauthorized attachment, alterations, modifications or foreign objects;
- damage caused by peripherals (unless such peripherals were supplied by Digital Security Controls);
- defects caused by failure to provide a suitable installation environment for the products;
- damage caused by use of the products for purposes other than those for which it was designed;
- damage from improper maintenance;
- damage arising out of any other abuse, mishandling or improper application of the products.

Items Not Covered by Warranty

In addition to the items which void the Warranty, the following items shall not be covered by Warranty: (i) freight cost to the repair centre; (ii) products which are not identified with DSC's product label and lot number or serial number; (iii) products disassembled or repaired in such a manner as to adversely affect performance or prevent adequate inspection or testing to verify any warranty claim. Access cards or tags returned for replacement under warranty will be credited or replaced at DSC's option. Products not covered by this warranty, or otherwise out of warranty due to age, misuse, or damage shall be evaluated, and a repair estimate shall be provided. No repair work will be performed until a valid purchase order is received from the Customer and a Return Merchandise Authorization number (RMA) is issued by DSC's Customer Service.

Digital Security Controls' liability for failure to repair the product under this warranty after a reasonable number of attempts will be limited to a replacement of the product, as the exclusive remedy for breach of warranty. Under no circumstances shall Digital Security Controls be liable for any special, incidental, or consequential damages based upon breach of warranty, breach of contract, negligence, strict liability, or any other legal theory. Such damages include, but are not limited to, loss of profits, loss of the product or any associated equipment, cost of capital, cost of substitute or replacement equipment, facilities or services, down time, purchaser's time, the claims of third parties, including customers, and injury to property. The laws of some jurisdictions limit or do not allow the disclaimer of consequential damages. If the laws of such a jurisdiction apply to any claim by or against DSC, the limitations and disclaimers contained here shall be to the greatest extent permitted by law. Some states do not allow the exclusion or limitation of incidental or consequential damages, so that the above may not apply to you.

LEGAL (Cont.)

Disclaimer of Warranties

This warranty contains the entire warranty and shall be in lieu of any and all other warranties, whether expressed or implied (including all implied warranties of merchantability or fitness for a particular purpose) And of all other obligations or liabilities on the part of Digital Security Controls. Digital Security Controls neither assumes responsibility for, nor authorizes any other person purporting to act on its behalf to modify or to change this warranty, nor to assume for it any other warranty or liability concerning this product. This disclaimer of warranties and limited warranty are governed by the laws of the province of Ontario, Canada.

WARNING: Digital Security Controls recommends that the entire system be completely tested on a regular basis. However, despite frequent testing, and due to, but not limited to, criminal tampering or electrical disruption, it is possible for this product to fail to perform as expected.

Installer's Lockout

Any products returned to DSC which have the Installer's Lockout option enabled and exhibit no other problems will be subject to a service charge.

Out of Warranty Repairs

Digital Security Controls will at its option repair or replace out-of-warranty products which are returned to its factory according to the following conditions. Anyone returning goods to Digital Security Controls must first obtain an authorization number. Digital Security Controls will not accept any shipment whatsoever for which prior authorization has not been obtained. Products which Digital Security Controls determines to be repairable will be repaired and returned. A set fee which Digital Security Controls has predetermined and which may be revised from time to time, will be charged for each unit repaired.

Products which Digital Security Controls determines not to be repairable will be replaced by the nearest equivalent product available at that time. The current market price of the replacement product will be charged for each replacement unit.

D. Intended use

Use the Product for its intended use only; refer to the data sheet and user documentation. Any use other than the Product's intended use will void any applicable warranties. For the latest Product information, contact your local vendor or visit us online at [DSC URL](#)

E. FCC compliance

Changes or modifications not expressly approved by DSC can void the user's authority to operate the Product. This Product has been tested and found to comply with FCC Rules.

This Product generates, uses, and can radiate radio frequency energy and, if not installed and used in accordance with the instructions, may cause harmful interference to radio communications. However, there is no guarantee that interference will not occur in a particular installation.

If this Product does cause harmful interference to radio or television reception, which can be determined by turning the equipment off and on, the user is encouraged to try to correct the interference by one or more of the following measures:

Reorient or relocate the receiving antenna.

Increase the separation between the Product and receiver.

Connect the affected equipment and the Product to separate outlets, on different branch circuits.

Consult the dealer or an experienced radio/TV technician for help.

CAUTION! This equipment complies with radiation exposure limits set forth for uncontrolled environment. The antenna(s) used for this transmitters must be installed to provide a separation distance of at least 20 cm from all persons and must not be collocated or operating in conjunction with any other antenna or transmitter.

F. WARNINGS

Warning: Do not connect the Product to an AC receptacle that is controlled by a switch.

Warning: Do not connect the Product to a High Power AC receptacle.

Warning: This Product should be installed in accordance with the National Fire Alarm Code, ANSI/NFPA 72, (National Fire Protection Association, Batterymarch Park, Quincy, MA 02269). Printed information describing proper installation, operation, testing, maintenance, evacuation planning, and repair service is to be provided with this Product.

Warning: Owner's instruction notice: The Product is not to be removed by anyone except occupant or certified dealer representative.

Warning: This Product and all sensors associated with it (collectively, the "System") should be tested once a week.

Warning: This System must be checked by a qualified technician at least once every three (3) years.

Warning: Users are advised to create their own Fire and Emergency Evacuation plan. Information to create a plan can be found at the following website, National Fire Protection Association (<http://www.nfpa.org/categoryList.asp?categoryID=1979>), United States Fire Administration (<https://apps.usfa.fema.gov/publications/>) or via other equivalent agencies.

Warning: This System cannot call the local police station directly ... all Police Panic Alarms and Intrusion Alarms will be sent to the dealer authorized central monitoring station who will then handle calling the local police as necessary. The Product cannot be configured to call the local police station.

Warning: This System cannot call the local fire station directly ... all Fire Panic Alarms and Fire Detection Alarms will be sent to the dealer authorized central monitoring station who will then handle calling the local Fire Department as necessary. The Product cannot be configured to call the local Fire Department.

Warning: This System cannot call the local medical emergency personnel directly ... all Medical Panic Alarms will be sent to the dealer authorized central monitoring station who will then handle calling the local medical emergency personnel (often 911 personnel) as necessary. The Product cannot be configured to call the local medical emergency personnel (nor local 911 services).

Warning: The terminal block that is mounted inside the Product has 8 connectors for wires. There are two additional connectors for the first external sensor (labeled EXT1 + and EXT1 -), two additional connectors for the second external sensor (labeled EXT2 + and EXT2 -), and finally, two additional connectors for an external siren (labeled BUZZER + and BUZZER -).

LEGAL (Cont.)

G. BATTERY INFORMATION & WARNINGS

Main AC-DC Supply Converter

Voltage	Input 100-240V (AC-DC converter)
frequency,	50/60hz
max. input current	0.68A Max
Voltage	output 12V, 2A

Panel Battery

Battery Type	Lithium Ion Polymer battery
Lifetime Power Cycles	300+ Power Cycles (fully charged to fully discharged state)
DC voltage	8.4V max
battery model number	Springpower 704077
max. charging current	400mA
trickle charge current	50mA max
battery capacity in ampere-hours	2500maH

Warning: Battery Capacity Detection: The battery will be automatically monitored for low battery capacity. Warning messages will be sent to the Product and to the Alarm.com Backend informing the customer of the low battery condition (this occurs whenever the current battery capacity falls below 30% of the fully charged capacity). The Product will also provide optional trouble beep warnings for the low battery conditions. The Product warning messages can be viewed on the Security Status / Alerts Tab.

Warning: Battery Unplugged Detection: The battery will be automatically monitored to detect occurrences of the battery being unplugged. Warning messages will be sent to the Product and to the ADC Backend informing the customer of the unplugged battery. The Product will also provide optional trouble beep warnings for the unplugged battery condition. The Product warning messages can be viewed on the Security Status / Alerts Tab.

Warning: Battery Life: Greater than 5 years with use of the Product according to specifications. Change the battery after 5 years of service. .

Warning: Battery Handling: To maximize the life of the battery and for safety reasons the following precautions should be taken:

- The aluminum foil encasing the battery is delicate and should not be exposed to sharp objects such as knives, pins or sharp finger nails
- The battery should not be exposed to water
- Do not leave near a heat source. This will reduce the working life of the battery
- Do not short circuit the battery by connecting the positive terminal to the negative terminal. High currents can be generated resulting in high temperatures and risking fire and personal injury

H. FALSE ALARM WARNINGS

The following warnings cover the likely potential situations that may cause False Alarms Reports (FAR) to be generated.

Cause of FAR: User fails to enter proper pass code or enters the wrong pass code while trying to disarm system.

Prevention: Carefully enter your passcode. Remember your passcode and/or write it down in a safe place that is easily accessible.

Cause of FAR: User fails to exit premise before exit delay timer expires while trying to arm system in Away Mode.

Prevention: Listen to exit beeps and last 10 second voice countdown ... if running out of time, then either press the Extend button to extend the exit delay or press cancel ... and then start the rearming process again once you are ready to leave the premises.

Cause of FAR: User opens a door, but fails to close the door before the exit delay timer expires while trying to arm system in Away Mode, thus causing an exit fault and alarm condition.

Prevention: Be careful to close the door tightly upon exit during the arming process. If an exit fault / alarm does occur, then quickly reenter the home and disarm the alarm.

Cause of FAR: Erroneous fire detection alarm from sensor.

Prevention: During installation, system can be set to require two fire sensor detections prior to generating central monitoring station fire alarm ... note a local fire alarm will still sound to alert the homeowner.

Cause of FAR: Erroneous Carbon Monoxide detection alarm from sensor.

Prevention: During installation, system can be set to require two Carbon Monoxide sensor detections prior to generating central monitoring station gas leak alarm ... note a local fire alarm will still sound to alert the homeowner.

LEGAL (Cont.)

Cause of FAR: Erroneous user fire, medical or police panic alarm generated.

Prevention: Do not press the Emergency button unless there is a real emergency. If the emergency alarm is accidentally activated, then quickly enter the disarm pass code which will then cancel the alarm.

I. Insert warnings from DSC Warnings terms

This equipment has been tested and found to comply with the limits for a Class B digital device, pursuant to part 15 of the FCC Rules. These limits are designed to provide reasonable protection against harmful interference in a residential installation. This equipment generates, uses and can radiate radio frequency energy and, if not installed and used in accordance with the instructions, may cause harmful interference to radio communications. However, there is no guarantee that interference will not occur in a particular installation. If this equipment does cause harmful interference to radio or television reception, which can be determined by turning the equipment off and on, the user is encouraged to try to correct the interference by one or more of the following measures:

- Reorient or relocate the receiving antenna.
- Increase the separation between the equipment and receiver.
- Connect the equipment into an outlet on a circuit different from that to which the receiver is connected.
- Consult the dealer or an experienced radio/TV technician for help.

This Class [B] digital apparatus meets all requirements of the Canadian Interference-Causing Equipment Regulations.
Cet appareil numérique de la classe [B] respecte toutes les exigences du Règlement sur le matériel brouilleur du Canada.

IMPORTANT! Changes or modifications not expressly approved by DSC could void the user's authority to operate the equipment.

This device complies with Industry Canada license-exempt RSS standard(s). Operation is subject to the following two conditions: (1) this device may not cause interference, and (2) this device must accept any interference, including interference that may cause undesired operation of the device

CAUTION! *This equipment complies with radiation exposure limits set forth for uncontrolled environment. The antenna(s) used for this transmitters must be installed to provide a separation distance of at least 20 cm from all persons and must not be collocated or operating in conjunction with any other antenna or transmitter.*

Cet appareil est conforme avec Industrie Canada RSS exemptes de licence standard (s). Son fonctionnement est soumis aux deux conditions suivantes: (1) ce dispositif ne doit pas causer d'interférences, et (2) cet appareil doit accepter toute interférence, y compris celles pouvant causer un mauvais fonctionnement de l'appareil

ATTENTION! Cet équipement est conforme aux limites d'exposition aux rayonnements définies pour environnement non contrôlé. L'antenne (s) utilisé pour cette émetteurs doit être installé pour fournir une distance de séparation d'au moins 20 cm de toute personne et ne doit pas être installé à proximité ou utilisé en conjonction avec une autre antenne ou émetteur.

This device complies with Part 15 of the FCC Rules. Operation is subject to the following two conditions: (1) this device may not cause harmful interference, and (2) this device must accept any interference received, including interference that may cause undesired operation.