

REVISIONS				
REV.	ACC.	DESCRIPTION	DRN.	DATE
Δ	6/2 MAIL	CHANGE ENGRAVING RAISED TO CAVE	Etic	6/2-'16

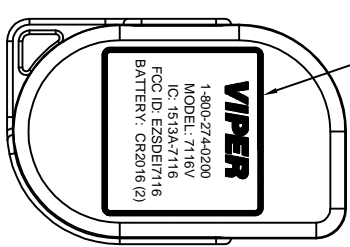
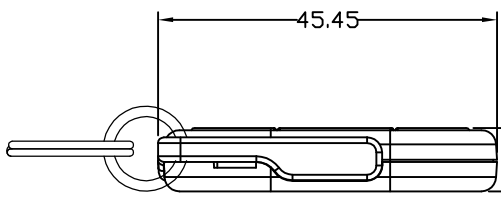
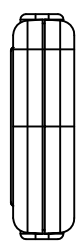
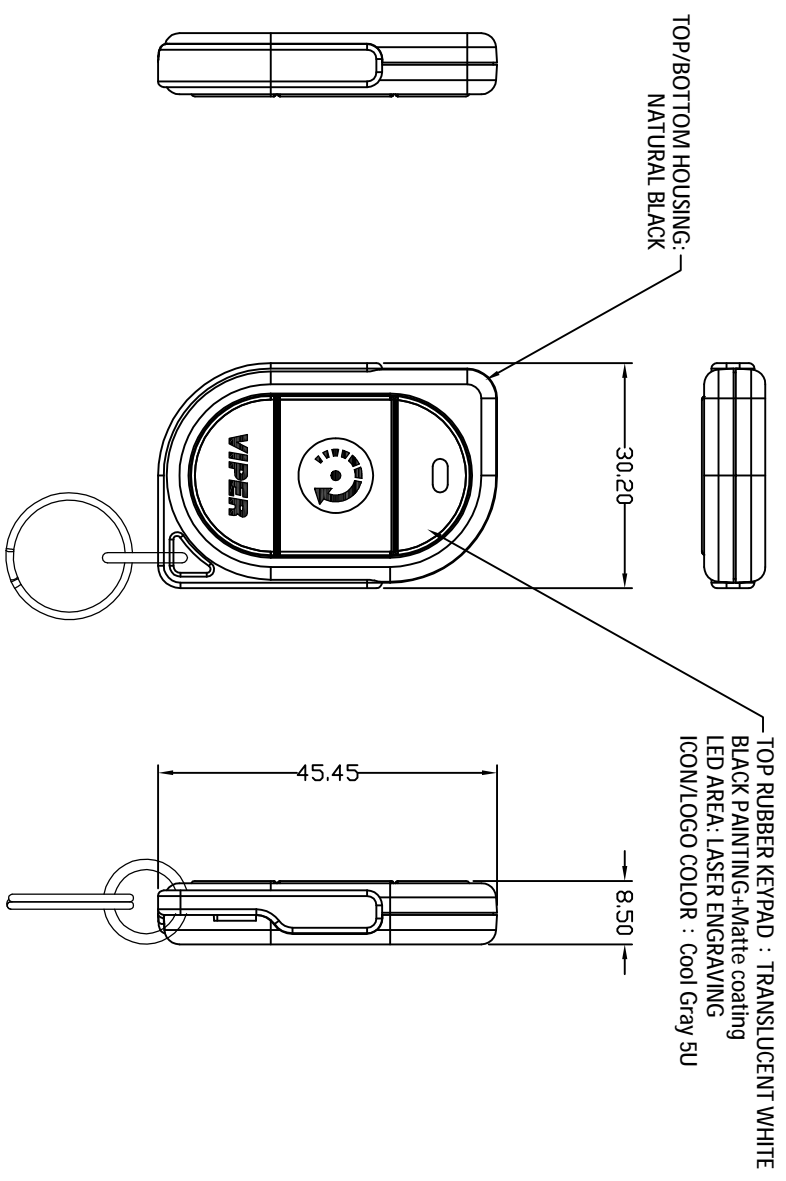

PART	P/N
CASE	IADR4001
RUBBER	NKDR4BA0
KEY CHAIN	MA16D000

BODY MATERIAL : PC+ABS  
 1. Texture is same as MT-11010  
 2. Raddious will be 0.2 If not specified.

\*Tolerance please refer specification of tolerance for this drawing.

Dimension	A	B	C
UNDER 6	0.08	0.16	0.30
6-30	0.10	0.20	0.40
30-120	0.20	0.40	0.80
120-300	0.40	0.80	2.00

SCALE: 1:1	UNIT: M/M	DRN BY: Etic	DATE: 3/4-'16	TITLE: NUTEK CORPORATION	
MATERIAL	CHK BY: YYS	APPD BY: Vicior	6/2-'16	SIZE: A4	DEPT: 7116V
FINISH				DRAWING NO: 10510020	REV: 1
CODE		SHEET	OF		

REVISIONS				
REV.	ACC.	DESCRIPTION	DRN.	DATE
1	2016/2/22	MODIFY LOGO	FELIX	2016/2/22
2		MODIFY ENGRAVED	FELIX	2016/4/8

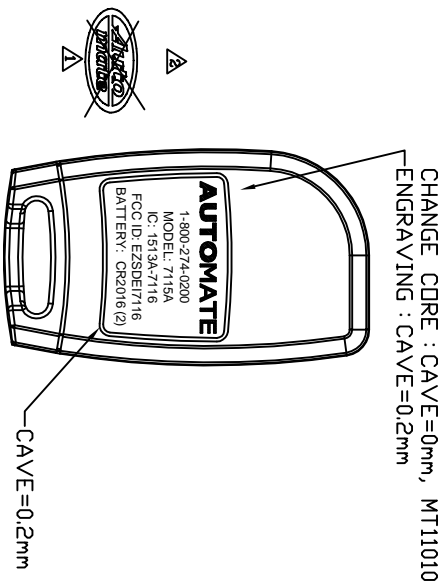
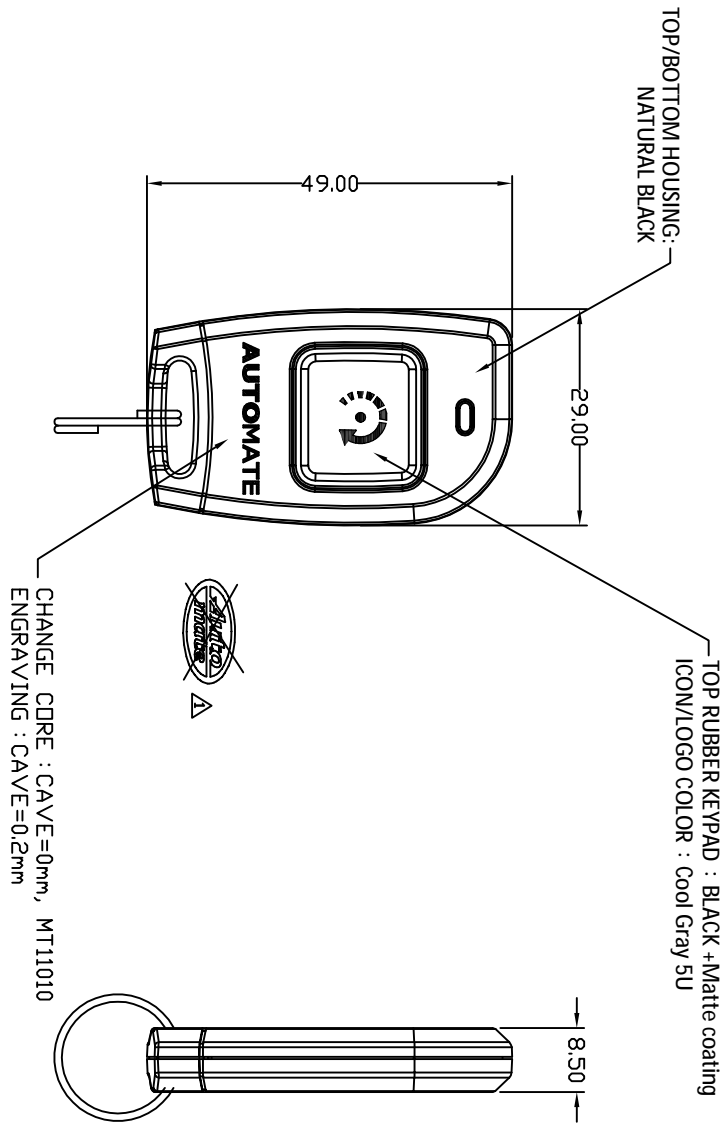

PART	P/N
CASE	IADRE0A1
RUBBER	NKDR50A0
KEY CHAIN	MA150000

\*Tolerance please refer specification of tolerance table, unit: mm.

Dimension	A	B	C
UNDER 6	0.08	0.16	0.30
6-30	0.10	0.20	0.40
30-120	0.20	0.40	0.80
120-300	0.40	0.80	2.00

BODY MATERIAL : PC+ABS  
1. Texture is same as MT-11010  
2. Raddious will be 0.2 If not specified.

SCALE: 1:1	UNIT: M/M	DRN BY: FELIX	DATE: 2016/2/4
MATERIAL	CHK BY: YYS	APPD BY: VICIOR	SHEET: OF
FINISH			
CODE			

NUTEK CORPORATION  
DEI  
NEW 7115A

SIZE: A4	DEPT: 10510040	DRAWING NO: 10510040	REV: 2
----------	----------------	----------------------	--------