

REVISIONS				
REV.	ACC.	DESCRIPTION	DRN.	DATE
△				

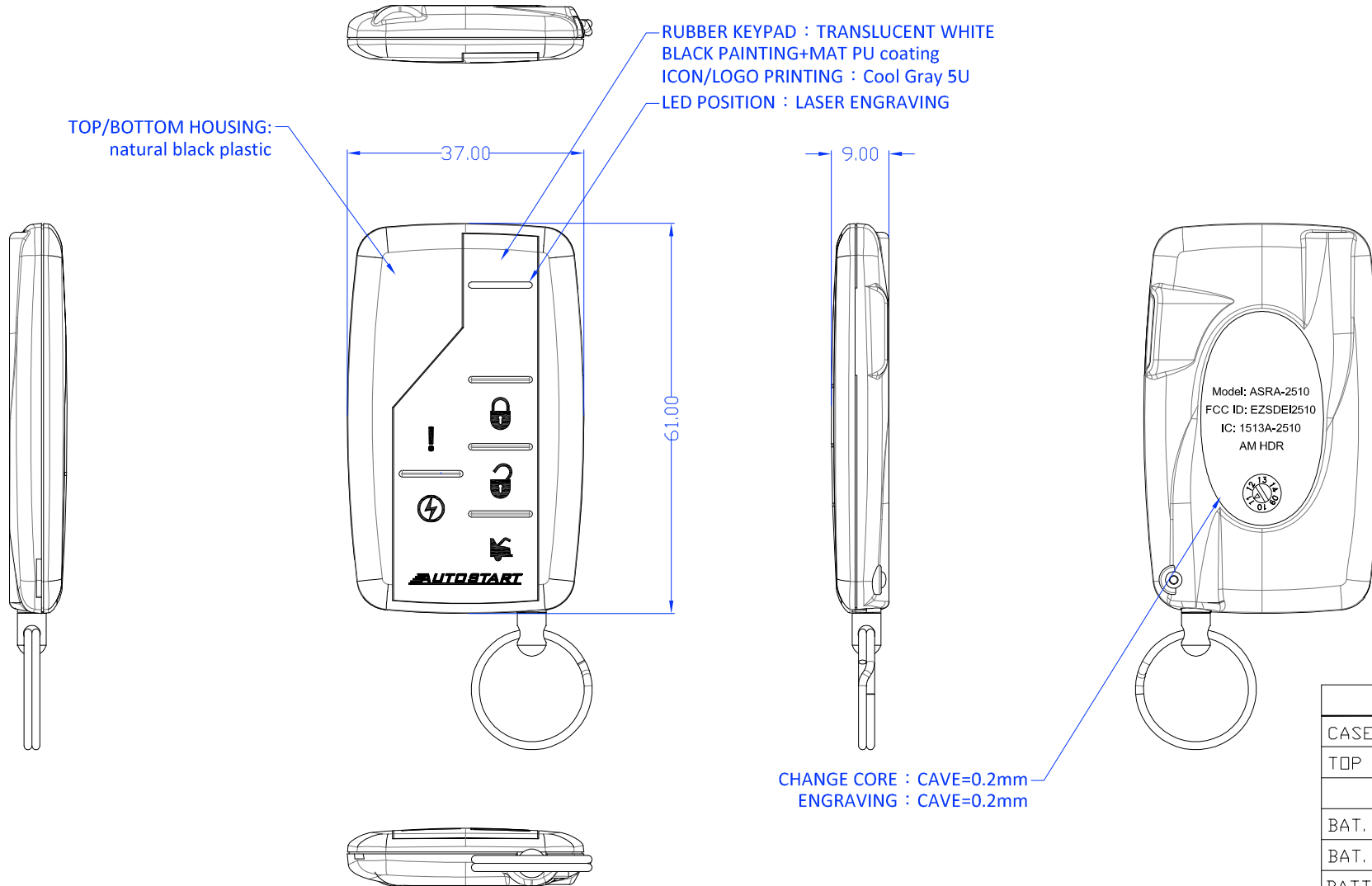

PART	P/N
CASE	IASL7003
TOP KEYPAD	NKSL6BC0
BAT. CLIP(+)	MCCL4000
BAT. CLIP(-)	MCDG2GAA
BATTERY	CR2016 *2
KEY CHAIN	MA160000
SCREW	MIP01445

**BODY MATERIAL : PC/ABS**

- Texture is same as MT-11010
- Radiused will be 0.2 if not specified.

\*Tolerance please refer specification of tolerance limits "c"  
INJECT TOLERANCE SPEC.

DIMENSION	GRADE	A	B	C
UNDER 6		±0.08	±0.16	±0.30
6~30		±0.10	±0.20	±0.40
30~120		±0.20	±0.40	±0.80
120~300		±0.40	±0.80	±2.00

SCALE: 1:1	UNIT: M/M	DRN BY Eric	DATE 5/29-'12	NUTEK CORPORATION	
MATERIAL	CHK BY YYS	TITLE AS			
FINISH	APPD BY VICTOR	ASRA-2510FBK TX		SIZE A4	DEPT
CODE	SHEET OF	DRAWING NO 100I0520-6		REV 0	

REVISIONS				
REV.	ACC.	DESCRIPTION	DRN.	DATE
△				

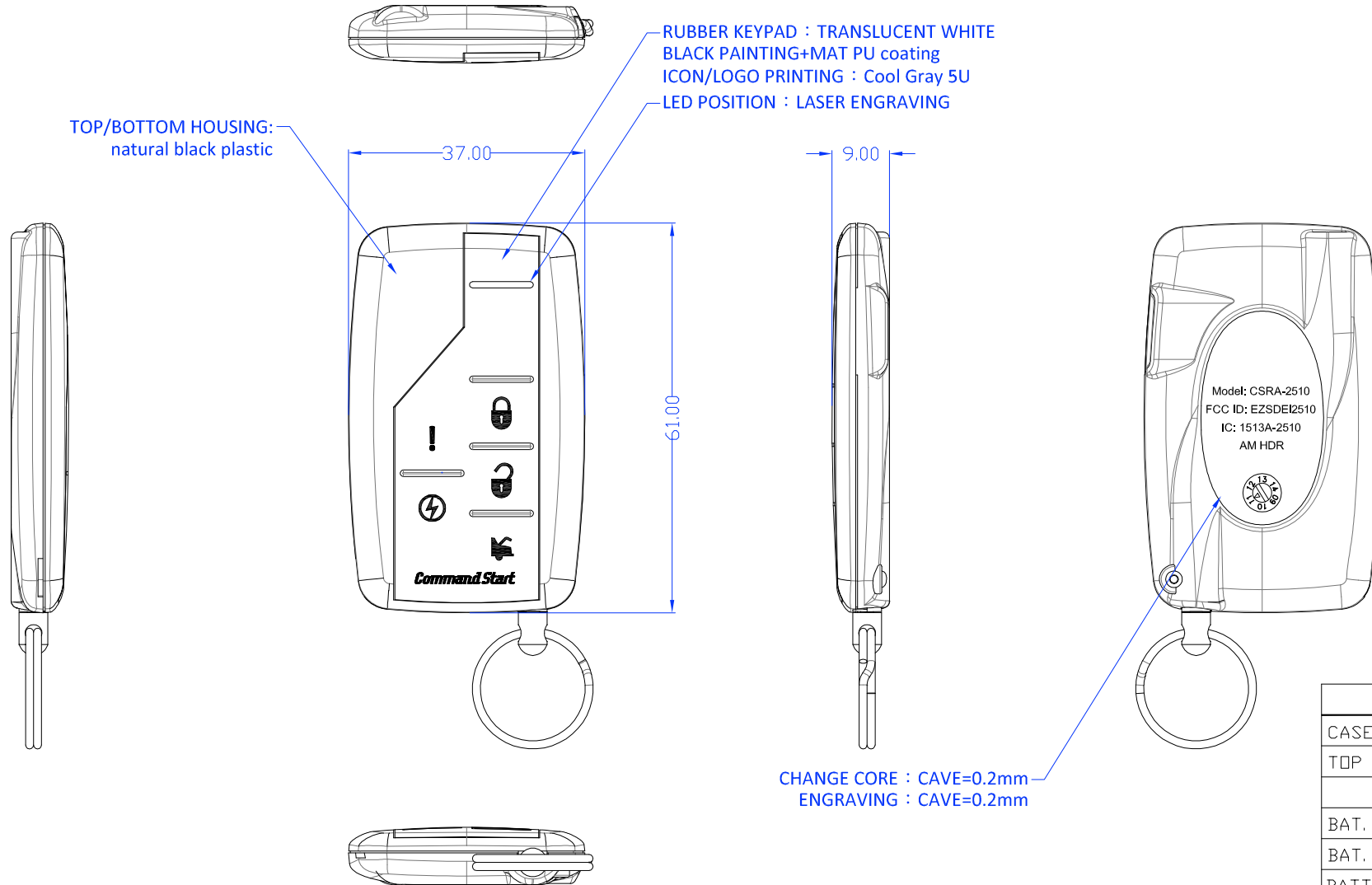

CHANGE CORE : CAVE=0.2mm  
ENGRAVING : CAVE=0.2mm

PART	P/N
CASE	IASL7006
TOP KEYPAD	NKSL6BF0
BAT. CLIP(+)	MCCL4000
BAT. CLIP(-)	MCDG2GAA
BATTERY	CR2016 *2
KEY CHAIN	MA160000
SCREW	MIP01445

**BODY MATERIAL : PC/ABS**

1. Texture is same as MT-11010
2. RADIUS will be 0.2 if not specified.

\*Tolerance please refer specification of tolerance limits "c"  
INJECT TOLERANCE SPEC.

DIMENSION	GRADE	A	B	C
UNDER 6		± 0.08	± 0.16	± 0.30
6~30		± 0.10	± 0.20	± 0.40
30~120		± 0.20	± 0.40	± 0.80
120~300		± 0.40	± 0.80	± 2.00

SCALE: 1:1	UNIT: M/M	DRN BY Eric	DATE 6/28-'12	NUTEK CORPORATION	
MATERIAL	CHK BY YYS	TITLE AS			
FINISH	APPD BY VICTOR	CSRA-2510FBK TX		SIZE A4	DEPT
CODE	SHEET OF			DRAWING NO 100I0520-11	REV 0

REVISIONS				
REV.	ACC.	DESCRIPTION	DRN.	DATE
△		add Date core	Eric	4/16-'12

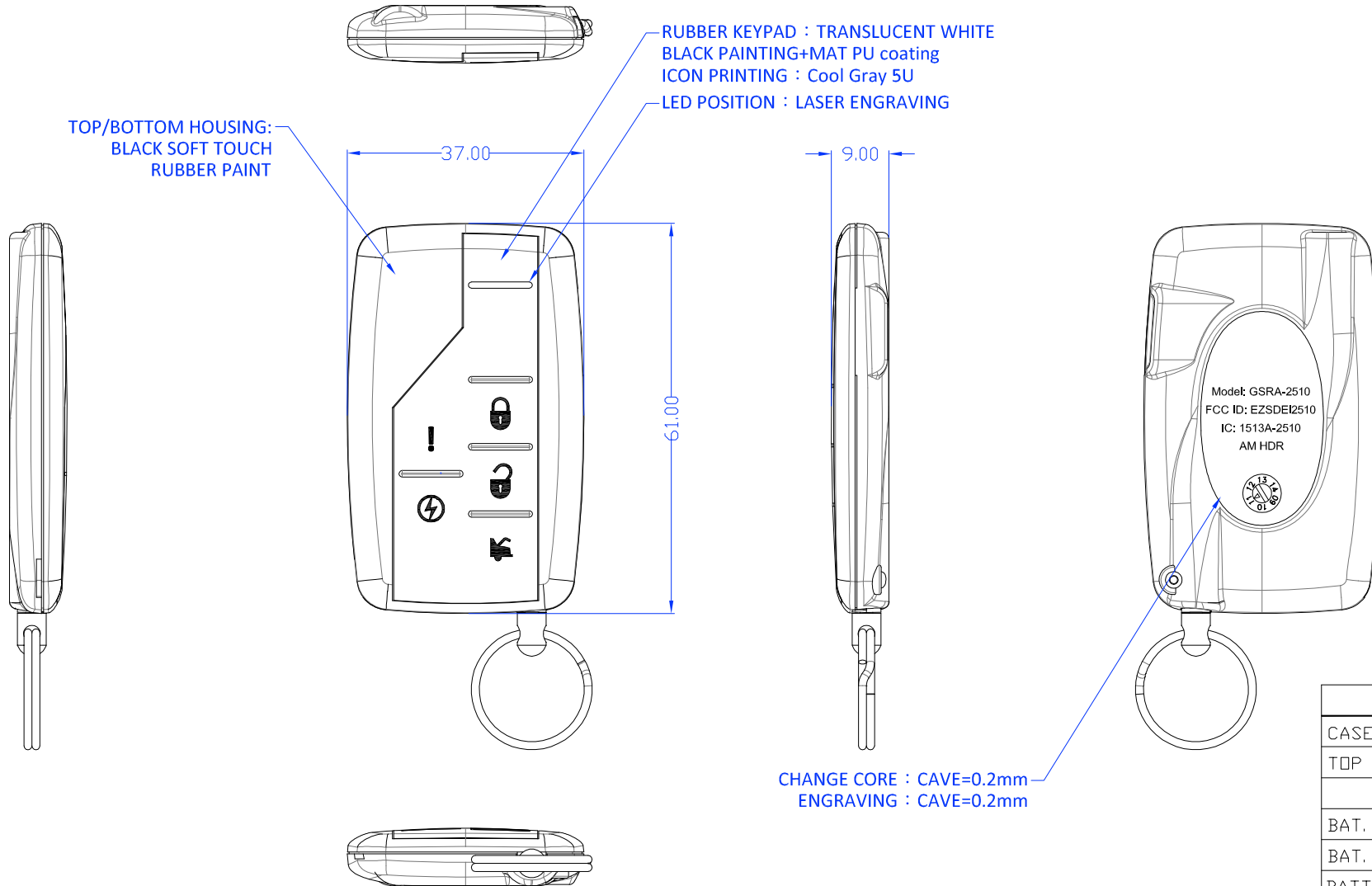

PART	P/N
CASE	IASL7M04
TOP KEYPAD	NKSL6BD0
BAT. CLIP(+)	MC SL4000
BAT. CLIP(-)	MCDG2GAA
BATTERY	CR2016 *2
KEY CHAIN	MA160000
SCREW	MIP01445

**BODY MATERIAL : PC/ABS**

- Texture is same as MT-11010
- Radiused will be 0.2 if not specified.

\*Tolerance please refer specification of tolerance limits "c"

DIMENSION	INJECT TOLERANCE SPEC.			
	GRADE	A	B	C
UNDER 6	±	0.08	0.16	0.30
6~30	±	0.10	0.20	0.40
30~120	±	0.20	0.40	0.80
120~300	±	0.40	0.80	2.00

SCALE: 1:1	UNIT: M/M	DRN BY Eric	DATE 3/15-'12	NUTEK CORPORATION	
MATERIAL	CHK BY YYS	TITLE AS			
FINISH	APPD BY VICTOR	GSRA-2510BKR TX		SIZE A4	DEPT
CODE	SHEET OF	DRAWING NO 100I0520-3		REV 1	

REVISIONS				
REV.	ACC.	DESCRIPTION	DRN.	DATE
⚠		add Date core	Eric	4/16-'12
⚠		modify case finish	Eric	6/11-'12

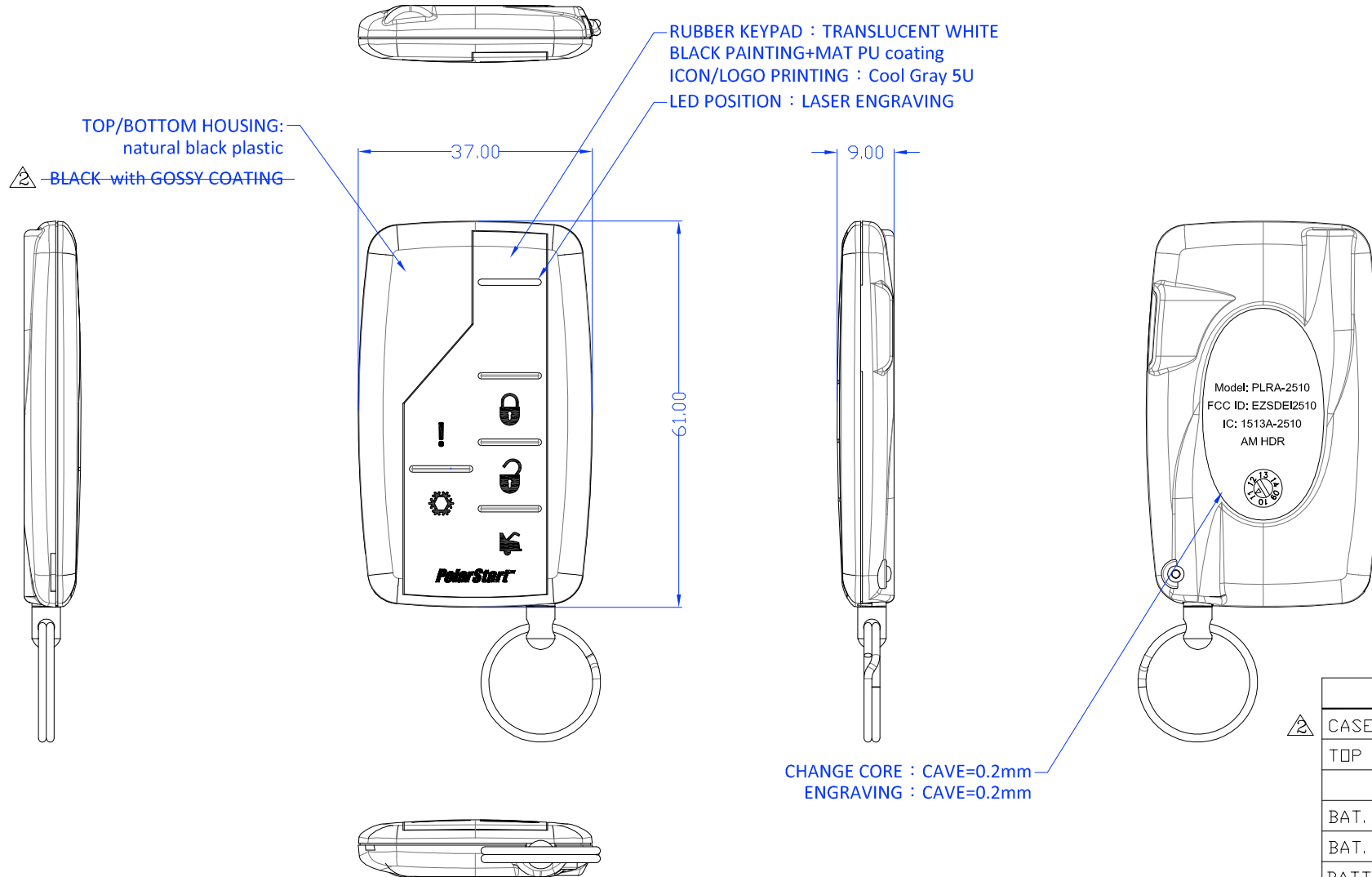

PART	P/N
⚠ CASE	IASL7005
TOP KEYPAD	NKSL6BE0
BAT. CLIP(+)	MCSL4000
BAT. CLIP(-)	MCDG2GAA
BATTERY	CR2016 *2
KEY CHAIN	MA160000
SCREW	MIP01445

**BODY MATERIAL : PC/ABS**

- Texture is same as MT-11010
- Radiused will be 0.2 if not specified.

\*Tolerance please refer specification of tolerance limits "c"  
INJECT TOLERANCE SPEC.

DIMENSION	GRADE	A	B	C
UNDER 6		± 0.08	± 0.16	± 0.30
6~30		± 0.10	± 0.20	± 0.40
30~120		± 0.20	± 0.40	± 0.80
120~300		± 0.40	± 0.80	± 2.00

SCALE: 1:1	UNIT: M/M	DRN BY Eric	DATE 3/15-'12	NUTEK CORPORATION	
MATERIAL	CHK BY YYS			TITLE AS ⚠	
FINISH	APPD BY VICTOR			PLRA-2510FBK TX	
CODE	SHEET OF	SIZE A4	DEPT	DRAWING NO 100I0520-4	REV 2