

REVISIONS				
REV.	ACC.	DESCRIPTION	DRN.	DATE
△0				

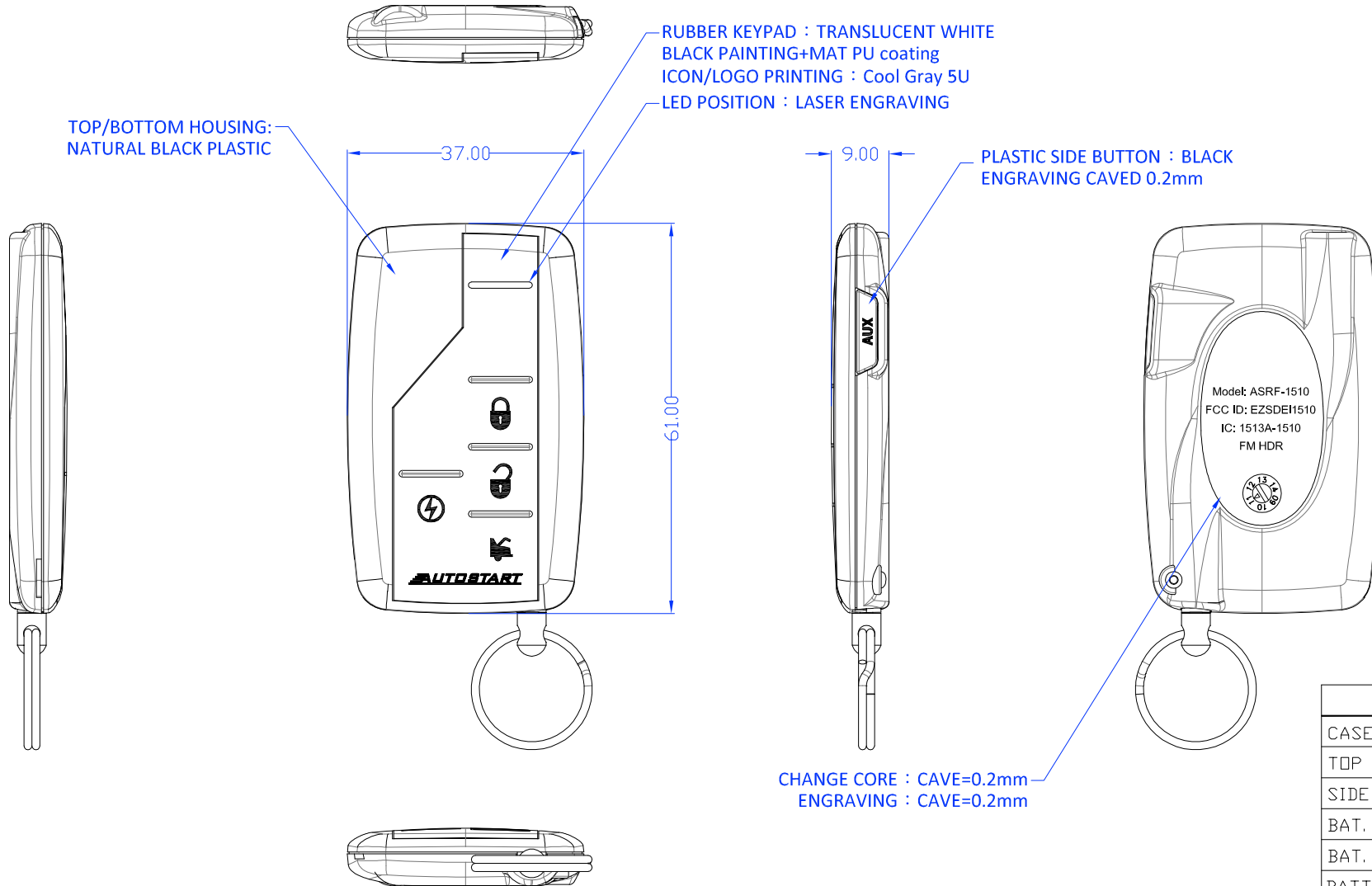

PART	P/N
CASE	IASL6001
TOP KEYPAD	NKSL6BA0
SIDE KEYPAD	IKSL40A0
BAT. CLIP(+)	MCSL4000
BAT. CLIP(-)	MCDG2GAA
BATTERY	
KEY CHAIN	MA160000
SCREW	MIP01445

BODY MATERIAL : PC/ABS

- Texture is same as MT-11010
- Radiused will be 0.2 if not specified.

*Tolerance please refer specification of tolerance limits "c"
INJECT TOLERANCE SPEC.

DIMENSION	GRADE	A	B	C
UNDER 6		±0.08	±0.16	±0.30
6~30		±0.10	±0.20	±0.40
30~120		±0.20	±0.40	±0.80
120~300		±0.40	±0.80	±2.00

SCALE: 1:1	UNIT: M/M	DRN BY Eric	DATE 5/29-12	NUTEK CORPORATION	
MATERIAL	CHK BY YYS	TITLE AS		ASRF-1510FBK TX	
FINISH	APPD BY VICTOR	SIZE A4	DEPT	DRAWING NO 100I0520-7	REV 0
CODE	SHEET OF				

REVISIONS				
REV.	ACC.	DESCRIPTION	DRN.	DATE
△				

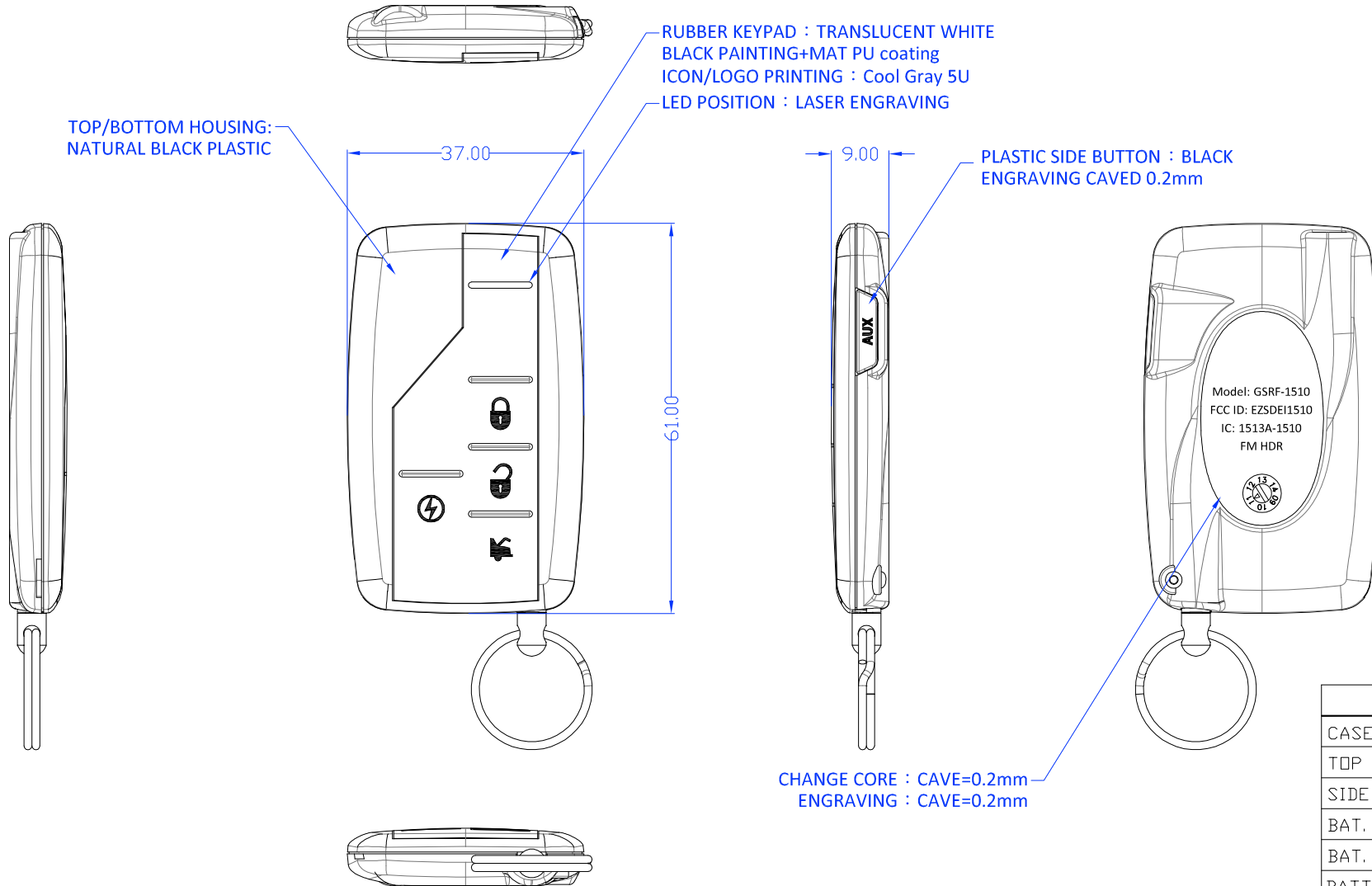

PART	P/N
CASE	IASL6002
TOP KEYPAD	NKSL6BB0
SIDE KEYPAD	IKSL40A0
BAT. CLIP(+)	MCSL4000
BAT. CLIP(-)	MCDG2GAA
BATTERY	
KEY CHAIN	MA160000
SCREW	MIP01445

BODY MATERIAL : PC/ABS
 1. Texture is same as MT-11010
 2. RADIUS will be 0.2 if not specified.

*Tolerance please refer specification of tolerance limits "c"
 INJECT TOLERANCE SPEC.

DIMENSION	GRADE	A	B	C
UNDER 6		± 0.08	± 0.16	± 0.30
6~30		± 0.10	± 0.20	± 0.40
30~120		± 0.20	± 0.40	± 0.80
120~300		± 0.40	± 0.80	± 2.00

SCALE: 1:1	UNIT: M/M	DRN BY Eric	DATE 5/29-'12	NUTEK CORPORATION	
MATERIAL	CHK BY YYS	TITLE AS			
FINISH	APPD BY VICTOR	GSRF-1510FBK TX		SIZE A4	DEPT
CODE	SHEET OF	DRAWING NO 100I0520-9		REV 0	