



User's manual VM341/VM341-2

Safe & Sound® Full Color Video Monitor



Congratulations

on purchasing your new VTech product. Before using this product, please read **important safety instructions**.

For support, shopping, and everything new at VTech, visit our website at www.vtechphones.com.

Register online to get an **additional 3-month warranty!**

Visit www.vtechphones.com.

Registration
Register your product online for enhanced warranty support.

Product news
Learn about the latest VTech products.

What's in the box

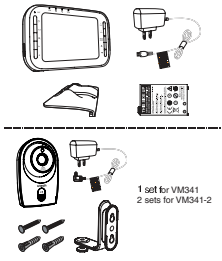

Install the battery

You can power up the parent unit by connecting it to AC power or to the rechargeable battery provided. Even if the parent unit is connected to AC power, we recommend you also install the battery. This guarantees continual operation in case of a power outage.

Install the battery as shown below.



2. With the label **THIS SIDE UP** facing up, insert the small tabs of the battery into the slots inside the battery compartment. Make sure the metallic contact is correctly oriented as shown below. Push the battery into the battery compartment until it clicks securely into place.

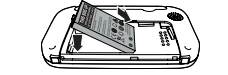

3. Align the battery compartment cover flat against the battery compartment, then slide it towards the center of the parent unit until it clicks into place.



Replace the battery

To replace the battery, press down on the large tab of the battery compartment cover and pull it out, then follow the steps above to install the battery.

NOTES
• The operating time for using the rechargeable battery is short. If you want to monitor your baby for a long time, we recommend you connect the parent unit to AC power.
• If the parent unit will not be used for a long time, disconnect and remove the battery to prevent possible leakage.

Connect and charge the battery

- Use only the battery supplied with this product.
- Use only the power adapters supplied with this product.
- Make sure the electrical outlets are not controlled by wall switches.
- The power adapter are intended to be correctly oriented in a vertical or floor mount position. The prongs are not designed to hold the plug in place if they are plugged into a ceiling, under-the-table or cabinet outlet.
- Make sure the parent unit, the baby unit and the power adapter cord are out of reach of children.

Connect the baby monitor

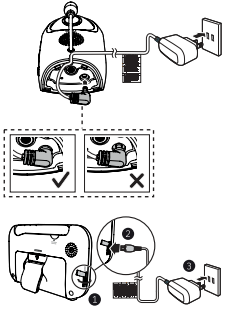

Charge the parent unit battery

When you have connected the parent unit and installed its battery for the first time or after power outage, the parent unit powers on automatically. The battery icon indicates the battery status (see the following table).

NOTES
The parent unit battery is fully charged after 3 hours of continuous charging. It takes longer to charge the battery when the parent unit is turned on. To shorten the charging time, turn the parent unit off while charging. The standby time varies depending on the sensitivity level you set, your actual use and the age of the battery.

Battery indicators	Battery status	Action
The battery icon is off and	The battery has very little charge and may be used for only a short time.	Charge without interruption (about 30 minutes).
The light flashes.		
The battery icon becomes solid		

Before use

NOTE
CAUTION
On the baby unit to turn it on.

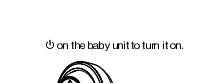

Upon initial use, the parent unit powers on automatically after connecting to AC power. The screen shows **vtech** and **Powering on...**

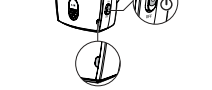

NOTE
TIP

NOTE
CAUTION
At least 1 meter (3 feet)

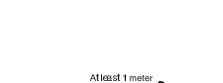

NOTE
TIP
At least 1 meter (3 feet)



Overview

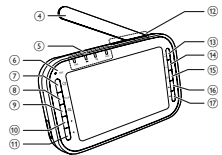
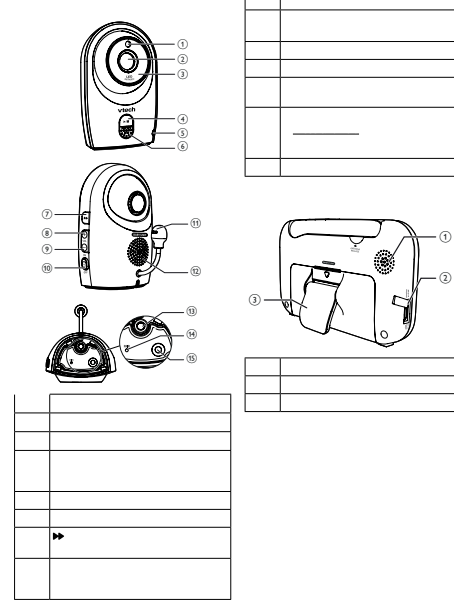

13	+VOL	Press to increase the speaker volume.
14	-VOL	Press to decrease the speaker volume.
15	MENU/SELECT	Press to enter the menu. While in a menu, press to choose an item, or save a setting.
16	▲	While in a menu, press to scroll up.
17	▼	While in a menu, press to scroll down.

Parent unit lights	
LINK	On when moderate or high signal strength is detected between the parent unit and the selected baby unit. Flashes when low signal strength is detected between the parent unit and the selected baby unit. Off when the parent unit is turned off, or the link to the selected baby unit is lost.
	On when the parent unit battery is charging. Flashes when the parent unit battery is low and needs charging. Off when the parent unit is turned off, charged without battery, or when the battery inserted is fully charged or not being charged.
TALK	On when the parent unit is talking to the baby unit.
	On when the speaker volume of the parent unit is turned off.

Parent unit display icons

	Signal strength indicator
	Link status indicator
	Battery status indicator
	Talk status indicator
	Speaker volume indicator
	Temperature alert indicator
	Vibration alert indicator
	Brightness indicator
	Rename indicator
	Pair/unpair indicator
	Sensitivity indicator
	Temperature alert indicator
	Sound detected at CAM # indicator

	Language selection icon
	Alarm time icon
	Sensitivity selection icon
	Temperature selection icon
	Vibration selection icon
	Brightness selection icon
	Rename selection icon
	Pair/unpair selection icon
	Sensitivity selection icon
	Temperature selection icon
	Vibration selection icon
	Brightness selection icon
	Rename selection icon
	Pair/unpair selection icon
	Sensitivity selection icon
	Temperature selection icon
	Vibration selection icon
	Brightness selection icon
	Rename selection icon
	Pair/unpair selection icon
	Sensitivity selection icon
	Temperature selection icon
	Vibration selection icon
	Brightness selection icon
	Rename selection icon
	Pair/unpair selection icon
	Sensitivity selection icon
	Temperature selection icon
	Vibration selection icon
	Brightness selection icon
	Rename selection icon
	Pair/unpair selection icon
	Sensitivity selection icon
	Temperature selection icon
	Vibration selection icon
	Brightness selection icon
	Rename selection icon
	Pair/unpair selection icon
	Sensitivity selection icon
	Temperature selection icon
	Vibration selection icon
	Brightness selection icon
	Rename selection icon
	Pair/unpair selection icon
	Sensitivity selection icon
	Temperature selection icon
	Vibration selection icon
	Brightness selection icon
	Rename selection icon
	Pair/unpair selection icon
	Sensitivity selection icon
	Temperature selection icon
	Vibration selection icon
	Brightness selection icon
	Rename selection icon
	Pair/unpair selection icon
	Sensitivity selection icon
	Temperature selection icon
	Vibration selection icon
	Brightness selection icon
	Rename selection icon
	Pair/unpair selection icon
	Sensitivity selection icon
	Temperature selection icon
	Vibration selection icon
	Brightness selection icon
	Rename selection icon
	Pair/unpair selection icon
	Sensitivity selection icon
	Temperature selection icon
	Vibration selection icon
	Brightness selection icon
	Rename selection icon
	Pair/unpair selection icon
	Sensitivity selection icon
	Temperature selection icon
	Vibration selection icon
	Brightness selection icon
	Rename selection icon
	Pair/unpair selection icon
	Sensitivity selection icon
	Temperature selection icon
	Vibration selection icon
	Brightness selection icon
	Rename selection icon
	Pair/unpair selection icon
	Sensitivity selection icon
	Temperature selection icon
	Vibration selection icon
	Brightness selection icon
	Rename selection icon
	Pair/unpair selection icon
	Sensitivity selection icon
	Temperature selection icon
	Vibration selection icon
	Brightness selection icon
	Rename selection icon
	Pair/unpair selection icon
	Sensitivity selection icon
	Temperature selection icon
	Vibration selection icon
	Brightness selection icon
	Rename selection icon
	Pair/unpair selection icon
	Sensitivity selection icon
	Temperature selection icon
	Vibration selection icon
	Brightness selection icon
	Rename selection icon
	Pair/unpair selection icon
	Sensitivity selection icon
	Temperature selection icon
	Vibration selection icon
	Brightness selection icon
	Rename selection icon
	Pair/unpair selection icon
	Sensitivity selection icon
	Temperature selection icon
	Vibration selection icon
	Brightness selection icon
	Rename selection icon
	Pair/unpair selection icon
	Sensitivity selection icon
	Temperature selection icon
	Vibration selection icon
	Brightness selection icon
	Rename selection icon
	Pair/unpair selection icon
	Sensitivity selection icon
	Temperature selection icon
	Vibration selection icon
	Brightness selection icon
	Rename selection icon
	Pair/unpair selection icon
	Sensitivity selection icon
	Temperature selection icon
	Vibration selection icon
	Brightness selection icon
	Rename selection icon
	Pair/unpair selection icon
	Sensitivity selection icon
	Temperature selection icon
	Vibration selection icon
	Brightness selection icon
	Rename selection icon
	Pair/unpair selection icon
	Sensitivity selection icon
	Temperature selection icon
	Vibration selection icon
	Brightness selection icon
	Rename selection icon
	Pair/unpair selection icon
	Sensitivity selection icon
	Temperature selection icon
	Vibration selection icon
	Brightness selection icon
	Rename selection icon
	Pair/unpair selection icon
	Sensitivity selection icon
	Temperature selection icon
	Vibration selection icon
	Brightness selection icon
	Rename selection icon
	Pair/unpair selection icon
	Sensitivity selection icon
	Temperature selection icon
	Vibration selection icon
	Brightness selection icon
	Rename selection icon
	Pair/unpair selection icon
	Sensitivity selection icon
	Temperature selection icon
	Vibration selection icon
	Brightness selection icon
	Rename selection icon
	Pair/unpair selection icon
	Sensitivity selection icon
	Temperature selection icon
	Vibration selection icon
	Brightness selection icon
	Rename selection icon
	Pair/unpair selection icon
	Sensitivity selection icon
	Temperature selection icon
	Vibration selection icon
	Brightness selection icon
	Rename selection icon
	Pair/unpair selection icon
	Sensitivity selection icon
	Temperature selection icon
	Vibration selection icon
	Brightness selection icon
	Rename selection icon
	Pair/unpair selection icon
	Sensitivity selection icon
	Temperature selection icon
	Vibration selection icon
	Brightness selection icon
	Rename selection icon
	Pair/unpair selection icon
	Sensitivity selection icon
	Temperature selection icon
	Vibration selection icon
	Brightness selection icon
	Rename selection icon
	Pair/unpair selection icon
	Sensitivity selection icon
	Temperature selection icon
	Vibration selection icon
	Brightness selection icon
	Rename selection icon
	Pair/unpair selection icon
	Sensitivity selection icon
	Temperature selection icon
	Vibration selection icon
	Brightness selection icon
	Rename selection icon
	Pair/unpair selection icon
	Sensitivity selection icon
	Temperature selection icon
	Vibration selection icon
	Brightness selection icon
	Rename selection icon
	Pair/unpair selection icon
	Sensitivity selection icon
	Temperature selection icon
	Vibration selection icon
	Brightness selection icon
	Rename selection icon
	Pair/unpair selection icon
	Sensitivity selection icon
	Temperature selection icon
	Vibration selection icon
	Brightness selection icon
	Rename selection icon
	Pair/unpair selection icon
	Sensitivity selection icon
	Temperature selection icon
	Vibration selection icon
	Brightness selection icon
	Rename selection icon
	Pair/unpair selection icon
	Sensitivity selection icon
	Temperature selection icon
	Vibration selection icon
	Brightness selection icon
	Rename selection icon
	Pair/unpair selection icon
	Sensitivity selection icon
	Temperature selection icon
	Vibration selection icon
	Brightness selection icon
	Rename selection icon
	Pair/unpair selection icon
	Sensitivity selection icon
	Temperature selection icon
	Vibration selection icon
	Brightness selection icon
	Rename selection icon
	Pair/unpair selection icon
	Sensitivity selection icon
	Temperature selection icon
	Vibration selection icon
	Brightness selection icon
	Rename selection icon
	Pair/unpair selection icon
	Sensitivity selection icon
	Temperature selection icon
	Vibration selection icon
	Brightness selection icon
	Rename selection icon
	Pair/unpair selection icon
	Sensitivity selection icon
	Temperature selection icon
	Vibration selection icon
	Brightness selection icon
	Rename selection icon
	Pair/unpair selection icon
	Sensitivity selection icon
	Temperature selection icon
	Vibration selection icon
	Brightness selection icon
	Rename selection icon
	Pair/unpair selection icon
	Sensitivity selection icon
	Temperature selection icon
	Vibration selection icon
	Brightness selection icon
	Rename selection icon
	Pair/unpair selection icon
	Sensitivity selection icon
	Temperature selection icon
	Vibration selection icon
	Brightness selection icon
	Rename selection icon
	Pair/unpair selection icon
	Sensitivity selection icon
	Temperature selection icon
	Vibration selection icon
	Brightness selection icon
	Rename selection icon
	Pair/unpair selection icon
	Sensitivity selection icon
	Temperature selection icon
	Vibration selection icon
	Brightness selection icon
	Rename selection icon
	Pair/unpair selection icon
	Sensitivity selection icon
	Temperature selection icon
	Vibration selection icon
	Brightness selection icon
	Rename selection icon
	Pair/unpair selection icon
	Sensitivity selection icon
	Temperature selection icon
	Vibration selection icon
	Brightness selection icon
	Rename selection icon
	Pair/unpair selection icon
	Sensitivity selection icon
	Temperature selection icon
	Vibration selection icon
	Brightness selection icon
	Rename selection icon
	Pair/unpair selection icon
	Sensitivity selection icon
	Temperature selection icon
	Vibration selection icon
	Brightness selection icon
	Rename selection icon
	Pair/unpair selection icon
	Sensitivity selection icon
	Temperature selection icon
	Vibration selection icon
	Brightness selection icon
	Rename selection icon
	Pair/unpair selection icon
	Sensitivity selection icon
	Temperature selection icon
	Vibration selection icon
	Brightness selection icon
	Rename selection icon
	Pair/unpair selection icon
	Sensitivity selection icon
	Temperature selection icon
	Vibration selection icon
	Brightness selection icon
	Rename selection icon
	Pair/unpair selection icon
	Sensitivity selection icon
	Temperature selection icon
	Vibration selection icon
	Brightness selection icon
	Rename selection icon
	Pair/unpair selection icon
	Sensitivity selection icon
	Temperature selection icon
	Vibration selection icon
	Brightness selection icon
	Rename selection icon
	Pair/unpair selection icon
	Sensitivity selection icon
	Temperature selection icon
	Vibration selection icon
	Brightness selection icon
	Rename selection icon
	Pair/unpair selection icon
	Sensitivity selection icon
	Temperature selection icon
	Vibration selection icon
	Brightness selection icon
	Rename selection icon
	Pair/unpair selection icon
	Sensitivity selection icon
	Temperature selection icon
	Vibration selection icon
	Brightness selection icon
	Rename selection icon
	Pair/unpair selection icon
	Sensitivity selection icon
	Temperature selection icon
	Vibration selection icon
	Brightness selection icon
	Rename selection icon
	Pair/unpair selection icon

In SINGLE-CAM mode:

- Press **VOL** repeatedly to view images of other baby units.
- Press **PATROL** to display images from different baby units in every 7 seconds. Press again to turn off the patrolling function.

Press SPLIT key to enter the SPLIT-VIEW mode:

- Press **VOL** to select a baby unit.
- Press **Q** or **VOL** key to view images from the selected baby unit temporarily in SINGLE-CAM mode. It returns to SPLIT-VIEW mode after 10 seconds.
- Press **PATROL** key to display images from different baby units in every 7 seconds.
- Press **SPLIT** key again to return to SINGLE-CAM mode.

NOTE

The parent unit is muted when in SPLIT-VIEW mode.

ZOOM

- You can zoom in or out while viewing image from baby unit in SINGLE-CAM mode.
- Press **Q** to zoom in.
- Press and hold **▲**, **▼** or **←** or **→** to move the zoomed image upward, downward, leftward or rightward correspondingly.
- Press **Q** again to zoom out.

Talk

- You can use the TALK function of the parent unit to connect your baby unit in SINGLE-CAM mode.
- Press and hold **TALK** on the parent unit. The TALK light turns on.
- Speak through the microphone on the parent unit. Your voice is broadcast to the baby unit of the desired temperature range.
- Release the TALK key to stop the broadcast. The TALK light goes off.

Set alert tone

Low battery tone

- You can set the parent unit to beep when the parent unit operates in low battery condition.

- Press **MENU** when the parent unit is not in use.

Cautions

- Use and store the product at a temperature between 32°F and 104°F.
- Do not expose the product to extreme cold, heat or direct sunlight. Do not put the product close to a heating source.
- Batteries should be exposed to excessive heat such as bright sunlight or fire.
- Make sure the battery(ies) and the adapter cord(s) are always out of reach of the baby, at least 3 feet away from the baby or crib, to avoid a possible strangulation hazard.
- Never place the baby unit(s) inside the baby's crib or cot. Never cover the baby unit(s) or parent unit with anything such as a towel or a blanket.
- Other electronic products may cause interference with your baby monitor. Try installing your baby monitor as far away from these electronic devices as possible: wireless routers, radios, cellular telephones, intercoms, room monitors, televisions, personal computers, kitchen appliances and cordless telephones.

Precautions for users of implanted cardiac pacemakers

- Cardiac pacemakers (applies only to digital cordless devices).
- VTEch's participation in RBRBC® makes it easy for you to drop off the parent battery at local retailers including the RBRBC® program at authorized VTEch product service centers. Please call (800) 274-VTECH for information on Li-Ion battery recycling and disposal restrictions in your area. VTEch's involvement in this program is part of its commitment to protecting our environment and conserving natural resources.
- RBRBC® and (800) 274-VTECH are registered trademarks of the Rechargeable Battery Recycling Corporation.

- Read the instructions and safety information for the device you are using.
- Do not use the device if you are experiencing any of the following conditions: (1) the device may not be used based on scientific evidence available today.

The RBRBC® seal

The RBRBC® seal on the lithium-ion battery indicates that VTEch Communications, Inc. is voluntarily participating in an industry program to collect and recycle these batteries at the end of their useful lives, when taken out of service within the United States and Canada.

The RBRBC® program provides a convenient alternative to placing used lithium-ion batteries into the trash or municipal waste, which may be illegal in your area.

- Press **VOL** or **▲** to choose **ALERT TONE**, then press **SELECT**.
- Press **VOL** or **▲** to choose **Low Battery Tone**, then press **SELECT**.

- Press **VOL** or **▲** to choose **On or Off**, then press again to confirm your selection.

No link alert

You can set the parent unit to beep when the link between the parent unit and the baby unit is lost.

- Press **MENU** when the parent unit is not in use.
- Press **VOL** or **▲** to select a baby unit.
- Press **Q** or **VOL** key to view images from the selected baby unit temporarily in SINGLE-CAM mode. It returns to SPLIT-VIEW mode after 10 seconds.
- Press **PATROL** key to display images from different baby units in every 7 seconds.
- Press **SPLIT** key again to return to SPLIT-VIEW mode.

Sound alert

You can turn on the sound alert feature so that, while in SPLIT-VIEW mode, the parent unit beeps and displays **Sound detected at CAM #** whenever the baby unit detects sound.

- Press **MENU** when the parent unit is not in use.
- Press **VOL** or **▲** to choose **ALERT TONE**, then press **SELECT**.
- Press **VOL** or **▲** to choose **No Link Alert**, then press **SELECT**.
- Press **VOL** or **▲** to choose **On or Off**, then press **SELECT** to confirm your selection.

Monitor the temperature

To monitor the temperature of your baby's room, you can turn on the temperature alert feature on the parent unit. It beeps whenever the temperature detected by the baby unit falls out of the desired temperature range.

- Press **MENU** when the parent unit is not in use.

- Press **VOL** or **▲** to choose **TEMPERATURE**, then press **SELECT**.
- Press **VOL** or **▲** to choose **Alert**, then press **SELECT**.

- If you have more than one baby unit, the system prompts you to choose the desired baby unit or all baby units, press **VOL** or **▲** to choose **All CAM or CAM #**, then press **SELECT**.

- Press **VOL** or **▲** to choose **On or Off**, then press **SELECT** to confirm your selection.

- Press **MENU** when the parent unit is not in use.
- Press **VOL** or **▲** to choose **TEMPERATURE**, then press **SELECT**.

- If you have more than one baby unit, the system prompts you to choose the desired baby unit or all baby units, press **VOL** or **▲** to choose **All CAM or CAM #**, then press **SELECT**.

- Press **VOL** or **▲** to choose **On or Off**, then press **SELECT** to confirm your selection.

- Press **MENU** when the parent unit is not in use.
- Press **VOL** or **▲** to choose **TEMPERATURE**, then press **SELECT**.

- If you have more than one baby unit, the system prompts you to choose the desired baby unit or all baby units, press **VOL** or **▲** to choose **All CAM or CAM #**, then press **SELECT**.

- Press **VOL** or **▲** to choose **On or Off**, then press **SELECT** to confirm your selection.

FCC and IC regulations

- FCC Part 15**
This equipment has been tested and found to comply with the requirements for a Class B digital device under Part 15 of the Federal Communications Commission (FCC) rules. These requirements are designed to provide reasonable protection against harmful interference in a residential installation. This equipment generates, uses and can radiate radio frequency energy and, if not installed and used in accordance with the instructions, may cause harmful interference to radio communications. However, there is no guarantee that interference will not occur in a particular installation. If this equipment does cause harmful interference to radio or television reception, which can be determined by turning the equipment off and on, the user is encouraged to try to correct the interference by one or more of the following measures:
 - Reorient or relocate the receiving antenna.
 - Increase the separation between the equipment and receiver.
 - Connect the equipment into an outlet on a circuit different from that to which the receiver is connected.
 - Consult the dealer or an experienced radio/TV technician for help.
- Changes or modifications to this equipment not expressly approved by the party responsible for compliance could void the user's authority to operate the equipment.
- This device complies with Part 15 of the FCC rules. Operation is subject to the following two conditions: (1) this device may not cause harmful interference, and (2) this device must accept any interference received, including that which may cause undesired operation.

- California Energy Commission battery charging testing mode**
This baby monitor meets the California Energy Commission (CEC) regulations for energy conservation. Your baby monitor is set up to comply with the energy-conserving standards right out of the box.
Follow the instructions to install and charge the battery. The CEC battery charging testing mode is activated when the parent unit is paired to baby units. The CEC battery charging testing mode is activated while it is powered off and charging.

- Do not touch the battery contacts or the lithium-ion battery. The battery is not to be recharged or replaced. If you are having trouble with the battery, contact your retailer or the manufacturer.
- Do not use the device if you are experiencing any of the following conditions: (1) the device may not be used based on scientific evidence available today.

- Press **VOL** or **▲** to choose **Minimum**, then press **SELECT**.
- If you have more than one baby unit, the system prompts you to choose the desired baby unit or all baby units, press **VOL** or **▲** to choose **All CAM or CAM #**, then press **SELECT**.

- Press **VOL** or **▲** to choose **Fahrenheit or Celsius**, then press **SELECT** to confirm your selection.

- Press **VOL** or **▲** to choose the desired temperature, then press **SELECT** to confirm your selection.

- Press **VOL** or **▲** to choose **TEMPERATURE**, then press **SELECT**.

- If you have more than one baby unit, the system prompts you to choose the desired baby unit or all baby units, press **VOL** or **▲** to choose **All CAM or CAM #**, then press **SELECT**.

- Press **VOL** or **▲** to choose **On or Off**, then press **SELECT** to confirm your selection.

- Press **MENU** when the parent unit is not in use.
- Press **VOL** or **▲** to choose **TEMPERATURE**, then press **SELECT**.

- If you have more than one baby unit, the system prompts you to choose the desired baby unit or all baby units, press **VOL** or **▲** to choose **All CAM or CAM #**, then press **SELECT**.

- Press **VOL** or **▲** to choose **On or Off**, then press **SELECT** to confirm your selection.

- Press **MENU** when the parent unit is not in use.
- Press **VOL** or **▲** to choose **TEMPERATURE**, then press **SELECT**.

- If you have more than one baby unit, the system prompts you to choose the desired baby unit or all baby units, press **VOL** or **▲** to choose **All CAM or CAM #**, then press **SELECT**.

- Press **VOL** or **▲** to choose **On or Off**, then press **SELECT** to confirm your selection.

- Press **MENU** when the parent unit is not in use.
- Press **VOL** or **▲** to choose **TEMPERATURE**, then press **SELECT**.

- If you have more than one baby unit, the system prompts you to choose the desired baby unit or all baby units, press **VOL** or **▲** to choose **All CAM or CAM #**, then press **SELECT**.

- Press **VOL** or **▲** to choose **On or Off**, then press **SELECT** to confirm your selection.

- Press **MENU** when the parent unit is not in use.
- Press **VOL** or **▲** to choose **TEMPERATURE**, then press **SELECT**.

- If you have more than one baby unit, the system prompts you to choose the desired baby unit or all baby units, press **VOL** or **▲** to choose **All CAM or CAM #**, then press **SELECT**.

- Press **VOL** or **▲** to choose **On or Off**, then press **SELECT** to confirm your selection.

- Press **MENU** when the parent unit is not in use.
- Press **VOL** or **▲** to choose **TEMPERATURE**, then press **SELECT**.

- If you have more than one baby unit, the system prompts you to choose the desired baby unit or all baby units, press **VOL** or **▲** to choose **All CAM or CAM #**, then press **SELECT**.

- Press **VOL** or **▲** to choose **On or Off**, then press **SELECT** to confirm your selection.

- Press **MENU** when the parent unit is not in use.
- Press **VOL** or **▲** to choose **TEMPERATURE**, then press **SELECT**.

- If you have more than one baby unit, the system prompts you to choose the desired baby unit or all baby units, press **VOL** or **▲** to choose **All CAM or CAM #**, then press **SELECT**.

- Press **VOL** or **▲** to choose **On or Off**, then press **SELECT** to confirm your selection.

- Press **MENU** when the parent unit is not in use.
- Press **VOL** or **▲** to choose **TEMPERATURE**, then press **SELECT**.

- If you have more than one baby unit, the system prompts you to choose the desired baby unit or all baby units, press **VOL** or **▲** to choose **All CAM or CAM #**, then press **SELECT**.

- Press **VOL** or **▲** to choose **On or Off**, then press **SELECT** to confirm your selection.

- Press **MENU** when the parent unit is not in use.
- Press **VOL** or **▲** to choose **TEMPERATURE**, then press **SELECT**.

- If you have more than one baby unit, the system prompts you to choose the desired baby unit or all baby units, press **VOL** or **▲** to choose **All CAM or CAM #**, then press **SELECT**.

- Press **VOL** or **▲** to choose **On or Off**, then press **SELECT** to confirm your selection.

- Press **MENU** when the parent unit is not in use.
- Press **VOL** or **▲** to choose **TEMPERATURE**, then press **SELECT**.

- If you have more than one baby unit, the system prompts you to choose the desired baby unit or all baby units, press **VOL** or **▲** to choose **All CAM or CAM #**, then press **SELECT**.

- Press **VOL** or **▲** to choose **On or Off**, then press **SELECT** to confirm your selection.

- Press **MENU** when the parent unit is not in use.
- Press **VOL** or **▲** to choose **TEMPERATURE**, then press **SELECT**.

- If you have more than one baby unit, the system prompts you to choose the desired baby unit or all baby units, press **VOL** or **▲** to choose **All CAM or CAM #**, then press **SELECT**.

- Press **VOL** or **▲** to choose **On or Off**, then press **SELECT** to confirm your selection.

- Press **MENU** when the parent unit is not in use.
- Press **VOL** or **▲** to choose **TEMPERATURE**, then press **SELECT**.

- If you have more than one baby unit, the system prompts you to choose the desired baby unit or all baby units, press **VOL** or **▲** to choose **All CAM or CAM #**, then press **SELECT**.

- Press **VOL** or **▲** to choose **On or Off**, then press **SELECT** to confirm your selection.

- Press **MENU** when the parent unit is not in use.
- Press **VOL** or **▲** to choose **TEMPERATURE**, then press **SELECT**.

- If you have more than one baby unit, the system prompts you to choose the desired baby unit or all baby units, press **VOL** or **▲** to choose **All CAM or CAM #**, then press **SELECT**.

- Press **VOL** or **▲** to choose **Fahrenheit or Celsius**, then press **SELECT** to confirm your selection.

- Press **VOL** or **▲** to choose the desired temperature, then press **SELECT** to confirm your selection.

- Press **VOL** or **▲** to choose **TEMPERATURE**, then press **SELECT**.

- If you have more than one baby unit, the system prompts you to choose the desired baby unit or all baby units, press **VOL** or **▲** to choose **All CAM or CAM #**, then press **SELECT**.

- Press **VOL** or **▲** to choose **On or Off**, then press **SELECT** to confirm your selection.

- Press **MENU** when the parent unit is not in use.
- Press **VOL** or **▲** to choose **TEMPERATURE**, then press **SELECT**.

- If you have more than one baby unit, the system prompts you to choose the desired baby unit or all baby units, press **VOL** or **▲** to choose **All CAM or CAM #**, then press **SELECT**.

- Press **VOL** or **▲** to choose **On or Off**, then press **SELECT** to confirm your selection.

- Press **MENU** when the parent unit is not in use.
- Press **VOL** or **▲** to choose **TEMPERATURE**, then press **SELECT**.

- If you have more than one baby unit, the system prompts you to choose the desired baby unit or all baby units, press **VOL** or **▲** to choose **All CAM or CAM #**, then press **SELECT**.

- Press **VOL** or **▲** to choose **On or Off**, then press **SELECT** to confirm your selection.

- Press **MENU** when the parent unit is not in use.
- Press **VOL** or **▲** to choose **TEMPERATURE**, then press **SELECT**.

- If you have more than one baby unit, the system prompts you to choose the desired baby unit or all baby units, press **VOL** or **▲** to choose **All CAM or CAM #**, then press **SELECT**.

- Press **VOL** or **▲** to choose **On or Off**, then press **SELECT** to confirm your selection.

- Press **MENU** when the parent unit is not in use.
- Press **VOL** or **▲** to choose **TEMPERATURE**, then press **SELECT**.

- If you have more than one baby unit, the system prompts you to choose the desired baby unit or all baby units, press **VOL** or **▲** to choose **All CAM or CAM #**, then press **SELECT**.

- Press **VOL** or **▲** to choose **On or Off**, then press **SELECT** to confirm your selection.

- Press **MENU** when the parent unit is not in use.
- Press **VOL** or **▲** to choose **TEMPERATURE**, then press **SELECT**.

- If you have more than one baby unit, the system prompts you to choose the desired baby unit or all baby units, press **VOL** or **▲** to choose **All CAM or CAM #**, then press **SELECT**.

- Press **VOL** or **▲** to choose **On or Off**, then press **SELECT** to confirm your selection.

- Press **MENU** when the parent unit is not in use.
- Press **VOL** or **▲** to choose **TEMPERATURE**, then press **SELECT**.

- If you have more than one baby unit, the system prompts you to choose the desired baby unit or all baby units, press **VOL** or **▲** to choose **All CAM or CAM #**, then press **SELECT**.

- Press **VOL** or **▲** to choose **On or Off**, then press **SELECT** to confirm your selection.

- Press **MENU** when the parent unit is not in use.
- Press **VOL** or **▲** to choose **TEMPERATURE**, then press **SELECT**.

- If you have more than one baby unit, the system prompts you to choose the desired baby unit or all baby units, press **VOL** or **▲** to choose **All CAM or CAM #**, then press **SELECT**.

- Press **VOL** or **▲** to choose **On or Off**, then press **SELECT** to confirm your selection.

- Press **MENU** when the parent unit is not in use.
- Press **VOL** or **▲** to choose **TEMPERATURE**, then press **SELECT**.

- If you have more than one baby unit, the system prompts you to choose the desired baby unit or all baby units, press **VOL** or **▲** to choose **All CAM or CAM #**, then press **SELECT**.

- Press **VOL** or **▲** to choose **On or Off**, then press **SELECT** to confirm your selection.

- Press **MENU** when the parent unit is not in use.
- Press **VOL** or **▲** to choose **TEMPERATURE**, then press **SELECT**.

- If you have more than one baby unit, the system prompts you to choose the desired baby unit or all baby units, press **VOL** or **▲** to choose **All CAM or CAM #**, then press **SELECT**.

- Press **VOL** or **▲** to choose **On or Off**, then press **SELECT** to confirm your selection.

- Press **MENU** when the parent unit is not in use.
- Press **VOL** or **▲** to choose **TEMPERATURE**, then press **SELECT**.

- If you have more than one baby unit, the system prompts you to choose the desired baby unit or all baby units, press **VOL** or **▲** to choose **All CAM or CAM #**, then press **SELECT**.

- Press **VOL** or **▲** to choose **On or Off**, then press **SELECT** to confirm your selection.

- Press **MENU** when the parent unit is not in use.
- Press **VOL** or **▲** to choose **TEMPERATURE**, then press **SELECT**.

- If you have more than one baby unit, the system prompts you to choose the desired baby unit or all baby units, press **VOL** or **▲** to choose **All CAM or CAM #**, then press **SELECT**.

- Press **VOL** or **▲** to choose **On or Off**, then press **SELECT** to confirm your selection.

Night vision

The baby unit has infrared LEDs that allow you to see your baby clearly at night or in a dark room. When the baby unit detects low light levels, the infrared LEDs are switched on automatically.

NOTE
When the infrared LEDs are on, the image is in black and white. This is normal due to external light factors, like lights, objects, colors and backgrounds, the display resolution may vary. Adjust the baby's angle or place the baby unit at a higher level to prevent glare and blurry display.

TIP
Depending on the sun outdoors and other interfering factors, like lights, objects, colors and backgrounds, the display resolution may vary. Adjust the baby's angle or place the baby unit at a higher level to prevent glare and blurry display.

Add new baby unit (VM304)

The baby units and parent unit provided are already paired. You can add or replace any baby units. To add a new baby unit, follow these steps:
1. Press **MENU** when the parent unit is not in use.
2. Press **VOL** or **▲** to choose **VIBRATION**, then press **SELECT**.
3. Press **VOL** or **▲** to choose **On if speaker is off**. The parent unit vibrates only when the speaker of the parent unit is turned off.
4. **Always on**: The parent unit vibrates regardless of the speaker volume setting.
5. **Off**: The parent unit will not vibrate at all instances.
6. Press **SELECT** to confirm your selection.

For more details, refer to the user's manual that comes with your VM304 new baby unit.

General product care

To keep this product working well and looking good, follow these guidelines:

- Avoid putting this near heating appliances and devices that generate electrical noise (for example, motors or fluorescent lamps).
- DO NOT expose it to direct sunlight or moisture.
- DO NOT drop the product or treating it roughly, especially with a soft cloth.
- DO NOT immerse the parent unit and the baby unit in water and do not clean them under the tap.
- DO NOT use cleaning spray or liquid cleaners.
- Make sure the baby unit and parent unit use dry before you connect them to the mains again.

Storage

When you are not going to use the baby monitor for some time, remove the rechargeable battery from the parent unit. Store the parent unit, the baby unit and the adapters in a cool and dry place.

Frequently asked questions

Below are the questions most frequently asked about the baby monitor. If you cannot find the answer to your question, visit our website at www.vtechphones.com or contact (800) 274-VTECH for further service.