

Go to www.vtechphones.com to register your product for enhanced warranty support and the latest VTech product news.

CS6120-2
CS6120-31
CS6124
CS6124-2
CS6124-31

DECT 6.0 cordless telephone



vtech®

Abridged user's manual

Congratulations

on purchasing your new VTech product. Before using this telephone, please read **Important safety instructions**.

This abridged user's manual provides you with basic installation and use instructions. A limited set of features are described in abbreviated form.

Please refer to the online user's manual for a full set of installation and operation instructions at www.vtechcanada.com.



Telephones identified with this logo have reduced noise and interference when used with most T-coil equipped hearing aids and cochlear implants. The TIA-1083 Compliant Logo is a trademark of the Telecommunications Industry Association. Used under license.

What's in the box

Your telephone package contains the following items. Save your sales receipt and original packaging in the event warranty service is necessary.

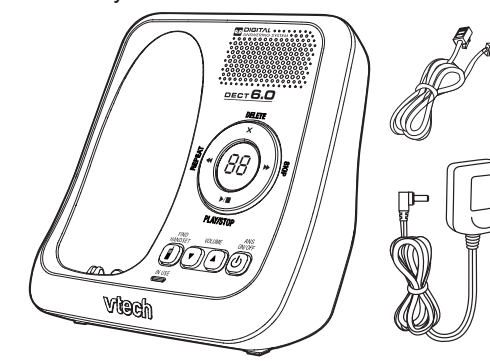

1 set for CS6124;
2 sets for CS6120-2/
CS6124-2;
3 sets for CS6120-31/
CS6124-31

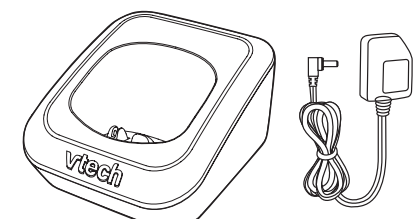

1 set for CS6120-2/CS6124-2;
2 sets for CS6120-31/CS6124-31

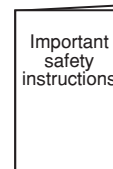
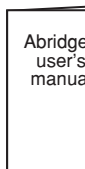

Telephone base overview

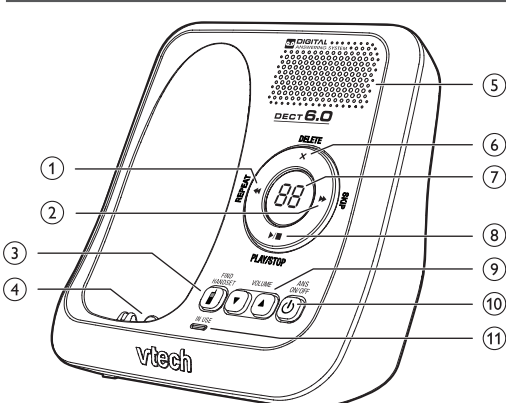

- 1 - ◀/REPEAT**
 - Repeat a message.
 - Press twice to play the previous message.
- 2 - ▶/SKIP**
 - Skip to the next message.
- 3 - ⏪/FIND HANDSET**
 - Page all system handsets.
- 4 - Charging pole**
- 5 - Speakerphone**
- 6 - X/DELETE**
 - Delete the playing message.
 - Press twice to delete all old messages.
- 7 - Message window**
- 8 - ▶/PLAY/STOP**
 - Play messages.
 - Stop playing messages.
- 9 - ▲/▼/VOLUME**
 - Adjust the listening volume.
 - Adjust the telephone base ringer volume.
- 10 - ◊/ANS ON/OFF**
 - Turn on or off the answering system.
- 11 - IN USE light**
 - Flashes when there is an incoming call, or another telephone sharing the same line is in use.
 - On when the telephone is in use, or the answering system is answering a call.

Handset overview

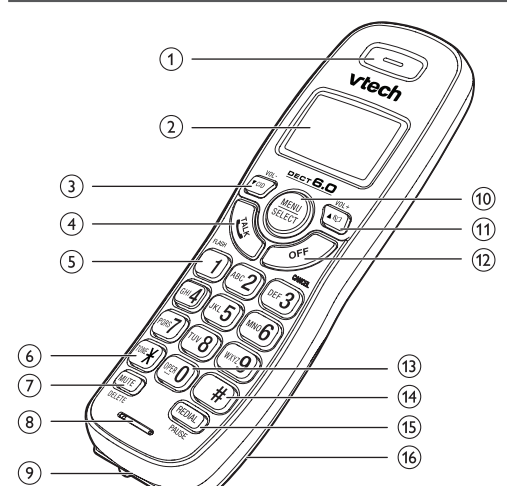

- 1 - Handset earpiece**
- 2 - LCD display**
- 3 - ◊/CID/VOL-**
 - Review the caller ID log when the telephone is not in use.
 - Scroll down while in a menu, or in the directory, caller ID log or redial list.
 - Move the cursor to the left when entering numbers or names.
 - Decrease the listening volume during a call or message playback.
- 4 - ⚡/FLASH**
 - Make or answer a call.
 - Answer an incoming call when you receive a call waiting alert.
- 5 - 1**
 - Press repeatedly to add or remove 1 in front of the caller ID log entry before dialing or saving it to the directory.
- 6 - TONE X**
 - Switch to tone dialing temporarily during a call.
- 7 - MUTE/DELETE**
 - Mute the microphone during a call.
 - Silence the handset ringer temporarily while the phone is ringing.
 - Delete the displayed entry while reviewing the directory, caller ID log or redial list.
 - Delete digits or characters when entering numbers or names.
- 8 - Microphone**
- 9 - Charging pole**

- 10 - MENU/SELECT**
 - Show the menu.
 - While in a menu, press to select an item, or save an entry or setting.
- 11 - ▲/VOL+**
 - Review the directory when the phone is not in use.
 - Scroll up while in a menu, or in the directory, caller ID log or redial list.
 - Move the cursor to the right when entering numbers or names.
 - Increase the listening volume during a call or message playback.
- 12 - OFF/CANCEL**
 - Hang up a call.
 - Return to the previous menu or idle mode without making changes.
 - Delete digits while predialing.
 - Silence the handset ringer temporarily while the phone is ringing.
 - Erase the missed call indicator while the handset is not in use.
- 13 - 0/OPER**
 - Enter space character during text editing.
- 14 - #**
 - Show other dialing options when reviewing a caller ID log entry.
- 15 - REDIAL/PAUSE**
 - Review the redial list.
 - Insert a dialing pause while dialing or entering numbers into the directory.
- 16 - Battery compartment cover**

Charger overview

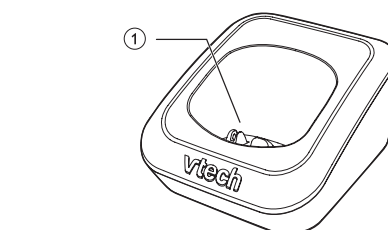

1 - Charging pole

Display icons overview

| | |
|--|--|
| | The battery icon flashes when the battery is low and needs charging. |
| | The battery icon animates when the battery is charging. |
| | The battery icon becomes solid when the battery is fully charged. |
| | There are new messages on the built-in answering system. |
| | There are new voicemail received from your telephone service provider. |
| | There are new caller ID log entries. |
| | The answering system is turned on. |
| | The message number currently playing. |

Connect

You can choose to connect the telephone base for desktop usage or wall mounting.

NOTES

- Use only the adapters provided.
- Make sure the electrical outlets are not controlled by wall switches.
- The adapters are intended to be correctly oriented in a vertical or floor mount position. The prongs are not designed to hold the plug in place if it is plugged into a ceiling, under-the-table or cabinet outlet.

TIP

If you subscribe to digital subscriber line (DSL) high-speed Internet service through your telephone line, make sure you install a **DSL filter** (not included) between the telephone line cord and telephone wall jack. Contact your DSL service provider for more information.

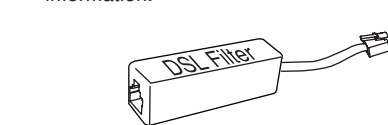

Connect the telephone base

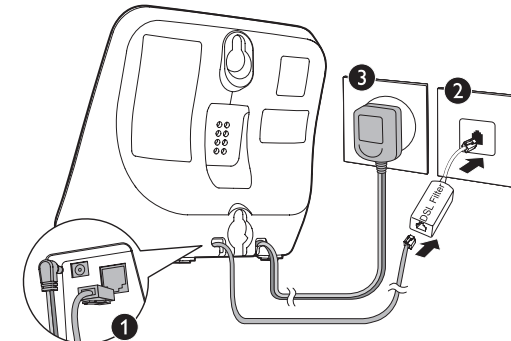

Connect the charger

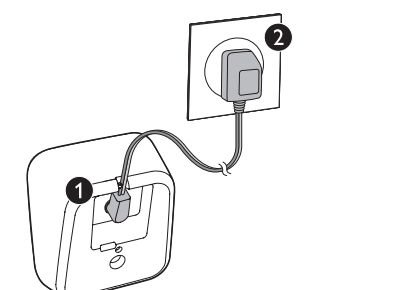

Mount the telephone base

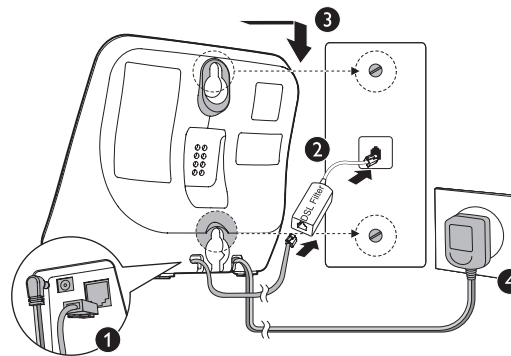

Install and charge the battery

Install the battery

Install the battery as shown below.

NOTES

- Use only supplied battery.
- Charge the battery provided with this product only in accordance with the instructions and limitations specified in this manual.
- If the handset will not be used for a long time, disconnect and remove the battery to prevent possible leakage.

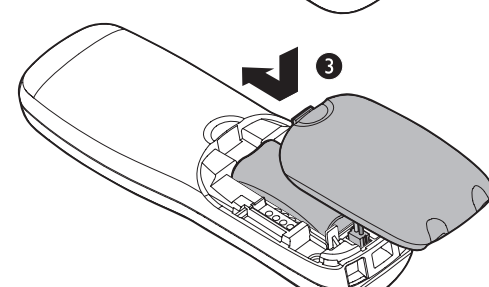
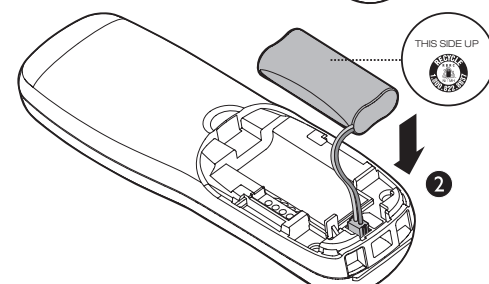
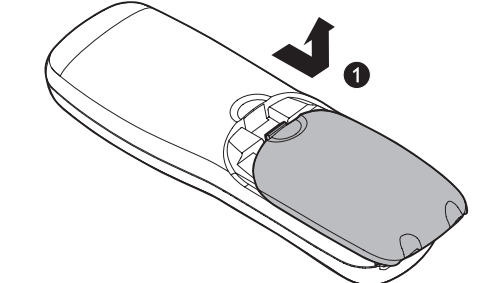

Charge the battery

Place the handset in the telephone base or the charger to charge.

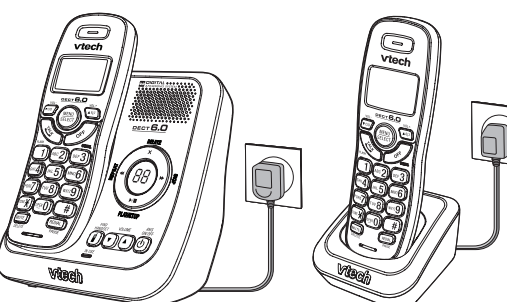

Once you have installed the battery, the handset LCD display indicates the battery status (see the table below).

NOTES

- For best performance, keep the handset in the telephone base or charger when not in use.
- The battery is fully charged after 16 hours of continuous charging.
- If you place the handset in the telephone base or the charger without plugging in the battery, the screen displays **No battery**.

| Battery indicators | Battery status | Action |
|--|---|---|
| The screen is blank, or displays Put in charger and | The battery has no or very little charge. The handset cannot be used. | Charge without interruption (at least 30 minutes). |
| The screen displays Low battery and | The battery has enough charge to be used for a short time. | Charge without interruption (about 30 minutes). |
| The screen displays HANDSET X . | The battery is charged. | To keep the battery charged, place it in the telephone base or charger when not in use. |

Before use

After you install your telephone or power returns following a power outage, the handset will prompt you to set the date and time.

Set date and time

NOTE

- Make sure you set the date and time including the year correctly; otherwise the answering system does not announce the correct day of the week for your recorded messages time stamp.

- Use the dialing keys (0-9) to enter the month (MM), date (DD) and year (YY). Then press **SELECT**.
- Use the dialing keys (0-9) to enter the hour (HH) and minute (MM). Then press **▼** or **▲** to choose **AM** or **PM**.
- Press **SELECT** to save.

Check for dial tone

Press **◊**. If you hear a dial tone, the installation is successful.

If you do not hear a dial tone:

- Make sure the installation procedures described above are properly done.
- It may be a wiring problem. If you have changed your telephone service to digital service from a cable company or a VoIP service provider, the telephone line may need to be rewired to allow all existing telephone jacks to work. Contact your cable/VoIP service provider for more information.

Operating range

This cordless telephone operates with the maximum power allowed by the Federal Communications Commission (FCC). Even so, this handset and telephone base can communicate over only a certain distance - which can vary with the locations of the telephone base and handset, the weather, and the layout of your home or office.

When the handset is out of range, the handset displays **Out of range** or **no pwr** at base.

If there is a call while the handset is out of range, it may not ring, or if it does ring, the call may not connect well when you press **◊**. Move closer to the telephone base, then press **◊** to answer the call.

If the handset moves out of range during a telephone conversation, there may be interference. To improve reception, move closer to the telephone base.

Use the handset menu

- Press **MENU** when the phone is not in use.
- Press **▼** or **▲** until the screen displays the desired feature menu.
- Press **SELECT**.
 - To return to the previous menu, press **CANCEL**.
 - To return to idle mode, **press and hold CANCEL**.

Configure your telephone

Set language

The LCD language is preset to English. You can select English, French or Spanish to be used in all screen displays.

- Press **MENU** when the handset is not in use.
- Scroll to **Settings**, then press **SELECT** twice.
- Scroll to choose **English**, **Français** or **Español**.
- Press **SELECT** twice to save your setting.

Set date and time

NOTE

- Make sure you set the date and time including the year correctly; otherwise the answering system does not announce the correct day of the week for your recorded messages time stamp.

- Press **MENU** on the handset when not in use.
- Scroll to **Set date/time** and then press **SELECT**.
- Use the dialing keys (0-9) to enter the month (MM), date (DD) and year (YY). Then press **SELECT**.
- Use the dialing keys (0-9) to enter the hour (HH) and minute (MM). Then press **▼** or **▲** to choose **AM** or **PM**.
- Press **SELECT**.

Temporary tone dialing

If you have pulse (rotary) service only, you can switch from pulse to touch-tone dialing temporarily during a call.

- During a call, press **TONE X**.
- Use the dialing keys to enter the relevant number. The telephone sends touch-tone signals. It automatically returns to pulse dialing mode after you end the call.

Telephone operations

Handset control key panel:

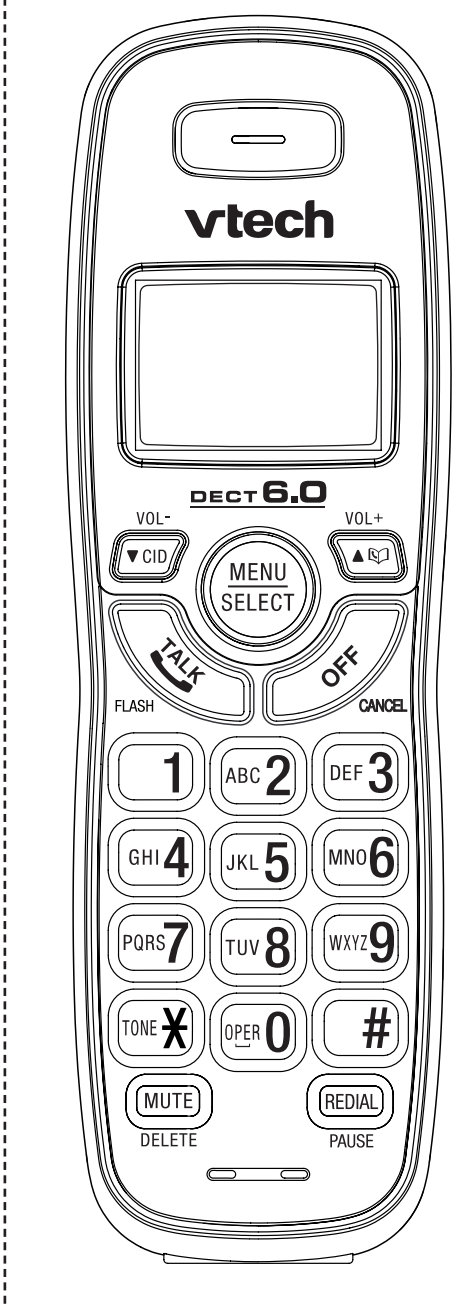

Make a call

- Press **◊**, and then dial the telephone number.

Answer a call

- Press **◊** or any of the dialing keys.

End a call:

- Press **OFF** or put the handset back in the telephone base or charger.

Volume

- During a call, press **VOL-** or **VOL+** to adjust the listening volume.

Mute

The mute function allows you to hear the other party but the other party cannot hear you.

- During a call, press **MUTE**. The handset displays **Muted**.
- Press **MUTE** again to resume the conversation. The handset displays **Microphone on** briefly.

Join a call in progress (for multiple handset models only)

You can use three handsets at a time on an outside call.

- When a handset is already on a call, press **◊** on another handset to join the call.
- To exit the call, press **OFF** on the handset or place it in the telephone base or charger. The call continues until all handsets hang up.

Call waiting

When you subscribe to call waiting service from your telephone service provider, you hear an alert tone if there is an incoming call while you are already on a call.

- Press **FLASH** to put the current call on hold and take the new call.
- Press **FLASH** at any time to switch back and forth between calls.

Find handset

Use this feature to find the system handset.

- Press **◊/FIND HANDSET** on the telephone base when not in use. All idle handsets ring and display **** Paging ****.

To start paging:

- Press **◊/FIND HANDSET** on the telephone base when not in use. All idle handsets ring and display **** Paging ****.

To end paging:

- Press **◊/FIND HANDSET** at the telephone base.

-OR-

- Press **◊** or any of the dialing keys on the handset.

NOTE

- Do not **press and hold ◊/FIND HANDSET** for more than four seconds. It may lead to handset deregistration.

Redial list

Each handset stores the last five telephone numbers dialed. When there are already five entries, the oldest entry is deleted to make room for the new entry.

Review and dial a redial list entry

- Press **REDIAL** when the handset is not in use.
- Press **▼**, **▲** or **REDIAL** repeatedly until the desired entry displays.
- Press **◊** to dial.

Delete a redial list entry

- When the desired redial entry displays, press **DELETE**.

Directory

The directory can store up to 30 entries, which are shared by all handsets. Each entry may consist of a telephone number up to 24 digits, and a name up to 15 characters.

Add a directory entry

- Enter the number when the phone is not in use. Press **MENU**, then go to Step 3.

-OR-

- Press **MENU** when the phone is not in use, then press **▼** or **▲** to scroll to **Directory**. Press **SELECT** twice to choose **Add contact**.

-OR-

- Copy a number from the redial list by pressing **REDIAL** and then press **▼**, **▲** or **REDIAL** repeatedly to select a number. Press **SELECT** to copy the number.

- Press **SELECT** to move on to enter the name.
- Use the dialing keys to enter the name. Additional key presses show other characters of that particular key.
- Press **SELECT** to save.

Review a caller ID log entry

- Press **CID** when the phone is not in use.
- Scroll to browse through the caller ID log.

While entering names and numbers, you can:

- Press **DELETE** to backspace and erase a digit or character.
- Press and hold DELETE** to erase the entire entry.
- Press **▼** or **▲** to move the cursor to the left or right.
- Press and hold PAUSE** to insert a dialing pause (for entering numbers only).
- Press 0 to add a space (for entering names only).

Review a directory entry

Entries are sorted alphabetically.

- Press **◊** when the phone is not in use.
- Scroll to browse through the directory, or use the dialing keys to start a name search.

Delete a directory entry

- When the desired entry displays, press **DELETE**.
- When the handset displays **Delete contact?**, press **SELECT**.

Edit a directory entry

- When the desired entry displays, press **SELECT**.
- Use the dialing keys to edit the number, then press **SELECT**.
- Use the dialing keys to edit the name, then press **SELECT**.

Dial a directory entry

- When the desired entry appears, press **◊** to dial.

Caller ID

If you subscribe to caller ID service, information about each caller appears after the first or second ring. If you answer a call before the caller information appears on the screen, it will not be saved in the caller ID log.

The caller ID log stores up to 30 entries. Each entry has up to 24 digits for the phone number and 15 characters for the name.

If the telephone number has more than 15 digits, only the last 15 digits appear. If the name has more than 15 characters, only the first 15 characters are shown and saved in the caller ID log.

Review a caller ID log entry

- Press **CID** when the phone is not in use.
- Scroll to browse through the caller ID log.

Missed call indicator

When there are calls that have not been reviewed in the caller ID log, the handset displays **XX missed calls**.

Each time you review a caller ID log entry marked **NEW**, the number of missed calls decreases by one.

When you have reviewed all the missed calls, the missed call indicator no longer displays.

If you do not want to review the missed calls one by one, **press and hold CANCEL** on the idle handset to erase the missed call indicator. All the entries are then considered old.

Dial a caller ID log entry

- When the desired entry appears, press **◊** to dial.

Save a caller ID log entry to the directory

- When the desired caller ID log entry displays, press **SELECT**.
- Use the dialing keys to modify the number, if necessary. Then press **SELECT**.
- Use the dialing keys to modify the name, if necessary. Then press **SELECT**.

Delete the caller ID log entries

- When the desired caller ID log entry displays, press **DELETE**.

To delete all caller ID log entries:

- Press **MENU** when the phone is not in use.
- Scroll to **Caller ID log** and then press **SELECT**.
- Scroll to **Del all calls** then press **SELECT** twice.

Sound settings

Key tone

You can turn the key tone on or off.

- Press **MENU** when the handset is not in use.
- Scroll to **Settings** and then press **SELECT**.
- Scroll to choose **Key tone**, then press **SELECT**.
- Press **▼** or **▲** to choose **On** or **Off**, then press **SELECT** to save.

Ringer tone

You can choose from different ringer tones for each handset.

Set your built-in answering system

The answering system can record and store up to 99 messages. Each message can be up to three minutes in length. The total storage capacity for the announcement, messages and memos is approximately 11 minutes. The actual recording time depends on individual message characteristics.

Your answering system allows you to set your announcement, save and delete messages, activate call screening, to set number of rings before pick up, to access remotely, and to control the recording time.

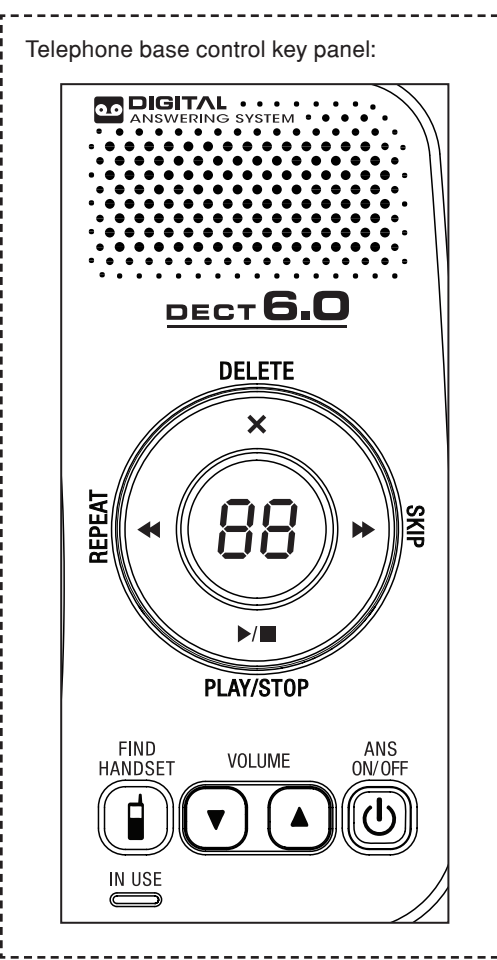

Turn the answering system on or off

The answering system must be turned on or to answer and record messages.

To turn on or off with the telephone base:

- Press **ON/OFF** to turn the built-in answering system on or off.

To turn on or off with the handset:

- Press **MENU** when the phone is not in use.
- Scroll to **Answering sys** and then press **SELECT**.
- Scroll to **Ans on/off** and then press **SELECT**.
- Press **▼** or **▲** to choose **On** or **Off** and then press **SELECT**.

Set voice language

The voice prompt language is preset to English. You can select English or French to be used for the voice prompts in your answering system.

- Press **MENU** when the handset is not in use.
- Scroll to **Answering sys** and then press **SELECT**.
- Scroll to **Ans sys setup** and then press **SELECT**.
- Scroll to **Voice language** and then press **SELECT**.
- Scroll to choose **English** or **Français**.
- Press **SELECT** to save your setting.

Default announcement

The telephone is preset with a greeting that answers calls with *"Hello, please leave a message after the tone."* You can use this preset announcement, or replace it with your own.

Record your own announcement

The announcement can be up to 90 seconds in length.

- Press **MENU** when the phone is not in use.
- Scroll to **Answering sys** then press **SELECT** twice.
- The handset announces, *"To play, press 2. To record, press 7."* Then press **7** to record.
- The handset announces, *"Record after the tone. Press 5 when you are done."* After the tone, speak towards the handset microphone.
- Press **5** when done.

Play the announcement

- Press **MENU** when the phone is not in use.
- Scroll to **Answering sys** then press **SELECT** twice.
- The handset announces, *"To play, press 2. To record, press 7."* Then press **2** to play the current announcement.

Options during playback:

- Press **VOL+** or **VOL-** to adjust the listening volume.
- Press **▶/■** when the phone is not in use.
- Press **5** or **OFF** to stop at any time.

Delete the announcement

- Press **MENU** when the phone is not in use.
- Scroll to **Answering sys** then press **SELECT** twice.
- The handset announces, *"To play, press 2. To record, press 7."* Then press **2** to delete your own recorded announcement.

NOTE

- After you deleted your own recorded announcement, the answering system answers calls with the default announcement.

Set number of rings

You can set the answering system to answer an incoming call after two, three, four, five or six rings, or toll saver. If you choose toll saver, the answering system answers a call after two rings when you have new messages, or after four rings when you have no new messages.

- Press **MENU** when the phone is not in use.
- Scroll to **Answering sys** and then press **SELECT**.
- Scroll to **Ans sys setup** and then press **SELECT**.
- Scroll to **# of rings** and then press **SELECT**.
- Press **▼** or **▲** to choose **6, 5, 4, 3, 2** or **Toll saver** and then press **SELECT**.

Set recording time

You can set the recording time for each incoming message.

- Press **MENU** when the phone is not in use.
- Scroll to **Answering sys** and then press **SELECT**.
- Scroll to **Ans sys setup** and then press **SELECT**.
- Scroll to **Recording time** and then press **SELECT**.
- Press **▼** or **▲** to choose **3 minutes, 2 minutes or 1 minute**, and then press **SELECT**.

Use your built-in answering system

New message indication

When there are new answering system messages, the handset displays **XX new messages** and **QD**, and the message window on the telephone base flashes. When you are reviewing a new message, **NEW** and **QD** display on the handset.

If the message alert tone is turned on, the telephone base beeps every 10 seconds when there are messages that have not been reviewed.

Message playback

To playback messages at the telephone base:

- Press **▶/■** when the phone is not in use.

Options during playback:

- Press **▼/VOLUME** or **▲/VOLUME** to adjust the listening volume.
- Press **▶/SKIP** to skip to the next message.
- Press **◀/REPEAT** to repeat the playing message. Press **◀/REPEAT** twice to listen to the previous message.
- Press **X/DELETE** to delete the playing message. The system advances to the next message.
- Press **▶/STOP** to stop.

To playback messages with a handset:

- Press **MENU** when the phone is not in use, and then press **SELECT**.

Options during playback:

- Press **VOL-** or **VOL+** to adjust the listening volume.
- Press **6** to skip to the next message.
- Press **4** to repeat the playing message. Press **4** twice to listen to the previous message.
- Press **3** to delete the playing message. The system advances to the next message.
- Press **OFF** to stop the playback.

Delete all messages

You can only delete old (reviewed) messages. You cannot delete new messages until you review them. You cannot retrieve deleted messages.

To delete all messages with the telephone base:

- Press **X/DELETE** twice when the phone is not in use.

To delete all messages with a handset:

- Press **MENU** when the phone is not in use.
- Scroll to **Answering sys** and then press **SELECT**.
- Scroll to **Delete all old** and then press **SELECT** twice.

Remote access

A two-digit security code is required to access the answering system remotely from any touch-tone telephone. The preset code is **19**. You can use this preset code, or set your own.

- Dial your telephone number from any touch-tone telephone.
- When the system plays your announcement, enter the two-digit security code.
- Enter one of the following remote commands.

| Command | Description |
|-----------|---|
| 1 | Play all messages. |
| 2 | Play only new messages. |
| 3 | Delete the current message (during playback). |
| 33 | Delete all old messages. |
| 4 | Repeat the current message (during playback). |
| 5 | Stop. |
| *5 | Hear a list of remote commands. |
| 6 | Skip to the next message (during playback). |
| *7 | Record a new announcement. |
| 8 | End the call. |
| 0 | Turn the answering system on or off. |

- Hang up or press **8** to end the call.

Remote access code

You can set your own remote access code from **00 to 99**.

- Press **MENU** when the phone is not in use.
- Scroll to **Answering sys** and then press **SELECT**.
- Scroll to **Ans sys setup** and then press **SELECT**.
- Scroll to **Remote code** and then press **SELECT**.
- Press the dialing keys (**0-9**) to enter the code, or **▼** or **▲** to select from **00 to 99**, then press **SELECT**.

NOTE

- This feature turns off the indicators only. It does not delete your voicemail messages.

- Press **MENU** when the phone is not in use.
- Scroll to **Settings** and then press **SELECT**.
- Scroll to **Clr voicemail** and then press **SELECT**.
- Press **SELECT** again to confirm.

Use the built-in answering system and voicemail service

You can use your answering system and voicemail service together by setting your answering system to answer before voicemail service answers as described below. To learn how to program your voicemail settings, contact your telephone service provider.

If you are on a call, or if the answering system is busy recording a message and you receive another call, the second caller can leave a voicemail message.

Set your answering system to answer calls at least two rings earlier than your voicemail service is set to answer. For example, if your voicemail service answers after six rings, set your answering system to answer after four rings. Some voicemail service providers may program the delay before answering calls in seconds instead of rings. In this case, allow six seconds per ring when determining the appropriate setting.

Retrieve voicemail from telephone service

Voicemail is a feature available from most telephone service providers. It may be included with your telephone service, or may be optional. Fees may apply.

Retrieve voicemail

When you received a voicemail, the handset displays **✉** and **New voicemail**. To retrieve, you typically dial an access number provided by your telephone service provider, and then enter a security code. Contact your telephone service provider for instructions on how to configure the voicemail settings and listen to messages.

- NOTE**
- Press **NOTE** have you listened to all new voicemail messages, the indicators on the handset turn off automatically.

Turn off the new voicemail indicators

If you have retrieved your voicemail while away from home, and the handset still displays the new voicemail indicators, use this feature to turn off the indicators.

NOTE

- This feature turns off the indicators only. It does not delete your voicemail messages.

- Press **MENU** when the phone is not in use.
- Scroll to **Settings** and then press **SELECT**.
- Scroll to **Clr voicemail** and then press **SELECT**.
- Press **SELECT** again to confirm.

Register a handset

When your handset is deregistered from the telephone base, follow the steps below to register it back to the telephone base.

- Remove the handset from the telephone base.
- Press and hold **▼/FIND HANDESET** at the telephone base for about four seconds until the **IN USE** light turns on.
- Then press **#** on the handset. It displays **Registering...**

The handset show **Registered** and you hear a beep when the registration process completes. The registration process takes about 60 seconds to complete.

General product care

Taking care of your telephone

Your cordless telephone contains sophisticated electronic parts, so it must be treated with care.

Avoid rough treatment

Place the handset down gently. Save the original packing materials to protect your telephone if you ever need to ship it.

Avoid water

Your telephone can be damaged if it gets wet. Do not use the handset outdoors in the rain, or handle it with wet hands. Do not install the telephone base near a sink, bathtub or shower.

Electrical storms

Electrical storms can sometimes cause power surges harmful to electronic equipment. For your own safety, take caution when using electrical appliances during storms.

Cleaning your telephone

Your telephone has a durable plastic casing that should retain its luster for many years. Clean it only with a dry non-abrasive cloth. Do not use dampened cloth or cleaning solvents of any kind.

Frequently asked questions

Below are the questions most frequently asked about the cordless telephone. If you cannot find the answer to your question, visit our website at **www.vtechcanada.com** or call **1 (800) 267-7377** for customer service.

| | |
|---|---|
| My telephone does not work at all. | Make sure the telephone base is installed properly, and battery is installed and charged correctly. For optimum daily performance, return the handset to the telephone base after use. |
| The display shows No line . I cannot hear the dial tone. | Disconnect the telephone line cord from your telephone and connect it to another telephone. If there is no dial tone on that other telephone either, then the telephone line cord may be defective. Try installing a new telephone line cord. If changing the telephone line cord does not help, the wall jack (or the wiring to this wall jack) may be defective. Contact your telephone service provider. |
| The answering system does not record messages. | Make sure the answering system is on. When the answering system is on, ANS ON should display on the handset and the telephone base. <p>You may be using a new cable or VoIP service, the existing telephone jacks in your home may no longer work. Contact your service provider for solutions.</p> <p>When the answering machine memory is full, it does not record new messages until some old messages are deleted.</p> <p>If you subscribe to voicemail service, change the number of rings so that your answering system answers before your voicemail service answers. To determine how many rings activate your voicemail service, contact your telephone service provider.</p> |
| How do you get warranty service? | To obtain warranty service, please visit our website at www.vtechcanada.com or call 1 (800) 267-7377. <p>NOTE: Before calling for service, please review the user's manual - a check of the Product's controls and features may save you a service call.</p> <p>Except as provided by applicable law, you assume the risk of loss or damage during transit and transportation and are responsible for delivery or handling charges incurred in the transport of the Product(s) to the service location. V-Tech will return repaired or replaced Product under this limited warranty. Transportation, delivery or handling charges are prepaid. V-Tech assumes no risk for damage or loss of the Product in transit. If the Product failure is not covered by this limited warranty, or proof of purchase does not meet the terms of this limited warranty, V-Tech will notify you and will request that you authorize the cost of repair prior to any further repair activity. You must pay for the cost of repair and return shipping costs for the repair of Products that are not covered by this limited warranty.</p> <p>What must you return with the Product to get warranty service?</p> <p>1. Return the entire original package and contents including the Product to the V-Tech service location along with a description of the malfunction or difficulty; and</p> <p>2. Include a "valid proof of purchase" (sales receipt) identifying the Product purchased (Product model) and the date of purchase or receipt; and</p> <p>3. Provide your name, complete and correct mailing address, and telephone number.</p> <p>Other limitations</p> <p>This warranty is the complete and exclusive agreement between you and V-Tech. It supersedes all other written or oral communications related to this Product. V-Tech provides no other warranties for this Product. The warranty exclusively describes all of V-Tech's responsibilities regarding the Product. There are no other warranties or limitations. No one is authorized to make modifications to this limited warranty and you should not rely on any such modification.</p> <p>State/Provincial Law Rights: This warranty gives you specific legal rights, and you may have additional rights, which vary from state to state or province to province.</p> <p>Limitations: Implied warranties, including those of fitness for a particular purpose and merchantability (an unwritten warranty that the Product is fit for the use or replacement intended, or shipped to you or (b) the time remaining on the original one-year warranty; whichever is longer.</p> <p>What is not covered by this limited warranty?</p> <p>This limited warranty does not cover:</p> <ol style="list-style-type: none">Product that has been subjected to misuse, accident, shipping or other physical damage, improper installation, abnormal operation or handling, neglect, inundation, fire, water or other liquid intrusion. Product that has been damaged due to repair, alteration or modification by anyone other than an authorized service representative of V-Tech; Product to the extent that the problem experienced is caused by any indirect, special, incidental, consequential, or similar damages (including, but not limited to lost profits or revenue, inability to use the Product or other associated equipment, the cost of substitute equipment and claims by third parties) resulting from the use of this Product. Some states/provinces do not allow the exclusion or limitation of incidental or consequential damages, so the above limitation or exclusion may not apply to you. |
| What is the limited warranty period? | The limited warranty period for the Product extends for ONE (1) YEAR from the date of purchase. If V-Tech repairs or replaces a Materially Defective Product under the terms of this limited warranty, this limited warranty also applies to the repaired or replacement Product for a period of either (a) 90 days from the date of purchase or replacement, or (b) the time remaining on the original one-year warranty; whichever is longer. |
| What is the limited warranty period? | This limited warranty does not cover: <ol style="list-style-type: none">Product that has been subjected to misuse, accident, shipping or other physical damage, improper installation, abnormal operation or handling, neglect, inundation, fire, water or other liquid intrusion. Product that has been damaged due to repair, alteration or modification by anyone other than an authorized service representative of V-Tech; Product to the extent that the problem experienced is caused by any indirect, special, incidental, consequential, or similar damages (including, but not limited to lost profits or revenue, inability to use the Product or other associated equipment, the cost of substitute equipment and claims by third parties) resulting from the use of this Product. Some states/provinces do not allow the exclusion or limitation of incidental or consequential damages, so the above limitation or exclusion may not apply to you. |
| How long is the limited warranty period? | The limited warranty period for the Product extends for ONE (1) YEAR from the date of purchase. If V-Tech repairs or replaces a Materially Defective Product under the terms of this limited warranty, this limited warranty also applies to the repaired or replacement Product for a period of either (a) 90 days from the date of purchase or replacement, or (b) the time remaining on the original one-year warranty; whichever is longer. |
| What is not covered by this limited warranty? | This limited warranty does not cover: <ol style="list-style-type: none">Product that has been subjected to misuse, accident, shipping or other physical damage, improper installation, abnormal operation or handling, neglect, inundation, fire, water or other liquid intrusion. Product that has been damaged due to repair, alteration or modification by anyone other than an authorized service representative of V-Tech; Product to the extent that the problem experienced is caused by any indirect, special, incidental, consequential, or similar damages (including, but not limited to lost profits or revenue, inability to use the Product or other associated equipment, the cost of substitute equipment and claims by third parties) resulting from the use of this Product. Some states/provinces do not allow the exclusion or limitation of incidental or consequential damages, so the above limitation or exclusion may not apply to you. |
| Can I get a replacement handset? | Yes, if you are within the limited warranty period, you may be eligible for a replacement handset. However, there is no guarantee that interference will not occur in a particular installation. If this equipment does cause harmful interference to radio or television reception, which can be determined by turning the equipment off and on, the user is encouraged to try to correct the interference by one or more of the following measures: <ul style="list-style-type: none">Reorient or relocate the receiving antenna. Increase the separation between the equipment and receiver. Connect the equipment into an outlet on a circuit different from that to which the receiver is connected. Consult the dealer or an experienced radio/TV technician for help. Changes or modifications to this equipment not expressly approved by the party responsible for compliance could void the user's authority to operate the equipment. |
| Can I get a replacement handset? | This device complies with Part 15 of the FCC rules. Operation is subject to the following two conditions: (1) this device may not cause harmful interference, and (2) this device must accept any interference received, including interference that may cause undesired operation. Privacy of communications may not be ensured when using this telephone. |
| Can I get a replacement handset? | To ensure safety of users, the FCC has established criteria for the amount of radio frequency energy that can be safely absorbed by a user or bystander according to the intended use of the product. This product has been tested and found to comply with the FCC criteria. The handset may be safely held against the ear of the user. The telephone base shall be installed such that part of the user's body does not touch the hands are maintained at a distance of approximately 20 cm (8 inches) or more. |

located in an environment containing concentrations of flammable or flame-supporting gases, unless there is adequate ventilation. A spark in such an environment could create a fire or explosion. Such environments might include: medical oxygen without adequate ventilation; industrial gases (cleaning solvents; gasoline vapors, etc.); a leak of natural gas, etc.

16. Only put the handset of your telephone next to your ear when it is in normal talk mode.

17. The power adapter is intended to be correctly oriented in a vertical or floor mount position. The prongs are not designed to hold the plug in place if it is plugged into a ceiling, under-the-table or cabinet outlet.

SAVE THESE INSTRUCTIONS

Battery

- Use only the battery provided or equivalent. To order a replacement, visit our website at www.vtechcanada.com or call 1 (800) 267-7377.

- Do not dispose of the battery in a fire. Check with local waste management codes for special disposal instructions.

- Do not open or mutilate the battery. Released electrolyte is corrosive and may cause burns or injury to the eyes or skin. The electrolyte may be toxic if swallowed.

- Exercise care in handling batteries in order not to create a short circuit with conductive materials.
- Charge the battery provided with or identified for use with this product only in accordance with the instructions and limitations specified in this manual.

Precautions for users of implanted cardiac pacemakers
Cardiac pacemakers (applies only to digital cordless telephones):

Wireless Technology Research, LLC (WTR), an independent research entity, led a multidisciplinary evaluation of the interference between portable wireless telephones and implanted cardiac pacemakers. Supported by the U.S. Food and Drug Administration, WTR recommends to physicians that:

Pacemaker patients

- Should keep wireless telephones at least six inches from the pacemaker.
- Should NOT place wireless telephones directly over the pacemaker, such as in a breast pocket, when it is turned ON.
- Should use the wireless telephone at the ear opposite the pacemaker.

WTR's evaluation did not identify any risk to bystanders with pacemakers from other persons using wireless telephones.

About cordless telephones

- Privacy:** The same features that make a cordless telephone convenient create some limitations. Telephone calls are transmitted between the telephone base and the cordless handset by radio waves, so there is a possibility that the cordless telephone conversations could be intercepted by radio receiving equipment within range of the cordless handset. For this reason, you should not think of cordless telephone conversations as being as private as those on corded telephones.
- Electrical power:** The telephone base of this cordless telephone must be connected to a working electrical outlet. The electrical outlet should not be controlled by a wall switch. Calls cannot be made from the cordless handset if the telephone base is unplugged, switched off or if the electrical power is interrupted.

- Potential TV interference:** Some cordless telephones operate at frequencies that may cause interference to televisions and VCRs. To minimize or prevent such interference, do not place the telephone base of the cordless telephones near or on top of a TV or VCR. If interference is experienced, moving the cordless telephone farther away from the TV or VCR often reduces or eliminates the interference.

- Rechargeable batteries:** Exercise care in handling batteries in order not to create a short circuit with conducting material such as rings, bracelets and keys. The battery or conductor may overheat and cause harm. Observe proper polarity between the battery and the battery charger.
- Nickel-metal hydride rechargeable batteries:** Dispose of these batteries in a safe manner. Do not burn or mutilate the batteries. Like other batteries of this type, if burned or punctured, they could release caustic material which could cause injury.

For C-UL compliance only

Mesures de sécurité importantes

Afin de réduire les risques d'incendie, de blessures corporelles ou d'électrocution, suivez toujours ces mesures préventives de base lorsque vous utilisez votre téléphone :

- Lisez et comprenez bien toutes les instructions.
- Observez toutes les instructions et mises en garde inscrites sur l'appareil.
- Débranchez le téléphone de la prise murale avant de le nettoyer. N'utilisez pas de nettoyeurs liquides ni en aérosol. N'utilisez qu'un chiffon doux et légèrement humecté.
- N'utilisez pas ce produit près de l'eau, tel que près d'un bain, d'un lavabo, d'un évier de cuisine, d'un bac de lavage ou d'un réservoir, ou dans un sous-sol humide ou sous la douche.
- Ne déposez pas ce téléphone sur un chariot, support ou table chancelants. L'appareil pourrait tomber et être sérieusement endommagé.
- Évitez d'installer le système téléphonique dans les endroits soumis à une température extrême, à la lumière directe du soleil ou à proximité immédiate d'autres appareils électriques ou électroniques. Protégez votre téléphone contre les risques chimiques, la poussière, les vapeurs et les liquides corrosifs.
- Le boîtier de l'appareil est doté de fentes et d'ouvertures d'aération situées à l'arrière ou en dessous. Afin d'empêcher la surchauffe, ces ouvertures ne doivent pas être obstruées en plaçant l'appareil sur un lit, divan, tapis ou autre surface similaires. Ne placez pas cet appareil à proximité d'un élément de chauffage ni d'une plinthe électrique. De plus, ne l'installez pas dans une unité murale ou un cabinet fermé qui ne possède pas d'aération adéquate.
- Ne faites fonctionner cet appareil qu'avec le type d'alimentation indiqué sur les étiquettes de l'appareil. Si vous ne connaissez pas le voltage de votre maison, consultez votre marchand ou votre fournisseur d'électricité.
- Ne déposez rien sur le cordon d'alimentation. Installez cet appareil dans un endroit sécuritaire, là où personne ne pourra ténêcher sur la ligne d'alimentation ni le cordon téléphonique modulaire.
- N'insérez jamais d'objets à travers les fentes et ouvertures de cet appareil, car ils pourraient toucher à des points de tension dangereux ou court-circuiter des pièces, ce qui constituerait un risque d'incendie ou d'électrocution. N'échappez pas de liquides dans l'appareil.
- Afin de réduire les risques d'électrocution, ne démontez pas l'appareil, mais appez-vous sur un service qualifié s'il doit être réparé. En enlevant le couvercle, vous vous exposez à des tensions dangereuses ou autres dangers similaires. Un remontage inadéquat peut être à l'origine d'une électrocution lors d'une utilisation ultérieure de l'appareil. Débranchez l'appareil avant de procéder au nettoyage. Utilisez un chiffon humide et doux.
- Ne surchargez pas les prises de courant et les rallonges.
- Débranchez cet appareil de la prise de courant et déconnectez-le de la ligne d'alimentation de service à la clientèle de V-Tech dans les cas suivants :
 - Lorsque le cordon d'alimentation est endommagé ou liché.
 - Si du liquide a été échappé dans l'appareil.

- Si l'appareil a été exposé à une source d'humidité telle que la pluie, ne le réutilisez pas.
- Si le produit ne fonctionne pas normalement en respectant les instructions de fonctionnement. Réglez uniquement les commandes indiquées dans le manuel des instructions de fonctionnement. Les réglages incorrects des autres commandes pourraient provoquer un dommage qui pourrait égarer un travail exhaustif de la part d'un technicien autorisé afin de rétablir le fonctionnement normal de l'appareil.
- Si le produit a été échappé et que le socle et/ou le combiné a été endommagé.
- Si le produit affiche une nette diminution de sa performance.

- Évitez d'utiliser un téléphone (autre qu'un sans fil) pendant les éclairs peuvent être à l'origine d'une électrocution.

- N'utilisez pas le téléphone pour rapporter une fuite de gaz à proximité de la fuite. En certaines circonstances, une flamme pourrait être provoquée lorsque l'adaptateur est branché à une prise de courant, ou lorsque le combiné est déposé sur le socle. Ceci est un événement commun associé à la fermeture d'un circuit électrique. L'utilisateur ne devrait pas brancher le téléphone à une prise de courant, et ne devrait pas déposer le combiné chargé sur le socle, si le téléphone se trouve à proximité d'une source de fortes concentrations de gaz inflammables, à moins que la ventilation soit adéquate. Une flamme dans un tel endroit pourrait provoquer un incendie ou une explosion. Des tests environnementaux ont démontré que les électrodes ou l'utilisation de l'oxygène médical sans ventilation adéquate, des gaz industriels (dissolvants de nettoyage, des vapeurs d'essence, etc.) une fuite de gaz naturel), etc.
- Ne placez que le combiné de votre téléphone près de votre oreille lorsqu'en mode de conversation.
- Ces adaptateurs ont été conçus pour être orientés en position verticale ou montés au sol. Les broches ne sont pas conçues pour maintenir l'adaptateur en place si celui-ci est branché dans une prise au plafond ou sous une table/ armoire.
- Pour le MATERIEL RACCORDE PAR PRISE DE COURANT, le socle de prise de courant doit être installé à proximité du matériel de votre fournisseur d'électricité.

CONSERVEZ CES INSTRUCTIONS

- Pile**

N'utilisez que la pile incluse ou l'équivalent. Pour commander une pile de recharge, visitez notre site Web