



5.5" Touch Screen Wi-Fi Pan & Tilt Monitor

LF2936FHD
LF2936-2FHD



Parent Guide

This guide contains important information. Please keep it for future reference.

Need help?

Visit leapfrog.com/support

Visit our website leapfrog.com for more information about products, downloads, resources and more.

Read our complete warranty policy online at leapfrog.com/warranty.



Scan the QR code to enter the Online Manual:



Or go to leapfrog.com/support

Important Safety Instructions

The applied nameplate is located at the bottom of the Baby Unit's base.

When using your equipment, basic safety precautions should always be followed to reduce the risk of fire, electric shock and injury, including the following:

- Follow all warnings and instructions marked on the product.
- Adult setup is required.
- CAUTION:** Do not install the Baby Unit at a height above 6.5 feet (2 meters).
- This product is intended as an aid. It is not a substitute for responsible and proper adult supervision and should not be used as such.
- This product is not intended for use as a medical monitor.
- Do not use this product near water, for example, near to a bath, sink, swimming pool or shower.
- CAUTION:** Use only the battery provided. There may be a risk of explosion if a wrong type of battery is used for the parent unit. The battery cannot be subjected to high or low extreme temperature and low air pressure at high altitude during use, storage or transportation. Disposal of battery in fire or a hot oven, mechanically crushing or cutting the battery can result in an explosion. Leaving the battery in an extremely high temperature surrounding environment can result in an explosion or the leakage of flammable liquid or gas. Battery subjected to extremely low air pressure may result in an explosion or the leakage of flammable liquid or gas. Dispose of used battery according to the information in **The RBRC seal**.
- Use only the power adapters included with this product. Incorrect power adapter polarity or voltage can seriously damage the product.

Power adapter information:

Baby Unit output: 5V DC 1A;
V-Tech Telecommunications Ltd.; Model: VT05EUS05100
Parent Unit output: 5V DC 2A;
V-Tech Telecommunications Ltd.; Model: VT07EUS05200

Rechargeable battery information:
Zhuohai Great Power Energy Co., Ltd.; Lithium battery,
3.7V 5000mAh; Model: GSP806090-5Ah-3.7V-1S1P

- The power adapters are intended to be correctly oriented in a vertical or floor mount position. The prongs are not designed to hold the plug in place if it is plugged into a ceiling, under-table or cabinet outlet.
- For pluggable equipment, the socket-outlet shall be installed near the equipment and shall be easily accessible.
- Unplug this product from the wall outlet before cleaning. Do not use liquid or aerosol cleaners. Use a damp cloth for cleaning.
- Do not modify the power adapters or replace with other adapters, as this causes a hazardous situation.
- Do not allow anything to rest on the power cords. Do not install this product where the cords may be walked on or crimped.
- This product should be operated only from the type of power source indicated on the marking label. If you are not sure of the type of power supply in your home, consult your dealer or electricity supply provider.
- Do not overload wall outlets or use an extension cord.
- Do not place this product on an unstable table, shelf, stand or other unstable surfaces.
- This product should not be placed in any area where proper ventilation is not provided. Slots and openings in the back or bottom of this product are provided for ventilation. To protect them from overheating, these openings must not be blocked by placing the product on a soft surface such as a bed, sofa or rug. This product should never be placed near or over a radiator or heat source.
- Never push objects of any kind into this product through the slots because they may touch dangerous voltage points or create a short circuit. Never spill liquid of any kind on the product.

- To reduce the risk of electric shock, do not disassemble this product, but take it to an authorized service facility. Opening or removing parts of the product other than specified access doors may expose you to dangerous voltages or other risks. Incorrect reassembling can cause electric shock when the product is subsequently used.
- You should test the sound reception every time you turn on the units or move one of the components.
- Periodically examine all components for damage.
- There is a very low risk of privacy loss when using certain electronic devices, such as baby monitors, cordless telephones, etc. **To protect your privacy, make sure the product has never been used before purchase, reset the baby monitor periodically by powering off and then powering on the units, and power off the baby monitor if you will not use it for some time.**
- The small parts of this monitor can be swallowed by babies or small children. Keep these parts out of reach of children.
- Children should be supervised to ensure that they do not play with the product.
- The product is not intended for use by persons (including children) with reduced physical, sensory or mental capabilities, or lack of experience and knowledge, unless they have been given supervision or instruction concerning use of the appliance by a person responsible for their safety.

SAVE THESE INSTRUCTIONS

- Use and store the product at a temperature between 32°F (0°C) and 104°F (40°C).
- Do not expose the product to extreme cold, heat or direct sunlight. Do not put the product close to a heating source.
- Batteries should not be exposed to excessive heat such as bright sunshine or fire.
- Mishandling batteries can cause burn, fire or explosion hazards.
- Warning—Strangulation Hazard—Children have STRANGLED in cords. Keep this cord out of the reach of children (more than 3 ft (0.9m) away). Do not remove warning label on the adapter cord.
- Never place the Baby Unit(s) inside the baby's crib or playpen. Never cover the Baby Unit(s) or Parent Unit with anything such as a towel or a blanket.
- Other electronic products may cause interference with your baby monitor. Try installing your baby monitor as far away from these electronic devices as possible: wireless routers, radios, cellular telephones, intercoms, room monitors, televisions, personal computers, kitchen appliances and cordless telephones.

Precautions for users of implanted cardiac pacemakers
Cardiac pacemakers (applies only to digital cordless devices): Wireless Technology Research, LLC (WTR), an independent research entity, led a multidisciplinary evaluation of the interference between portable wireless devices and implanted cardiac pacemakers. Supported by the U.S. Food and Drug Administration, WTR recommends to physicians that:

- Pacemaker patients**
- Should keep wireless devices at least six inches from the pacemaker.
 - Should NOT place wireless devices directly over the pacemaker, such as in a breast pocket, when it is turned ON. WTR's evaluation did not identify any risk to bystanders with pacemakers from other persons using wireless devices.

Electromagnetic fields (EMF)
This LeapFrog product complies with all standards regarding electromagnetic fields (EMF). If handled properly and according to the instructions in this user's manual, the product is safe to be used based on scientific evidence available today.

What's Included

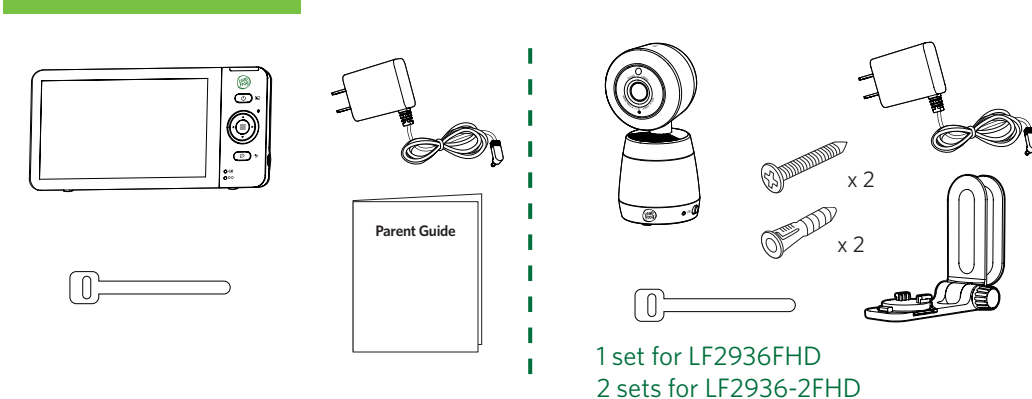

1 set for LF2936FHD
2 sets for LF2936-2FHD

Download LeapFrog Baby Care+ App

Start monitoring from anywhere.

Scan the QR code to download the free LeapFrog Baby Care+ mobile app, or search "LeapFrog Baby Care+" on Apple App Store or Google Play Store.

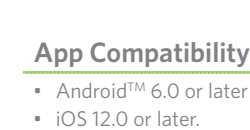

App Compatibility

- Android™ 6.0 or later
- iOS 12.0 or later.

Connect, Charge, and Power On the Baby Monitor

1. Connect the Baby Monitor

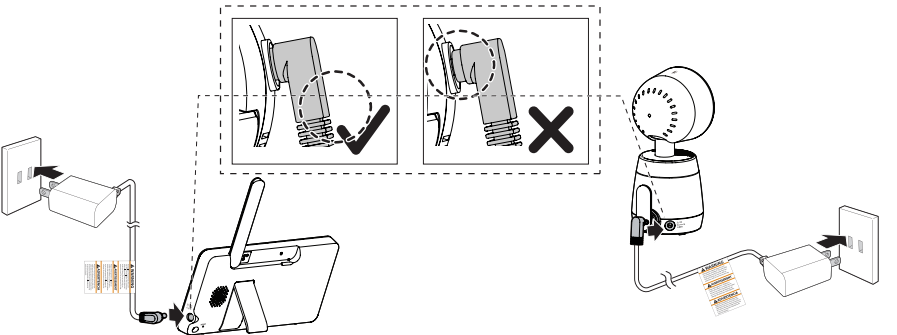

2. Charge the Parent Unit Battery

Notes:

- Before using the baby monitor for the first time, charge the Parent Unit battery for 12 hours. When the Parent Unit battery is fully charged, the battery icon becomes solid .
- The standby time varies depending on your actual usage time and the age of the battery.

The battery icon on the screen indicates the battery status:

Battery Indicators	Battery Status	Action
alert displays on the parent unit screen, and the battery icon becomes empty with the LED light flashes.	The battery has very little charge and may only be used for a short time.	Charge without interruption (about 30 minutes).
The battery icon becomes solid .	The battery is fully charged.	To keep the battery charged, connect it to AC power when in use.

3. Power On or Off the Baby Monitor

- Slide the On/Off switch to **ON** to power on your Baby Unit.
- The Parent Unit turns on automatically after connecting to the power socket, and the welcome screen appears. The green LINK LED light flashes. You can **press and hold** Power to turn it on or off.



Note:
• POWER LED Light is OFF by default.

4. Status Check

Once your Baby Unit and Parent Unit are powered on and connected, your Parent Unit displays video from the Baby Unit, and the LINK LED lights steadily.

5. Positioning the Baby Monitor

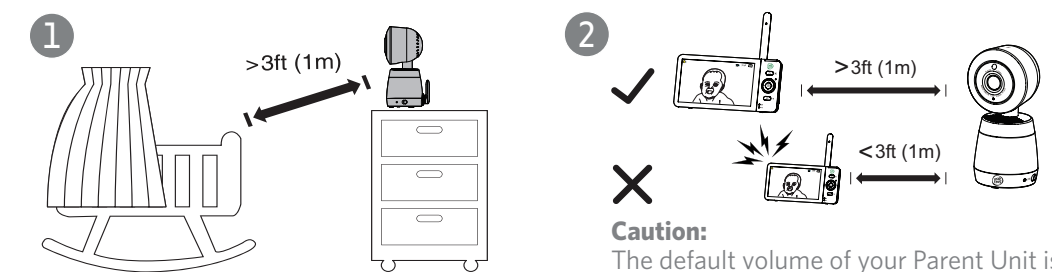

Caution:
The default volume of your Parent Unit is level 3, and the maximum volume is level 5. If you experience a feedback noise from your baby monitor while positioning:
- Make sure your Baby Unit and Parent Unit are more than 3 feet (1 meter) apart, **OR**
- Lower the volume of your Parent Unit.

Note:

To avoid interference from other electronic devices, place your baby monitor at least 3 feet (1 meter) away from devices such as wireless routers, microwaves, mobile phones and computers.

Cable Management

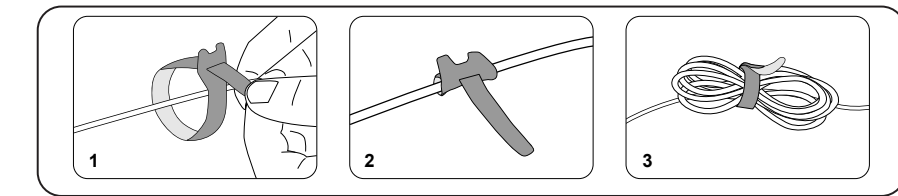

Overview

Parent Unit

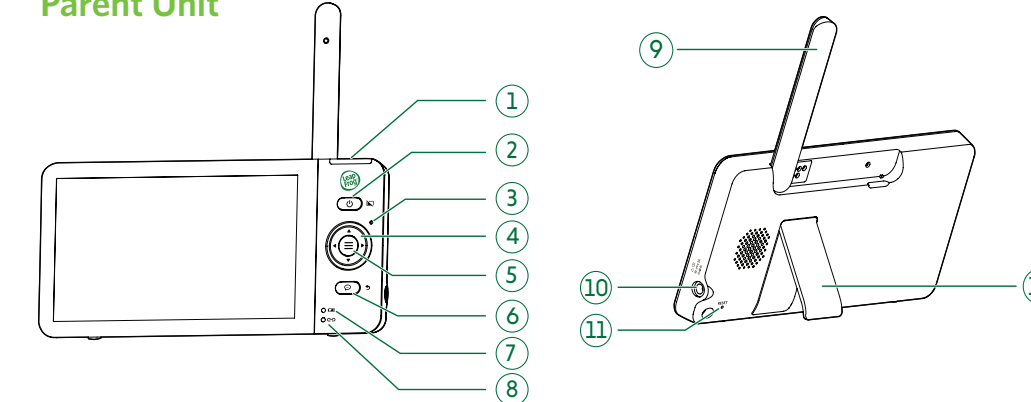

- 3-level sound indicator
- Power / LCD Off
- Microphone
- Arrow Keys
- Menu / Select
- Talk / Return
- Battery LED indicator
- Link LED indicator
- Antenna
- Power jack
- RESET
- Stand

Baby Unit

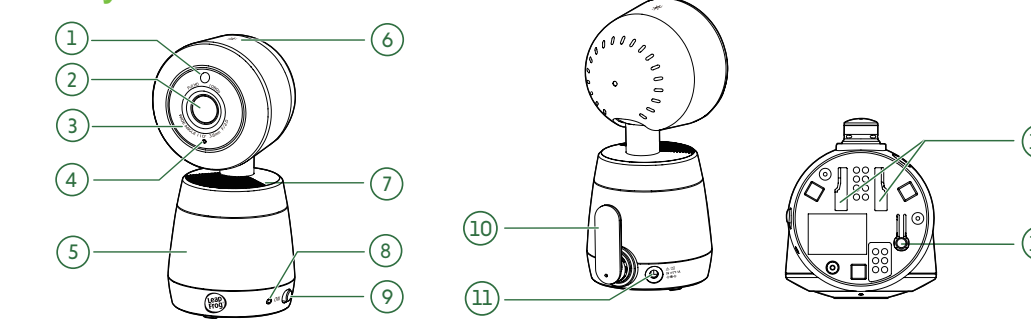

- Light sensor
 - Camera
 - Infrared LEDs
 - Microphone
 - Night light
 - Night light control key
 - POWER LED Light
 - On / Off switch
 - Speaker
 - Antenna
 - Power jack
 - Wall mount holes
 - PAIR key
- Press to turn the night light on or off.
 - Press and hold to adjust night light brightness level.
 - The Parent Unit and Baby Unit(s) provided are already paired.



Intertek
3177099

Parent Unit Icons

Overlay Control Panel

1 **Monitoring mode (For LF2936-2FHD only)**

- View Baby Units in Single mode.

2

- View Baby Units in Split screen.
- View Baby Units in Patrol mode.

≡ **Main Menu**

Temporary Night Light

- Turn on/off 30s night light.
- Select black-and-white or color night light.
- Adjust night light brightness.

Zoom

- Tap/Press/Press and hold the arrow icons/keys to pan or tilt the camera.

Pan and Tilt

- Tap/Press/Press and hold the arrow icons/keys to pan or tilt the camera.

Main Menu Icons

Monitoring mode (For LF2936-2FHD only)

- View Baby Units in Single mode.
- View Baby Units in Split screen.
- View Baby Units in Patrol mode.

- Turn on or turn off night light.
- Select a night light color.

- Adjust brightness.
- Set a Timer to turn the night light off.

Lullaby

- Play/Stop lullaby.
- Select to play all melodies, or play one of the 5 melodies and 5 soothing sounds.
- Set a Timer to stop the lullaby.
- Adjust the play volume level.

General settings

- Configure Wi-Fi
- Connect Mobile Phone
- Select Connection Mode
- Connection Status
- Video on Mobile App Connection

- Adjust parent unit screen brightness.
- Turn on/off Dim Mode.

- Set the Temperature display format.
- Set screen off timer.
- Set the Sound Sensitivity Level to activate the screen.
- Set screen lock timer.

- Adjust the Baby Unit speaker volume.

- Select the display language on parent unit.
- Reset settings.
- Software update.

- Adjust brightness.
- Set a Timer to turn the night light off.

Alert settings

- Mute or adjust alerts volume level.
- Turn on/off Temperature Alert.
- Select the minimum and maximum Temperature range.
- Adjust motion sensitivity level;
- Turn on/off motion detection alert.

- Turn on/off low battery alert.
- Turn on/off no link alert.

Help and info

- Customer support
- Privacy information
- Support information
- System information

Alert icons

- The parent unit's battery is low and needs charging.
- The parent unit is connected to AC power.
- Displays when motion exceeding the set sensitivity level is detected at a baby unit.
- Displays when baby unit detected temperature reaches or exceeds the set maximum.
- Displays when baby unit detected temperature at or lower than the set minimum.

Status icon

Direct mode

Parent unit, baby unit 1 and baby unit 2 (For LF2936-2FHD Only) are connected to each others directly.

Wi-Fi Router mode

Parent unit, baby unit 1 and baby unit 2 (For LF2936-2FHD only) are connected to home Wi-Fi network.

Baby unit 1 and 2 are being viewed in **Patrol mode (For LF2936-2FHD only)**.

Baby unit 1 and 2 are being viewed in **Split mode (For LF2936-2FHD only)**.

Touch screen is locked.

B/W night vision is turned on.

Color night vision is turned on.

Motion detection alert is turned on.

Melodies and soothing sounds are playing.

Night light is turned on.

Auto night light brightness is activated.

Parent unit is muted.

Temperature alert is turned on.

Humidity

Temperature

Low battery indicator.

Battery level indicator

Three Ways to Connect Your Baby Monitor

Direct mode

The Parent Unit and the Baby Unit are pre-paired and can connect to each other directly in **Direct mode** by default, which allows you to stream live video right out of the box. **It is NOT recommended to continue using Direct Mode connection after initial installation.**

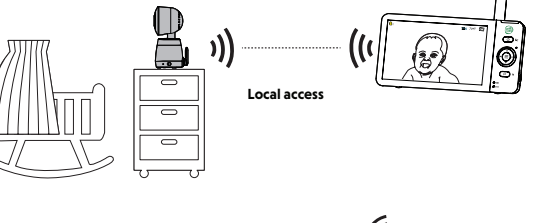

Wi-Fi Router mode

You are required to set up your monitor in **Router mode**. **Router mode** uses your home Wi-Fi network to connect your baby monitor system. It enhances your local access by extending connection range.

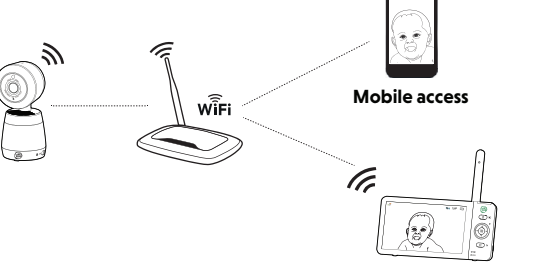

Auto mode

Auto mode should only be used when your Wi-Fi router is periodically turned off or the Wi-Fi connection is unstable. It works by automatically selecting the connection mode (**Direct** or **Router**) when connecting to the baby unit(s). For routers turned on with good Wi-Fi connectivity, **Router mode** is the best selection. Mobile app access will not be interrupted in **Auto mode**.

Test the Location

If you plan to install your Baby Unit to a designated location, and will use your home Wi-Fi network to connect your video monitor, test whether your selected monitoring areas have good Wi-Fi signal strength.

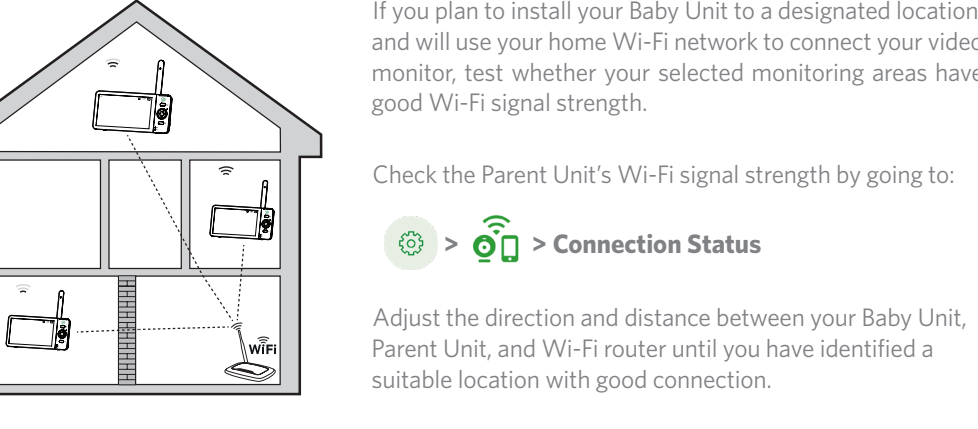

Protect Your Privacy and Online Security

LeapFrog cares about your privacy and peace of mind. That's why we've put together a list of industry-recommended best practices to help keep your wireless connection private and your devices protected when online.

- Ensure your wireless connection is secure
 - Before installing a device, ensure your router's wireless signal is encrypted by selecting the "WPA2-PSK with AES" setting in your router's wireless security menu.

Change default settings

- Change your wireless router's default wireless network name (SSID) to something unique.
- Change default passwords to unique, strong passwords. A strong password:
 - Is at least 10 characters long.
 - Does not contain dictionary words or personal information.
 - Contains a mix of uppercase letters, lowercase letters, special characters and numbers.

Keep your devices up to date

- Download security patches from manufacturers as soon as they become available. This will ensure you always have the latest security updates.

Pan and Tilt the Camera

You can swipe on the screen, use the arrow keys or the control panel on the parent unit to pan and tilt the camera.

Touch the screen to launch the overlay control panel, then tap 

- Tap the icons  to move the camera upward, downward, leftward and rightward, or press and hold the icons to move continuously.

OR

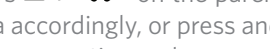
- Press the arrow keys  on the parent unit to move the camera accordingly, or press and hold the arrow keys to move continuously.

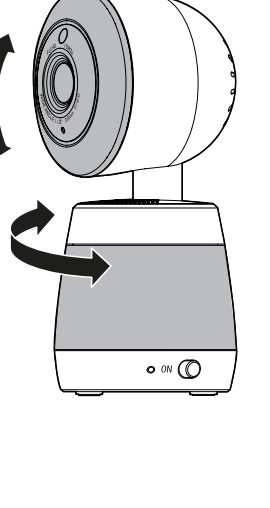

The RBRC seal



The RBRC seal on the Li-Ion battery indicates that VTeCh Communications, Inc. is voluntarily participating in an industry program to collect and recycle these batteries at the end of their useful lives, when taken out of service within the United States and Canada. The program provides a convenient alternative to placing used Li-ion batteries into the trash or municipal waste, which may be illegal in your area. VTeCh's participation makes it easy for you to drop off the spent battery at local retailers participating in the program or at authorized VTeCh product service centers. Please call 1 (800) 8 BATTERY for information on participating and disposal bans/restrictions in your area. VTeCh's involvement in this program is part of its commitment to protecting our environment and conserving natural resources. The RBRC Seal and 1 (800) 8 BATTERY are registered trademarks of Call2Recycle, Inc.

This Class B digital apparatus complies with Canadian requirement: CAN ICES-3 (B)/NMB-3(B)

This device contains licence-exempt transmitter(s)/receiver(s) that comply with Innovation, Science and Economic Development Canada's licence-exempt RSS(s). Operation is subject to the following two conditions: (1) This device may not cause interference. (2) This device must accept any interference, including interference that may cause undesired operation of the device.

The term "IC" before the certification/registration number only signifies that the Industry Canada technical specifications were met.

This product meets the applicable Innovation, Science and Economic Development Canada technical specifications.

The product complies with FCC RF radiation exposure limits set forth for an uncontrolled environment. The Baby Unit should be installed with respect to Baby Units, the CEC battery charging testing mode is activated while it is powered off and charging.

California Energy Commission battery charging testing mode

This baby monitor meets the California Energy Commission (CEC) regulations for energy consumption. Your baby monitor is set up to comply with the energy-conserving standards right out of the box. Follow the instructions to install and charge the battery. The CEC battery charging testing mode is activated while it is powered off and charging.

This equipment complies also with Industry Canada RS-102 with respect to Baby Units, the CEC battery charging testing mode is activated while it is powered off and charging.

For cETL compliance only

Mesures de sécurité importantes

La plaque signalétique appliquée est située au bas du socle de l'unité du bébé.

Lorsque vous utilisez votre appareil, vous devez toujours suivre certaines mesures de précaution de base afin de réduire les risques d'incendie, d'électrocution et de blessures corporelles, dont ceux qui suivent :

- Observez toutes les instructions et mises en garde inscrites sur l'appareil.
- L'installation par un adulte est requise.
- MISE EN GARDE : N'installez pas l'unité du bébé à une hauteur supérieure à 2 mètres.
- Ce produit ne remplace pas la surveillance adulte du nourrisson. La supervision du nourrisson est la responsabilité du parent ou de la personne qui s'occupe de l'enfant. Ce produit pourrait cesser de fonctionner et, par conséquent, vous ne devriez pas présumer qu'il continuera de fonctionner correctement pendant une période de temps donnée.
- De plus, il ne s'agit pas d'un instrument médical et ne devrait pas être utilisé comme tel. Ce produit est destiné à vous aider à superviser votre bébé.
- N'utilisez pas cet appareil près de feu ni de toute autre source d'humidité, par exemple, près d'une baignoire, cuve à lessive, évier de cuisine, dans un sous-sol humide ni près d'une piscine, dans un sous-sol humide ou une douche.
- N'utilisez pas cet appareil à une pression atmosphérique à haute altitude pendant son utilisation, son entreposage ou son transport. Le fait de jeter la pile dans au feu ou dans un four chaud, ou d'écraser ou de briser mécaniquement la pile peut entraîner une explosion. Le fait de laisser la pile dans un environnement à température extrêmement élevée peut entraîner une explosion ou une fuite de liquide ou de gaz inflammable. Mettez au rebut la pile usagée conformément aux informations figurant dans la section **Le socle RBRC**.
- MISE EN GARDE :** Utilisez que la pile fournie. Il peut y avoir un risque d'explosion si un mauvais type de pile est utilisé pour le dispositif apparié. La pile ne peut pas être soumise à des températures extrêmes (chaud ou basées) et à une faible pression atmosphérique à haute altitude pendant son utilisation, son entreposage ou son transport. Le fait de jeter la pile dans un feu ou dans un four chaud, ou d'écraser ou de briser mécaniquement la pile peut entraîner une explosion. Le fait de laisser la pile dans un environnement à température extrêmement élevée peut entraîner une explosion ou une fuite de liquide ou de gaz inflammable. Mettez au rebut la pile usagée conformément aux informations figurant dans la section **Le socle RBRC**.

CONSERVEZ CES INSTRUCTIONS

- Utilisez et entreposez le produit à une température entre 0° C (32° F) et 40° C (104° F).
- N'exposez pas cet appareil à des froids ou des chaleurs extrêmes, ainsi qu'à la lumière directe du soleil. Ne l'installez pas près d'une source de chauffage.
- Le bloc-piles ne doit pas être exposé à la chaleur excessive telle que la lumière du soleil ou au feu.
- Risque de brûlure, risque d'incendie, risque d'explosion associé à une mauvaise manipulation de ses piles.
- Avertissement - Risque de strangulation - Les enfants se sont ÉTRANGLES dans des cordons.** Gardez ce cordon hors de portée des enfants (à plus de 0,9 m). N'enlevez pas cette étiquette.
- N'exposez pas le produit à des températures extrêmes, telles que les radiateurs, sans fil, radios, téléphones cellulaires, interphones, moniteurs, téléphones, ordinateurs personnels, stimulateurs cardiaques implantés dans l'organisme.
- N'utilisez pas cet appareil à une température extrême (chaud ou basées) et à une faible pression atmosphérique à haute altitude pendant son utilisation, son entreposage ou son transport. Le fait de jeter la pile dans un feu ou dans un four chaud, ou d'écraser ou de briser mécaniquement la pile peut entraîner une explosion. Le fait de laisser la pile dans un environnement à température extrêmement élevée peut entraîner une explosion ou une fuite de liquide ou de gaz inflammable. Mettez au rebut la pile usagée conformément aux informations figurant dans la section **Le socle RBRC**.

FCC and IC regulations

FCC Part 15

This equipment has been tested and found to comply with the requirements for a Class B digital device under Part 15 of the Federal Communications Commission (FCC) rules. These requirements are intended to provide reasonable protection against harmful interference in a residential installation. This equipment generates, uses and can radiate radio frequency energy and, if not installed and used in accordance with the instructions, may cause harmful interference to radio communications. However, there is no guarantee that interference will not occur in a particular installation. If this equipment does cause harmful interference to radio or television reception, which can be determined by turning the equipment off and on, the user is encouraged to try to correct the interference by one or more of the following measures:

- Reorient or relocate the receiving antenna.
- Increase the separation between the equipment and receiver.
- Connect the equipment into an outlet on a circuit different from that to which the receiver is connected.
- Consult the dealer or an experienced radio/TV technician for help.

WARNINGS: Changes or modifications to this equipment not expressly approved by the party responsible for compliance could void the user's authority to operate the equipment.

Online Manual



Find the answer to your question on our knowledge-rich Online Manual. Get assisted at your own pace and learn what your monitor is capable of.

 **Scan the QR code to access the Online Manual or visit leapfrog.com/support.**

 Full Manual
Comprehensive help articles on product set up, operations, Wi-Fi and settings.

 Video Tutorials
Walk-throughs on features and installation such as mounting the Baby Unit on the wall.

 FAQs & Troubleshooting
Answers to the most commonly asked questions, including troubleshooting solutions.

Customer Support

Visit our Consumer Support website 24 hours a day at: **United States:** leapfrog.com/support **Canada:** leapfrog.ca/support

Call our Customer Service number from Monday to Friday 9am - 6pm Central Time: **United States & Canada:** (800) 717-6031

Please visit our website at leapfrog.com for full details of the warranty provided in your country.

Technical Specifications

Technology	Wi-Fi 2.4GHz 802.11 b/g/n
Channels	1-11 (2412-2462 MHz)
Internet connection	Minimum Requirement: 1.5 Mbps @ 720p or 2.5 Mbps @1080p upload bandwidth per Baby Unit
LCD	5.5" Color LCD (IPS 1920x1080 pixels)
Nominal effective range	Maximum power allowed by FCC and IC. Actual operating range may vary according to environmental conditions at the time of use.
Power requirements	Parent Unit: 3.7V 5000mAh Lithium-ion battery Baby Unit power adapter: Output: 5V DC @ 1A Parent Unit power adapter: Output: 5V DC @ 2A

Credits:
The Background Noise sound file was created by Caroline Ford, and is used under the Creative Commons License.
The Stream Noise sound file was created by Caroline Ford, and is used under the Creative Commons License.
The Night sound file was created by Mike Koenig, and is used under the Creative Commons License.
The Hicorl Beat sound file was created by Zarahadeu, and is used under the Creative Commons License.
Android™ and Google Play™ are trademarks of Google Inc.
App Store is a trademark of Apple Inc., registered in the U.S. and other countries.
iOS is a trademark or registered trademark of Cisco in the U.S. and other countries and is used under license.



Specifications are subject to change without notice.
© 2022 LeapFrog Enterprises, Inc.
a subsidiary of VTeCh Holdings Limited.
All rights reserved. 10/22. LF2936-XFHD_QSG_V1

