

■ PARENT UNIT ICONS (CONT'D)

Status icons

- Connection status**
- Tail** - Strong signal strength.
 - T** - Moderate signal strength.
 - T** - Low signal strength.
 - T** - Weak signal strength.

- Split mode**
(For pairing with VM924-2 only)
- Patrol mode**
(For pairing with VM924-2 only)

- Current view status**
- The baby unit number that is being viewed when it:

- Single CAM mode.**
- Patrol mode.** (For pairing with VM924-2 only)
- Split mode.** (For pairing with VM924-2 only)

- Night vision - On**
- Zoom - On**

- Lullaby - On**
- °F or °C**

- Real-time temperature**
- Real-time temperature detected by the baby unit in Fahrenheit (F) or Celsius (C) (e.g. 37.0 or 14.0 C)

- Temperature alert tone - On**
- Talkback - On**

Status icons

- Mute alert**
- Displays when the parent unit speaker volume is set to off.
 - Displays when the parent unit is talking to the baby unit.

- Battery status**
- Animates when the battery is charging.
 - Battery is fully charged.
 - Battery is low and needs charging.

- VOX Sensitivity Level**
- | Level 5 (Highest) | Level 4 (High) | Level 3 (Medium) | Level 2 (Low) | Level 1 (Lowest) |
|-------------------|----------------|------------------|---------------|------------------|
| | | | | |

- DOCKING** (Default setting)
- The parent unit screen and speaker turn on for very small sounds, including background noise from your baby's room.
 - The parent unit screen and speaker turn on for soft babbling and louder sounds from your baby.
 - The parent unit remains quiet when your baby sleeps soundly.
 - The parent unit screen and speaker turn on for loud crying or loud crying and recording sounds from your baby.
 - The parent unit remains quiet when your baby makes soft sounds.
 - The parent unit screen and speaker turn on for loud crying or loud crying and recording sounds from your baby.
 - The parent unit remains quiet when your baby makes soft sounds.

- Sound activated screen and audio**

- When **Sound activation** is on, the parent unit screen stays off to give power when the baby unit detects no sound.

- Once the baby unit detects sounds that are louder than the chosen sound sensitivity level, the parent unit screen and speaker turn on automatically. The parent unit will then turn off again after 50 seconds of no sound detection.

- NOTE**
- If you have muted the parent unit speaker, only the parent unit screen will turn on when a sound is detected.

- NOTE**
- If you have muted the parent unit speaker, only the parent unit screen will turn on when a sound is detected.

- NOTE**
- If you have muted the parent unit speaker, only the parent unit screen will turn on when a sound is detected.

- NOTE**
- If you have muted the parent unit speaker, only the parent unit screen will turn on when a sound is detected.

- NOTE**
- If you have muted the parent unit speaker, only the parent unit screen will turn on when a sound is detected.

- NOTE**
- If you have muted the parent unit speaker, only the parent unit screen will turn on when a sound is detected.

- NOTE**
- If you have muted the parent unit speaker, only the parent unit screen will turn on when a sound is detected.

■ SOUND SENSITIVITY AND SOUND ACTIVATION

Adjust sound detection sensitivity

You can turn on **Sound activation** and adjust the **VOX sensitivity** to detect sounds and turn on the parent unit when its screen is switched off or dimmed. When the baby unit detects sounds that exceed certain levels, the parent unit screen will turn on and the baby unit starts transmitting the sounds to the parent unit, and you can see and hear your baby.

If you turn off **Sound activation**, you will hear sounds from the baby unit all the time, even when the battery is charged.

If you have turned on sound alert, the parent unit beeps when the baby unit detects sounds while in **Split mode** (For pairing with VM924-2 only).

VOX Sensitivity Level	Level 5 (Highest)	Level 4 (High)	Level 3 (Medium)	Level 2 (Low)	Level 1 (Lowest)

- DOCKING** (Default setting)
- The parent unit screen and speaker turn on for very small sounds, including background noise from your baby's room.
 - The parent unit screen and speaker turn on for soft babbling and louder sounds from your baby.
 - The parent unit remains quiet when your baby sleeps soundly.
 - The parent unit screen and speaker turn on for loud crying or loud crying and recording sounds from your baby.
 - The parent unit remains quiet when your baby makes soft sounds.
 - The parent unit screen and speaker turn on for loud crying or loud crying and recording sounds from your baby.
 - The parent unit remains quiet when your baby makes soft sounds.

- Sound activated screen and audio**

- When **Sound activation** is on, the parent unit screen stays off to give power when the baby unit detects no sound.

- Once the baby unit detects sounds that are louder than the chosen sound sensitivity level, the parent unit screen and speaker turn on automatically. The parent unit will then turn off again after 50 seconds of no sound detection.

- NOTE**
- If you have muted the parent unit speaker, only the parent unit screen will turn on when a sound is detected.

- NOTE**
- If you have muted the parent unit speaker, only the parent unit screen will turn on when a sound is detected.

- NOTE**
- If you have muted the parent unit speaker, only the parent unit screen will turn on when a sound is detected.

- NOTE**
- If you have muted the parent unit speaker, only the parent unit screen will turn on when a sound is detected.

- NOTE**
- If you have muted the parent unit speaker, only the parent unit screen will turn on when a sound is detected.

- NOTE**
- If you have muted the parent unit speaker, only the parent unit screen will turn on when a sound is detected.

- NOTE**
- If you have muted the parent unit speaker, only the parent unit screen will turn on when a sound is detected.

■ DIM MODE

The parent unit display will dim to conserve energy after 10 minutes of inactivity, in which there is neither key pressed nor alert received from the baby unit.

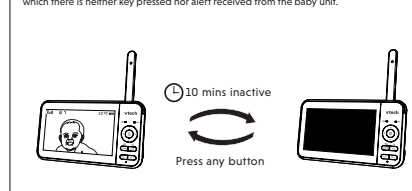

■ NIGHT VISION

The baby unit has infrared LEDs that allow you to see your baby clearly at night or in a dark room. When the baby unit being viewed detects low light levels, the infrared LEDs are switched on automatically. The images from the baby unit are in black and white, and appears on the screen.

NOTES

- It is normal to see a short white glare on your parent unit screen as the baby unit is adapting to the dark environment.
- When the infrared LEDs are the images are in black and white. This is normal.
- Depending on the surroundings and other interfering factors, like lighting, objects, colors and backgrounds, the display resolution may vary. Adjust the baby unit's angle or place the baby unit at a higher level to prevent glare and blurry display.

TIP

- Depending on the surroundings and other interfering factors, like lighting, objects, colors and backgrounds, the display resolution may vary. Adjust the baby unit's angle or place the baby unit at a higher level to prevent glare and blurry display.

■ FOR VM924-2 ONLY

Status check - Two baby units

If you are viewing baby unit 1, the **POWER LED** light of baby unit 1 turns on. As baby unit 2 is not being viewed, its **POWER LED** light flashes.



- NOTE**
- If you power on only one baby unit, your parent unit may display 1 and the LINK LED light will flash.

Change different views - Single CAM

To switch between the image of baby units 1 and 2:

- Press **MONITORING** menu.
- Select the baby unit you would like to view.

Change different views - Patrol

Select **Patrol** as your monitoring mode to alternately view the image from baby units 1 and 2 every 10 seconds.

Change different views - Split

Select **Split** as your monitoring mode to view the images from both baby units at once.

- Press **MONITORING** menu.
- Select the baby unit you would like to view.

- Press **MONITORING** menu.
- Select the baby unit you would like to view.

- Press **MONITORING** menu.
- Select the baby unit you would like to view.

■ FREQUENTLY ASKED QUESTIONS

Below are the questions most frequently asked about the baby monitor.

- Why does the baby monitor not respond normally?**
- Try the following (in the order listed) for common cure:
 - Disconnect the power to the baby units and the parent unit.
 - Wait a few seconds before connecting power back to the baby units and the parent unit.
 - Turn on the baby units and the parent unit.
 - Wait for the parent unit to synchronize with the baby units. Allow up to one minute for this to take place.

- Why doesn't my parent unit charge while connected to AC power?**
- Perhaps the parent unit is not connected to the power. Insert the appliance plug into the parent unit and put the adapter in a wall socket. Then, **press and hold POWER** to switch on the parent unit and to establish connection with the baby unit.

- Why is my screen in black and white?**
- Perhaps the baby unit is not connected to the power. Insert the appliance plug into the baby unit and put the adapter in a wall socket. Then, slide the **ON/OFF** switch to **ON** to switch on the baby unit and to establish connection with the parent unit.

- Why doesn't my parent unit charge while connected to AC power?**
- You may have used the battery for a long time. See **Warranty for repair/replacement.**

- Why is my screen in black and white?**
- The screen is in black and white during night-time or in a dark room when the night vision feature is activated. This is normal.

- Why is my screen blurry during night-time or in a dark room?**
- During night-time or in a dark room, the surroundings and other interfering factors, like lighting, objects, colors and backgrounds may affect the image quality on your parent unit screen. Adjust the baby unit's angle or place the baby unit at a higher level to prevent glare and blurry display.

- Why does the parent unit beep?**
- The parent unit and baby units may be too close to each other.
- Move the parent unit away from the baby units until the noise stops. OR
 - Turn down the volume of your parent unit.

- Why does the parent unit beep?**
- The baby units may be out of range. Move the parent unit closer to the baby units (but not less than 3 feet).

- Why does the parent unit beep?**
- The parent unit may not have enough charge for the parent unit to perform normally. Charge the battery in the parent unit until the battery icon becomes solid.

- Why does the parent unit beep?**
- The temperature of your baby's room may be too high or too low.

- Why does the parent unit beep?**
- The baby unit also picks up other sounds than those of your baby. Adjust the **VOX sensitivity level** to a lower level or lower the parent unit speaker volume.

- Why don't I hear a sound when I hear my baby cry?**
- The parent unit speaker volume may be too low. See **Adjust parent unit speaker volume** to increase the volume.

- Why can't I establish a connection? Why are there sound interruptions?**
- You may have set a low **VOX sensitivity level**. See **Adjust the sound sensitivity of the baby unit** to set to a higher level.

- Why can't I establish a connection? Why are there sound interruptions?**
- The baby units may be out of range. Move the parent unit closer to the baby units (but not less than 3 feet).

- Why can't I establish a connection? Why are there sound interruptions?**
- Other electronic products and wireless products may cause interference with your baby monitor. Try installing your baby monitor as far away from these devices as possible.

- Why can't I establish a connection? Why are there sound interruptions?**
- If you power on only one baby unit, your parent unit may display 1 and the LINK LED light will flash.

■ THE RBRC SEAL

The RBRC seal on the Li-ion battery indicates that Vtech Communications, Inc. is voluntarily participating in an industry program to collect and recycle these batteries at the end of their useful lives, when taken out of the product.

The program provides a convenient alternative to placing used Li-ion batteries into the trash or municipal waste, which may be illegal in your area.

Vtech's participation makes it easy for you to drop off the spent battery at Li-ion retailers participating in the program or at authorized Vtech product service centers. Please call **(800) 8 BATTERY** for information on Li-ion battery recycling and disposal laws/restrictions in your area. Vtech's involvement in this program is part of our commitment to protecting our environment and conserving natural resources.

FCC and (800) 8 BATTERY are registered trademarks of Callzebyre, Inc.

■ FCC AND IC REGULATIONS

FCC Part 15

The equipment has been tested and found to comply with the requirements for a Class B digital device under Part 15 of the Federal Communications Commission (FCC) rules. These requirements are intended to provide reasonable protection against harmful interference in a residential installation. The equipment generates, uses and can radiate radio frequency energy and, if not installed and used in accordance with the instructions, may cause harmful interference to radio communications. However, there is no guarantee that interference will not occur in a particular installation. If this equipment does cause harmful interference to radio or television reception, which can be determined by turning the equipment off and on, the user is encouraged to try to correct the interference by one or more of the following measures:

- Reorient or relocate the receiving antenna.
- Increase the separation between the equipment and receiver.
- Connect the equipment to an outlet on a circuit different from that to which the receiver is connected.
- Consult the dealer or an experienced radio/TV technician for help.

WARNING: Changes or modifications to this equipment not expressly approved by the party responsible for compliance could void the user's authority to operate the equipment.

This device complies with Part 15 of the FCC rules. Operation is subject to the following two conditions: (1) this device may not cause harmful interference, and (2) this device must accept any interference received, including interference that may cause undesired operation.

This Class B digital apparatus complies with Canadian requirements.

Industry Canada

This device complies (except transmitter/receiver) that comply with Innovation, Science and Economic Development Canada's licence-exempt RSSI (receiving) that comply with the following two conditions: (1) this device may not cause interference, and (2) this device must accept any interference received, including interference that may cause undesired operation of the device.

The term "IC" before the certification/registration number only signifies that the Industry Canada technical specifications were met.

This product meets the applicable Innovation, Science and Economic Development Canada technical specifications.

RF Radiation Exposure Statement

The product complies with FCC RF radiation exposure limits set forth for an uncontrolled environment. The baby unit should be used in accordance with the following instructions: (1) Use only the accessories that are approved for use with the product. (2) Do not use the product for extended periods of time. (3) Do not use the product near your face or body. (4) Do not use the product near your head. (5) Do not use the product near your chest. (6) Do not use the product near your hands. (7) Do not use the product near your feet. (8) Do not use the product near your arms. (9) Do not use the product near your legs. (10) Do not use the product near your neck. (11) Do not use the product near your torso. (12) Do not use the product near your back. (13) Do not use the product near your stomach. (14) Do not use the product near your buttocks. (15) Do not use the product near your groin. (16) Do not use the product near your feet. (17) Do not use the product near your hands. (18) Do not use the product near your feet. (19) Do not use the product near your hands. (20) Do not use the product near your feet. (21) Do not use the product near your hands. (22) Do not use the product near your feet. (23) Do not use the product near your hands. (24) Do not use the product near your feet. (25) Do not use the product near your hands. (26) Do not use the product near your feet. (27) Do not use the product near your hands. (28) Do not use the product near your feet. (29) Do not use the product near your hands. (30) Do not use the product near your feet. (31) Do not use the product near your hands. (32) Do not use the product near your feet. (33) Do not use the product near your hands. (34) Do not use the product near your feet. (35) Do not use the product near your hands. (36) Do not use the product near your feet. (37) Do not use the product near your hands. (38) Do not use the product near your feet. (39) Do not use the product near your hands. (40) Do not use the product near your feet. (41) Do not use the product near your hands. (42) Do not use the product near your feet. (43) Do not use the product near your hands. (44) Do not use the product near your feet. (45) Do not use the product near your hands. (46) Do not use the product near your feet. (47) Do not use the product near your hands. (48) Do not use the product near your feet. (49) Do not use the product near your hands. (50) Do not use the product near your feet. (51) Do not use the product near your hands. (52) Do not use the product near your feet. (53) Do not use the product near your hands. (54) Do not use the product near your feet. (55) Do not use the product near your hands. (56) Do not use the product near your feet. (57) Do not use the product near your hands. (58) Do not use the product near your feet. (59) Do not use the product near your hands. (60) Do not use the product near your feet. (61) Do not use the product near your hands. (62) Do not use the product near your feet. (63) Do not use the product near your hands. (64) Do not use the product near your feet. (65) Do not use the product near your hands. (66) Do not use the product near your feet. (67) Do not use the product near your hands. (68) Do not use the product near your feet. (69) Do not use the product near your hands. (70) Do not use the product near your feet. (71) Do not use the product near your hands. (72) Do not use the product near your feet. (73) Do not use the product near your hands. (74) Do not use the product near your feet. (75) Do not use the product near your hands. (76) Do not use the product near your feet. (77) Do not use the product near your hands. (78) Do not use the product near your feet. (79) Do not use the product near your hands. (80) Do not use the product near your feet. (81) Do not use the product near your hands. (82) Do not use the product near your feet. (83) Do not use the product near your hands. (84) Do not use the product near your feet. (85) Do not use the product near your hands. (86) Do not use the product near your feet. (87) Do not use the product near your hands. (88) Do not use the product near your feet. (89) Do not use the product near your hands. (90) Do not use the product near your feet. (91) Do not use the product near your hands. (92) Do not use the product near your feet. (93) Do not use the product near your hands. (94) Do not use the product near your feet. (95) Do not use the product near your hands. (96) Do not use the product near your feet. (97) Do not use the product near your hands. (98) Do not use the product near your feet. (99) Do not use the product near your hands. (100) Do not use the product near your feet. (101) Do not use the product near your hands. (102) Do not use the product near your feet. (103) Do not use the product near your hands. (104) Do not use the product near your feet. (105) Do not use the product near your hands. (106) Do not use the product near your feet. (107) Do not use the product near your hands. (108) Do not use the product near your feet. (109) Do not use the product near your hands. (110) Do not use the product near your feet. (111) Do not use the product near your hands. (112) Do not use the product near your feet. (113) Do not use the product near your hands. (114) Do not use the product near your feet. (115) Do not use the product near your hands. (116) Do not use the product near your feet. (117) Do not use the product near your hands. (118) Do not use the product near your feet. (119) Do not use the product near your hands. (120) Do not use the product near your feet. (121) Do not use the product near your hands. (122) Do not use the product near your feet. (123) Do not use the product near your hands. (124) Do not use the product near your feet. (125) Do not use the product near your hands. (126) Do not use the product near your feet. (127) Do not use the product near your hands. (128) Do not use the product near your feet. (129) Do not use the product near your hands. (130) Do not use the product near your feet. (131) Do not use the product near your hands. (132) Do not use the product near your feet. (133) Do not use the product near your hands. (134) Do not use the product near your feet. (135) Do not use the product near your hands. (136) Do not use the product near your feet. (137) Do not use the product near your hands. (138) Do not use the product near your feet. (139) Do not use the product near your hands. (140) Do not use the product near your feet. (141) Do not use the product near your hands. (142) Do not use the product near your feet. (143) Do not use the product near your hands. (144) Do not use the product near your feet. (145) Do not use the product near your hands. (146) Do not use the product near your feet. (147) Do not use the product near your hands. (148) Do not use the product near your feet. (149) Do not use the product near your hands. (150) Do not use the product near your feet. (151) Do not use the product near your hands. (152) Do not use the product near your feet. (153) Do not use the product near your hands. (154) Do not use the product near your feet. (155) Do not use the product near your hands. (156) Do not use the product near your feet. (157) Do not use the product near your hands. (158) Do not use the product near your feet. (159) Do not use the product near your hands. (160) Do not use the product near your feet. (161) Do not use the product near your hands. (162) Do not use the product near your feet. (163) Do not use the product near your hands. (164) Do not use the product near your feet. (165) Do not use the product near your hands. (166) Do not use the product near your feet. (167) Do not use the product near your hands. (168) Do not use the product near your feet. (169) Do not use the product near your hands. (170) Do not use the product near your feet. (171) Do not use the product near your hands. (172) Do not use the product near your feet. (173) Do not use the product near your hands. (174) Do not use the product near your feet. (175) Do not use the product near your hands. (176) Do not use the product near your feet. (177) Do not use the product near your hands. (178) Do not use the product near your feet. (179) Do not use the product near your hands. (180) Do not use the product near your feet. (181) Do not use the product near your hands. (182) Do not use the product near your feet. (183) Do not use the product near your hands. (184) Do not use the product near your feet. (185) Do not use the product near your hands. (186) Do not use the product near your feet. (187) Do not use the product near your hands. (188) Do not use the product near your feet. (189) Do not use the product near your hands. (190) Do not use the product near your feet. (191) Do not use the product near your hands. (192) Do not use the product near your feet. (193) Do not use the product near your hands. (194) Do not use the product near your feet. (195) Do not use the product near your hands. (196) Do not use the product near your feet. (197) Do not use the product near your hands. (198) Do not use the product near your feet. (199) Do not use the product near your hands. (200) Do not use the product near your feet. (201) Do not use the product near your hands. (202) Do not use the product near your feet. (203) Do not use the product near your hands. (204) Do not use the product near your feet. (205) Do not use the product near your hands. (206) Do not use the product near your feet. (207) Do not use the product near your hands. (208) Do not use the product near your feet. (209) Do not use the product near your hands. (210) Do not use the product near your feet. (211) Do not use the product near your hands. (212) Do not use the product near your feet. (213) Do not use the product near your hands. (214) Do not use the product near your feet. (215) Do not use the product near your hands. (216) Do not use the product near your feet. (217) Do not use the product near your hands. (218) Do not use the product near your feet. (219) Do not use the product near your hands. (220) Do not use the product near your feet. (221) Do not use the product near your hands. (222) Do not use the product near your feet. (223) Do not use the product near your hands. (224) Do not use the product near your feet. (225) Do not use the product near your hands. (226) Do not use the product near your feet. (227) Do not use the product near your hands. (228) Do not use the product near your feet. (229) Do not use the product near your hands. (230) Do not use the product near your feet. (231) Do not use the product near your hands. (232) Do not use the product near your feet. (233) Do not use the product near your hands. (234) Do not use the product near your feet. (235) Do not use the product near your hands. (236) Do not use the product near your feet. (237) Do not use the product near your hands. (238) Do not use the product near your feet. (239) Do not use the product near your hands. (240) Do not use the product near your feet. (241) Do not use the product near your hands. (242) Do not use the product near your feet. (243) Do not use the product near your hands. (244) Do not use the product near your feet. (245) Do not use the product near your hands. (246) Do not use the product near your feet. (247) Do not use the product near your hands. (248) Do not use the product near your feet. (249) Do not use the product near your hands. (250) Do not use the product near your feet. (251) Do not use the product near your hands. (252) Do not use the product near your feet. (253) Do not use the product near your hands. (254) Do not use the product near your feet. (255) Do not use the product near your hands. (256) Do not use the product near your feet. (257) Do not use the product near your hands. (258) Do not use the product near your feet. (259) Do not use the product near your hands. (260) Do not use the product near your feet. (261) Do not use the product near your hands. (262) Do not use the product near your feet. (263) Do not use the product near your hands. (264) Do not use the product near your feet. (265) Do not use the product near your hands. (266) Do not use the product near your feet. (267) Do not use the product near your hands. (268) Do not use the product near your feet. (269) Do not use the product near your hands. (270) Do not use the product near your feet. (271) Do not use the product near your hands. (272) Do not use the product near your feet. (273) Do not use the product near your hands. (274) Do not use the product near your feet. (275) Do not use the product near your hands. (276) Do not use the product near your feet. (277) Do not use the product near your hands. (278) Do not use the product near your feet. (279) Do not use the product near your hands. (280) Do not use the product near your feet. (281) Do not use the product near your hands. (282) Do not use the product near your feet. (283) Do not use the product near your hands. (284) Do not use the product near your feet. (285) Do not use the product near your hands. (286) Do not use the product near your feet. (287) Do not use the product near your hands. (288) Do not use the product near your feet. (289) Do not use the product near your hands. (290) Do not use the product near your feet. (291) Do not use the product near your hands. (292) Do not use the product near your feet. (293) Do not use the product near your hands. (294) Do not use the product near your feet. (295) Do not use the product near your hands. (296) Do not use the product near your feet. (297) Do not use the product near your hands. (298) Do not use the product near your feet. (299) Do not use the product near your hands. (300) Do not use the product near your feet. (301) Do not use the product near your hands. (302) Do not use the product near your feet. (303) Do not use the product near your hands. (304) Do not use the product near your feet. (305) Do not use the product near your hands. (306) Do not use the product near your feet. (307) Do not use the product near your hands. (308) Do not use the product near your feet. (309) Do not use the product near your hands. (310) Do not use the product near your feet. (311) Do not use the product near your hands. (312) Do not use the product near your feet. (313) Do not use the product near your hands. (314) Do not use the product near your feet. (315) Do not use the product near your hands. (316) Do not use the product near your feet. (317) Do not use the product near your hands. (318) Do not use the product near your feet. (319) Do not use the product near your hands. (320) Do not use the product near your feet. (321) Do not use the product near your hands. (322) Do not use the product near your feet. (323) Do not use the product near your hands. (324) Do not use the product near your feet. (325) Do not use the product near your hands. (326) Do not use the product near your feet. (327) Do not use the product near your hands. (328) Do not use the product near your feet. (329) Do not use the product near your hands. (330) Do not use the product near your feet