



5" WiFi High Definition Video Monitor

LF815HD
LF815-2HD
LF815-OHD



Parent Guide
This guide contains important information. Please keep it for future reference.

Need help?
Visit leapfrog.com/support



Visit our website leapfrog.com for more information about products, downloads, resources and more. Read our complete warranty policy online at leapfrog.com/warranty.

Important Safety Instructions

The applied nameplate is located at the bottom of the Baby Unit's base. When using your equipment, basic safety precautions should always be followed to reduce the risk of fire, electric shock and injury, including the following:

- Follow all warnings and instructions marked on the product.
 - Adult setup is required.
 - CAUTION:** Do not install the Baby Unit at a height above 2 meters.
 - This product is not a substitute for adult supervision of the infant. Supervising the infant is the parent's or caregiver's responsibility. This product could cease operating, and therefore you should not assume it will continue working properly for any given period of time. Further, this is not a medical device and should not be used as such. This product is intended to assist you in supervising your baby.
 - Do not use this product near water. For example, do not use it next to a bath tub, wash bowl, kitchen sink, laundry tub or swimming pool, or in a wet basement or shower.
 - CAUTION:** Use only the battery provided. There may be a risk of explosion if a wrong type of battery is used for the Parent Viewer. The battery cannot be subjected to high or low extreme temperature and low air pressure at high altitude during use, storage or transportation. Disposal of battery into fire or a hot oven, or mechanically crushing or cutting or the battery can result in an explosion. Leaving the battery in an extremely high temperature surrounding environment can result in an explosion or the leakage of flammable liquid or gas. Battery subjected to extremely low air pressure may result in an explosion or the leakage of flammable liquid or gas. Dispose of used battery according to the information in **The RBRC seal**.
 - Use only the adapters included with this product. Incorrect adapter polarity or voltage can seriously damage the product.
- Power adapter information:**
Baby Unit output: Output: 5V DC 1A; V-Tech Telecommunications Ltd.; Model: VT05EU50S100
Parent Viewer output: Output: 5V DC 2A; V-Tech Telecommunications Ltd.; Model: VT07EU50S200
- Rechargeable battery information:**
Zhuhai Great Power Energy Co., Ltd.; Lithium battery, 3.7V 5000mAh; Model: GSP806090-5Ah-3.7V-1S1P

Connect, charge and power on the baby monitor

1. Connect the Baby Monitor

- Notes:**
- The rechargeable battery in the Parent Viewer is built-in.
 - Use only the power adapters supplied with this product.
 - Make sure the Parent Viewer and the Baby Unit are not connected to the switch controlled electric outlets.
 - Connect the power adapters in a vertical or floor mount position only. The adapters' prongs are not designed to hold the weight of the Parent Viewer and the Baby Unit, so do not connect them to any ceiling, under-the-table, or cabinet outlets. Otherwise, the adapters may not properly connect to the outlets.
 - Make sure the Parent Viewer, the Baby Unit and the power adapter cords are out of reach of children.
 - To maintain compliance with the FCC's RF exposure guidelines, place the Baby Unit at least 20cm from nearby persons.

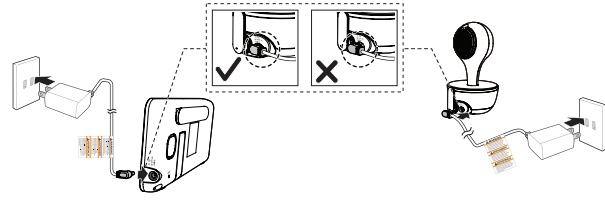

2. Charge the Parent Viewer battery before use

When you connect and turn on the Parent Viewer, the battery charges automatically.

- Notes:**
- Before using the baby monitor for the first time, charge the Parent Viewer battery for 12 hours. When the Parent Viewer battery is fully charged, the battery icon becomes solid.
 - The standby time varies depending on the Baby Unit sensitivity levels you set for Auto Wake-Up, your actual usage time and the age of the battery.

The battery icon on the screen indicates the battery status (see the following table).

Battery Indicators	Battery Status	Action
The screen displays . The light flashes.	The battery has very little power left and may only be used for a short time.	Charge without interruption (about 30 minutes).
The battery icon becomes solid	The battery is fully charged.	To keep the battery charged, connect it to AC power when not in use.

capabilities, or lack of experience and knowledge, unless they have been given supervision or instruction concerning use of the appliance by a person responsible for their safety.

SAVE THESE INSTRUCTIONS

- Cautions**
- Use and store the product at a temperature between 32°F and 104°F.
 - Do not expose the product to extreme cold, heat or direct sunlight. Do not put the product close to a heating source. Batteries should not be exposed to excessive heat such as bright sunshine or fire.
 - Warning—Strangulation Hazard—Children have STRANGLED in cords.** Keep this cord out of the reach of children (more than 3 ft (0.9m) away). Do not remove this tag.
 - Never place the Baby Unit(s) inside the baby's crib or playpen. Never cover the Baby Unit(s) or Parent Viewer with anything such as a towel or a blanket.
 - Other electronic products may cause interference with your baby monitor. Try installing your baby monitor as far away from these electronic devices as possible: wireless routers, radios, cellular telephones, intercoms, room monitors, televisions, personal computers, kitchen appliances and cordless telephones.

Precautions for users of implanted cardiac pacemakers
Cardiac pacemakers (applies only to digital cordless devices):
Wireless Technology Research, LLC (WTR), an independent research entity, led a multidisciplinary evaluation of the interference between portable wireless devices and implanted cardiac pacemakers. Supported by the U.S. Food and Drug Administration, WTR recommends to physicians that:

Pacemaker patients

- Should keep wireless devices at least six inches from the pacemaker.
- Should NOT place wireless devices directly over the pacemaker, such as in a breast pocket, when it is turned ON. WTR's evaluation did not identify any risk to bystanders with pacemakers from other persons using wireless devices.

Electromagnetic fields (EMF)
This LeapFrog product complies with all standards regarding electromagnetic fields (EMF). If handled properly and according to the instructions in this user's manual, the product is safe to be used based on scientific evidence available today.

What's Included

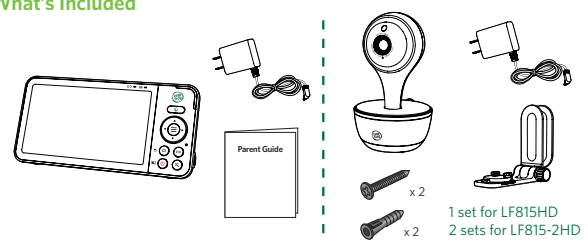

Requirements

For mobile access:

LeapFrog mobile app	Wi-Fi
Network	Wi-Fi
Wi-Fi router	2.4GHz 802.11 b/g/n
Internet connection	1.5 Mbps @ 720p or 2.5 Mbps @ 1080p upload bandwidth per Baby Unit

3. Power On or Off the Baby Monitor

- Slide the On/Off switch to **ON** in order to power on your Baby Unit.
- After the Parent Viewer is fully charged, **press and hold** until the welcome screen appears.



- 3. Status Check**
Once your Baby Unit and Parent Viewer are powered on, your Parent Viewer displays image from the Baby Unit, and the **LINK** LED light turns on. The Baby Unit's **POWER** LED light also turns on.
- Note:**
- The POWER LED Light is OFF by default.

4. Positioning the Baby Monitor

- Place the Baby Unit at least 3ft (1m) away from other electronic devices.
 - Place the Baby Unit at least 3ft (1m) away from other electronic devices.
 - Place the Baby Unit at least 3ft (1m) away from other electronic devices.
 - Place the Baby Unit at least 3ft (1m) away from other electronic devices.
- Note:**
- To avoid interference from other electronic devices, place your baby monitor at least 3 feet (1 meter) away from devices such as wireless routers, microwaves, cell phones and computers.
- Caution:**
- The default volume of your Parent Viewer is level 3, and the maximum volume is level 5. If you experience a high-pitched screeching noise from your baby monitor while positioning:
 - Make sure your Baby Unit and Parent Viewer are more than 3 feet (1 meter) apart, **OR**
 - Lower the volume of your Parent Viewer.

Key Features

- Color and B&W Automatic Night Vision**
- Humidity and Temperature Sensor**
- Lullabies and Soothing Sounds**

- Night Light**
- Motion and Sound Sensor**

Technical Specifications

Frequency	2412-2462 MHz
Channels	1-11
LCD	5" Color LCD (IPS 1280x720 pixels)
Nominal effective range	Maximum power allowed by FCC and IC. Actual operating range may vary according to environmental conditions at the time of use.
Power requirements	Parent Viewer: 3.7V 5000mAh Lithium-ion battery Baby Unit power adapter: Output: 5V DC @ 1A Parent Viewer power adapter: Output: 5V DC @ 2A

Credits: The Background Noise sound file was created by Caroline Ford, and is used under the Creative Commons license. The Stream Noise sound file was created by Caroline Ford, and is used under the Creative Commons license. The Crickets At Night sound file was created by Mike Koenig, and is used under the Creative Commons license. The Heart Beat sound file was created by Zarabadeu, and is used under the Creative Commons license.



Overview - Parent Viewer

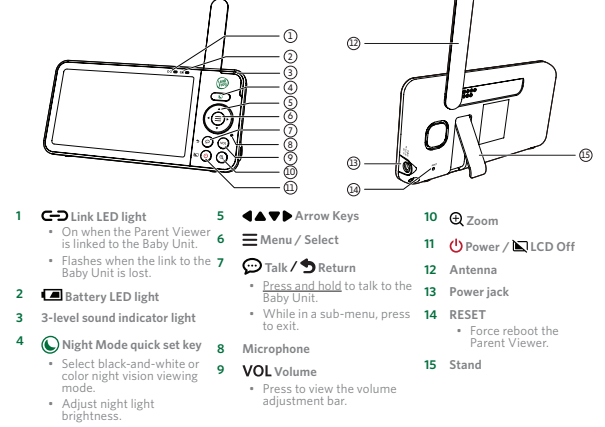

Overview - Baby Unit

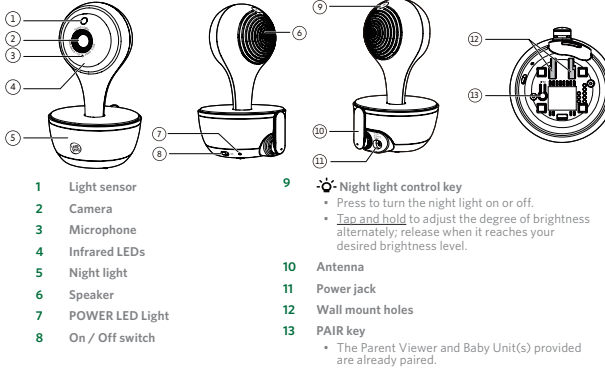

How the system works?

Direct mode

The Parent Viewer and the Baby Unit of your video monitor connect to each other in **Direct mode** by default, which allows you to stream live video right out of the box. **Direct mode** connection lets you stream live video from the Parent Viewer only.

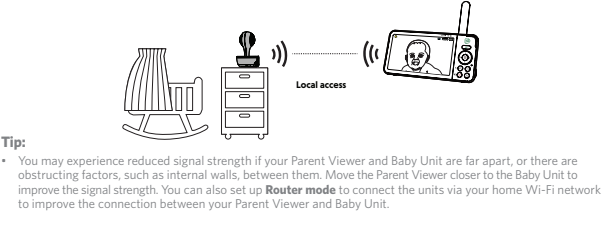

Wi-Fi Router mode

You can continue using your video monitor with **Direct mode** connection, or you can set up your monitor in **Router mode** connection.

Router mode uses your home Wi-Fi network to connect your video monitor. It supports live video streaming through the Parent Viewer and smartphone app.

We recommend that you set up your monitor in **Router mode** to enjoy live video streaming via your Parent Viewer with an enhanced connection.

If you want to stream live video remotely with your mobile device, download and install the **LeapFrog** mobile app. With the mobile app, your Wi-Fi router (not included) provides Internet connectivity to your HD video monitor system. It serves as a communicating channel between your Baby Unit and mobile device, allowing you to monitor and/or control your Baby Unit wherever you are. For more details, see **Download app for mobile access** section in this Parent Guide.

- Notes:**
- Your Parent Viewer detects the connection signal strength. If you have connected your video monitor with your home Wi-Fi network, your Parent Viewer automatically switches to direct or router mode - whichever has a stronger signal strength.
 - When both Parent Viewer and app are viewing the camera simultaneously, the video quality will be optimised to deliver the best possible viewing result.

Parent Viewer Icons

Main Menu Icons

Monitoring mode (For LF815-2HD only)

- Baby Unit 1 in **Single mode**
- Baby Unit 2 in **Single mode**
- Patrol mode**
Viewer displays video feeds from all paired Baby Units at the same time in split view.
- Split mode**
Viewer displays a single Baby Unit's video feed that transitions to a different Baby Unit every 10 seconds.

Night light

- Turn **On/Off** night light.
- Select a night light **Color**. Choose from 7 preset colors and 3 light patterns.
- Select **Auto Brightness** mode (or) Adjust the fixed level night light brightness.
- Set a **Timer** to turn the night light off after 15, 30, or 60 minutes.

Lullaby

- Stop** melody playing.
- Play** all melodies.
- Play and view all Songs**. Choose from 5 melodies and 5 soothing sounds.
- Set a **timer** to stop playing melodies after 15, 30, or 60 minutes, or let them play non-stop.

Detection

- Sound**
 - Select sound **Sensitivity** level.
 - Turn on/off **Sound Detection Alert**. Parent Viewer beeps when the Baby Unit detects sounds above the chosen sound sensitivity level.
 - Turn on/off **Auto Wake Up** function. Once the Baby Unit detects sounds that are louder than the chosen sound sensitivity level, the Parent Viewer screen and speaker turn on automatically.
- Motion**
 - Turn on/off **Motion Alert**. Parent Viewer beeps when the Baby Unit detects movements larger than the chosen motion sensitivity level.
 - Select motion **Sensitivity** level.
- Temperature**
 - Turn on/off **Temperature Alert**. When you turn it on, the Parent Viewer beeps whenever the room temperature detected by the Baby Unit falls outside the set temperature range.
 - Select the **Minimum** temperature of the temperature alert range.
 - Select **Maximum** temperature of the temperature alert range.
 - Select temperature **Format**. Change the temperature display format to Fahrenheit (°F) or Celsius (°C).

Parent Viewer settings

- Adjust Parent Viewer screen **Brightness**.
- Adjust **Low Battery Alert Tone Volume**.
- Adjust **No Link Alert Tone Volume**.
- Turn on/off **Dim Mode**. (See **Dim Mode** section to learn more)
- Change the **Language** on your Parent Viewer

Baby Unit settings

- Turn on/off **Status LED** indicator. When on, the POWER LED light on the Baby Unit turns on/off or flash to indicate the camera's conditions.
- Adjust the Baby Unit's speaker **Volume**.

General settings

- Configure Wi-Fi**. Change your **Wi-Fi network**, select a **Connection Mode**, and check the Baby Unit and Parent Viewer's **Connection Status**.
- Connect Mobile Phone**
- Add Baby Unit**
- Remove Baby Unit**
- Reset Settings to default**.
- Software Update**
Check if your Parent Viewer software is up to date, or install a new update when available.

Status Bar Icons

- Current view status**
 - The Baby Unit number that is being viewed when in:
 - Single Baby Unit mode
 - Patrol mode (* For LF815-2HD or pairing with LF815-OHD)
 - Split mode (* For LF815-2HD or pairing with LF815-OHD)
 - Split mode (* For LF815-2HD or pairing with LF815-OHD)
 - Patrol mode (* For LF815-2HD or pairing with LF815-OHD)
- Black and white night vision is activated.
- Color night vision is activated.
- Motion detection and alert is turned on.
- Sound detection and alert is turned on.
- Melodies or soothing sounds are playing.
- Night light is turned on and the automatic brightness setting is turned off.

