

Go to www.vtechphones.com to register your product for enhanced warranty support and the latest VTech product news.

VM919HD VM919-2HD Full Color Pan and Tilt HD Video Monitor



For more support information



VM919HD VM919-2HD

vtech® Quick start guide

Model	VM919HD, VM919-2HD
Frequency control	CPS/Freq. controlled PLL/Synchresizer
Transmit frequency	Baby unit: 2405-2475MHz
Channels	32
LCF	FCC ID: J7D0080 (part 68)
Minimum effective range	Maximum range allowed by FCC and IC: Actual operating range may vary according to environmental conditions at the site.
Power requirements	Baby unit power adapter: Output: 5V DC @ 2A Parent unit power adapter: Output: 5V DC @ 2A
Weight	Parent unit: 3.75 pounds (1.7 kg), 1.8 lbs. (0.8 kg) net weight Baby unit: 1.75 pounds (0.8 kg), 1.6 lbs. (0.7 kg) net weight
Dimensions	Parent unit: 4.7" (120 mm) H x 3.1" (78 mm) W x 1.8" (46 mm) D Baby unit: 4.7" (120 mm) H x 3.1" (78 mm) W x 1.8" (46 mm) D

TECHNICAL SPECIFICATIONS

IMPORTANT SAFETY INSTRUCTIONS

- The applied warnings is located at the bottom of the baby units base.
- When using your equipment, basic safety precautions should always be followed to reduce the risk of fire, electric shock and injury, including the following:
- Follow all warnings and instructions marked on the product.
 - Use only the power adapter supplied with the product.
 - CAUTION:** Do not install the baby unit at a height above 2 feet.
 - This product is intended as an aid. It is not a substitute for responsive and proper adult supervision and should not be used as such.
 - This product is not intended for use as a medical device.
 - Do not use this product near water. For example, do not use it near a bath tub, wash basin, kitchen sink, laundry tub or swimming pool, or in a well basement or shower.
 - CAUTION:** Use only the battery provided. There may be a risk of explosion if a wrong type of battery is used for the parent unit. The battery cannot be subjected to high or low extreme temperature and low air pressure at high altitude during use, storage or transport. Disposal of battery into fire or a hot oven, or mechanically crushing or cutting of the battery can result in an explosion. Leaving the battery in an extremely high temperature surrounding environment can result in an explosion or the leakage of flammable liquid or gas. Battery subjected to extremely low air pressure may result in an explosion or the leakage of flammable liquid or gas. Dispose of used battery according to the information in the **RRRC** call.
 - Use only the spacers included with this product. Incorrect adapter polarity or voltage can seriously damage the product.

- Use the power adapter information: Baby Unit Output: 5V DC 2A
V-Tech Telecommunications Ltd.
Model: VT00503000
- Use the power adapter information: Parent Unit Output: 5V DC 2A
V-Tech Telecommunications Ltd.
Model: VT00503000
- Use the power adapter information: Baby Unit Output: 5V DC 2A
Zhuohui Great Power Energy Co., Ltd.
Model: GPE00000000
- The power adapter is intended to be plugged into a standard wall outlet. The power cord should not be draped over the table or cabinet outlet.
- For portable use, use the power adapter with a power cord that has a standard three-pronged plug and is easily accessible.
- Do not use this product from the wall outlet before cleaning. Do not use liquid or aerosol cleaners. Use a damp cloth for cleaning.
- Do not cut out of the cover or remove the top cover.
- Do not allow anything to rest on the power cords. Do not insert this product where the cords may be walked or tripped over.
- This product should be operated only from the type of power source indicated on the marking label. If you are not sure of the type of power supply in your home, consult your dealer or local power company.
- The equipment is to be supplied from an identified USB port complying with the requirements of Limited Power Source.
- Do not overload wall outlet or an extension cord.
- Do not place this product on an unstable shelf, table, stand or other similar surface.
- This product should not be placed in any area where proper ventilation is not provided. Stop and openings on the back or bottom of this product are provided for ventilation. To protect them from overheating, these openings must not be blocked by placing the product on a soft surface such as a bed, sofa or rug. This product should never be placed near or over a fire.

- Use and store the product at a temperature between 32°F and 104°F.
 - Burn hazard. The hazard, explosion hazard associated with mishandling of the battery.
 - Do not expose the product to extreme cold, heat or direct sunlight. Do not put the product close to a heating source.
 - Warning - Strangulation Hazard - Cords:** Cords present a strangulation hazard to children under 3 years of age. Do not remove the top cover.
 - Never place the camera units inside the baby's crib or playpen. Never cover the camera unit or parent unit with anything such as a towel or a blanket.
 - Other electronic products may cause interference with your camera unit. Installing your camera unit as far away from these electronic devices as possible: wireless routers, video, cellular telephones, intercom, room monitors, televisions, personal computers, and other appliances and cordless telephones.
- Precautions for use of implanted cardiac pacemakers:**
- Cordless pacemakers (applies only to digital cordless devices): Wireless Technology Research, LLC (WTR), an independent research entity, has a multiprofessional evaluation of the interference between portable wireless devices and implanted cardiac pacemakers. Supported by the U.S. Food and Drug Administration, WTR recommends to physicians that:
- Patients should be advised to avoid using wireless devices.
 - Should keep wireless devices at least six inches from the pacemaker.
 - Should NOT place wireless devices directly over the pacemaker.
 - Should NOT place wireless devices in a bag or pocket when it is turned ON.
 - WTR's evaluation did not identify any risks to bystanders with pacemakers from other persons using wireless devices.
- Electromagnetic fields (EMF)**
- The VTech product complies with all standards regarding electromagnetic fields (EMF). If handled properly and according to the instructions in this user's manual, the product is safe to be used based on scientific evidence available today.

WHAT'S IN THE BOX

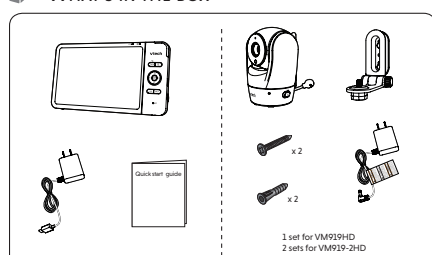

1 set for VM919HD
2 sets for VM919-2HD

1 CONNECT THE BABY MONITOR

- NOTES**
- The rechargeable battery in the parent unit is built-in.
 - Use only the power adapters supplied with this product.
 - Make sure the parent unit and the baby unit are not connected to the switched controlled electric outlets.
 - Connect the power adapters in a vertical or floor mount position only. The adapters' prongs are not designed to hold the weight of the parent unit and the baby unit, so do not connect them to any ceiling, under-the-table, or cabinet outlets. Otherwise, the adapters may not properly connect to the outlets.
 - Make sure the parent unit, the baby unit and the power adapter cords are out of reach of children.
 - To maintain compliance with the FCC's RF exposure guidelines, place the baby unit at least 20cm from nearby persons.
- Raise the parent unit antenna for better reception**
-

1 CONNECT THE BABY MONITOR (CONT'D)

Charge the parent unit battery before use

- When you have connected and turned on the parent unit, the battery will be charged automatically.
- NOTES**
- Before using the baby monitor for the first time, charge the parent unit battery for 12 hours. When the parent unit battery is fully charged, the battery icon becomes solid.
 - It takes longer to charge the battery when the parent unit is turned on. To shorten the charging time, turn the parent unit off while charging.
 - The standby time varies depending on the sensitivity level you set, your actual use and the age of the battery.

The battery icon indicates the battery status (see the following table).

BATTERY INDICATORS	BATTERY STATUS	ACTION
The screen displays The light flashes.	The battery has very little charge and may be used for only a short time.	Charge without interruption (about 30 minutes).
The battery icon becomes solid	The battery is fully charged.	To keep the battery charged, connect it to AC power when not in use.

2 POWER ON OR OFF THE BABY MONITOR

- Slide the switch to **ON** to power on your baby unit.
 - After the parent unit is fully charged, press **POWER** until the welcoming screen appears.
-

3 POSITIONING THE BABY MONITOR

- Place the baby monitor in a safe location, away from the baby's crib or playpen.
 - Place the baby monitor at least 3 feet (1 meter) away from the baby's crib or playpen.
 - Place the baby monitor at least 3 feet (1 meter) away from the baby's crib or playpen.
- NOTE**
- To avoid interference from other electronic devices, place your baby monitor at least 3 feet (1 meter) away from devices such as wireless routers, microwaves, cell phones and computers.
- CAUTION**
- The default volume of your parent unit is level 3, and the maximum volume is level 5. If you experience high-pitched screaming noise from your baby monitor while positioning:
 - Make sure your baby unit and parent unit are more than 1 feet (1 meter) apart, OR
 - Lower the volume of your parent unit.

4 STATUS CHECK

- Once you power on both your baby unit and parent unit, your parent unit displays image from the baby unit, and the **LINK** LED light turns on.
- The green LED light of the baby unit turns on.
-

BASIC OPERATION - PARENT UNIT

- Adjust speaker volume**
- Press **VOL+ / VOL-** to adjust your parent unit speaker volume. It determines the volume of sound transmitted from your baby unit.
- Zoom**
- Press **Q** to zoom in or out.
- Use the menu**
- Press **MENU** to enter the menu, choose a menu item, or save a setting. You can use the parent unit for advanced settings or operations, such as to play or stop the baby unit lullaby, or to adjust the baby unit sound sensitivity.
- While in the menu:
- Press **▲**, **▼**, **←** or **→** to scroll among the menu options.
 - Press **SELECT** to select an item, or to save a setting.
 - Press **TALK** to return to the live video.
 - Press **Q** to go to the **Help & Info** page.

- Talk to your baby via the baby unit**
- Press and hold the **TALK** key.
 - When the **TALK** icon displays on screen, speak to your parent unit. Your voice is transmitted to the baby unit.
 - When finish talking, release the **TALK** key and hear your baby again.
- Turn on/off the parent unit screen**
- You can turn on or off the parent unit screen without powering off the parent unit. You can still hear sound from the baby unit.
- Press **POWER** on the parent unit to turn off the screen.
 - Press any keys on the parent unit to turn on the screen again.

OVERVIEW - PARENT UNIT

- LINK LED light
- LED light
- 3-level sound indicator light
- TALK
 - Press and hold to talk to the baby unit.
 - While in a submenu, press to exit.
- Q
 - Press to zoom in/out.
 - When in the main menu, press to go to the **Help & Info** page.
- Arrow keys
- MENU/SELECT
 - Press to enter the main menu.
 - While in a menu, press to choose an item, or save a setting.
- VOL+ / VOL-
 - Increase or decrease parent unit's volume.
- Microphone
- POWER key
- Power jack
- RESET
 - Force reboot the parent unit.
- Antenna
- Speaker
- Stand

OVERVIEW - BABY UNIT

- Microphone
- Camera lens
- Light sensor
- LED indicator
- Infrared LEDs
- ON/OFF switch
- Antenna
- Speaker
- Temperature sensor
 - Position the sensor horizontally for its optimal usage.
- Power jack
- Threaded socket for wall mounting
- Pair button

NEED HELP?

- For operations and guides to help you using your video monitor, and for latest information and supports, go and check the online help topics and online FAQs.
- Use your smartphone or mobile device to access our online help.
- Go to <https://help.vtechphones.com/vm919hd> or <https://help.vtechphones.com/vm919-2hd>. OR
 - Scan the QR code on the right. Launch the camera app or QR code scanner app on your smartphone or tablet. Hold the device's camera up to the QR code and frame it. Tap the notification to trigger the redirection of the online help.
- If the QR code is not clearly displayed, adjust your camera's focus by moving your device closer or further away until it is clear.
- You can also call our Customer Support at 1 (800) 595-9511 (in US) or 1 (800) 267-7377 (in Canada) for help.
-

PARENT UNIT ICONS

- Main menu icons**
- Main menu**
- Monitoring mode (For VM919-2HD only)
 - Baby unit 1 in Single mode
 - Baby unit 2 in Single mode
 - Patrol mode
 - Split mode
 - Melodies and soothing sounds
 - Melodies and Soothing Sounds
 - Select play all melodies, or play one of the five melodies and four soothing sounds.
 - Timer
 - You can also set the timer to stop playing after 15, 30 or 60 minutes, or playing non-stop.
 - Alerts - Sound, motion and temperature
 - Sound
 - Select sound Sensitivity level.
 - Turn on/off Sound Detection Alert.
 - Turn on/off Auto Wake Up function.
 - (See Sound Detection and Auto Wake Up section)
 - Motion
 - Turn on/off Motion Alert.
 - Select motion Sensitivity level.
 - (See Motion Detection section)
 - Temperature
 - Turn on/off Low Battery Alert Tone.
 - Set the parent unit to beep when the battery is low.
 - Turn on/off No Alert Tone.
 - Set the parent unit to beep when the link between the parent unit and the baby unit is lost.

PARENT UNIT ICONS

- Status icons**
- Current video status
 - The baby unit number that is being viewed when in:
 - Single CAM mode.
 - Patrol mode (* For VM919-2HD only).
 - Split mode (* For VM919-2HD only).
 - Patrol mode (* For VM919-2HD only)
 - Split mode (* For VM919-2HD only)
 - Night vision feature is activated automatically.
 - Motion alert is turned on.
 - Sound detection alert is turned on.
 - Melodies or soothing sound are turned on.
 - Parent unit speaker is muted.
 - Temperature alert is turned on.
- Parent unit settings**
- Adjust parent unit screen Brightness.
 - Turn on/off Dim Mode.
- Baby unit settings**
- Turn on/off baby unit's Status LED.
 - Select Field of View
 - Choose Wide angle or Standard .
 - Adjust baby unit's speaker Volume.
- General settings**
- Turn on/off Low Battery Alert Tone.
 - Set the parent unit to beep when the battery is low.
 - Turn on/off No Alert Tone.
 - Set the parent unit to beep when the link between the parent unit and the baby unit is lost.
- Alert icons**
- Displays when parent unit's battery is low and needs charging.
 - Displays when motion is detected at a baby unit.
 - Displays when sound is detected at a baby unit.
 - Baby unit detects temperature exceeds the set maximum.
 - Baby unit detects temperature is lower than the set minimum.

