

Go to www.vtechphones.com to register your product for enhanced warranty support and latest Vtech product news.

CSS329
CSS329-2
CSS329-3
CSS329-4

DECT 6.0 cordless telephone

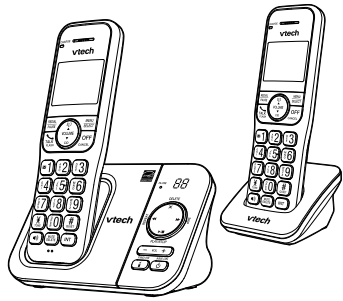

vtech Quick start guide

WHAT'S IN THE BOX

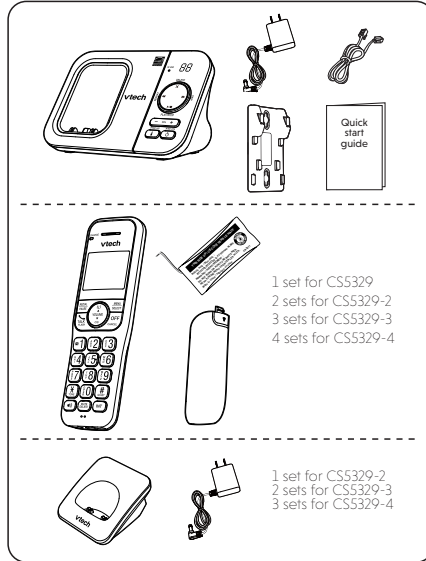

IMPORTANT SAFETY INSTRUCTIONS

When using your telephone equipment, basic safety precautions should always be followed to reduce the risk of fire, electric shock and injury, including the following:

1. Read and understand all instructions.
2. Follow all warnings and instructions marked on the product.
3. Unplug this product from the wall outlet before cleaning. Do not use liquid or aerosol cleaners. Use a damp cloth for cleaning.
4. Do not use this product near water such as near a bath tub, wash bowl, kitchen sink, laundry tub or a swimming pool, nor in a wet basement or shower.
5. Do not place this product on an unstable table, shelf, stand or other unstable surfaces.
6. Avoid placing the telephone system in places with extreme temperature, direct sunlight, or other electrical devices. Protect your phone from moisture, dust, corrosive liquids and fumes.
7. Slots and openings in the back or bottom of the telephone base and handset are provided for ventilation. To protect them from overheating, these openings must not be blocked by placing the product on a soft surface such as a bed, sofa or rug. This product should never be placed near or over a radiator or heat register. This product should not be placed in any area where proper ventilation is not provided.
8. This product should be operated only from the type of power source indicated on the marking label. If you are not sure of the type of power supply in your home or office, consult your dealer or local power company.
9. Do not allow anything to rest on the power cord. Do not install this product where the cord may be walked on.
10. Never push objects of any kind into this product through the slots in the telephone base or handset because they may touch dangerous voltage points or create a short circuit. Never spill liquid of any kind on the product.
11. To reduce the risk of electric shock, do not disassemble this product, but take it to an authorized service facility. Opening or removing parts of the telephone base or handset other than specified access doors may expose you to dangerous voltages or other risks. Incorrect reassembling can cause electric shock when the product is subsequently used.
12. Do not overload wall outlets and extension cords.
13. Unplug this product from the wall outlet and refer servicing to an authorized service facility under the following conditions:
 - When the power supply cord or plug is damaged or frayed.
 - If liquid has been spilled onto the product.
 - If the product has been exposed to rain or water.
 - If the product does not operate normally by following the operating instructions. Adjust only those controls that are covered by the operation instructions. Improper adjustment of other controls may result in damage and often requires extensive work by an authorized technician to restore the product to normal operation.
 - If the product has been dropped and the telephone base and/or handset has been damaged.
 - If the product exhibits a distinct change in performance.
14. Avoid using a telephone (other than cordless) during an electrical storm. There is a remote risk of electric shock from lightning.
15. Do not use the telephone to report a gas leak in the vicinity of the leak. Under certain circumstances, a spark may be created when the adapter is plugged into the power outlet, or when the handset is replaced in its cradle. This is a common event associated with the closing of any electrical circuit. The user should not plug the phone into a power outlet, and should not put a charged handset into the cradle, if the phone is located in an environment containing concentrations of flammable or flame-supporting gases, unless there is adequate ventilation. A spark in such an environment could create a fire or explosion. Such environments might include: medical use of oxygen without adequate ventilation; industrial gases (cleaning solvents; gasoline vapors, etc.); a leak of natural gas; etc.
16. Only put the handset of your telephone next to your ear when it is in normal talk mode.
17. The power adapter is intended to be correctly oriented in a vertical or floor mount position. The prongs are not designed to hold the plug in place if it is plugged into a ceiling, under-the-table or cabinet outlet.

18. For pluggable equipment, the socket-outlet shall be installed near the equipment and shall be easily accessible.
19. **CAUTION:** Use only the batteries indicated in this manual. There may be a risk of explosion if a wrong type of battery is used for the handset. Use only the supplied rechargeable batteries or replacement batteries (BT162342/262342) for the handset. Do not dispose of batteries in a fire. They may explode.
20. Use only the adapter included with this product. Incorrect adapter polarity or voltage can seriously damage the product.

- SAVE THESE INSTRUCTIONS**
- **CAUTION:** Use Only Supplied Battery.
 - Do not dispose of the battery in a fire. Check with local waste management codes for special disposal instructions.
 - Do not open or mutilate the battery. Released electrolyte is corrosive and may cause burns or injury to the eyes or skin. The electrolyte may be toxic if swallowed.
 - Exercise care in handling batteries in order not to create a short circuit with conductive materials.
 - Charge the battery provided with this product only in accordance with the instructions and limitations specified in this manual.

Precautions for users of implanted cardiac pacemakers
Cardiac pacemakers (applied only to digital cordless telephones): Wireless Technology Research, LLC (WTR), an independent research entity, led a multidisciplinary evaluation of the interference between portable wireless telephones and implanted cardiac pacemakers. Supported by the U.S. Food and Drug Administration, WTR recommends to physicians that:
Pacemaker patients

- Should keep wireless telephones at least six inches from the pacemaker.
- Should NOT place wireless telephones directly over the pacemaker, such as in a breast pocket, when it is turned ON.
- Should use the wireless telephone on the ear opposite the pacemaker.

WTR's evaluation did not identify any risk to bystanders with pacemakers from other persons using wireless telephones.

ABOUT CORDLESS TELEPHONES

- **Privacy:** The same features that make a cordless telephone convenient create some limitations. Telephone calls are transmitted between the telephone base and the cordless handset by radio waves, so there is a possibility that the cordless telephone conversations could be intercepted by radio receiving equipment within range of the cordless handset. For this reason, you should not think of cordless telephone conversations as being as private as those on corded telephones.
- **Electrical power:** The telephone base of this cordless telephone must be connected to a working electrical outlet. The electrical outlet should not be controlled by a wall switch. Calls cannot be made from the cordless handset if the telephone base is unplugged, switched off or if the electrical power is interrupted.
- **Potential TV interference:** Some cordless telephones operate at frequencies that may cause interference to televisions and VCRs. To minimize or prevent such interference, do not place the telephone base of the cordless telephone near or on top of a TV or VCR. If interference is experienced, moving the cordless telephone farther away from the TV or VCR often reduces or eliminates the interference.
- **Rechargeable batteries:** Exercise care in handling batteries in order not to create a short circuit with conducting material such as rings, bracelets and keys. The battery or conductor may overheat and cause harm. Observe proper polarity between the battery and the battery charger.
- **Nickel-metal hydride rechargeable batteries:** Dispose of these batteries in a safe manner. Do not burn or puncture the battery. Like other batteries of this type, if burned or punctured, they could release caustic material which could cause injury.

CONNECT AND ACTIVATE

1 Connect the telephone base

If you subscribe to digital subscriber line (DSL) high-speed Internet service through your telephone line, make sure you connect a DSL filter (not included) to the telephone wall jack.

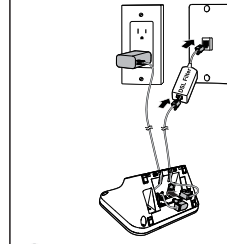

2 Install the battery

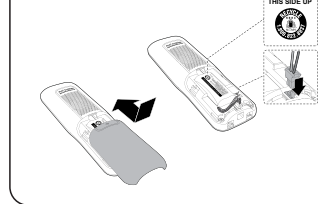

3 Connect the charger

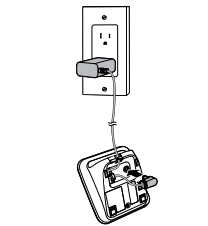

4 Charge the battery

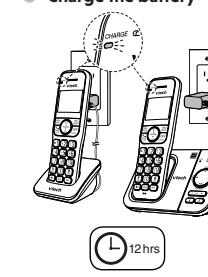

Display

	The battery is low and needs charging.
	The battery is charging.
	The battery is fully charged.
	Handset ringer is off.
	New voicemail received from your telephone service provider.
	There are new caller ID log entries.
	Answering system is on.
	Number of new/old messages recorded.
	The ECO mode activates automatically to reduce power consumption when the handset is within range of the telephone base.

2 SETUP

After you install your telephone or power returns following a power outage and battery depletion, the handset will prompt you to set the date and time, and to configure the answering system through voice guide.

Date and time

Follow the steps below to set the date and time. For example, if the date is 25 December, 2019, and the time is 10:59 AM:

When the handset prompts you to set the date and time

1 Enter the date.

2 Press SELECT.

3 Enter the time.

4 Press SELECT.

Document order number: 96-010-100-100
Address: 2020 Vtech Communications, Inc. - Site 555 Triad, OR 97223, United States
Phone: 1 (800) 595-9511 in the U.S. or 1 (800) 262-7377 in Canada

DISCLAIMER AND LIMITATION OF LIABILITY
Vtech Communications, Inc. and its suppliers assume no responsibility for any damage or loss resulting from the use of this user's manual. Vtech Communications, Inc. and its suppliers do not warrant the accuracy of the information contained in this manual. Vtech Communications, Inc. and its suppliers do not assume any responsibility for any damage or loss resulting from the use of this user's manual.

The ENERGY STAR program (www.energy.gov) recognizes and encourages the use of products that save energy and help protect our environment. We are proud to make this product with the ENERGY STAR label indicating it meets the latest energy efficiency guidelines.

Telephones identified with this logo have reduced noise and interference when used with most T-coil equipped hearing aids and cochlear implants. The TIA-1083 Compliant logo is a trademark of the Telecommunications Industry Association. Used under license.

TECHNICAL SPECIFICATIONS

Frequency	Handset: 1921.536-1928.448 MHz
Channels	DECT channel: 5
Memory	Phonebook: 50 memory locations
Power requirement	Handset: 2.4V Ni-MH battery
Charger requirement	Telephone base: 6V DC @ 400mA
Maximum power allowed by FCC and IC	Handset: 24 dBm
Actual operating range may vary according to environmental conditions at the time of use.	

BASIC OPERATION

Make a call

1 Press **TALK FLASH** - OR - **FLASH**

2 Enter the phone number

Answer a call

Press **TALK FLASH** - OR - **FLASH** - OR - Press any dialing keys to answer

End a call

Press **OFF** - OR - **CANCEL**

Speakerphone

Press **SPK**

Volume

Press **VOLUME** - OR - **UP** - OR - **DOWN**

PHONEBOOK

Phonebook

The phonebook can store up to 50 entries, which are shared by all handsets. Each entry may consist of a telephone number up to 30 digits, and a name up to 15 characters.

Add a phonebook entry

1 Enter the phone number.

2 Press **MENU**.

3 Press **SELECT**.

4 Enter the name.

5 Press **SELECT**.

Review phonebook entries

1 Press **PHONEBOOK**

2 Press **UP** / **DOWN** to browse the entries.

Delete a phonebook entry

When your desired phonebook entry displays on the handset screen

1 Press **DELETE**.

2 Press **SELECT**.

CALLER ID

Caller ID

If you subscribe to caller ID service, information about each caller appears after the first or second ring. The caller ID log stores up to 30 entries. Each entry has up to 24 digits for the phone number and 15 characters for the name.

Review caller ID log entries

1 Press **CID**.

2 Press **UP** / **DOWN** to browse the entries.

Dial a caller ID log entry

When your desired caller ID entry displays on the handset screen

Press **TALK FLASH** - OR - **FLASH**

Save a caller ID log entry to the phonebook

When your desired caller ID entry displays on the handset screen

1 Press **MENU**.

2 Press **SELECT** to select **To phonebook**.

3 Edit the phone number if needed, then press **SELECT**.

4 Edit the name if needed, then press **SELECT**.

Delete a caller ID log entry

When your desired caller ID entry displays on the handset screen

Press **DELETE** to delete.

Voice guide for answering system

After setting the date and time, the handset will display **Voice guide to...** and set up **Ans sys?** alternatively.

This feature assists you to do the basic setup of the answering system. You can follow the voice guide to record your own announcement, set the number of rings and the message alert tone.

When the handset prompts you to set up the answering system via voice guide

Press **SELECT**.

Setup your answering system by inputting the designated numbers as instructed in the voice guide.

LCD LANGUAGE SETTING

If you accidentally set the LCD language to Spanish or French, press **MENU** and then enter ***364#** to change the handset LCD language back to English while the handset is not in use.

