

# VM5463 VM5463-2 Full Color Pan and Tilt Video Monitor

Go to [www.vtechphones.com](http://www.vtechphones.com) to enhance warranty support and the latest Vtech product news.



## Quick start guide



©2019 Vtech Industries, Inc. All rights reserved.  
VM5463-2 (20190129)

This document shows how the new product is used. Read the manual before you use the product. The Screen Name and/or ID is not covered by the FCC Part 15.247 and 15.249. The Screen Name and/or ID is not covered by the FCC Part 15.247 and 15.249. The Screen Name and/or ID is not covered by the FCC Part 15.247 and 15.249.

Technical Specifications

Frequency control	Crystal controlled 32.768 kHz
Transmit frequency	916.5 MHz - 920.5 MHz
Channel	12
Modulation	GFSK (FSK) 2FSK, 2DSSSS
Power requirements	Battery unit: 3x AA Ni-MH battery Parent unit: 3x AA Ni-MH battery
Net weight	1.25 kg (2.75 lbs)
Dimensions (W x H x D)	111 x 105 x 45 mm

## IMPORTANT SAFETY INSTRUCTIONS

The safety instructions are located at the bottom of the box. Please read the safety instructions carefully before using the product. Do not use the product if you find any damage or if the product does not work properly. Do not use the product near water. Do not use the product near fire. Do not use the product near children. Do not use the product near pets. Do not use the product near electrical equipment. Do not use the product near medical equipment. Do not use the product near pregnant women. Do not use the product near children with disabilities. Do not use the product near children who are allergic to plastic. Do not use the product near children who are allergic to nickel. Do not use the product near children who are allergic to lead. Do not use the product near children who are allergic to cadmium. Do not use the product near children who are allergic to mercury. Do not use the product near children who are allergic to chromium. Do not use the product near children who are allergic to cobalt. Do not use the product near children who are allergic to iron. Do not use the product near children who are allergic to manganese. Do not use the product near children who are allergic to zinc. Do not use the product near children who are allergic to copper. Do not use the product near children who are allergic to silver. Do not use the product near children who are allergic to gold. Do not use the product near children who are allergic to platinum. Do not use the product near children who are allergic to palladium. Do not use the product near children who are allergic to rhodium. Do not use the product near children who are allergic to iridium. Do not use the product near children who are allergic to osmium. Do not use the product near children who are allergic to tungsten. Do not use the product near children who are allergic to rhenium. Do not use the product near children who are allergic to niobium. Do not use the product near children who are allergic to molybdenum. Do not use the product near children who are allergic to vanadium. Do not use the product near children who are allergic to chromium. Do not use the product near children who are allergic to manganese. Do not use the product near children who are allergic to zinc. Do not use the product near children who are allergic to copper. Do not use the product near children who are allergic to silver. Do not use the product near children who are allergic to gold. Do not use the product near children who are allergic to platinum. Do not use the product near children who are allergic to palladium. Do not use the product near children who are allergic to rhodium. Do not use the product near children who are allergic to iridium. Do not use the product near children who are allergic to osmium. Do not use the product near children who are allergic to tungsten. Do not use the product near children who are allergic to rhenium. Do not use the product near children who are allergic to niobium. Do not use the product near children who are allergic to molybdenum. Do not use the product near children who are allergic to vanadium. Do not use the product near children who are allergic to chromium. Do not use the product near children who are allergic to manganese. Do not use the product near children who are allergic to zinc. Do not use the product near children who are allergic to copper. Do not use the product near children who are allergic to silver. Do not use the product near children who are allergic to gold. Do not use the product near children who are allergic to platinum. Do not use the product near children who are allergic to palladium. Do not use the product near children who are allergic to rhodium. Do not use the product near children who are allergic to iridium. Do not use the product near children who are allergic to osmium. Do not use the product near children who are allergic to tungsten. Do not use the product near children who are allergic to rhenium. Do not use the product near children who are allergic to niobium. Do not use the product near children who are allergic to molybdenum. Do not use the product near children who are allergic to vanadium.

**SAVE THESE INSTRUCTIONS**

- Use and store the product in a temperature between 32°F and 104°F (0°C and 40°C).
- Do not use the product in an area where there is a risk of fire or explosion.
- Do not use the product in an area where there is a risk of lightning.
- Do not use the product in an area where there is a risk of flooding.
- Do not use the product in an area where there is a risk of falling objects.
- Do not use the product in an area where there is a risk of falling power lines.
- Do not use the product in an area where there is a risk of falling vehicles.
- Do not use the product in an area where there is a risk of falling aircraft.
- Do not use the product in an area where there is a risk of falling space debris.
- Do not use the product in an area where there is a risk of falling meteoroids.
- Do not use the product in an area where there is a risk of falling asteroids.
- Do not use the product in an area where there is a risk of falling comets.
- Do not use the product in an area where there is a risk of falling planets.
- Do not use the product in an area where there is a risk of falling stars.
- Do not use the product in an area where there is a risk of falling galaxies.
- Do not use the product in an area where there is a risk of falling universes.

## BASIC OPERATION - PARENT UNIT

**Adjust speaker volume**  
Press ① or ② to adjust your parent unit speaker volume.

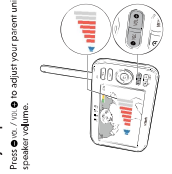

**Zoom**  
Press ③ to zoom in or out.

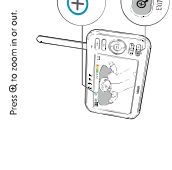

**Use the menu**  
Press ④ to enter the menu, choose a menu item, advanced setting or operation, such as to play or stop the baby unit lullaby, or to adjust the baby unit sound sensitivity.

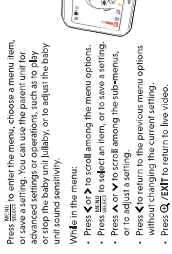

**Turn off the screen**  
Press and hold LCD ON/OFF to switch off the screen. You can still hear sound from the baby unit.

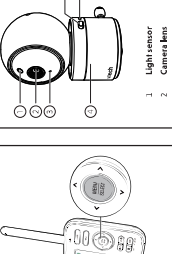

**Talk to your baby unit**  
Press and hold TALK and speak to your parent unit. Your voice is transmitted to the baby unit. Release TALK when you finish talking and hear your baby again.

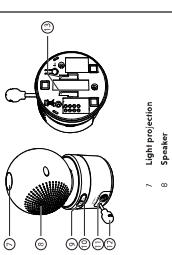

## WHAT'S IN THE BOX

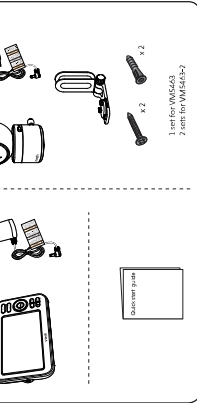

## CONNECT THE BATTERY UNIT

**NOTES**

- The rechargeable battery in the parent unit is built-in.
- Use only the power adapter supplied with this product.
- Connect the power adapter in a vertical or rear mount position only. The adapter prongs are not designed to be used in a horizontal or side mount position.
- Make sure the parent unit, the battery unit, and the power adapter cords are out of reach of children.

## POWER ON OR OFF THE BATTERY MONITOR

**1** Slide the switch to power on or off your baby unit.

**2** Press and hold POWER to power on or off your parent unit.

## STATUS CHECK

Once you power on both your baby unit and parent unit, your parent unit displays image from the baby unit, and the LINK LED light turns on.

The ON LED light of baby unit turns on.

## POSITIONING THE BABY MONITOR

**CAUTION**

- Do not put the parent unit in a place where the maximum volume is fixed. If you do so, you may cause hearing damage to your child. Make sure you baby unit and parent unit are placed in a safe place.
- Lower the volume of your parent unit.

**NOTE**

- To avoid interference from other electronic devices, please keep the parent unit away from devices such as wireless routers, microwaves, cell phones and computers.

## 5.0 FAQ

**Q: The baby unit is not working. What should I do?**

**A:** Check the power switch on the baby unit. Check the battery level of the parent unit. Check the connection of the power adapter. Check the connection of the antenna.

## PARENT UNIT ICONS

**Main menu**  
Adjust the parent unit's LCD brightness.

**Camera settings**  
Monitoring mode (For VMS606 only):  
• Single mode  
• Split mode  
• Patrol mode

**Lullaby**  
Baby unit speaker volume or parent unit speaker volume.  
Play/Stop lullaby:  
• Select one of the lullabies, or white noise, of the soothing sounds, or when the parent unit is in a lullaby.  
• Select one of the live melodies.

**Projection light**  
Turn on/off projection light when the baby unit is in a lullaby. You can set VOX sensitivity level to turn on/off projection light. You can set VOX sensitivity level to turn on/off projection light.

**Temperature**  
Turn on/off temperature alarm tone.  
Set the parent unit to beep whenever the baby unit talk outside of the set temperature range.  
Set the minimum temperature.  
Set the maximum temperature.

**Alert tones**  
Set the parent unit to beep when the battery is low.  
Set the parent unit to beep when the baby unit is in a lullaby.  
Set the confirmation tone on or off when selecting an option in the menu.  
Set the parent unit to beep when the baby unit detects a road while in Shift mode (For VMS606 only).

**Sound activation - screen and audio**  
Turn on/off sound activation.  
When it on, and the baby unit screen stays off to save power. Once a sound is detected, the parent unit screen and audio will be activated automatically, and you can see and hear your baby. The parent unit will no sound detection.

**VOX (Voice Activated Alarm) Sensitivity**  
You can set VOX sensitivity level to activate parent unit screen and sound when the baby unit talk outside of the set exceed certain level. See Sound sensitivity and sound activation section.

## PARENT UNIT ICONS

**Main menu**  
Adjust the parent unit's LCD brightness.

**Camera settings**  
Monitoring mode (For VMS606 only):  
• Single mode  
• Split mode  
• Patrol mode

**Lullaby**  
Baby unit speaker volume or parent unit speaker volume.  
Play/Stop lullaby:  
• Select one of the lullabies, or white noise, of the soothing sounds, or when the parent unit is in a lullaby.  
• Select one of the live melodies.

**Projection light**  
Turn on/off projection light when the baby unit is in a lullaby. You can set VOX sensitivity level to turn on/off projection light. You can set VOX sensitivity level to turn on/off projection light.

**Temperature**  
Turn on/off temperature alarm tone.  
Set the parent unit to beep whenever the baby unit talk outside of the set temperature range.  
Set the minimum temperature.  
Set the maximum temperature.

**Alert tones**  
Set the parent unit to beep when the battery is low.  
Set the parent unit to beep when the baby unit is in a lullaby.  
Set the confirmation tone on or off when selecting an option in the menu.  
Set the parent unit to beep when the baby unit detects a road while in Shift mode (For VMS606 only).

**Sound activation - screen and audio**  
Turn on/off sound activation.  
When it on, and the baby unit screen stays off to save power. Once a sound is detected, the parent unit screen and audio will be activated automatically, and you can see and hear your baby. The parent unit will no sound detection.

**VOX (Voice Activated Alarm) Sensitivity**  
You can set VOX sensitivity level to activate parent unit screen and sound when the baby unit talk outside of the set exceed certain level. See Sound sensitivity and sound activation section.

## OVERVIEW - BABY UNIT



## OVERVIEW - PARENT UNIT

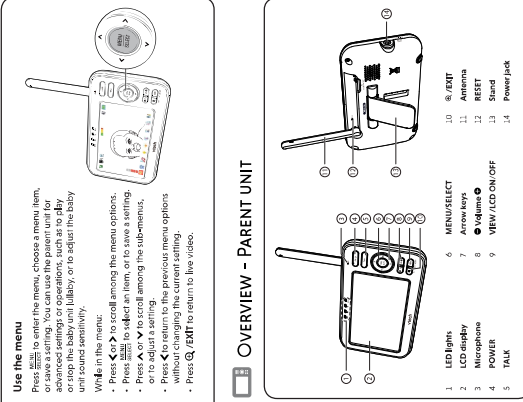

## OVERVIEW - PARENT UNIT

For operations and guides to help you using your video monitor, and for latest information and updates, go and check the online help topics and online FAQs. Use your smartphone or mobile device to access our online help.

Go to [www.vtechphones.com/vms463-CR](http://www.vtechphones.com/vms463-CR) to access our app on your smartphone or tablet. Hold the device camera up to the QR code in the online help topic. Tap the notification to trigger the redirection of the camera to the app.

If the QR codes are not clearly displayed, adjust your camera's focus by moving your device closer or further away until it is clear.

## STATUS ICONS

Connection status	Projection light - On
<ul style="list-style-type: none"> <li>🟢 Strong signal strength.</li> <li>🟡 Moderate signal.</li> <li>🔴 Weak signal strength.</li> <li>🟠 Low signal strength.</li> </ul>	<ul style="list-style-type: none"> <li>• Displays when parent unit's battery is low and needs charging.</li> <li>• Displays when connection between parent unit and baby unit is lost. (For VM54632 only)</li> <li>• Baby unit detects temperature reaches or exceeds the set maximum.</li> <li>• Baby unit detects temperature is at or lower than the set minimum.</li> </ul>
Spill mode	Real-time temperature
<ul style="list-style-type: none"> <li>• Displays when the parent unit is in spill mode. (For VM54632 only)</li> <li>• Displays when parent unit is not in spill mode. (For VM54632 only)</li> </ul>	<p>• Real-time temperature display (°F or °C)</p> <ul style="list-style-type: none"> <li>• Fahrenheit (°F): Celsius (°C) 0g.37°F for 24°C.</li> <li>• 9-level sound indicator</li> <li>• Indicates low sound level.</li> <li>• Indicates moderate sound level.</li> <li>• Indicates high sound level.</li> <li>• Indicates when parent unit is detected by the baby unit.</li> </ul>
Parent unit status	Mute alert
<ul style="list-style-type: none"> <li>• Single-CAM mode.</li> <li>• Spill-CAM or Parent mode.</li> <li>• Power level indicator.</li> <li>• Night vision - On</li> <li>• Zoom - On</li> <li>• Lullaby - On</li> <li>• Night Light - On</li> <li>• Night Light - Auto-on</li> <li>• Night Light - currently turned on by sound</li> <li>• Night Light - currently off by night</li> <li>• Night Light - currently off by power</li> <li>• Night Light - currently off by auto-on</li> <li>• Night Light - currently off by auto-on</li> </ul>	<ul style="list-style-type: none"> <li>• Displays when the parent unit is muted.</li> <li>• Displays when the parent unit is unmuted.</li> <li>• Displays when parent unit is in spill mode.</li> </ul>
Spill mode	Battery status
<ul style="list-style-type: none"> <li>• Displays when the parent unit is in spill mode.</li> <li>• Displays when parent unit is not in spill mode.</li> </ul>	<ul style="list-style-type: none"> <li>• when the battery is fully charged.</li> <li>• battery is fully charged.</li> <li>• battery is low and needs charging.</li> <li>• battery is very low and needs charging.</li> </ul>
Parent unit status	Parent unit speaker volume
<ul style="list-style-type: none"> <li>• Displays when parent unit is in spill mode.</li> <li>• Displays when parent unit is not in spill mode.</li> </ul>	<ul style="list-style-type: none"> <li>• Indicates when parent unit speaker volume is at or below the set minimum.</li> <li>• Indicates when parent unit speaker volume is at or above the set maximum.</li> </ul>

## STATUS ICONS (CONTD)

Alert icons	Projection Light
<ul style="list-style-type: none"> <li>• Displays when parent unit's battery is low and needs charging.</li> <li>• Displays when connection between parent unit and baby unit is lost. (For VM54632 only)</li> <li>• Baby unit detects temperature reaches or exceeds the set maximum.</li> <li>• Baby unit detects temperature is at or lower than the set minimum.</li> </ul>	<p>• Tip: The projection light focuses on the top of the baby unit, projects a sharp soft night light scene onto the ceiling with a 14-degree beam. Adjust your baby unit's position with the projection light to help warm your baby to sleep. For optimal performance, place the baby unit in upright position.</p> <p>Optimal position</p>
Parent unit status	Mute alert
<ul style="list-style-type: none"> <li>• Displays when parent unit is in spill mode.</li> <li>• Displays when parent unit is not in spill mode.</li> </ul>	<ul style="list-style-type: none"> <li>• Displays when the parent unit is muted.</li> <li>• Displays when the parent unit is unmuted.</li> <li>• Displays when parent unit is in spill mode.</li> </ul>
Parent unit status	Battery status
<ul style="list-style-type: none"> <li>• when the battery is fully charged.</li> <li>• battery is fully charged.</li> <li>• battery is low and needs charging.</li> <li>• battery is very low and needs charging.</li> </ul>	<ul style="list-style-type: none"> <li>• when the battery is fully charged.</li> <li>• battery is fully charged.</li> <li>• battery is low and needs charging.</li> <li>• battery is very low and needs charging.</li> </ul>
Parent unit status	Parent unit speaker volume
<ul style="list-style-type: none"> <li>• Indicates when parent unit speaker volume is at or below the set minimum.</li> <li>• Indicates when parent unit speaker volume is at or above the set maximum.</li> </ul>	<ul style="list-style-type: none"> <li>• Indicates when parent unit speaker volume is at or below the set minimum.</li> <li>• Indicates when parent unit speaker volume is at or above the set maximum.</li> </ul>

## ADJUST SOUND DETECTION SENSITIVITY

You can turn on sound activation and adjust the VOX sensitivity to detect sounds and sounds when the baby unit detects sounds that screen will turn on or off. The baby unit starts transmitting the sounds to the parent unit, and the parent unit starts transmitting the sounds to the parent unit, and the parent unit starts transmitting the sounds to the parent unit, and the parent unit starts transmitting the sounds to the parent unit.

Levels (High)	Levels (Medium)	Levels (Low)
<ul style="list-style-type: none"> <li>• The parent unit screen turns on for 30 seconds when you hear any sound.</li> <li>• The parent unit screen turns on for 30 seconds when you hear any sound.</li> <li>• The parent unit screen turns on for 30 seconds when you hear any sound.</li> </ul>	<ul style="list-style-type: none"> <li>• The parent unit screen turns on for 30 seconds when you hear any sound.</li> <li>• The parent unit screen turns on for 30 seconds when you hear any sound.</li> <li>• The parent unit screen turns on for 30 seconds when you hear any sound.</li> </ul>	<ul style="list-style-type: none"> <li>• The parent unit screen turns on for 30 seconds when you hear any sound.</li> <li>• The parent unit screen turns on for 30 seconds when you hear any sound.</li> <li>• The parent unit screen turns on for 30 seconds when you hear any sound.</li> </ul>

## SOUND SENSITIVITY AND SOUND ACTIVATION

When sound activation is on, the parent unit screen stays off to save power when the baby unit detects no sound. The parent unit starts transmitting the sounds to the parent unit, and the parent unit starts transmitting the sounds to the parent unit, and the parent unit starts transmitting the sounds to the parent unit, and the parent unit starts transmitting the sounds to the parent unit.

Levels (High)	Levels (Medium)	Levels (Low)
<ul style="list-style-type: none"> <li>• The parent unit screen turns on for 30 seconds when you hear any sound.</li> <li>• The parent unit screen turns on for 30 seconds when you hear any sound.</li> <li>• The parent unit screen turns on for 30 seconds when you hear any sound.</li> </ul>	<ul style="list-style-type: none"> <li>• The parent unit screen turns on for 30 seconds when you hear any sound.</li> <li>• The parent unit screen turns on for 30 seconds when you hear any sound.</li> <li>• The parent unit screen turns on for 30 seconds when you hear any sound.</li> </ul>	<ul style="list-style-type: none"> <li>• The parent unit screen turns on for 30 seconds when you hear any sound.</li> <li>• The parent unit screen turns on for 30 seconds when you hear any sound.</li> <li>• The parent unit screen turns on for 30 seconds when you hear any sound.</li> </ul>

## SOUND ACTIVATED SCREEN AND AUDIO

When sound activation is on, the parent unit screen stays off to save power when the baby unit detects no sound. The parent unit starts transmitting the sounds to the parent unit, and the parent unit starts transmitting the sounds to the parent unit, and the parent unit starts transmitting the sounds to the parent unit, and the parent unit starts transmitting the sounds to the parent unit.

Levels (High)	Levels (Medium)	Levels (Low)
<ul style="list-style-type: none"> <li>• The parent unit screen turns on for 30 seconds when you hear any sound.</li> <li>• The parent unit screen turns on for 30 seconds when you hear any sound.</li> <li>• The parent unit screen turns on for 30 seconds when you hear any sound.</li> </ul>	<ul style="list-style-type: none"> <li>• The parent unit screen turns on for 30 seconds when you hear any sound.</li> <li>• The parent unit screen turns on for 30 seconds when you hear any sound.</li> <li>• The parent unit screen turns on for 30 seconds when you hear any sound.</li> </ul>	<ul style="list-style-type: none"> <li>• The parent unit screen turns on for 30 seconds when you hear any sound.</li> <li>• The parent unit screen turns on for 30 seconds when you hear any sound.</li> <li>• The parent unit screen turns on for 30 seconds when you hear any sound.</li> </ul>

## SOUND SENSITIVITY AND SOUND ACTIVATION (CONTD)

When sound activation is on, the parent unit screen stays off to save power when the baby unit detects no sound. The parent unit starts transmitting the sounds to the parent unit, and the parent unit starts transmitting the sounds to the parent unit, and the parent unit starts transmitting the sounds to the parent unit, and the parent unit starts transmitting the sounds to the parent unit.

Levels (High)	Levels (Medium)	Levels (Low)
<ul style="list-style-type: none"> <li>• The parent unit screen turns on for 30 seconds when you hear any sound.</li> <li>• The parent unit screen turns on for 30 seconds when you hear any sound.</li> <li>• The parent unit screen turns on for 30 seconds when you hear any sound.</li> </ul>	<ul style="list-style-type: none"> <li>• The parent unit screen turns on for 30 seconds when you hear any sound.</li> <li>• The parent unit screen turns on for 30 seconds when you hear any sound.</li> <li>• The parent unit screen turns on for 30 seconds when you hear any sound.</li> </ul>	<ul style="list-style-type: none"> <li>• The parent unit screen turns on for 30 seconds when you hear any sound.</li> <li>• The parent unit screen turns on for 30 seconds when you hear any sound.</li> <li>• The parent unit screen turns on for 30 seconds when you hear any sound.</li> </ul>

## NIGHT VISION

The baby unit's built-in LED light allows you to see your baby in a dark room. When the baby unit is in a dark room, the parent unit screen turns on, and the parent unit screen turns on, and the parent unit screen turns on, and the parent unit screen turns on.

• It is normal if you see a red light on the baby unit screen when the baby unit is in a dark room.

• The parent unit screen turns on for 30 seconds when you hear any sound.

• The parent unit screen turns on for 30 seconds when you hear any sound.

• The parent unit screen turns on for 30 seconds when you hear any sound.

• The parent unit screen turns on for 30 seconds when you hear any sound.

• The parent unit screen turns on for 30 seconds when you hear any sound.

## DIM MODE

The parent unit display will dim to conserve energy after 10 minutes of inactivity, in which there is neither key pressed nor alert received from the baby unit.

Press any buttons

## 10 MIN INACTIVITY

Press any buttons

## 10 MIN INACTIVITY

Press any buttons

## MOUNT THE BABY UNIT ON DRY WALL (OPTIONAL)

Place the wall mount bracket on a wall and then use a pencil to mark the holes in the wall. Then use a drill to drill holes in the wall. Then use the wall mount bracket and drill into the holes in the wall. Then use the wall mount bracket and drill into the holes in the wall.

- Place the wall mount bracket on a wall and then use a pencil to mark the holes in the wall. Then use a drill to drill holes in the wall. Then use the wall mount bracket and drill into the holes in the wall. Then use the wall mount bracket and drill into the holes in the wall.
- Place the screws into the wall mount bracket and then use a screwdriver to tighten the screws into the wall. Then use the wall mount bracket and drill into the holes in the wall. Then use the wall mount bracket and drill into the holes in the wall.
- Place the screws into the wall mount bracket and then use a screwdriver to tighten the screws into the wall. Then use the wall mount bracket and drill into the holes in the wall. Then use the wall mount bracket and drill into the holes in the wall.
- Place the screws into the wall mount bracket and then use a screwdriver to tighten the screws into the wall. Then use the wall mount bracket and drill into the holes in the wall. Then use the wall mount bracket and drill into the holes in the wall.

Notes:
 

- Check for maximum weight and height.
- The weight of the baby unit will need to be supported by the wall.
- The weight of the baby unit will need to be supported by the wall.
- The weight of the baby unit will need to be supported by the wall.

## FOR C-UL COMPLIANCE ONLY

The RBRC® seal is a certification mark that indicates that a product meets the requirements of the RBRC program. The RBRC program provides a convenient alternative to plugging into a wall outlet. The RBRC seal is a certification mark that indicates that a product meets the requirements of the RBRC program.

Notes:
 

- The RBRC seal is a certification mark that indicates that a product meets the requirements of the RBRC program.
- The RBRC seal is a certification mark that indicates that a product meets the requirements of the RBRC program.
- The RBRC seal is a certification mark that indicates that a product meets the requirements of the RBRC program.

## LIMITED WARRANTY

The manufacturer of this product warrants to the original purchaser for a limited period of time. The manufacturer of this product warrants to the original purchaser for a limited period of time. The manufacturer of this product warrants to the original purchaser for a limited period of time.

- The manufacturer of this product warrants to the original purchaser for a limited period of time.
- The manufacturer of this product warrants to the original purchaser for a limited period of time.
- The manufacturer of this product warrants to the original purchaser for a limited period of time.
- The manufacturer of this product warrants to the original purchaser for a limited period of time.

## FOR VM54632-2 ONLY

Change different views - Single CAM

Change different views - Patrol

Change different views - Spill

Notes:
 

- Press VIEW to switch between views.
- Press VIEW to switch between views.
- Press VIEW to switch between views.

## FOR VM54632-2 ONLY

Change different views - Single CAM

Change different views - Patrol

Change different views - Spill

Notes:
 

- Press VIEW to switch between views.
- Press VIEW to switch between views.
- Press VIEW to switch between views.