

Go to www.vtechphones.com to register your product for enhanced warranty support and the latest Vtech product news.

VM3252
VM3252-2
Video Monitor



For more support information



vtech
Quick start guide

<p>© 2022 Vtech Communications, Inc. All rights reserved. Specifications are subject to change without notice. The Major Retailer found first was created by Amazon.com, and is used under the Creative Commons license. The Minor Retailer found first was created by Amazon.com, and is used under the Creative Commons license. The Background Noise sound file was created by Amazon.com, and is used under the Creative Commons license.</p>	
Colors	Parent unit Battery: 3.0V Ni-MH battery (Built-in)
Power requirements	1. Recharge: 5.0VDC 500mA 2. Input: 5.0VDC 500mA 3. Output: 5.0VDC 500mA
Normal effective range	Maximum power: 0.5W Maximum power: 0.5W Maximum power: 0.5W
Maximum power	Maximum power: 0.5W Maximum power: 0.5W Maximum power: 0.5W
LCD	2.8" Color LCD (VM3252) 3.2" Color LCD (VM3252-2)
Connectors	3.5mm Audio Jack
Dimensions	Parent unit: 240.5 x 145.5 x 75.5 mm Parent unit: 240.5 x 145.5 x 75.5 mm
Frequency control	Cross-compatible with parent unit

BASIC OPERATION - PARENT UNIT

Adjust speaker volume
Press **VOL+** / **VOL-** to adjust your parent unit speaker volume.

The sound sensitivity setting also affects the speaker volume. For details, refer to **Sound sensitivity and sound activation**.

Zoom
Press **Q** to zoom in or out.

Use the menu
Press **MENU** to enter the menu, or save a setting. You can use the parent unit for advanced settings or operations, such as to play or stop the baby unit lullaby, or to adjust the baby unit sound sensitivity.

While in the menu:

- Press **←** or **→** to scroll among the menu options.
- Press **SELECT** or **A** to enter the desired submenu.
- Press **A** or **Y** to select an item.
- Press **SELECT** to confirm your selection.
- Press **→** or **→** to exit the submenu.

Talk to your baby unit
Press and hold **TALK** and speak to your parent unit. Your voice is transmitted to the baby unit. Release **TALK** when finish talking and hear your baby unit again.

Turn off the screen
Press and hold **LCD ON/OFF** to switch off the screen. You can still hear sound from the selected baby unit.

Tip
Press any keys on the parent unit to turn on the screen again.

IMPORTANT SAFETY INSTRUCTIONS

- The applied magnetism is located at the bottom of the baby unit base.
- When using your equipment, basic safety precautions should be followed to reduce the risk of fire, electric shock and injury, including the following:
- Read all warnings and instructions marked on the product.
 - Adult supervision is required.
 - CAUTION:** Do not install the baby unit at a height above 1.8m.
 - This product is not intended for adult supervision of the infant. Supervising the infant is the parent's or caregiver's responsibility. This product could cause operating, and therefore you should not assume that wall mounting is safe.
 - Do not use this product near water. For example, do not use it near a bathtub, swimming pool, kitchen sink, laundry tub or swimming pool, or in a wet basement or shower.
 - CAUTION:** Use only the battery provided. There may be a risk of explosion if a wrong type of battery is used for the parent unit. The battery cannot be recharged by any means. Do not attempt to recharge the battery at high altitude during use, storage or transportation. Dispose of battery into fire or hot oven, or mechanically cutting or cutting or the battery can result in an explosion. Leaving the battery in the parent unit for long periods of time may result in an explosion or the leakage of flammable liquid or gas. Battery subjected to excessive heat may result in an explosion or the leakage of flammable liquid or gas. Dispose of used battery according to the information on the **BATTERY** tag.
 - Use only the adapters included with this product. Incorrect adapter polarity or voltage can seriously damage the product.
 - Do not use liquid or aerosol cleaners. Use a damp cloth for cleaning.
 - Do not cut off the power adapters to replace it with other parts, as this causes a hazardous situation.
 - Do not allow anything to rest on the power cord. Do not remove the power cord where the cord may be walked on or tripped.
 - This product should be operated only from the type of power source indicated on the marking label. If you are not sure of the type of power source in your home, consult your dealer or local power company.
 - Do not connect wall outlets or use an extension cord.
 - Do not place this product on an unstable table, shelf, stand or other unstable surface.
 - This product should not be placed in any area where the temperature is below 0°C (32°F) and above 40°C (104°F). To protect them from overheating, those openings must not be blocked by placing the product on soft surface such as a bed, sofa or rug. This product should never be placed near or over a radiator or heat register.
 - Never put small objects of any kind into this product. Never put small objects of any kind into the product through the ports or create a short circuit.
38. To reduce the risk of electric shock, do not touch the product with wet hands or use it in an unapproved service facility. Opening or removing parts of the product that are not specified by the manufacturer may expose you to dangerous voltage or other risks. Incorrect reassembly can cause electric shock.

39. You should test the sound reception every time you use the unit or move one of the components.

40. Periodically examine all components for damage.

41. This is a very low risk of primary fire when using certain electric devices, such as baby monitors, cordless telephones, etc. To protect your privacy, make sure the product has never been used before purchase, reset the baby monitor periodically by powering off and then powering on the units, and do not use the product if you will not use it for some time.

42. Children should be supervised to ensure that they do not play with the product.

43. The product is not intended for use by persons including children with reduced physical, sensory or mental capabilities, or lack of experience and knowledge, unless they have been given supervision or instruction concerning use of the appliance by a person responsible for their safety.

WHAT'S IN THE BOX

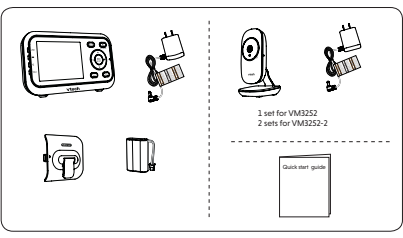

1 CONNECT THE BABY MONITOR

Install the battery
The parent unit runs on rechargeable battery or AC power. To continuously monitor your baby, make sure you use both battery and AC power at the same time. With the battery alone, the parent unit can cordlessly run for a short time only.

Replace the battery
To replace the battery, press down on the battery compartment cover and pull it out, then follow the steps above to install the battery.

Precautions for users of implanted cardiac pacemakers
Cardiac pacemakers (applies only to digital cordless devices):
 Wireless Technology Research, LLC (WTR), an independent research entity, led a multidisciplinary evaluation of the potential for interference between cordless devices and implanted cardiac pacemakers. Supported by the U.S. Food and Drug Administration, WTR recommends to users of implanted cardiac pacemakers:
 • **Pacemaker patients**
 - Should keep wireless devices at least six inches from the pacemaker.
 - Should NOT place wireless devices directly over the pacemaker, such as in a breast pocket, when it is turned on.
 WTR's evaluation did not identify any risk to bystanders with pacemakers from other parents using wireless devices.
Electromagnetic fields (EMF)
 The Manufacturer complies with all standards regarding electromagnetic fields (EMF). If handled properly and according to the instructions in this user manual, the product is safe to be used based on scientific evidence available today.

CONNECT THE BABY MONITOR

NOTES

- Use only the power adapters supplied with this product.
- Make sure the baby monitor is not connected to the switch controlled electric outlet.
- Connect the power adapters in a vertical or floor mount position only. The adapters' prongs are not designed to hold the weight of baby monitor, so do not connect them to any ceiling, under-table, or cabinet outlets. Otherwise, the adapters may not properly connect to the outlets.
- Make sure the parent unit, the baby unit and the power adapter cords are out of reach of children.

Charge the parent unit battery
When you have connected and turned on the parent unit, the battery will be charged automatically.

NOTES

- Before using the baby monitor for the first time, charge the parent unit battery for 12 hours. When the parent unit battery is fully charged, the battery icon becomes solid.
- It takes longer to charge the battery when the parent unit is turned on. To shorten the charging time, turn the parent unit off while charging.
- The standby time varies depending on the sensitivity level you set, your actual use and the age of the battery.

2 POWER ON OR OFF THE BABY MONITOR

1 Slide the **ON/OFF** switch to power on or off your baby unit.

2 Press and hold **Q** to power on or off your parent unit.

Replace the battery
To replace the battery, press down on the battery compartment cover and pull it out, then follow the steps above to install the battery.

3 POSITIONING THE BABY MONITOR

1 Position the baby unit at a distance of 3m (10ft) or more from the parent unit.

2 Position the baby unit at a distance of 3m (10ft) or more from the parent unit.

CAUTION

- The default volume of your parent unit is level 3. If you experience high-pitched screaming noise from your baby monitor while positioning:
 - Make sure your baby unit and parent unit are more than 1 meter (3 feet) apart, OR
 - Turn down the volume of your parent unit.

NOTE

- To avoid interference from other electronic devices, place your baby monitor at least 3 feet (1 meter) away from devices such as wireless routers, microwaves, cell phones and computers.

4 STATUS CHECK

Once you power on both your baby unit and parent unit, your parent unit displays image from the baby unit, and the **LINK** LED light turns on.

The **POWER LED** light of baby unit turns on.

OVERVIEW - BABY UNIT

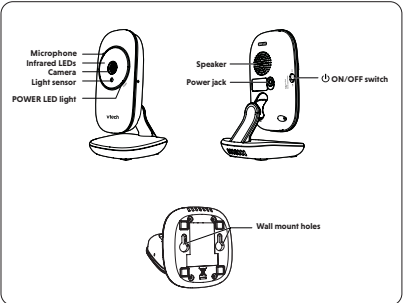

NEED HELP?

For operators and guides to help you using your video monitor, and for latest information and supports, go and check the online help topics and online FAQs.

Use your smartphone or mobile device to access our online help.

- Go to <https://help.vtechphones.com/vm3252> or <https://help.vtechphones.com/vm3252-2>
- OR
- Scan the QR code on the right. Launch the camera app or QR code scanner app on your smartphone or tablet. Hold the device's camera up to the QR code and frame it. Tap the notification to trigger the redirection of the online help.
- If the QR code is not clearly displayed, adjust your camera's focus by moving your device closer or further away until it is clear.

You can also call our Customer Support at 1 (800) 595-9511 (in US) or 1 (800) 261-7377 (in Canada) for help.

PARENT UNIT ICONS

Status icons

Yell
Connection status
 • Yell or Yell displays when strong signal strength is detected between the baby unit and the parent unit.
 • Ye or Ye displays when moderate or low signal strength is detected between the baby unit and the parent unit.

Patrol mode
 • Displays when the parent unit is in **PATROL** mode.
 • For VM3252-2 only

Current view status
 • Displays the baby unit number of the baby unit that is being viewed.

Zoom
 • Displays when the current image on the parent unit has zoomed in.

Night vision
 • Displays when the baby unit being viewed has activated the night vision feature.

Lullaby
 • Displays when a lullaby is playing.

Talkback
 • Displays when talking back to the baby units from parent unit.

6-level sound indicator
 Displays the sound level according to the scales of loudness when there is sound transmitted from the baby unit.
 • || (1 to 2 bars) indicates low sound level detected by the baby unit.
 • ||| (3 to 4 bars) indicates moderate sound level detected by the baby unit.
 • |||| (5 to 6 bars) indicates high sound level detected by the baby unit (e.g. baby crying loudly).

Mute alert
 • Displays when the parent unit speaker volume is set to zero.
 • Displays when the parent unit is talking to the baby unit.

Real-time temperature
 • Displays when the parent unit is talking to the baby unit.

Battery status
 • Animates when the battery is charging.
 • Displays solid when the battery is fully charged.
 • Displays when the battery is low and needs charging.

AC power without battery
 • Displays when the parent unit is connected to AC power without the battery.

Speaker volume
 • Displays the parent unit speaker volume level while adjusting.

Main menu icons

Brightness
 • You can change the brightness of the parent unit screen.

LCD screen off timer
 • You can set a specific time to screen off your parent unit.

Temperature
 • You can choose to set the maximum/minimum temperature and turn on the temperature alert tone so that the parent unit beeps whenever the room temperature detected by the baby unit falls outside of the desired temperature range.
 • You can also choose to display the temperature in Fahrenheit (°F) or Celsius (°C) on your parent unit.

Sound-activated screen
 • When the baby unit being viewed detects no sound, the parent unit screen stays off to save power. Once a sound is detected, the parent unit screen turns on automatically. It will then turn off again after 50 seconds of no sound detection.

VOX sensitivity
 • With this feature, you can choose to hear sounds from the baby unit all the time, or to hear sounds that exceed a certain level. You can use the parent unit to adjust the microphone sensitivity of your baby unit. The higher the sensitivity level, the more sensitive the baby unit is in detecting sounds for transmitting to the parent unit.

Lullaby
 • You can select, play, or stop a lullaby.

Patrol mode
 • You can monitor your baby in **PATROL** mode.
 • For VM3252-2 only

Warning icons and messages

Battery low at Parent Unit
 • The battery is empty and needs to be recharged.
 Operation is in progress.

Temperature too high
 • The temperature detected by the baby unit is higher than the desired temperature alert range.

Temperature too low
 • The temperature detected by the baby unit is lower than the desired temperature alert range.

No Link to Camera
 • The parent unit is searching for baby units or the link between the baby unit and the parent unit is lost.
 • The parent unit is connected to AC power.

