

■ Front side

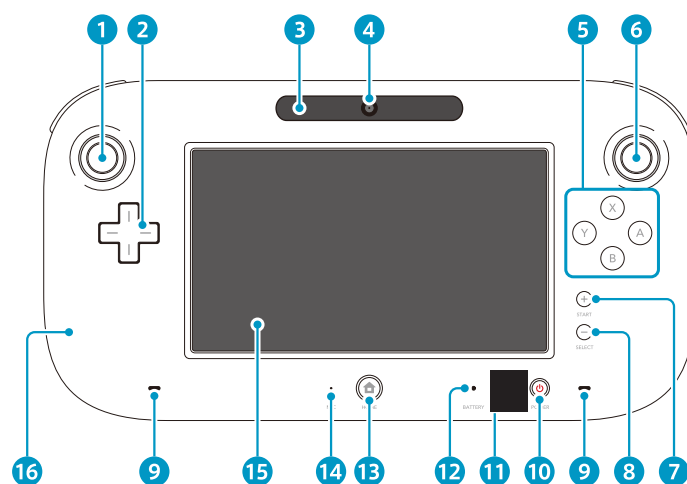

1 L Control Stick (L Stick Button*)

*Works when pressing the L Control Stick in.

2 + Control Pad

3 Sensor Bar

Detects the movement of Wii Remote.

4 Camera

5 A / B / X / Y Button

6 R Control Stick (R Stick Button*)

*Works when pressing the L Control Stick in.

7 + / START Button

8 - / SELECT Button

9 Speaker (L · R)

10 POWER Button

Press to turn the console ON or OFF (→Page XX).

11

12 Battery LED

It shows the status of battery charging and remaining power of the battery (→Page XX).

● (Light in orange) : Charging

● (Light in red) : Battery power is low

● (Blinking in red) : Battery power is very low

13 HOME button

Shows Ⓜ menu (HOME button menu) that can setup this Controller or Wii Remote, or see electronic manual (→ electronic manual "Ⓜ menu").

Lights in blue when you receive notices or informations from your friend. Lights will turn off when pressing Ⓜ.

14 Microphone**15 Touch screen****16 NFC****How to use the touch screen****Touch**

Touch the screen softly.

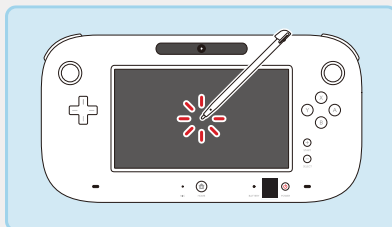
**Slide**

Move while touching the screen.

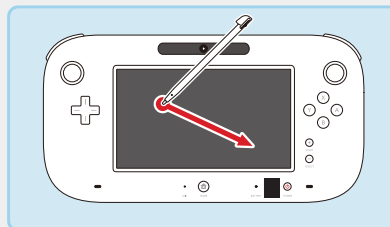

* If the touch screen does not work correctly, adjust the touch screen on hardware settings (→Page XX). If you cannot operate correctly on the menu, use + Control Pad and A.



■ Above side

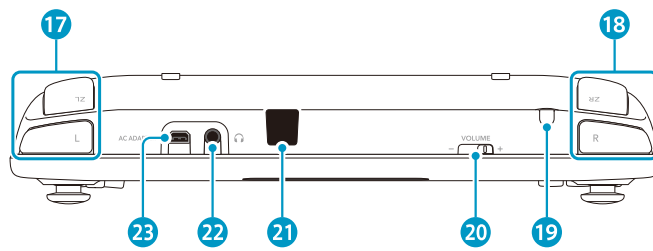

■ Back side

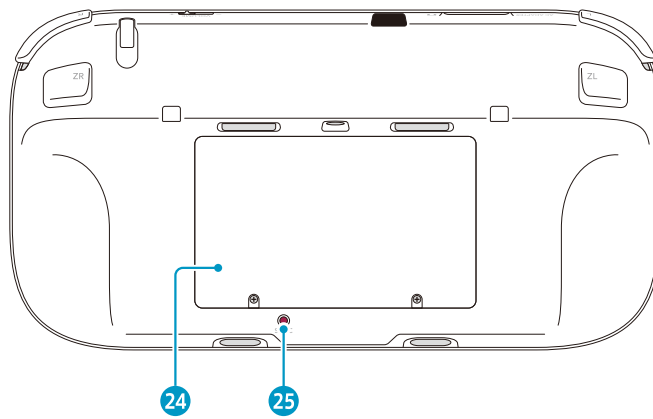

■ Bottom side

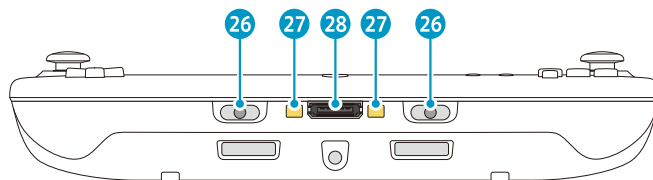

17 L / ZL button

18 R / ZR button

19 Stylus holder

Put the attached stylus in.

20 Volume

Slide to adjust the volume of this Controller.

21 Infrared transceiver

Sends and receives information when using infrared communication.

22 Audio jack

For connection of stereo headphones. If headphones are connected, no sound will play through the speakers.

23 AC adapter connector

Allows connection to the AC adapter for this controller.

24 Battery cover

Battery is installed inside.

* Do not remove the cover unless you need to replace the battery.

25 SYNCRO Button (SYNC)

Used when synchronizing with the console.

* This Controller included on the hardware set is already synchronized.

26 Cradle holder (tentative)

Place the controller on the top of the charging cradle(*), and it will click into place.

27 Charging connector

Charging will start when the controller touches the charging connector on the charging cradle(*).

28 External extension connector

Allows you to connect external extension equipment for this controller.

Turning the power ON/OFF

Turn the power ON/OFF by using the console or the controller. After turning the power ON, select the account and the menu will show up. (tentative)

* Power can be turned ON/OFF by the other accessories (Wii Remote or the grip controller) that is synchronized to the console.

Turn the power ON

Turn the power ON by using ⏻ of the controller

When pressing ⏻, power will be ON and the screen of the controller will be displayed.

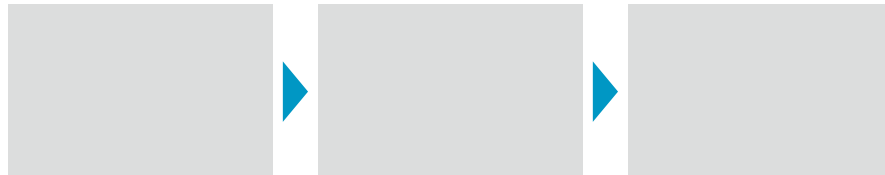

Turn the power ON by using ⏻ of the console

When pressing ⏻ on the console, power will be turned ON and the screen of this controller will be displayed, same as in the ⏻ of this controller.

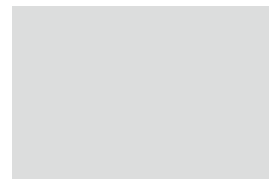

Energy-saving mode

Depending on the images that is displayed, brightness and the colors are automatically adjusted, and the battery will last longer (→ the electronic manual "⏻ menu")

* When purchasing, this feature is turned OFF.

Turning the power OFF

When turning OFF using the controller, press  for approximately one second. When the power is turned OFF, battery LED on the console will light in red.



* Even though the power is turned OFF, battery LED will not be switched off.

Automatic power-OFF feature

When nothing is operated while certain time, console will be turned OFF when this feature is ON (→ menu "Automatic power-OFF" on "Hardware settings").

* When purchasing, this feature is turned OFF.

Display OFF

When the controller screen is not used, screen can be turned OFF and save the battery (→  electronic manual "  menu")

FCC Compliance Statements

Caution:

Any changes or modifications not expressly approved by the party responsible for product compliance could void the user's authority to operate the equipment.

This device must not be co-located or operating in conjunction with any other antenna or transmitter.

This device complies with part 15 of the FCC rules. Operation is subject to the following two conditions: (1) this device may not cause harmful interference, and (2) this device must accept any interference received, including interference that may cause undesired operation.

This equipment has been tested and found to comply with the limits for a Class B digital device, pursuant to part 15 of the FCC Rules. These limits are designed to provide reasonable protection against harmful interference in a residential installation. This equipment generates, uses and can radiate radio frequency energy and, if not installed and used in accordance with the instructions, may cause harmful interference to radio communications. However, there is no guarantee that interference will not occur in a particular installation. If this equipment does cause harmful interference to radio or television reception, which can be determined by turning the equipment off and on, the user is encouraged to try to correct the interference by one or more of the following measures:

- Reorient or relocate the receiving antenna.
- Increase the separation between the equipment and receiver.
- Connect the equipment into an outlet on a circuit different from that to which the receiver is connected.
- Consult the dealer or an experienced radio/TV technician for help

Canadian Compliance Statement

Complies with the Canadian ICES-003 Class B specifications. Cet appareil numérique de la Classe B est conforme à la norme NMB-003 du Canada.

This device complies with RSS 210 of Industry Canada.

Operation is subject to the following two conditions:

(1) This device may not cause interference, and (2) This device must accept any interference, including interference that may cause undesired operation of this device.

(1) il ne doit pas produire de brouillage et

(2) l' utilisateur du dispositif doit être prêt à accepter tout brouillage radioélectrique reçu, même si ce brouillage est susceptible de compromettre le fonctionnement du dispositif.

To reduce potential radio interference to other users, the antenna type and its gain should be so chosen that the equivalent isotropic radiated power (EIRP) is not more than that required for successful communication.

Wireless Radio Use

This device is operated in 5180~5240MHz (indoor only) and 5745~5825MHz.