

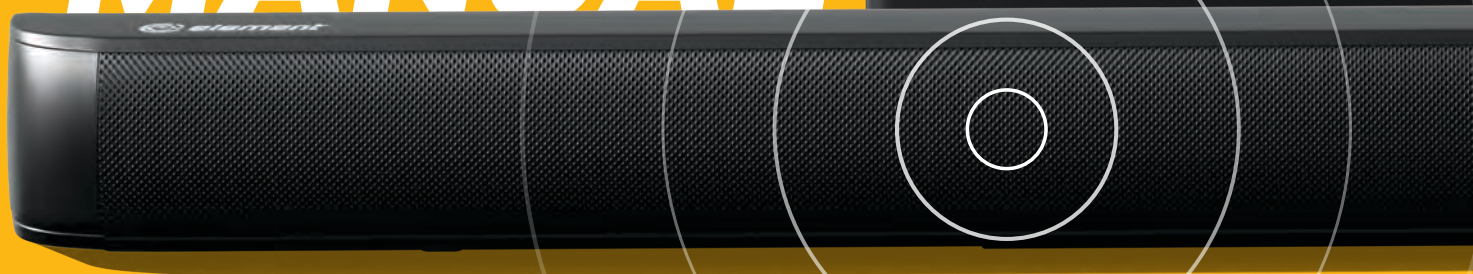

ESBAB21RTR
2.1 Sound Bar

USER **MANUAL**



WHAT'S INCLUDED

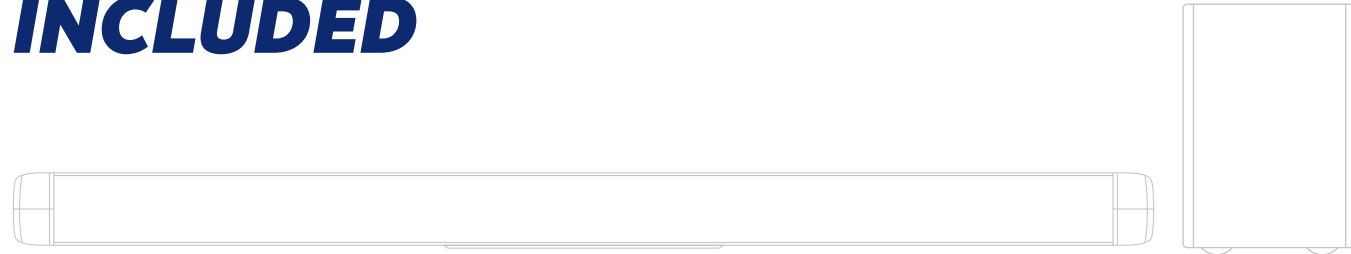

Your new sound bar & subwoofer!

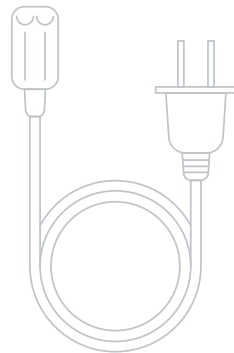

Power cable x 2



HDMI cable



Remote

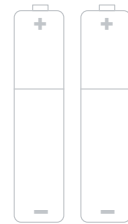

**2 AAA
remote batteries**

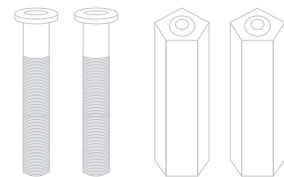

**2 mounting screws
and 2 wall plugs**

FOR YOUR ATTENTION

- Please read through this manual before making connections and operating this product. Retain this manual for future reference.
- Do not open the cabinet of this unit. No user-serviceable parts inside. Refer servicing to qualified personnel only.
- Switch off the unit when not in use. Switch off the unit and disconnect it from the AC power supply when not in use for an extended period of time.
- Do not install the unit in a place exposed to heating sources or direct sunshine.
- Do not install the unit in a place exposed to moisture or rain.
- The apparatus shall not be exposed to dripping or splashing and any object filled with liquids, such as vases shall not be placed on it.
- Install the unit on a horizontal, flat and firm surface with good ventilation. Never block the vents which will cause malfunction, resulting from overheating.
- Use a soft and clean rag to clean the outside of the unit. Never clean it with chemicals or detergent.
- This book is only a guide for user's operation, not a criterion for configuration.
- Only use attachments/accessories specified by the manufacturer.
- Where the main plug is used as the disconnect device, the disconnect device shall remain readily operable.

WARNING: The batteries shall not be exposed to excessive heat such as sunshine, fire or the like.

CAUTION: Danger of explosion if battery is incorrectly replaced. Replace only with the same or equivalent type.



The lightning flash is intended to alert the user to the presence of dangerous voltage within the product's enclosure, and touching the internal components may result in a risk of electric shock to persons.



The exclamatory mark is intended to alert the user to the presence of important operating instructions.



To reduce the risk of electric shock or fire, do not open the cover. Refer servicing to qualified service personnel.

MOUNTING YOUR SOUND BAR ON A WALL

In order to prevent injuries, the sound bar device must be fastened securely to the wall in accordance with the below installation instructions.

Drill two holes into the wall (about 6mm diameter).
Keep the distance between drill holes 660mm apart.
Insert the two supplied plugs into the holes, then insert the supplied screws and tighten.

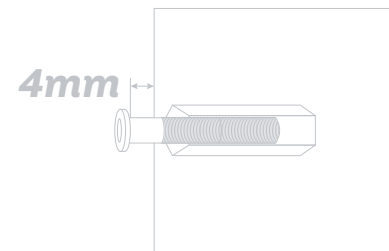
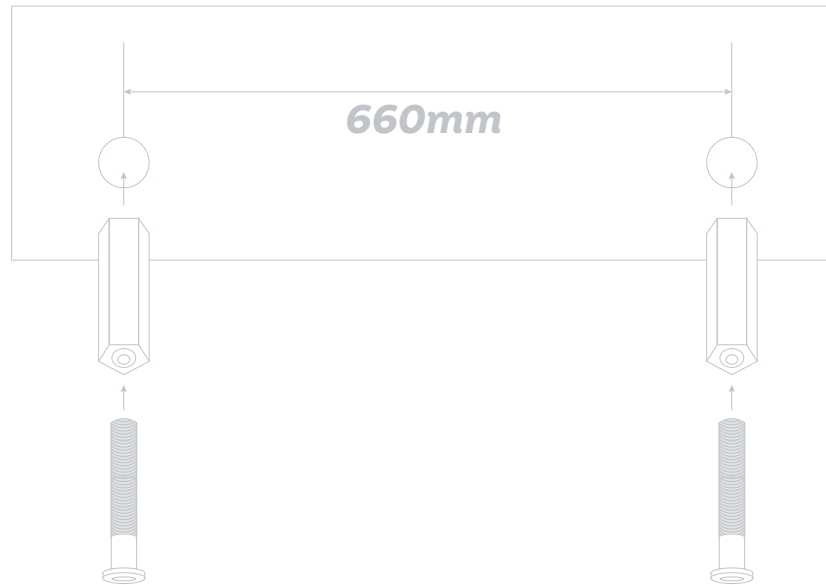

Leave 4mm distance between the screw heads and the wall.

MOUNTING YOUR SOUND BAR ON A WALL

(continued)

Hang the assembled sound bar on the screws in the wall.

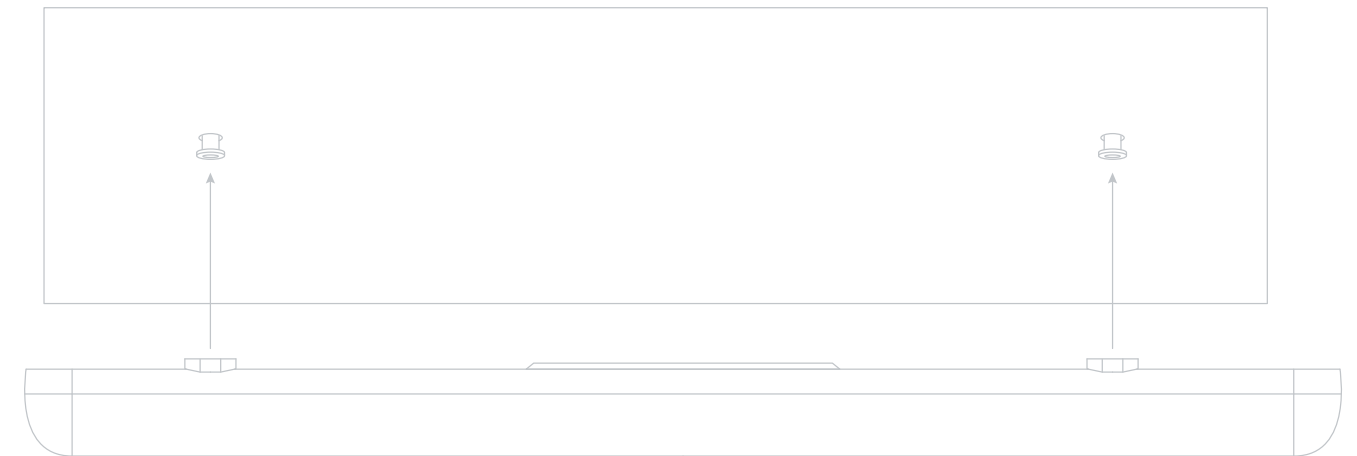

SOUND BAR PANELS

Front

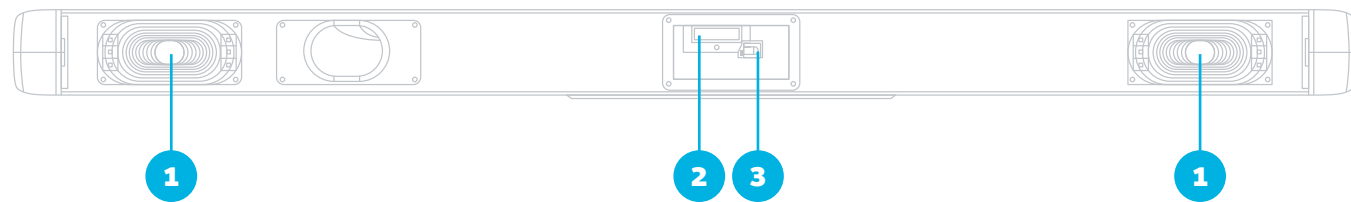

- 1 **Speaker**
- 2 **Display screen**
- 3 **Remote sensor**
- 4 **Power** Turn sound bar on or off
- 5 **Source** Select input audio source
- 6 **Volume Up** Turn up audio volume
- 7 **Volume Down** Turn down audio volume

Side

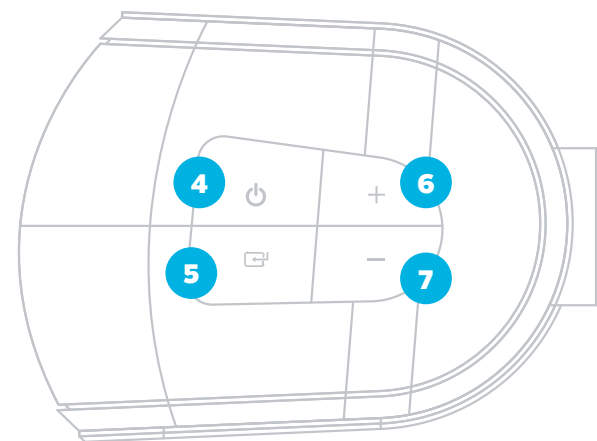

SOUND BAR PANELS

(continued)

Back



- 8 **AC IN**
- 9 **HDMI (ARC)**
- 10 **USB**
- 11 **OPTICAL**
- 12 **AUX IN**

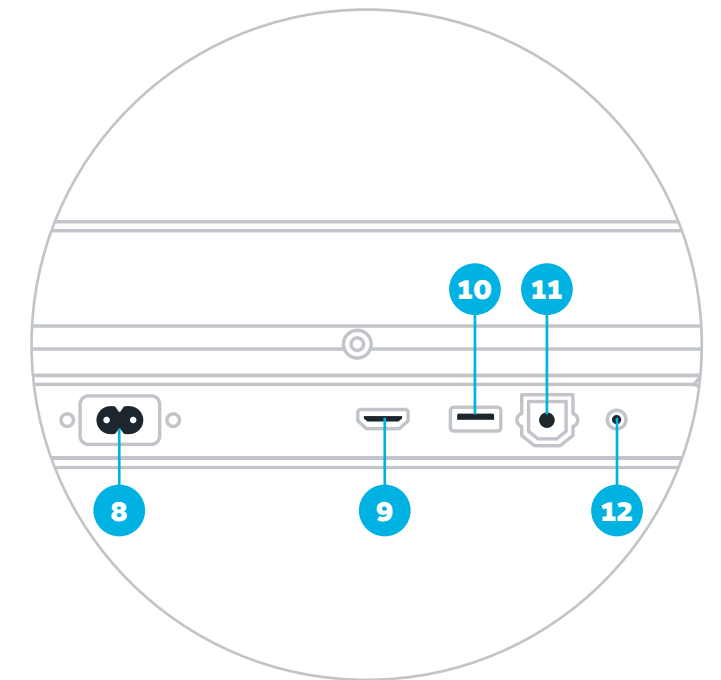

CONNECT TO YOUR TV

There are 3 ways to connect your sound bar to the TV:

- 1 **HDMI (ARC)** Best Quality (cable included)
- 2 **Optical** Better Quality (cable not included)
- 3 **Aux** Good Quality (cable not included)

ARC (AUDIO RETURN CHANNEL)

ARC is an audio return channel function for digital audio which will give you the best sound quality. Use the supplied HDMI cable to connect to the HDMI ARC input of your sound bar and the HDMI ARC output on your TV or other external device.

Note: The external device audio output must be set to PCM.

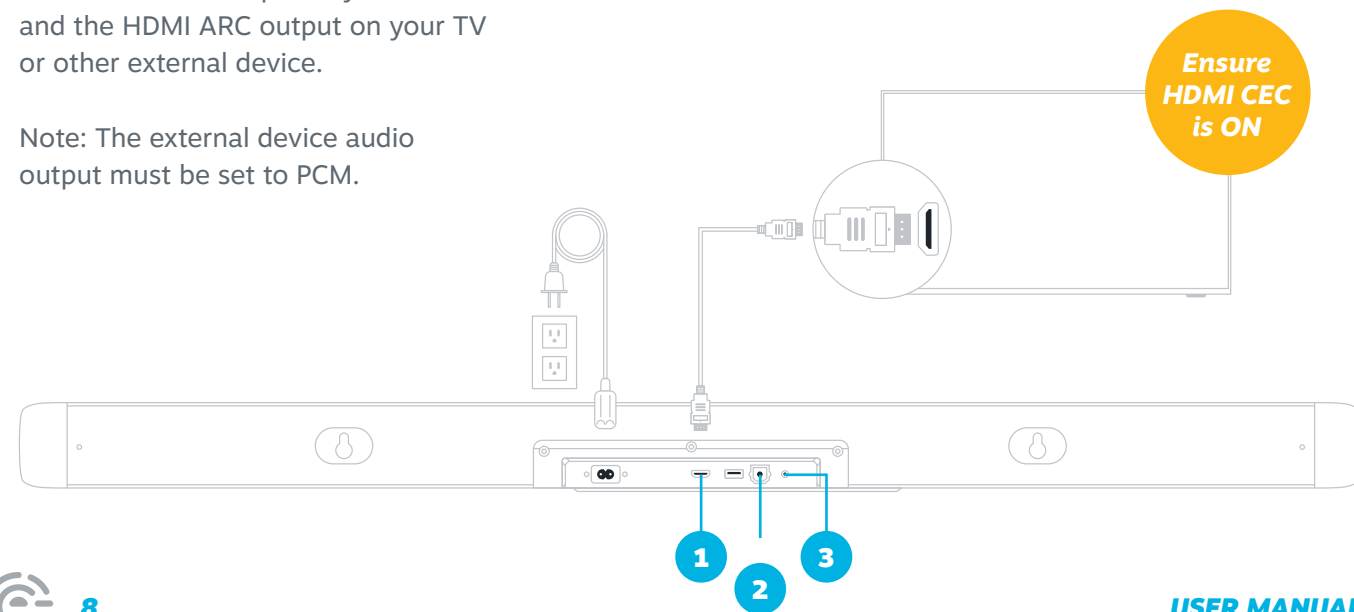

Roku TV Ready

- ✓ Simple setup
- ✓ One remote
- ✓ Quick settings

This sound bar is Roku TV Ready™ certified. If you have a Roku TV™, simply connect the supplied HDMI cable to your sound bar and TV and follow the onscreen instructions for simple setup.

CONNECTIONS

Optical

Connect your sound bar to your TV or other external devices such as a CD, VCR, DVD player, etc. by connecting an optical input cable (cable not included) to your sound bar and the optical output of your external device.

Press **SRC** button on the remote control to switch to the optical input mode. The word **OPT** will show on the display screen which means optical mode is selected.

Note: The external device audio output must be set to PCM.



AUX IN

This sound bar has an extra group of audio input terminals.

Connect your sound bar to your TV or other external devices such as a CD, VCR, DVD player, etc. by connecting an AUX input cable (cable not included) to your sound bar and the AUX output of your external device.

Press **SRC** button on the remote control to switch to the AUX input mode. The word **LINE** will show on the display screen which means optical mode is selected.



CONNECTIONS

Bluetooth

Press **STANDBY** button on the remote control to power on the sound bar, then press **SRC** button on the remote control to switch the Bluetooth mode. The word **BT** will be shown on the display screen.

If after several seconds you do not see **BT** on the screen, the sound bar is still searching for a signal and you can follow these steps:

Pairing a device or connecting a paired device:

1. Press and hold the  button on the remote control. Use your smart device to search for the Bluetooth signal of the sound bar.
2. Select **ESBAB21RTR** on your list and input the password 0000 if there is a password prompt.
3. The sound bar will then sync to play from your device. When the word **bt** appears and a beep is heard, it means you are connected successfully.

Disconnecting a device:

Press and hold the  button on the remote control. When it successfully disconnects the screen will show no **bt**.



TIP: Bluetooth connection range is 10 meters.

In Bluetooth mode, [PLAY/PAUSE], [NEXT], [PREVIOUS], [VOLUME+/-] etc. are also active.

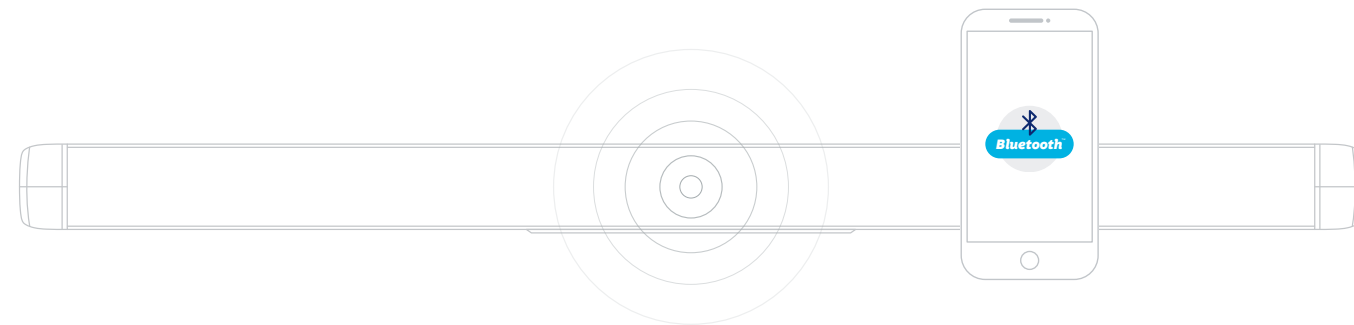

CONNECTIONS

(Continued)

Connecting the subwoofer to the soundbar:

The subwoofer will receive the wireless audio signal from the sound bar. When the indicator light is flashing RED, the subwoofer is searching for the wireless signal. When the indicator light turns solid BLUE, it means the subwoofer and sound bar are now connected.

TIP: During the connection of the sound bar and subwoofer, users should not press the **PAIR** button on the subwoofer or it will cause them to disconnect.

Press and hold the **SOURCE** button on the sound bar to disconnect it and the indicator light will flash RED on the subwoofer. Press and hold the **SOURCE** button again and the sound bar will reconnect with the subwoofer, and the indicator light will turn solid BLUE.

If the sound bar and subwoofer do not connect automatically you can follow these steps:

1. Press the **PAIR** button on the subwoofer to reset it and the red indicator light will flash quickly (twice per second).
2. In LINE mode, press the **POWER** button on the sound bar for 5 seconds to reset it, and the sound bar will enter standby. Press the **POWER** button to power on and the sound bar will automatically pair and connect to the subwoofer.

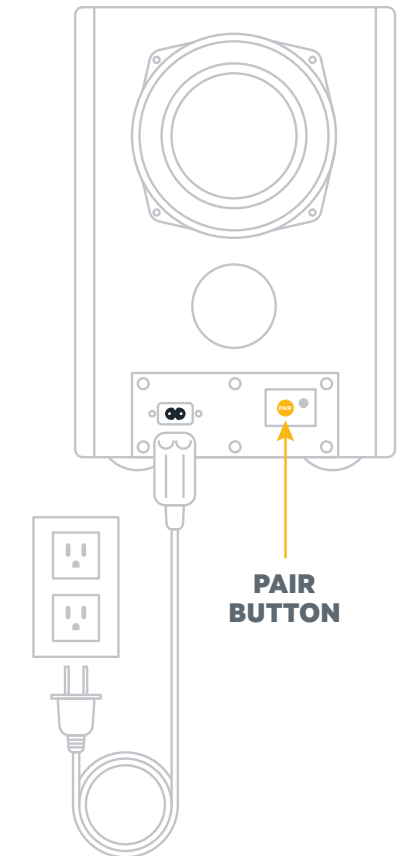

REMOTE CONTROL

Remote Control Operation

Insert the battery into the remote control. Point the remote control at the remote sensor on the front panel. The remote control works within a distance of about 8 meters from the sensor and within an angle of about 30 degrees from the left and right side.

Battery Installation

Remove the battery compartment cover on the back of the remote.

Load two AAA/1.5V batteries into the battery compartment making sure that the battery has been inserted with the correct polarities matching the symbols +, - as indicated inside the battery compartment.

Replace the cover.

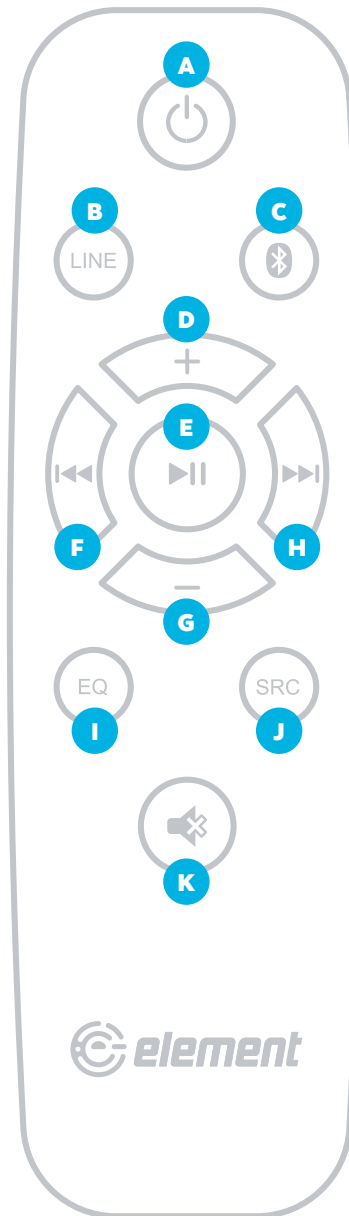

- A** Power
- B** Line
- C** Bluetooth
- D** Volume Up
- E** Play/Pause
- F** Previous
- G** Volume Down
- H** Next
- I** EQ
- J** Audio Source
- K** Mute

BASIC PLAYBACK



Press to switch on the unit. Press it again to put the unit in standby mode.



Press to enter the BT (Bluetooth) mode. Hold down this button for 3 seconds to disconnect Bluetooth.



Press repeatedly to switch between Bluetooth, AUX IN, USB, OPTICAL IN and ARC mode.



Press repeatedly to switch between EQ1, EQ2 and EQ3 equalizer modes. EQ1 stands for MUSIC, EQ2 stands for MOVIE and EQ3 stands for NEWS.



Press to enter the AUX IN mode.



Press to temporarily pause a playback. Press it again to resume the playback.



Press to skip to the next track.



Press to return to the previous track.



Press to temporarily switch off the sound. Press it again to switch it on.



Press [VOLUME+] to turn up the volume.



Press [VOLUME-] to turn down the volume.

TROUBLESHOOTING

Use the chart below to troubleshoot any issues you may be having. If you do not see your issue listed below, or the troubleshooting guide does not solve your issue, please contact Element customer support.

SYMPTOM	CAUSE	REMEDY
No Power	The AC power cord is not connected to the power supply or is not connected to a power supply securely.	Please check that the AC power cord is connected securely.
There is no sound or the sound is distorted.	<ul style="list-style-type: none"> The audio cables aren't connected securely. The volume is set to the minimum level. The sound is switched off. 	<ul style="list-style-type: none"> Connect the audio cables securely. Turn up the volume. Press [MUTE] on the remote control to switch on the sound. Press [PLAY/PAUSE]
The remote control does not function.	<ul style="list-style-type: none"> There is no battery in the remote control. The battery is out of charge. The remote control isn't pointed to the remote sensor. The remote control is out of its operating area. The unit is shut down. 	<ul style="list-style-type: none"> Install two AAA/1.5V batteries in it. Replace the battery with new one. Make sure that the remote control is pointed to the remote control sensor. Make sure the remote control is within the operating area. Switch off the unit and disconnect it from the AC outlet, then power on the unit again.

SOUND BAR SPECIFICATIONS

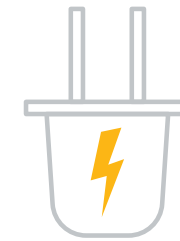

SOUND BAR AND SUBWOOFER POWER SUPPLY
AC ~100-240V, 50/60Hz

WORKING ENVIRONMENT



RELATIVE HUMIDITY
5% ~ 90%



TEMPERATURE
14°F - 95°F

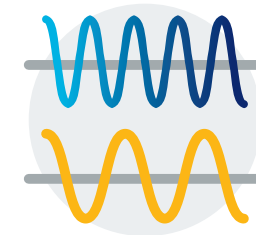

FREQUENCY RESPONSE
60Hz~20kHz



SOUNDBAR MAX POWER OUTPUT
25W X 2



SUBWOOFER MAX POWER OUTPUT
50W

REFERENCES

Element TV Company, LP. bears no responsibility for data and/or information that is compromised during a wireless transmission.

Frequency band

- This system uses the 2.4 GHz frequency band.

Certification

- This system conforms to the frequency restrictions and has received certification based on frequency laws. Thus, a wireless permit is not Necessary.
- The actions below are punishable by law in some countries:
 - Taking apart or modifying the unit.
 - Removing specification indications.

Restrictions of use

- Wireless transmission and/or usage with all Bluetooth equipped devices is not guaranteed.
- All devices must conform to standards set by the Bluetooth SIG, Inc.
- Depending on the specifications and settings of a device, it can fail to connect or some operations can be different.
- This system supports Bluetooth security features. But depending on the operating environment and/or settings, this security is possibly not sufficient. Transmit data wirelessly to this system with caution.
- This system cannot transmit data to a Bluetooth device.

Range of use

- Use this device at a maximum range of 10 m.
- The range can decrease depending on the environment, obstacles or interference.

Interference from other devices

- This system may not function properly and troubles such as noise and sound jumps may arise due to radio wave interference if this unit is located too close to other Bluetooth devices or the devices that use the 2.4 GHz band.
- This system may not function properly if radio waves from a nearby broadcasting station, etc. is too strong.

Intended usage

- This system is for normal, general use only.
- Do not use this system near equipment or in an environment that is sensitive to radio frequency interference (example: airports, hospitals, laboratories, etc.).



LICENSE

The Bluetooth® word mark and logos are registered trademarks owned by Bluetooth SIG, Inc. and any use of such marks by Element TV Company, LP. is under license. Other trademarks and trade names are those of their respective Owners.

The terms HDMI, HDMI High-Definition Multimedia Interface, and the HDMI Logo are trademarks or registered trademarks of HDMI Licensing Administrator, Inc.

Roku TV, Roku TV Ready, and the Roku TV Ready logo are trademarks of Roku, Inc.

Type of wireless	Frequency band
Bluetooth® (main unit)	2402 – 2480 MHz

FCC STATEMENT

1. This device complies with Part 15 of the FCC Rules. Operation is subject to the following two conditions:
 - (1) This device may not cause harmful interference, and
 - (2) This device must accept any interference received, including interference that may cause undesired operation.
2. Changes or modifications not expressly approved by the party responsible for compliance could void the user's authority to operate the equipment.

NOTE: This equipment has been tested and found to comply with the limits for a Class B digital device, pursuant to Part 15 of the FCC Rules. These limits are designed to provide reasonable protection against harmful interference in a residential installation.

This equipment generates uses and can radiate radio frequency energy and, if not installed and used in accordance with the instructions, may cause harmful interference to radio communications. However, there is no guarantee that interference will not occur in a particular installation. If this equipment does cause harmful interference to radio or television reception, which can be determined by turning the equipment off and on, the user is encouraged to try to correct the interference by one or more of the following measures:

- Reorient or relocate the receiving antenna.
 - Increase the separation between the equipment and receiver.
 - Connect the equipment into an outlet on a circuit different from that to which the receiver is connected.
- Consult the dealer or an experienced radio/TV technician for help.

RADIATION EXPOSURE STATEMENT

This equipment complies with FCC/IC radiation exposure limits set forth for an uncontrolled environment. This equipment should be installed and operated with minimum distance 20cm between the radiator & your body.

LET'S REGISTER YOUR PRODUCT



It's super easy, just head on over to elementelectronics.com/register

BENEFITS OF REGISTERING YOUR PRODUCT:



Support

Get assistance quickly by pre-registering your product.



News & Offers

Take advantage of the latest news and special offers from Element.



Updates

Stay current with important product updates and notifications.

WE'RE HERE TO HELP

Find resources and get help for product setup, connecting devices, technical issues, downloading manuals and more!

We're available 24 hours a day, 7 days a week



elementelectronics.com



1.888.842.3577



customerservice@elementelectronics.com



