

The logo for Crosley, featuring the word "CROSLEY" in a bold, sans-serif font with a registered trademark symbol (®) to the upper right. The letters are stylized with horizontal lines passing through them.

CROSLEY®

A large, light gray graphic element on the left side of the page, consisting of a vertical rectangle with a curved right edge that tapers towards the bottom right corner.

CR3502A-BK
USER MANUAL
CD MICRO SYSTEM

Contents

Features	2
For your Attention.....	3
Panel.....	4
Connections.....	5
Remote Control.....	6-7
Basic Playback.....	8-10
Trouble shooting.....	11
Specifications.....	12

Features

Thanks for your purchase of our product. Please read through this manual before making connections and operating this product. Retain this manual for future reference.

- Compatible with CD,MP3,CD-R,CD-RW,etc.
- With AUX IN socket .
- With bluetooth function .
- Full function remote control.
- FM stereo radio tuner.

Note: The player is not compatible with all disc;

Some of the disc could not read, caused by the disc is dirty,disc of poor quality, etc.

Package Contents:

User manual



AC adaptor



Remote control



FM antenna



Battery



For Your Attention

IMPORTANT NOTES:

- Please read through this manual before making connections and operating this product. Retain this manual for future reference.
 - Don't open the cabinet of this unit. No user-serviceable parts inside. Refer servicing to qualified personnel only.
 - Switch off the unit when you don't use it. Switch off the unit and disconnect it from the AC power supply when it is not being used for a long time.
 - Don't install the unit in a place exposed to heating sources or direct sunshine.
 - Don't install the unit in a place exposed to moisture or rain.
 - The apparatus shall not be exposed to dripping or splashing and any object filled with liquids, such as vases shall not be placed on it.
 - Install the unit on a horizontal, flat and firm surface with good ventilation. Never block the vents which will cause malfunction resulted from overheating.
 - Use a soft and clean rag to clean the outside of the unit . Never clean it with chemicals or detergent.
 - This book is only a guide for user's operation, not a criterion for configuration.
 - Only use attachments/accessories specified by the manufacturer.
 - Where the Mains plug is used as the disconnect device, the disconnect device shall remain readily operable.
- WARNING: The batteries shall not be exposed to excessive heat such as sunshine, fire or the like.
CAUTION: Danger of explosion if battery is incorrectly replaced. Replace only with the same or equivalent type.



The lightning flash is intended to alert the user to the presence of dangerous voltage within the product's enclosure, and touching the internal components may result in a risk of electric shock to persons.



The exclamation mark is intended to alert the user to the presence of important operating instructions.



To reduce the risk of electric shock or fire, do not open the cover. Refer servicing to qualified service personnel.

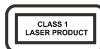

This mark indicates this unit belongs to class 1 laser product. The laser beam may produce radiation harm to the directly touching human body.

Panel

FRONT PANEL:

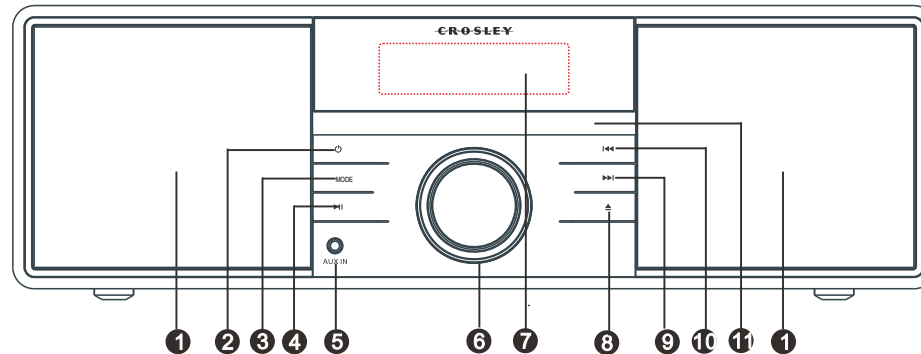

- 1 SPEAKER
- 2 STANDBY
- 3 MODE
- 4 PLAY/PAUSE
- 5 AUX IN
- 6 VOLUME ADJUSTER
- 7 DISPLAY SCREEN
- 8 OPEN/CLOSE
- 9 NEXT
- 10 PREVIOUS
- 11 DISC TRAY

REAR PANEL:

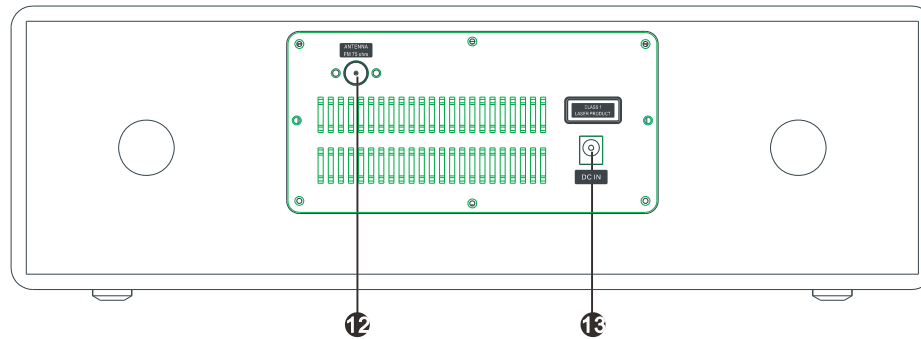

Connections

BLUETOOTH CONNECTION

The model of the player is CROSLEY CR3502A, press [SOURCE] button to switch to the corresponding signal source, " BT " on the display screen flashing status is in searching bluetooth signal status ,use your smart phone to search the bluetooth signal of the player, then input the password 0000 if necessary, at this time, " BT " will keep steady status displays on the display screen and the player will synchronize to play songs on your smart phone while they connected successfully. Disconnect the bluetooth on the smart phone to switch off the bluetooth connect.

The bluetooth is connected to your smart phone successfully for the first time, disconnect the bluetooth on your smart phone then reconnected it, the player will memories your smart phone and repaired automatically. Press [PLAY/PAUSE] to resume the playback.

NOTE: In bluetooth mode, [PLAY/PAUSE], [MUTE], [NEXT] and [PREVIOUS] buttons are also active.

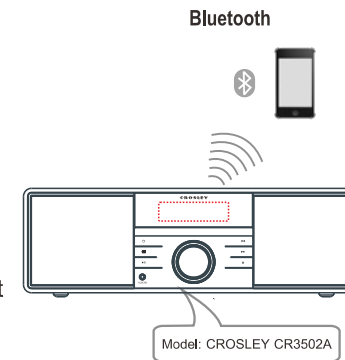

AUX IN

This unit has an extra group of audio input terminal. You can input the analogue stereo audio signals from extra devices such as VCD, CD, VCR, MP3 player, etc.

Use the audio cable to connect the stereo audio output terminals of a VCD, CD, VCR player to the input terminal (AUX IN) of this unit. Its corresponding signal source is **AUX IN** which can be available by pressing [SOURCE] on the remote control.

Remote control

Remote Control Operation

Insert the batteries into the remote control. Point the remote control at the remote sensor on the front panel. The remote control works within a distance of about 8 metres from the sensor and within an angle of about 30 degrees from the left and right side.

Battery Installation

- 1 Remove the battery compartment cover on the back of the remote control.
- 2 Load one AAA/1.5V battery into the battery compartment making sure that the battery have been inserted with the correct polarities matching the symbols +, - as indicated inside the battery compartment.
- 3 Replace the cover.

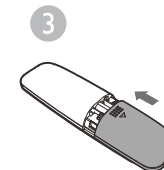
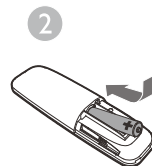
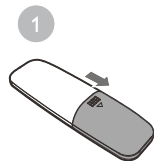

Note:

- Remove the battery when you do not intend to use the remote control for a long time.
- Weak battery can leak and severely damage the remote control.
- The battery must not be exposed to excessive heat source, such as sunshine, fire or any other things like that.
- Be environmentally friendly and dispose of batteries according to your government regulations.

Remote Control

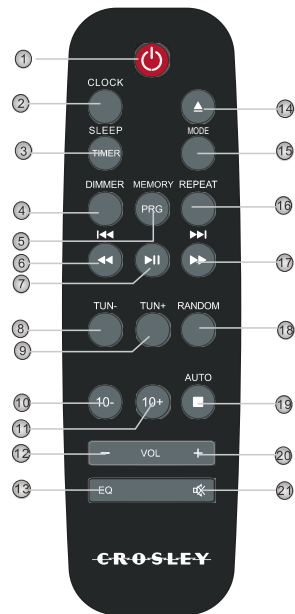

1 STANDBY
2 CLOCK
3 SLEEP
4 DIMMER
5 PROG/MEMORY
6 FAST REWIND/
PREVIOUS
7 PLAY/PAUSE
8 TUN-
9 TUN+
10 10-
11 10+
12 VOLUME-
13 EQ

14 OPEN/CLOSE
15 MODE
16 REPEAT
17 FAST FORWARD/NEXT
18 RANDOM
19 STOP/AUTO
20 VOLUME+
21 MUTE

Basic Playback

CD Operation

STANDBY



- Press to switch on the unit. Press it again to put the unit in standby mode.

OPEN/CLOSE



- Press to open or close the disc tray.

DIMMER



- Press repeatedly to adjust the display brightness of the display screen.

SLEEP



- Press repeatedly to select a sleep time and choose option **SLEEP OFF** to disable the sleep function , after which the unit will go into standby mode automatically. Then press [STANDBY] to wake it up.
- In standby mode,hold down this button enter into alarm set mode,then use[◀◀]/[▶▶] button to set the alarm time,press it again to confirm it.

MODE



- Press repeatedly to switch among CD,AUX IN,BLUETOOTH and FM TUNER mode.

STOP



- Press to stop a playback .



- Press to temporarily pause a playback. Press it again to resume the playback.
- Hold down this button for 3 seconds to disconnect bluetooth.



- Press to skip to the next chapter/track.



- Hold down for fast forward playback .













- Press to return to the previous chapter/track.

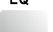

- Hold down for fast rewind playback .

Basic Playback

-
- VOL+**
 ● Press [VOLUME+] to turn up the volume.
- VOL-**
 ● Press [VOLUME-] to turn down the volume.
- PROGRAM**
 ● In stop mode, place a CD and press [PROGRAM] to access to the program mode. Press the arrows [◀] / [▶] to select the desired track and press once again [PROGRAM] to confirm your selection. Press [▶] to start program playback.
- MUTE**
 ● Press to temporarily switch off the sound . Press it again to switch it on.
- RANDOM**
 ● Press to switch the random play mode.
- REPEAT**
 ● Press repeatedly to switch the repeat modes.
- 10+**
 ● Press this button for each time to increase ten tracks.
- 10-**
 ● Press this button for each time to decrease ten tracks.
- EQ**
 ● Press to switch the equalizer modes.
- CLOCK**
 ● In standby mode, press and hold this button enter into clock set mode, press [◀] / [▶] button to select 12H or 24H clock display ,press clock button to confirm, then use [◀] / [▶] button to set the clock time, press it again to confirm it.
Note:it only available in standby mode.
● in play mode,press this button to display clock ,about after 5 seconds return to previous play information display.
-

Basic Playback

Tuner Operation

The following buttons are used in tuner mode. Press [FM] to select tuner mode.



TUN+/-

- TUN+: press to fine tune (increase) the frequency;
- TUN-: press to fine tune (decrease) the frequency.
- Hold down [TUN+/-] to increase/decrease the frequency continuously.



AUTO

- Hold down to do auto scanning for the broadcasting radio channels, press it again to stop auto scanning.



MEMORY

- After tuning in a new frequency, press [MEMORY] then select a preferred station by pressing arrows [◀]/[▶], press [MEMORY] again to confirm and save it as a preset station.



- Press to skip to the next preset station.



- Press to skip to the previous preset station.

NOTE: In Tuner mode, [VOLUME+/-], [MUTE] buttons are also active. For details, please refer to the introduction of the **CD operation** in this chapter.

Troubleshooting

Before resorting to maintenance service, please kindly check by yourself with the following chart.

Symptom	Cause(s)	Remedy
No Power	<ul style="list-style-type: none"> ● The AC power adaptor is not connected to the power supply or is not connected to a power supply securely. 	<ul style="list-style-type: none"> ● Please check that the AC power adaptor is connected securely.
Sound There is no sound or the sound is distorted.	<ul style="list-style-type: none"> ● The audio cables aren't connected securely. ● The volume is set to the minimum level. ● The sound is switched off. 	<ul style="list-style-type: none"> ● Connect the audio cables securely. ● Turn up the volume. ● Press [MUTE] on the remote control to switch on the sound. ● Press [PLAY/PAUSE].
Unable to play a disc	<ul style="list-style-type: none"> ● This disc is placed in the disc tray in a wrong way ● The unit isn't compatible with the disc. ● The disc is dirty. 	<ul style="list-style-type: none"> ● Check that the disc is placed in the disc tray with its label side upwards. ● / ● Clean the disc.
The buttons on the unit doesn't work.	<ul style="list-style-type: none"> ● The unit is being interfered with static electricity etc. 	<ul style="list-style-type: none"> ● Switch off and unplug the unit. Then connect the plug to the power supply and switch it on again.
The remote control does not function.	<ul style="list-style-type: none"> ● There is no battery in the remote control. ● The batteries are out of charge. ● The remote control isn't pointed to the remote sensor. ● The remote control is out of its operating area. ● The unit is shut down. 	<ul style="list-style-type: none"> ● Install one AAA/1.5V battery in it. ● Replace the batteries with new ones. ● Make sure that the remote control is pointed to the remote control sensor. ● Make sure the remote control is within the operating area. ● Switch off the unit and disconnect it from the AC outlet. Then power on the unit again

Specifications

Power supply		AC ~100-240V,50/60Hz DC IN 12V , 1.5A
Working environment	Temperature	-10~+35℃
	Relative humidity	5%~90%
Disc output	Frequency Response	20Hz~20kHz
	S/N(A weight)	> 80dB(1kHz)
	Frequency Range	≥70dB(1kHz)
	THD+NOISE	≤ -60dB(1kHz)
	WOW FLUTTER	Below the limit of apparatus measure
Tuner	FM band Range	87.5MHz~108MHz
Power output (Max)		8WX2
Frequency response		± 3dB(20Hz~20kHz)

FCC STATEMENT

1. This device complies with Part 15 of the FCC Rules. Operation is subject to the following two conditions:

(1) This device may not cause harmful interference, and

(2) This device must accept any interference received, including interference that may cause undesired operation.

2. any Changes or modifications not expressly approved by the party responsible for compliance could void the user's authority to operate the equipment.

NOTE: This equipment has been tested and found to comply with the limits for a Class B digital device, pursuant to Part 15 of the FCC Rules. These limits are designed to provide reasonable protection against harmful interference in a residential installation.

This equipment generates uses and can radiate radio frequency energy and, if not installed and used in accordance with the instructions, may cause harmful interference to radio communications. However, there is no guarantee that interference will not occur in a particular installation. If this equipment does cause harmful interference to radio or television reception, which can be determined by turning the equipment off and on, the user is encouraged to try to correct the interference by one or more of the following measures:

Reorient or relocate the receiving antenna.

Increase the separation between the equipment and receiver.

Connect the equipment into an outlet on a circuit different from that to which the receiver is connected.

Consult the dealer or an experienced radio/TV technician for help.

FCC Radiation Exposure Statement

This equipment complies with FCC radiation exposure limits set forth for an uncontrolled environment. This equipment should be installed and operated with minimum distance 20cm between the radiator & your body

