

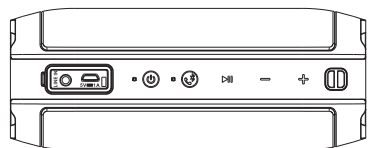

USER MANUAL



ATGTA6625

BLUETOOTH SPEAKER

FEATURES

Thanks for your purchase of our product. Please read through this manual before making connections and operating this product. Retain this manual for future reference.

- Bluetooth playback
 - LINE input
 - Power supply: DC-5V
- Note: ●Use DC adapter or USB terminal to charge battery no matter the speaker power on or off.
- In low battery status, the speaker will emit **Battery Low** voice prompt and it will switch off automatically if no charged in low battery status.
 - Power consumption: 6W
 - Speaker max output: 7WX2

ACCESSORY

- User manual
- USB cable

PRECAUTION

- Do not drop any objects into the unit through the openings.
 - Do not spill or spray liquid of any kind on or in the unit. It may result in a fire or electric shock.
 - Do not place anything heavy on the unit.
 - To ensure proper ventilation and proper operation, never cover or block the slots and opening with a cloth or other materials.
 - Keep the unit away from an open flame such as fire, candle, etc.
 - Install the batteries correctly.
 - Please dispose the batteries according to the local rule and law.
 - The maximum working temperature is 35 degrees Celsius.
 - Only use attachments/accessories specified by the manufacturer.
 - Where the Mains plug is used as the disconnect device, the disconnect device shall remain readily operable.
 - Rating label are on the bottom of the unit.
- WARNING: The batteries shall not be exposed to excessive heat such as sunshine, fire or the like.
CAUTION: Danger of explosion if battery is incorrectly replaced. Replace only with the same or equivalent type.

PANEL

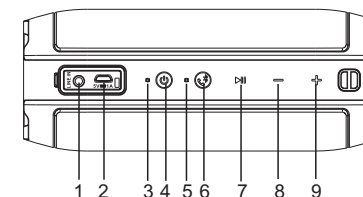

1. LINE IN
2. DC IN 5V
3. CHARGING (RED)/POWER ON (WHITE) INDICATOR
4. POWER ON/OFF
5. BLUETOOTH INDICATOR
6. BLUETOOTH/HANDS FREE
7. PLAY/PAUSE
8. VOLUME-
9. VOLUME+

VOLUME+

- When the speaker is in working mode, press to turn up the volume. You will hear the beep sound when you turn up to the maximum volume.
- When the speaker is in working mode, hold down to skip to the next track.

VOLUME-

- When the speaker is in working mode, press to turn down the volume. You will hear the beep sound when you turn down to the minimum volume.
- When the speaker is in working mode, hold down to skip to the previous track.

PLAY/PAUSE

- Press to temporarily pause a playback; press it again to resume the playback.

BLUETOOTH/HANDS FREE

- When the speaker is in working mode.
- Press this button to answer the phone call in hands free when there is a phone call in.
 - When the speaker is in bluetooth connection status,hold down this button to disconnected the existing bluetooth connections, the speaker will turn to pairing other matching bluetooth device when you hear the voice prompt of **YOUR DEVICE IS DISCONNECTED**.
 - When the speaker without bluetooth connection in bluetooth mode,hold down this Button to enter into bluetooth pairing status when you hear the voice prompt of **PAIRING**.

INDICATOR

- Hold down this button for 3 seconds to power on/off the speaker with the voice prompt of **POWER ON/OFF**.
- Power on the speaker, the blue indicator flashing, you will hear the voice prompt of **POWER ON**, the speaker is in searching bluetooth signal status.
- The blue indicator keep solid blue means

bluetooth was connected, you will hear the voice prompt of **YOUR DEVICE IS CONNECTED**, and the model of the speaker will shows on your device.

- It is better to switch off the unit before charging. The charging-indicator changing from red to light off indicates that the battery has been fully charged.

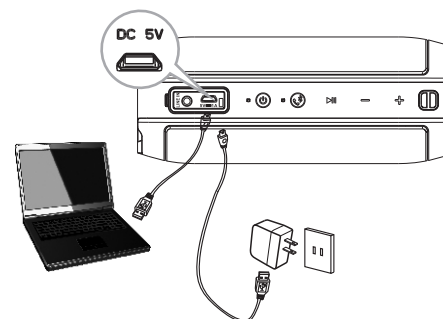

LINE IN

- This speaker has an extra group of audio input terminals. You can input the analogue stereo audio signals from extra devices such as mobile phone, computer,MP3 player, etc.
- Use the audio cable to connect the audio output terminals of mobile phone, computer, MP3 player to the audio input terminal (LINE IN) of this speaker.
- When the speaker connect the LINE input terminal, the speaker will disconnect the bluetooth connection automatically.
- When the speaker disconnect the LINE input terminal, the speaker will return to the previous bluetooth connection.

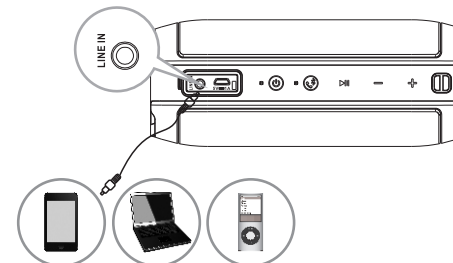

BLUETOOTH CONNECTION

- The bluetooth pairing model of the speaker is ATGTA6625, power on the speaker then use your smart phone to search the bluetooth signal of the unit, the unit will synchronize to play songs on your smart phone while they connected successfully.
- The speaker need to input the password 0000 when the matching bluetooth device under version 2.1.
- The bluetooth will turn to low power consumption dormant status after 3 minutes without connections, at this time , the blue indicator will go out, hold down [POWER ON/OFF] button for 3 seconds to wakes up the speaker.
- When the operation too frequently or other reason to disturb the bluetooth reconnected, please use manually connect on the bluetooth device.
- The bluetooth is connected to your smart phone successfully for the first time, disconnect the bluetooth on your smart phone then reconnected it, the speaker will memories your smart phone and repaired automatically.Press [PLAY/PAUSE] to

-8-

resume the playback.

Note:

- Bluetooth connection range in 10 meters;
- The model ATGTA6625 in your device was not deleted;
- After 3 minutes without connections, the speaker go to dormant status and you need to hold down [POWER ON/OFF] button for 3 seconds to wakes up the speaker.

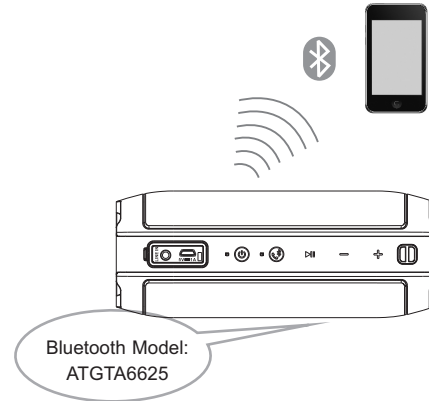

-9-

CHECK BATTERY LEVEL

- Press power on/off to check the current battery level in power on mode.
If the white indicator flashing
Four times=app. 100% full
Three times=app. 80% full above
Two times=app. 40%-80% full
One times=app. 20% full(indicating Charging is needed)

-10-

FCC STATEMENT

1. This device complies with Part 15 of the FCC Rules. Operation is subject to the following two conditions:
(1) This device may not cause harmful interference, and
(2) This device must accept any interference received, including interference that may cause undesired operation.
2. Changes or modifications not expressly approved by the party responsible for compliance could void the user's authority to operate the equipment.

NOTE: This equipment has been tested and found to comply with the limits for a Class B digital device, pursuant to Part 15 of the FCC Rules. These limits are designed to provide reasonable protection against harmful interference in a residential installation. This equipment generates uses and can radiate radio frequency energy and, if not installed and used in accordance with the instructions, may cause harmful interference to radio communications.

-11-

FCC STATEMENT

However, there is no guarantee that interference will not occur in a particular installation. If this equipment does cause harmful interference to radio or television reception, which can be determined by turning the equipment off and on, the user is encouraged to try to correct the interference by one or more of the following measures:
Reorient or relocate the receiving antenna.
Increase the separation between the equipment and receiver.
Connect the equipment into an outlet on a circuit different from that to which the receiver is connected.
Consult the dealer or an experienced radio/TV technician for help.

RF warning statement:The device has been evaluated to meet general RF exposure requirement. The device can be used in portable exposure condition without restriction.