

# USER MANUAL

happy plugs

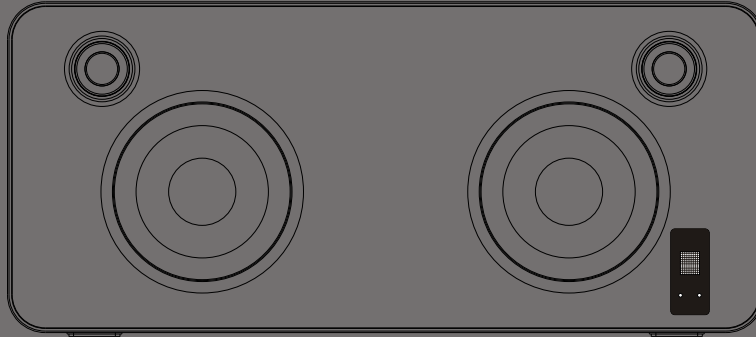

Happy Plugs

BLUETOOTH SPEAKER

Sound Piece

# Contents

---

Features .....	2
For your Attention.....	3-5
Panel.....	6
Connections.....	7-8
Trouble shooting.....	9
Specifications.....	10

# Features

---

Thanks for your purchase of our product. Please read through this manual before making connections and operating this product. Retain this manual for future reference.

- Bluetooth playback
- AUX input
- With USB charging for external device function

Note:The bluetooth speaker will turn to standby mode after 15 minutes in the absence of no source status,standby power is less than 0.5W.

## Package Contents:

**User manual**

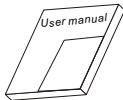

**AC power cord**



## For Your Attention

---

1. Read these instructions – All the safety and operating instructions should be read before this product is operated.
2. Keep these instructions – The safety and operating instructions should be retained for future reference.
3. Heed all warnings – All warnings on the appliance and in the operating instructions should be adhered to.
4. Follow all instructions – All operating and use instructions should be followed.
5. Do not use this apparatus near water – The appliance should not be used near water or moisture – for example, in a wet basement or near a swimming pool, and the like.
6. Clean only with dry cloth.
7. Do not block any ventilation openings. Install in accordance with the manufacture's instructions.  
Do not install near any heat sources such as radiators, heat registers, stoves, or other apparatus (including amplifiers) that produce heat.
8. Do not defeat the safety purpose of the polarized or grounding plug. A polarized plug has two blades with one wider than the other. A grounding plug has two blades and a third grounding prong. The wide blade or the third prong is provided for your safety. If the provided plug does not fit into your outlet, consult an electrician for replacement of the obsolete outlet.
9. Protect the power cord from being walked on or pinched particularly at the plugs, convenience receptacles, and at the point where they exit from the apparatus.
10. Only use attachments/accessories specified by the manufacturer.
11. Use only with the cart, stand, tripod, bracket, or table specified by the manufacturer, or sold with the apparatus. When a cart or rack is used, use caution when moving the cart/apparatus combination to avoid injury from tip-over.



53125A

## For Your Attention

---

12. Unplug the apparatus during lightning storms or when unused for long periods of time.
13. Unplug the apparatus during lightning storms or when unused for long periods of time.
14. Refer all servicing to qualified personnel. Servicing is required when the apparatus has been damaged in any way, such as power supply cord or plug is damaged, liquid has been spilled or objects have fallen into the apparatus has been exposed to rain or moisture, does not operate normally, or has been dropped.
15. **WARNING:** Please refer the information on exterior bottom enclosure for electrical and safety information before installing or operating the apparatus.
16. **WARNING:** To reduce the risk of fire or electric shock, do not expose this apparatus to rain or moisture. The apparatus shall not be exposed to dripping or splashing and that objects filled with liquids, such as vases, shall not be placed on apparatus
17. **WARNING:** The mains plug is used as disconnect device, the disconnect device shall remain readily operable.
18.  This equipment is a Class II or double insulated electrical appliance. It has been designed in such a way that it does not require a safety connection to electrical earth.



19. This lightning flash with arrowhead symbol within an equilateral triangle is intended to alert the user to the presence of non-insulated “dangerous voltage” within the product's enclosure that may be of sufficient magnitude to constitute a risk of electric shock.

- Warning: To reduce the risk of electric shock, do not remove cover (or back) as there are no user-serviceable parts inside. Refer servicing to qualified personnel.
- The exclamation point within an equilateral triangle is intended to alert the user to the presence of important operating and maintenance instructions in the literature accompanying the appliance.

## For Your Attention

---

### **FCC STATEMENT**

1. This device complies with Part 15 of the FCC Rules. Operation is subject to the following two conditions:
  - (1) This device may not cause harmful interference.
  - (2) This device must accept any interference received, including interference that may cause undesired operation.
2. Changes or modifications not expressly approved by the party responsible for compliance could void the user's authority to operate the equipment.

NOTE: This equipment has been tested and found to comply with the limits for a Class B digital device, pursuant to Part 15 of the FCC Rules. These limits are designed to provide reasonable protection against harmful interference in a residential installation.

This equipment generates uses and can radiate radio frequency energy and, if not installed and used in accordance with the instructions, may cause harmful interference to radio communications. However, there is no guarantee that interference will not occur in a particular installation. If this equipment does cause harmful interference to radio or television reception, which can be determined by turning the equipment off and on, the user is encouraged to try to correct the interference by one or more of the following measures:

- Reorient or relocate the receiving antenna.
- Increase the separation between the equipment and receiver.
- Connect the equipment into an outlet on a circuit different from that to which the receiver is connected.
- Consult the dealer or an experienced radio/TV technician for help.

### **FCC Radiation Exposure Statement**

This equipment complies with FCC radiation exposure limits set forth for an uncontrolled environment. This equipment should be installed and operated with minimum distance 20cm between the radiator & your body.

---

# For Your Attention

## Industry Canada Notice

This device complies with Industry Canada license-exempt RSS standard(s).  
Operation is subject to the following two conditions:

- (1) this device may not cause interference, and
- (2) this device must accept any interference, including interference that may cause  
Undesired operation of the device.

This Class B digital apparatus complies with Canada ICE-003.

## IC:255A-Happy Plugs Medium CAN ICES-3(B)/NMB-3(B)

### - French:

Le présent appareil est conforme aux CNR d'Industrie  
Canada applicables aux appareils radio exempts de  
licence. L'exploitation est autorisée aux deux conditions  
suivantes :

- (1) l'appareil ne doit pas produire de brouillage, et
- (2) l'utilisateur de l'appareil doit accepter tout brouillage  
radioélectrique subi, même si le brouillage est  
susceptible d'en compromettre le fonctionnement."



means that your electrical and electronic equipment should  
be disposed at the end of its life separately from your  
household waste.

There are separate collection systems for recycling in the EU.  
For more information, please contact the local authority or  
your retailer where you purchased the product.

# Panel

---

## TOP PANEL:

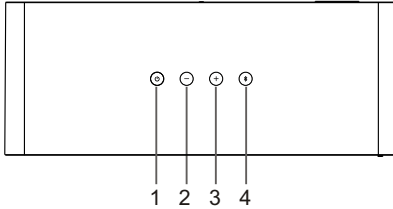

1. STANDBY (press to power on, hold down to standby in power on status)
2. VOLUME- (press to turn down the volume)
3. VOLUME+ (press to turn up the volume)
4. BLUETOOTH (press repeatedly to switch between BLUETOOTH and AUX IN mode, when switch to bluetooth mode, the bluetooth speaker will emit the voice of **Bluetooth Mode, Pairing Device**, when switch to AUX in mode, the bluetooth speaker emit the voice of **Cable Mode**. hold down to disconnect bluetooth connection)

## FRONT PANEL:

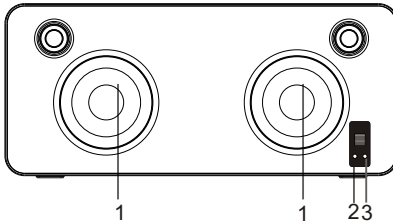

1. SPEAKER
2. STANDBY INDICATOR (standby mode in red indicator)
3. BLUETOOTH/AUX IN INDICATOR (Bluetooth mode in blue indicator, Aux in mode in solid yellow indicator.)

## REAR PANEL:

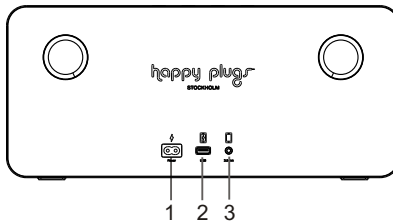

1. POWER CORD SOCKET
2. USB SLOT (Note: ● Use the USB cable to connect the USB slot of the player to other device input terminals to charge battery, like mobile phone, etc no matter the speaker power on or standby mode status.)  
● There is no connection with the speaker after 10~15 minutes (no AUX input, USB charge or bluetooth connection), the speaker will turn to standby mode automatically and the standby red indicator light, press [STANDBY] to wake up the speaker.
3. AUX IN(3.5mm)



# Connections

---

## AUX IN

- Use the audio cable to connect the audio output terminals of smart phone, computer, MP3 player to the audio input terminal (AUX IN) of this speaker.
- Press [BLUETOOTH] button to switch AUX IN mode and the indicator on the front panel indicates in solid yellow that the player has been switched to AUX IN mode when the bluetooth speaker is in bluetooth mode.
- Bluetooth is disabled when you use AUX IN play mode, and the audio playback (likes previous/next track) is controls on your audio device, not on the speaker.

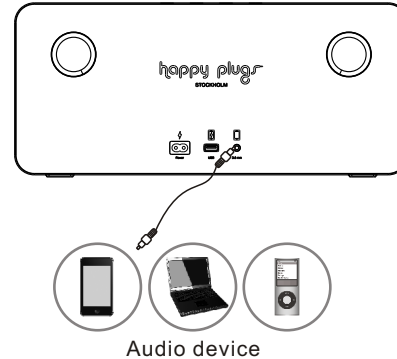

# Connections

---

## Bluetooth Connection

Use the power cord one terminal connect to power cord socket on the bluetooth speaker,the other terminal connect to AC outlet,press standby button power on the speaker, the blue indicator flashing quickly, you will hear the voice prompt of **Sound Piece Ready To Go,Pairing Device**, the speaker access insearching bluetooth signalstatus.

Use your smart phone to selectSound Piece on your bluetooth list, you will hear the voice prompt of **Device Connected**,the speaker was connected to your smart phone,the blue indicator flashing slowly,disconnected the bluetooth on your smart phone to switched off the bluetooth connection,and you will hear the voice prompt of **Device Disconnected,Pairing Device**.

The bluetooth is connected to your smart phone successfully for the first time, disconnect the bluetooth on your smart phone then reconnected it, the speaker will memories your smart phone and repaired automatically. Hold down [BLUETOOTH] button for 3 seconds to disconnect the bluetooth connection when you hear the voice prompt of **Device Disconnected,Pairing Device**, clear the paired memory history by pressing [STANDBY] button for 2 times and the speaker could not repaired automatically.

Hold down [STANDBY] button to power off the bluetooth speaker and you will hear the voice prompt of **Sound Piece Going To Sleep**.

Note:

- Bluetooth connection range in 10 meters.
- The model Sound Piece in your device was not deleted.
- In bluetooth mode,[BLUETOOTH],[VOLUME+/-] etc. are also active.
- The speaker need to input the password 0000 when the matching bluetooth device under version 2.1.

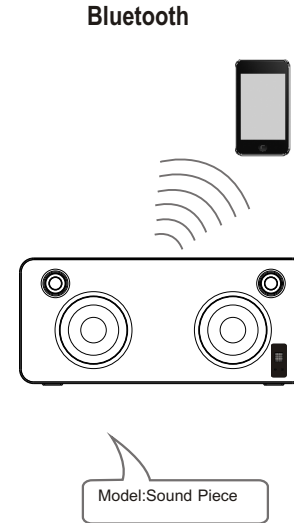

# Troubleshooting

---

Before resorting to maintenance service, please kindly check by yourself with the following chart.

Symptom	Cause(s)	Remedy
<b>No Power</b>	●The AC power cord is not connected to the power supply or is not connected to a power supply securely.	●Please check that the AC power cord is connected securely.
<b>Sound</b> There is no sound or the sound is distorted.	●The volume is set to the minimum level.	●Turn up the volume.
<b>The buttons on the unit doesn't work.</b>	●The unit is being interfered with static electricity etc.	●Switch off and unplug the unit. Then connect the plug to the power supply and switch it on again.

# Specifications

---

Power supply		AC IN ~100-240V 50/60Hz
Working environment	Temperature	-10~+35℃
	Relative humidity	5%~90%
Speaker output (Max)		20WX2

