

TECHNICAL BULLETIN UHF ANTENNA SETUP

ELECTRONIC SYSTEMS TECHNOLOGY
9092 (O)
415 N. QUAY STREET KENNEWICK, WA 99336
5475 (FAX)

509-735-
509-783-

Models 192S Indoor Equipment Diagram



Omni-Directional
Antenna

ST P/N AA20S.

Warning

Omni-directional antenna should not be located within 20 cm of personnel.



Omni-Directional
Antenna

EST P/N AA01S.
Rubber duck, back of set mount

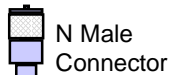

N Male
Connector

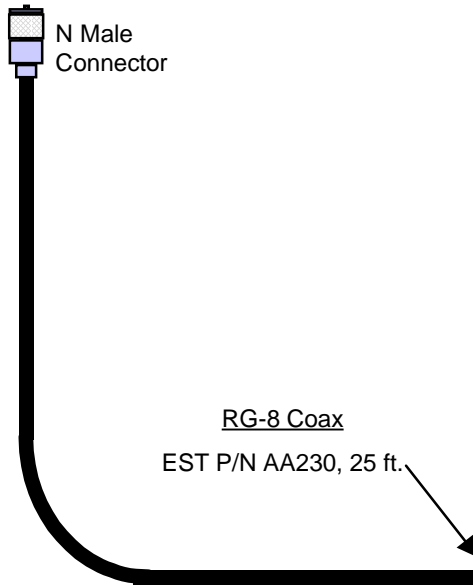

RG-8 Coax

EST P/N AA230, 25 ft.

TNC-R
Male Connector



12 VDC POWER SUPPLY
RECOMMENDATIONS

EST P/N AA174
Battery Packs
Solar Power

2 Pin Molex
Connector

NOTES

1. Vapor wrap all external antenna coax connections with vinyl wrap (EST P/N AA241) and apply Scotchkote Electrical Coating (EST P/N AA242).
2. Contact EST for recommendations regarding antenna mounting hardware and installation tips.
3. Ground antenna structure and base.

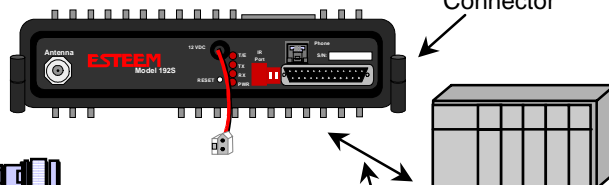

RS-232C, 422, &
485 Interface
Connector



User's
Device

RS-232C,422, or 485
INTERFACE CABLE

EST P/N AA06,
AA061, AA07, or
custom depending on
device.