



Model TW-400

# ALARM CLOCK WITH WIRELESS + USB CHARGING



For additional information, online registration, and exclusive special offers visit our website:

[www.timexaudio.com](http://www.timexaudio.com)

Questions? Contact Customer Service at 1-800-888-4491

### Table of Contents

- What's in the Box..... 1
- Controls Overview..... 2
- Display..... 3
- Backup Battery..... 3
- Set-Up..... 4
- Product Care..... 4
- Setting the Time..... 5
- Setting and Using Alarms..... 6-7
- Wireless Charging..... 8-9
- Charging Devices via USB Port..... 10
- Display Dimmer..... 11
- Troubleshooting..... 12
- Safety Information..... 13-14
- Warranty Information..... 15

### What's in the Box

This product ships with the following items. Make sure all are present.

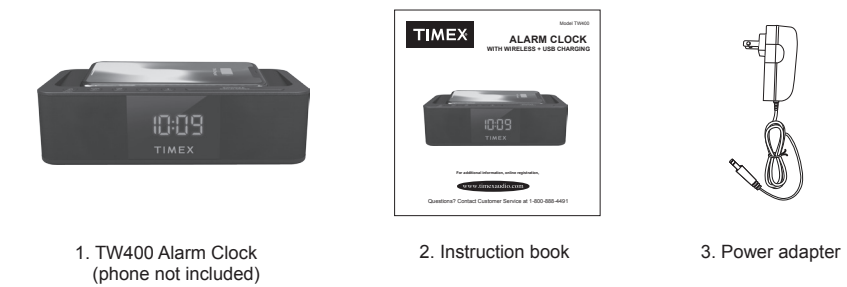

1. TW400 Alarm Clock (phone not included)      2. Instruction book      3. Power adapter

### Controls Overview

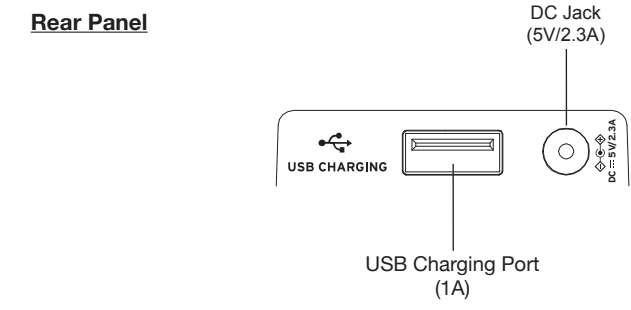
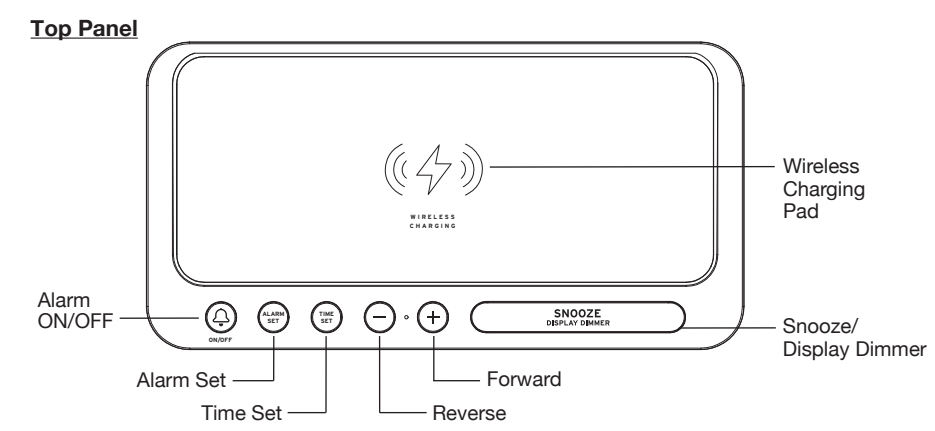

### Display

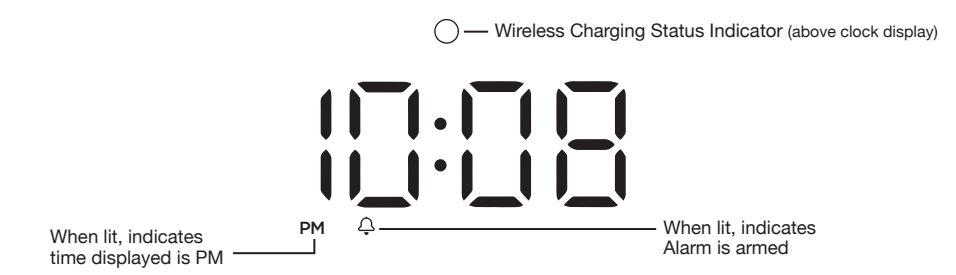

When lit, indicates time displayed is PM      When lit, indicates Alarm is armed

### Backup Battery

Your new Timex Clock includes a built-in battery backup system that will maintain the time settings during a temporary power interruption.



The display will turn off during a power failure, but the clock will continue to run. The alarm will NOT sound during a temporary power interruption, and will need to be reset once connected to power again.

### Set Up

#### Connecting to Power Source

Connect the included AC adapter to the DC jack located on the back of the unit and connect the other end to a working wall outlet.

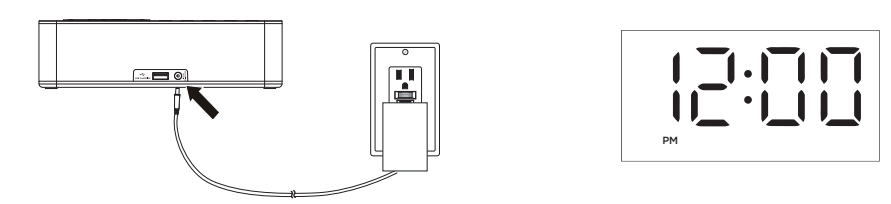

### Product Care

- Place the unit on a level surface away from sources of direct sunlight or excessive heat.
- Protect your furniture when placing your unit on a natural wood and lacquered finish. A cloth or other protective material should be placed between it and the furniture.
- Stronger cleaning agents, such as Benzene, thinner or similar materials can damage the surface of the unit.

### Setting the Time

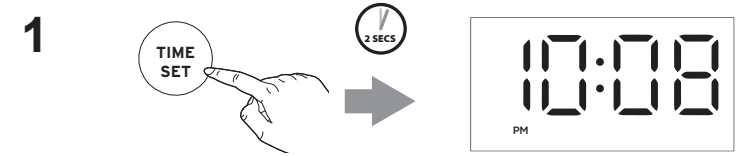

Press and hold the **Time Set Button**.

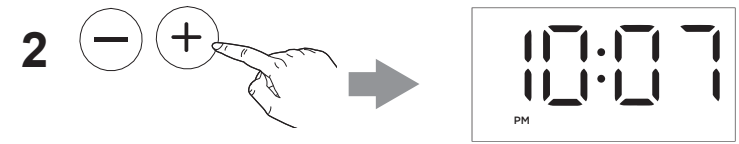

While continuing to press and hold the **Time Set Button**, press and release the **+/- Buttons** to adjust the time.

*NOTE: The PM indicator will light when the hour is set for PM. There is no AM indicator.*

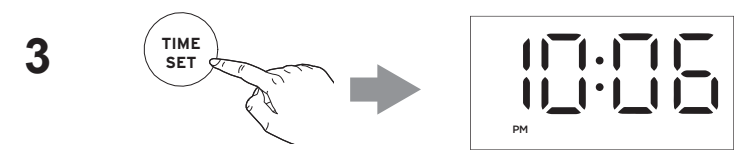

Release the **Time Set Button** to complete time setting.

### Setting and Using Alarms



Press and hold the **Alarm Set Button**.

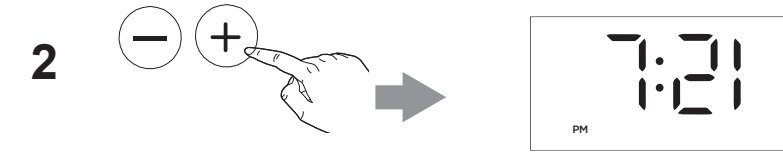

While continuing to press and hold the **Alarm Set Button**, press and release the **+/- Buttons** to adjust the alarm time.

*NOTE: The PM indicator will light when the hour is set for PM. There is no AM indicator.*

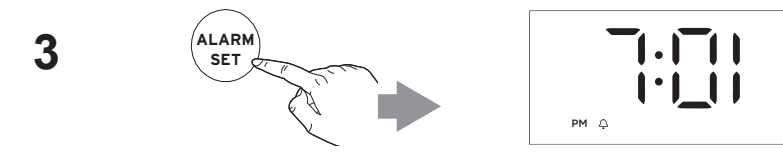

Release the **Alarm Set Button** to complete alarm setting. The icon will appear on the display to confirm the alarm is armed.

### Setting and Using Alarms (Continued)

#### RESETTING AN ALARM TO COME ON THE NEXT DAY



To silence a sounding alarm and reset it come on the next day at the same time, press and release the **Alarm Set Button**.

#### SNOOZING THE ALARM

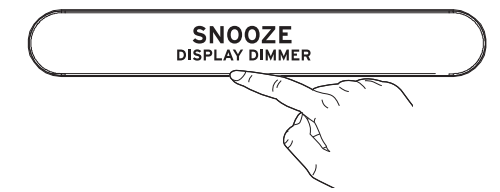

Press and release the **Snooze/Dimmer Button** when the alarm sounds to silence it for 9 minutes. The alarm icon on the display will blink while the unit is in Snooze mode. Snooze can be used several times during alarm.

## Wireless Charging

Supports:

- Qi compatible phones (also works with plastic cases up to 2mm thick)
  - AirPods with wireless charging case
- Place Qi compatible device face up on the wireless charging pad as pictured below:

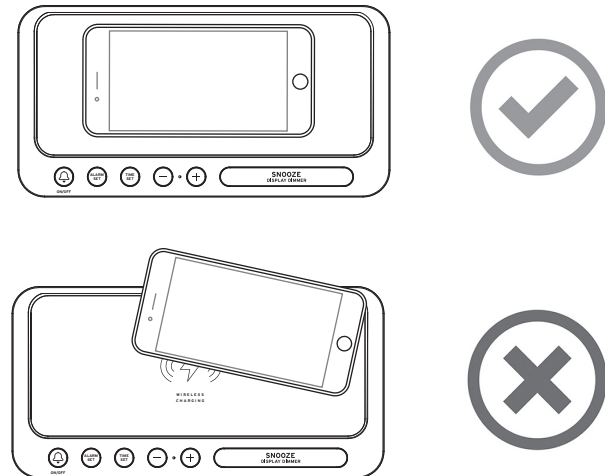

### CAUTION:

Remove metal protective or magnetic case from phone before charging. When charging phone, do not place magnetic-stripped or other metal objects on the charger. Doing so could damage the object or this unit. Qi compatible phones with metallic looking finishes will charge normally.

8

## Wireless Charging (Continued)

Check the wireless charging status indicator (located above the clock display) to monitor charging status:

Wireless Charging Status LED Indicator (above clock display)

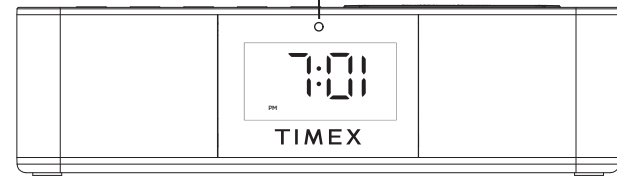

**Solid blue LED:** Device is charging properly.

**Solid red LED:** Device is charged.

**Rapid blinking red LED:** Device is not charging properly. Reposition device.

Note: The LED indicator may continue to glow solid blue when iOS devices are fully charged.

9

## Charging Devices via USB Port

You can also charge your devices via the USB port located on the back of the unit.

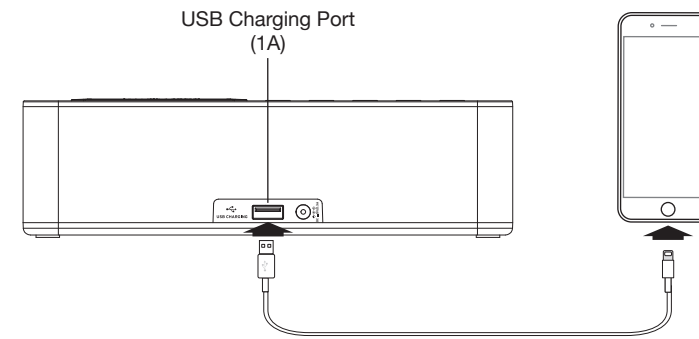

To charge devices:

- Connect the standard size end of a USB cable (not included) to the USB port on the back of the unit.
- Connect the other end to the charging port on your device.

(Make sure the unit is plugged into a working outlet in order to charge devices.)

10

## Display Dimmer

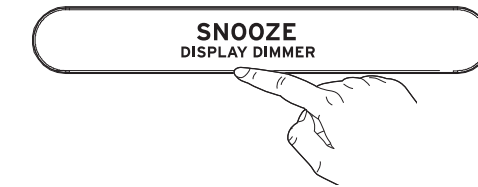

Press and hold the **Snooze/Dimmer Button** to toggle display brightness between high and low settings. Dimmer cannot be adjusted when alarm is sounding.

11

## Troubleshooting

- The unit does not power ON.**  
The unit is not connected to AC outlet, the AC outlet has no power, or is controlled by a wall switch that is "OFF". Check AC outlet and wall switch.
- Alarm does not come on.**  
The alarm time AM or PM incorrectly set, Alarm was OFF, etc. Check alarm settings.
- Unit shuts "Off" unexpectedly.**
  - a. A power surge has occurred, or the AC outlet has been disconnected.
  - b. The AC outlet may be controlled by a wall switch that is turned OFF. Check AC outlet or wall switch.

12



**CAUTION: TO REDUCE THE RISK OF ELECTRIC SHOCK, DO NOT REMOVE COVER (OR BACK). NO USER-SERVICEABLE PARTS INSIDE.**

**REFER SERVICING TO QUALIFIED SERVICE PERSONNEL.**

**WARNING: TO REDUCE THE RISK OF FIRE OR ELECTRIC SHOCK, DO NOT EXPOSE THIS APPLIANCE TO RAIN OR MOISTURE.**

**AVERTISSEMENT: POUR RÉDUIRE LE RISQUE D'INCENDIE OU DE CHOC ÉLECTRIQUE, NE PAS EXPOSER CET APPAREIL SOUS LA PLUIE ET L'HUMIDITÉ**

The lightning flash with arrowhead symbol, within an equilateral triangle, is intended to alert the user of the presence of uninsulated "dangerous voltage" within the product's enclosure that may be of sufficient magnitude to constitute a risk electric shock to persons.

The exclamation point within an equilateral triangle is intended to alert the user of the presence of important operating and maintenance (servicing) instructions in the literature accompanying the appliance.

**CAUTION:** To prevent electric shock, do not use this (Polarized) plug with an extension cord receptacle, or other outlets unless the blades can be fully inserted to prevent blade exposure.

**ATTENTION:** Pour prévenir les chocs électriques ne pas utiliser cette fiche polarisée avec un prolongateur. Une prise de courant, ou une autre sortie de courant sauf si les lames peuvent être insérées à fond sans en laisser aucune partie à découvert.

## IMPORTANT SAFETY INSTRUCTIONS

When used in the directed manner, this unit has been designed and manufactured to ensure your personal safety. However, improper use can result in potential electrical shock or fire hazards. Please read all safety and operating instructions carefully before installation and use, and keep these instructions handy for future reference. Take special note of all warnings listed in these instructions and on the unit. Follow all instructions:

- Water and Moisture** - The unit should not be used near water. For example: near a bathtub, washbowl, kitchen sink, laundry tub, swimming pool or in a wet basement.
- Ventilation** - The unit should be situated so that its location or position does not interfere with its proper ventilation. For example, it should not be situated on a bed, sofa, rug or similar surface that may block ventilation openings. Also, it should not be placed in a built-in installation, such as a bookcase or cabinet, which may impede the flow of air through the ventilation openings. Do not block any ventilation openings. Install in accordance with the manufacturer's instructions.
- Heat** - The unit should be situated away from heat sources such as radiators, heat registers, stoves or other appliances (including amplifiers) that produce heat.
- Power Sources** - The unit should be connected to a power supply only of the type described in the operating instructions or as marked on the appliance.
- Power-Cable Protection** - Power supply cables should be routed so that they are not likely to be walked on or pinched by items placed upon or against them. It is always best to have a clear area from where the cable exits the unit to where it is plugged into an AC socket.
- Cleaning** - Clean only with dry cloth. The unit should be cleaned only as recommended. See the Maintenance section of this manual for cleaning instructions.
- Objects and Liquid Entry** - Care should be taken so that objects do not fall and liquids are not spilled into any openings or vents located on the product.
- Attachments** - Do not use attachments not recommended by the product manufacturer.
- Lightning and Power Surge Protection** - Unplug the unit from the wall socket and disconnect the antenna or cable system during a lightning storm or when it is left unattended and unused for long periods of time. This will prevent damage to the product due to lightning and power-line surges.
- Periods of Nonuse** - If the unit is to be left unused for an extended period of time, such as a month or longer, the power cable should be unplugged from the unit to prevent damage or corrosion.
- Servicing** - The user should not attempt to service the unit beyond those methods described in the user's operating instructions. Service methods not covered in the operating instructions should be referred to qualified service personnel.
- Mains supply disconnection** - The mains plug shall remain readily operable.
- Do not defeat the safety purpose of the polarized or grounding-type plug. A polarized plug has two blades with one wider than the other. A grounding type plug has two blades and a third grounding prong. The wide blade or the third prong are provided for your safety. When the provided plug does not fit into your outlet, consult an electrician for replacement of the obsolete outlet.

CAUTION - Danger of explosion if battery is incorrectly replaced. Replace only with the same or equivalent type.

13

## FCC Information

This equipment complies with FCC radiation exposure limits set forth for an uncontrolled environment. This equipment should be installed and operated with minimum distance 20cm between the radiator & your body.

This device complies with Part 15 of the FCC Rules, operation is subject to the following two conditions:  
(1) This device may not cause harmful interference, and (2) this device must accept any interference received, including interference that may cause undesired operation.

- Warning: Changes or modifications to this unit not expressly approved by the party responsible for compliance could void the user's authority to operate the equipment.
- NOTE: This equipment has been tested and found to comply with the limits for a Class B digital device, pursuant to Part 15 of the FCC Rules.

These limits are designed to provide reasonable protection against harmful interference in a residential installation. This equipment generates, uses and can radiate radio frequency energy and, if not installed and used in accordance with the instructions, may cause harmful interference to radio communications. However, there is no guarantee that interference will not occur in a particular installation. If this equipment does cause harmful interference to radio or television reception, which can be determined by turning the equipment off and on, the user is encouraged to try to correct the interference by one or more of the following measures:

- Reorient or relocate the receiving antenna.
- Increase the separation between the equipment and receiver.
- Connect the equipment into an outlet on a circuit different from that to which the receiver is connected.
- Consult the dealer or an experienced radio/TV technician for help.

CAN ICES-3 (B)/NMB-3(B), CAN RSS216 / CNR-216

### IC statement

This equipment complies with IC RSS-102 radiation exposure limits set forth for an uncontrolled environment. Cet équipement est conforme aux limites d'exposition aux radiations IC CNR-102 établies pour un environnement non contrôlé.

This equipment should be installed and operated with a minimum distance of 20 cm between the radiator and your body. Cet équipement doit être installé et utilisé avec une distance minimale de 20 cm entre le radiateur et votre corps.

This device contains licence-exempt transmitter(s)/receiver(s) that comply with Innovation, Science and Economic Development Canada's licence-exempt RSS(s). Operation is subject to the following two conditions:  
1. This device may not cause interference.

1. This device must accept any interference, including interference that may cause undesired operation of the device.
2. L'émetteur/récepteur exempt de licence contenu dans le présent appareil est conforme aux CNR d'Innovation, Sciences et Développement économique Canada applicables aux appareils radio exempts de licence. L'exploitation est autorisée aux deux conditions suivantes:  
(1) L'appareil ne doit pas produire de brouillage;  
(2) L'appareil doit accepter tout brouillage radioélectrique subi, même si le brouillage est susceptible d'en compromettre le fonctionnement.

The device meets the exemption from the routine evaluation limits in section 2.5 of RSS 102 and compliance with RSS-102 RF exposure, users can obtain Canadian information on RF exposure and compliance. Le dispositif rencontre l'exemption des limites courantes d'évaluation dans la section 2.5 de RSS 102 et la conformité à l'exposition de RSS-102 rf, utilisateurs peut obtenir l'information canadienne sur l'exposition et la conformité de rf.

14

## Important Safety Instructions

- Minimum distances 10cm around the apparatus for sufficient ventilations.
- The ventilation should not be impeded by covering the ventilation openings with items such as newspaper, table-cloths, curtains etc.
- No naked flame sources such as lighted candles should be placed on the apparatus.
- Attention should be drawn to the environmental aspects of battery disposal.
- The use of apparatus in moderate climates.
- The apparatus shall not be exposed to dripping or splashing and that no objects filled with liquids, such as vases, shall be placed on the apparatus.
- Batteries (battery pack or batteries installed) shall not be exposed to excessive heat such as sunshine, fire or the like.
- Where the mains plug or an appliance coupler is used as the disconnect device, the disconnect device shall remain readily operable.
- Caution marking is located at the bottom of the apparatus.
- The marking information is located at the bottom of apparatus.
- 10cm de distance minimale autour de l'appareil pour une ventilation suffisante.
- Ne pas recouvrir les entrées d'aérations avec des objets tel qu'un journal, une nappe, un rideau, etc...
- Aucune source de flamme nue, tel qu'une bougie, ne doit être placée sur l'appareil.
- Les piles usagées doivent être jetées en respectant l'environnement.
- L'utilisation d'appareils dans les climats modérés.
- L'appareil ne doit pas être exposé aux écoulements ou aux éclaboussures et aucun objet ne contenant de liquide, tel qu'un vase, ne doit être placé sur l'objet.
- Les piles (batterie ou batteries installées) ne doivent pas être exposées à de forte chaleur, tel qu'à la lumière du soleil, au feu ou autres choses de semblable.
- Lorsque la fiche d'alimentation ou un coupleur d'appareil est utilisé comme dispositif de déconnexion, le dispositif de déconnexion doit rester facilement accessible.
- Le marquage de précaution est situé au bas de l'appareil.
- Les informations de marquage sont situées au bas de l'appareil.

## Limited 90 Day Warranty Information

Timex Audio Products, a division of SDI Technologies Inc. (hereafter referred to as SDI), warrants this product to be free from defects in workmanship and materials, under normal use and conditions, for a period of ninety (90) days from the date of original purchase. Should this product fail to function in a satisfactory manner, it is best to first return it to the store where it was originally purchased. Should this fail to resolve the matter and service still be required by reason of any defect or malfunction during the warranty period, SDI will repair or, at its discretion, replace this product without charge. This decision is subject to verification of the defect or malfunction upon delivery of this product to the Factory Service Center authorized by Customer Service. If service is required, please call Customer Service at 1-800-888-4491 for Return Authorization and shipping instructions. A copy of the sales receipt is required to validate in-warranty coverage.

### Disclaimer of Warranty

NOTE: This warranty is valid only if the product is used for the purpose for which it was designed. It does not cover (i) products which have been damaged by negligence or willful actions, misuse or accident, or which have been modified or repaired by unauthorized persons; (ii) cracked or broken cabinets, or units damaged by excessive heat; (iii) damage to digital media players, CD's or tape cassettes (if applicable); (iv) the cost of shipping this product to the Factory Service Center and its return to the owner. This warranty is valid only in the United States of America and does not extend to owners of the product other than the original purchaser. In no event will SDI or any of its affiliates, contractors, resellers, their officers, directors, shareholders, members or agents be liable to you or any third party for any consequential or incidental damages, any lost profits, actual, exemplary or punitive damages. (Some states do not allow limitations on implied warranties or exclusion of consequential damages, so these restrictions may not apply to you.) This warranty gives you specific legal rights, and you may also have other rights which vary from state to state. Your acknowledgment and agreement to fully and completely abide by the above mentioned disclaimer of warranty is contractually binding to you upon your transfer of currency (money order, cashier's check, or credit card) for purchase of your SDI product.

© 2019 SDI Technologies, Inc. All rights reserved  
Questions? Visit [www.timexaudio.com](http://www.timexaudio.com)  
or call 1-800-888-4491 Toll Free

TIMEX is a registered trademark of Timex Corporation in the United States and other countries

TW400\_QSG\_080819\_A

15

Printed in China