

**HTC Fetch**

BL A100

User Guide

<http://www.htc.com/support>

**htc**

## Trademarks and copyrights

© 2013 HTC Corporation. All rights reserved. **HTC and the HTC logo are trademarks of HTC Corporation.** All other trademarks included herein are the property of their respective owners.

The **Bluetooth and Bluetooth Smart** word mark and logos are registered trademarks owned by Bluetooth SIG, Inc.

**Google and Google Maps are trademarks of Google Inc.**

Windows is a registered trademark of Microsoft Corporation in the United States and other countries.

HTC shall not be liable for technical or editorial errors or omissions contained herein, nor for incidental or consequential damages resulting from furnishing this material. The information is provided “as is” without warranty of any kind and is subject to change without notice. HTC also reserves the right to revise the content of this document at any time without prior notice.

No part of this document may be reproduced or transmitted in any form or by any means, electronic or mechanical, including photocopying, recording or storing in a retrieval system, or translated into any language in any form without prior written permission of HTC.

## About your HTC Fetch

Your HTC Fetch is a *Bluetooth® Smart* device that helps you to easily locate your misplaced phone or find valuables you attached an HTC Fetch to with your phone.

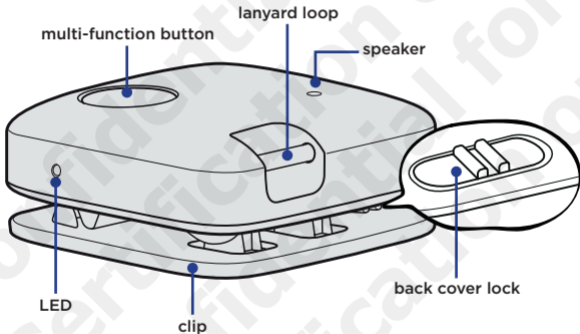

## Removing the battery film

Before using HTC Fetch, you'll need to remove the battery film.

1



1. Use a coin to slide the back cover lock to the unlock position, and then remove the back cover.

2

battery film



2. Remove the battery and the battery film.

4

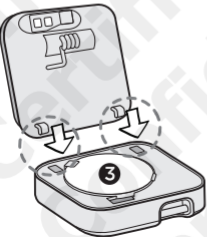

3. Reinsert the battery.
4. Reinstall the back cover, and then slide the back cover lock to the lock position.

## Pairing your HTC Fetch

You can connect up to three HTC Fetch tags to **any** HTC phone that is Bluetooth Smart Ready.

1. Turn on your HTC Fetch. (See Using HTC Fetch)
2. On your phone, turn on Bluetooth.
3. Do one of the following:
  - **On HTC phones with Android OS**  
Tap **Bluetooth**, and under “Available devices” tap **HTC Fetch** to pair your HTC Fetch.
  - **On HTC phones with Windows® Phone 8**  
Go to the system settings and tap **HTC Fetch**. Then tap **HTC Fetch** to pair.

### Tip:

If you have more than one HTC Fetch, rename your HTC Fetch to something descriptive such as “keys” so you’ll know what your HTC Fetch is attached to. In the Bluetooth settings, tap  > **Rename** next to the HTC Fetch tag you want to rename.

## Notifications

Your HTC Fetch uses a combination of audible and visual notifications to indicate changes in its status.

<b>Power on</b>	One beep and green LED flashes.
<b>Power off</b>	Two beeps and red LED flashes.
<b>Phone out of range</b>	Continuous beeping.

## Using HTC Fetch

HTC Fetch has a single multi-function button that you use to turn it on and off, activate the phone alert, and more.

<b>Power on or off</b>	Press and hold for four seconds.
<b>Activate the phone alert</b>	Press once. Press again to cancel.
<b>Take a photo</b>	Press once (while using the Camera app).

## Finding your HTC Fetch

When you attach HTC Fetch to something (such as your keys, bag, etc), you'll have the assurance that you'll have a starting point to track down your lost valuables.

1. On your phone, go to the Settings and tap **Bluetooth**.
2. Tap  next to the HTC Fetch tag you want to find.
3. Tap **Find [name of HTC Fetch]**.

### Tip:

You can use the signal strength indicator to see if you are getting closer to your HTC Fetch. The signal strength bars are next to "Paired Bluetooth devices".

If your HTC Fetch is not in range, you may be able to find out the last location before your phone lost contact with it.

1. On your phone, go to the Settings and tap **Bluetooth**.
2. Tap  next to the HTC Fetch tag you want to find.
3. If a last known location is available, tap **Last Seen** to view it in Google Maps™.

## Replacing the battery

HTC Fetch uses a standard CR2032 coin battery. The battery will last approximately six months when HTC Fetch is on stand-by. When you need to replace the battery, you'll receive a notification on your phone.

1. Use a coin to slide the back cover lock to the unlock position, and then remove the back cover.
2. Remove the battery and insert the new battery.
3. Reinstall the back cover, and then slide the back cover lock to the lock position.

### Tip:

To check the battery power, go to the Settings and tap **Bluetooth**. Tap  next to the HTC Fetch tag you want to check. The battery power information is just below "Paired Bluetooth device".

## Attaching the keychain

1. Hold the keychain with the clip facing down.
2. Align the keychain with HTC Fetch so that the HTC logos are facing the same side.
3. Slide the clip over the bar in the lanyard loop.

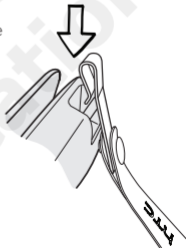

## Federal Communication Commission Interference Statement

This equipment has been tested and found to comply with the limits for a Class B digital device, pursuant to Part 15 of the FCC Rules. These limits are designed to provide reasonable protection against harmful interference in a residential installation. This equipment generates, uses and can radiate radio frequency energy and, if not installed and used in accordance with the instructions, may cause harmful interference to radio communications. However, there is no guarantee that interference will not occur in a particular installation. If this equipment does cause harmful interference to radio or television reception, which can be determined by turning the equipment off and on, the user is encouraged to try to correct the interference by one of the following measures:

- Reorient or relocate the receiving antenna.
- Increase the separation between the equipment and receiver.
- Connect the equipment into an outlet on a circuit different from that to which the receiver is connected.
- Consult the dealer or an experienced radio/TV technician for help.

This device complies with Part 15 of the FCC Rules. Operation is subject to the following two conditions: (1) This device may not cause harmful interference, and (2) this device must accept any interference received, including interference that may cause undesired operation.

**FCC Caution:** Any changes or modifications not expressly approved by the party responsible for compliance could void the user's authority to operate this equipment.



## Radiation Exposure Statement:

The product comply with the US/Canada portable RF exposure limit set forth for an uncontrolled environment and are safe for intended operation as described in this manual. The further RF exposure reduction can be achieved if the product can be kept as far as possible from the user body or set the device to lower output power if such function is available.

CAUTION: Any changes of modifications not expressly approved by the grantee of this device could void the user's authority to operate the equipment.

This device complies with RSS-210 of the Industry Canada Rules.

Operation is subject to the following two conditions:

- (1) This device may not cause harmful interference, and
- (2) this device must accept any interference received, including interference that may cause undesired operation.

Ce dispositif est conforme à la norme CNR-210 d'Industrie Canada applicable aux appareils radio exempts de licence.

Son fonctionnement est sujet aux deux conditions suivantes:

- 1) le dispositif ne doit pas produire de brouillage préjudiciable, et
- 2) ce dispositif doit accepter tout brouillage reçu, y compris un brouillage susceptible de provoquer un fonctionnement indésirable

## Radiation Exposure Statement:

The product comply with the US/Canada portable RF exposure limit set forth for an uncontrolled environment and are safe for intended operation as described in this manual. The further RF exposure reduction can be achieved if the product can be kept as far as possible from the user body or set the device to lower output power if such function is available.

## Déclaration d'exposition aux radiations:

Le produit est conforme aux limites d'exposition pour les appareils portables RF pour les Etats-Unis et le Canada établies pour un environnement non contrôlé.

Le produit est sûr pour un fonctionnement tel que décrit dans ce manuel. La réduction aux expositions RF peut être augmentée si l'appareil peut être conservé aussi loin que possible du corps de l'utilisateur ou que le dispositif est réglé sur la puissance de sortie la plus faible si une telle fonction est disponible.

## 低功率電波輻射性電機管理辦法

### 第十二條

經型式認證合格之低功率射頻電機，非經許可，公司、商號或使用者均不得擅自變更頻率、加大功率或變更原設計之特性及功能。

### 第十四條

低功率射頻電機之使用不得影響飛航安全及干擾合法通信；經發現有干擾現象時，應立即停用，並改善至無干擾時方得繼續使用。前項合法通信，指依電信法規定作業之無線電通信。

低功率射頻電機須忍受合法通信或工業、科學及醫療用電波輻射性電機設備之干擾。



91H0xxxx-xxM Rev.A

htc.com