

# Getting Started Presenter Mouse PM1200

We make sure

FUJITSU COMPUTERS  
SIEMENS

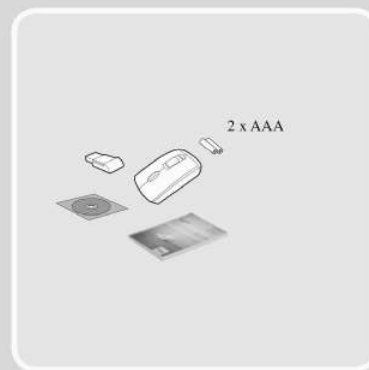
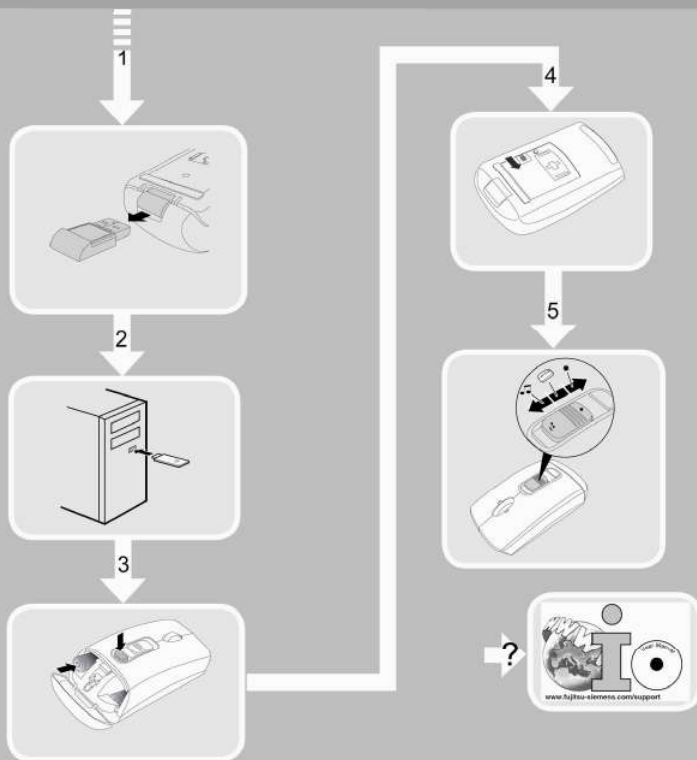

A26381-K421-2140-1-0919.3488 1

13.08.2007 08:46:08

**DE Wichtiger Hinweis:**  
Nicht allen Tinten- oder Lasergeräten ist eine Sicherheitsvorrichtung im Handbuch auf der mitgelieferten CD.

**CS Důležitý pokyn:**  
Dodržujte bezpečnostní pokyny v příručce "Sicherheit/Safety". (Bezpečnost a v případě dodržování příložné bezpečnostní pokyny a bezpečnostní pokyny uvedené v příručce na CD), které je součástí tohoto výrobku.

**DA Vigtig anvisning:**  
Læs nøje de medfølgende sikkerhedsanvisninger samt sikkerhedsanvisningerne i håndbogen på den medføjede CD.

**EN Important notice:**  
Please observe the attached safety notes and the safety notes in the manual on the CD supplied.

**ES Nota importante:**  
Observe las instrucciones de seguridad adjuntas y las instrucciones de seguridad del manual del CD suministrado.

**ET NB!**  
Järgige juuresolevat ning kaasolevat CD-l olemasolevaid kasutusjuhiseid.

**FI Tärkeä ohje:**  
Käsittele aina omia omia laitteita ja muita laitteita CD:n sisältämien käyttöohjeiden mukaisesti.

**FR Important :**  
Respectez les consignes de sécurité et celles figurant dans le manuel sur le CD fourni.

**HU Fontos megjegyzés:**  
Vegye figyelembe a mellékelt biztonsági előírásokat és a mellékelt CD-n levő kézikönyv biztonsági előírásokat.

**IT Istruzioni importanti:**  
Attenersi alle norme di sicurezza allegata e alle norme di sicurezza riportate nel manuale sul CD fornito.

**LT Svarbi pastaba:**  
Išsaugokite saugos instrukcijas, pateiktas šioje "Sicherheits/Safety" (Beige) ir "EasyGuide" (Šviesiai mėlyna) spalvos apvalkelių, pateiktose su šiuo CD-ROM disketu. Pateiktose su šiuo CD-ROM disketu.

**LV Svarīgi norāde:**  
Izlasiet arī pievienotās drošības norādes, kā arī norādījumus drošības drošības norādes komplektā ar šo CD-ROM disku.

**NL Belangrijke opmerking:**  
Niet alle tinten- of lasergeräten ist eine Sicherheitsvorrichtung im Handbuch auf der mitgelieferten CD.

**NO Viktig informasjon:**  
Ta hensyn til de vedlagte sikkerhetsanvisningene og sikkerhetsanvisningene i håndboken på den medføjede CD-pakke.

**PL Ważna wskazówka:**  
Należy uważnie przeczytać wskazówki bezpieczeństwa zawarte w instrukcji i w podręczniku, które znajdują się w pakiecie z dostarczonym CD-ROM.

**PT Nota importante:**  
Observe as instruções de segurança anexas e as instruções de segurança incluídas no manual do CD fornecido.

**RU Важное указание:**  
Соблюдайте указания по технике безопасности, приведенные в справочнике "Sicherheit/Safety". Соблюдайте прилагаемые указания по технике безопасности и указания по технике безопасности, включенные в справочник на вложенном в комплект поставки CD-диске.

**SK Dôležitá upozornenie:**  
Dodržujte príložné bezpečnostné pokyny a bezpečnostné pokyny v príručke na spoločodanom CD.

**SL Pomembno opozorilo:**  
Uporabite priložene varnostne navzile in napake v priručniku, ki ste ga prejeli na priloženem CD-ju.

**SV Viktigt!**  
Följ de viktigaste säkerhetsanvisningarna och säkerhetsanvisningarna i handboken som finns på den bifogade CD:n.

**TR Önemli uyarı:**  
Filtre her ayrı donanım için ayrı ayrı güvenlik talimatları CD'ye yerleştirildiğinde kullanılmalıdır.

**EL Σημαντική υπόδειξη:**  
Παρατηρήστε προσεκτικά τις οδηγίες ασφαλείας, καθώς και τις οδηγίες ασφαλείας, οι οποίες συνοδεύουν το παρόν CD-ROM.

**BG Важно указание:**  
Следвайте внимателно указанията за безопасност и указанията за безопасност, които са включени в комплекта с CD-ROM.

**RO Indicatie importanta:**  
Respectati precautiile privind siguranta anexate si instructiunile de siguranta din manualul de pe CD-ul care insozeteaza aparatul.

**Federal Communication Commission Interference Statement**

This equipment has been tested and found to comply with the limits for a Class B digital device, pursuant to Part 15 of the FCC Rules. These limits are designed to provide reasonable protection against harmful interference in a residential installation. This equipment generates, uses and can radiate radio frequency energy and, if not installed and used in accordance with the instructions, may cause harmful interference to radio communications. However, there is no guarantee that interference will not occur in a particular installation. If this equipment does cause harmful interference to radio or television reception, which can be determined by turning the equipment off and on, the user is encouraged to try to correct the interference by one of the following measures:

- Reorient or relocate the receiving antenna.
- Increase the separation between the equipment and receiver.
- Connect the equipment into an outlet on a circuit different from that to which the receiver is connected.
- Consult the dealer or an experienced radio/TV technician for help.

This device complies with Part 15 of the FCC Rules. Operation is subject to the following two conditions: (1) This device may not cause harmful interference, and (2) this device must accept any interference received, including interference that may cause undesired operation. FCC Caution: Any changes or modifications not expressly approved by the party responsible for compliance could void the user's authority to operate this equipment.

**IMPORTANT NOTE:**  
**FCC Radiation Exposure Statement:**  
This equipment complies with FCC radiation exposure limits set forth for an uncontrolled environment. End users must follow the specific operating instructions for satisfying RF exposure compliance. This transmitter must not be co-located or operating in conjunction with any other antenna or transmitter.



A26381-K421-2140-1-0919.3488 1

A26381-K421-2140-1-0919.3488 2

13.08.2007 08:46:11

3050001776000