

1



2



3

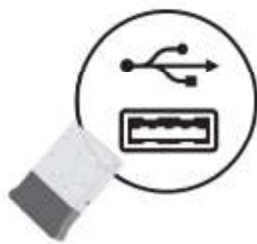

OR

A

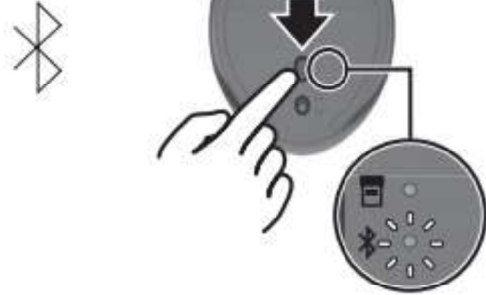

B

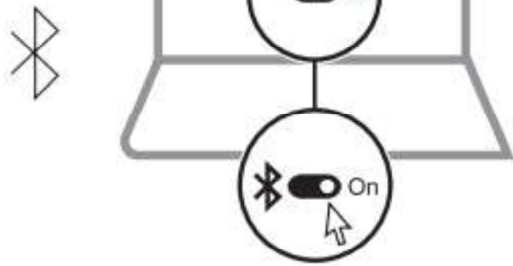

C

[www.hp.com/support](http://www.hp.com/support)



To download the *Bluetooth Pairing User Guide*, go to <http://www.hp.com/support>.

HSA-P012M+HSA-P012D



For regulatory information, scan the QR code or go to [www.hp.com/go/regulatory](http://www.hp.com/go/regulatory).

## ENGLISH

Connect the mouse to one computer using the receiver and one computer via Bluetooth®. To program the mouse buttons or change the DPI setting 800 to 4000 DPI, use the software. If the software does not download automatically, on your computer, open Microsoft Store or Apple Store. Search for HP Accessory Center, and then download the app.

the app. Components description

- ① Programmable forward button  
By default, press to display the next page in your application history.
- ② Programmable back button  
By default, press to display the previous page in your application history.
- ③ Programmable right-click button
- ④ Programmable scroll wheel  
To change the scrolling speed, use the software
- ⑤ Pairing button  
Press to switch between channels.
- ⑥ Receiver light  
Quickly blinking white (5 s): The receiver channel is currently selected and the receiver is not connected to a computer.  
Solid white (5 s): The mouse is connected to the computer to which the receiver is connected
- ⑦ Bluetooth pairing light  
Quickly blinking white (5 s): The Bluetooth channel is currently selected. If you attempted to pair the mouse to a computer, the pairing was not successful.  
Solid white (5 s): The mouse is connected to the computer that is paired to the Bluetooth channel.  
Slowly blinking white (180 s): The Bluetooth channel is in pairing mode.