

WARNING: Changes or modifications not expressly approved by the manufacturer could void the user's authority to operate the equipment.

NOTE: This equipment has been tested and found to comply with the limits for a Class B digital device, pursuant to Part 15 of the Federal Communications Commission (FCC) rules. These limits are designed to provide reasonable protection against harmful interference in a residential installation. This equipment generates, uses and can radiate radio frequency energy and, if not installed and used in accordance with the instructions, may cause harmful interference to radio communications. However, there is no guarantee that interference will not occur in a particular installation. If this equipment does cause harmful interference to radio or television reception, which can be determined by turning the equipment off and on, the user is encouraged to try to correct the interference by one or more of the following measures:

- Reorient or relocate the receiving antenna.
- Increase the separation between the equipment and receiver.
- Connect the equipment into an outlet on a circuit different from that to which the receiver is connected.
- Consult the dealer or an experienced radio/TV technician for help.



INSTALLATION INSTRUCTIONS

MICRO-TRANSMITTER MODEL 3070

Congratulations! You have just purchased a Micro-Code Digital Transmitter, which we believe to be the finest product of its kind on the market. With a little care this transmitter should provide you with many years of excellent service. Please take a moment to read the following instructions and you will find that setting your new transmitter will be quite an easy matter.

ACCESSING THE CODE SWITCH AND BATTERY COMPARTMENT

The model 3070 Micro-Transmitter case is composed of two halves that can be opened by inserting a small coin in the slot provided. A twisting motion of the coin will cause the two halves to separate. Once opened, you will have access to both the code setting switch and the battery compartment (See Diagram #1).

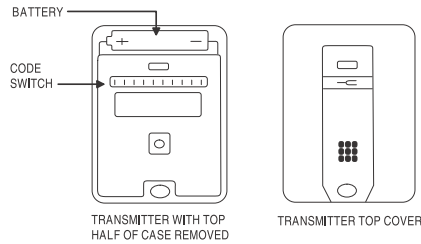

DIAGRAM #1



USA & Canada (800) 421-1587 & (800) 392-0123
 (760) 438-7000 - Toll Free FAX (800) 468-1340
 www.nortekcontrol.com

SELECTING A CODE

Set both transmitter and receiver switches to the code of your choice, being sure both are set the same since a different setting of just one switch will prevent operation. The digital code is determined by the position of 10 small switches numbered 1 through 10 located in the receiver and transmitter. Any combination of "on" or "off" positions can be selected by using a pencil or ball point pen. (Note: The switches are in the "on" position when the switch is depressed toward the number.) See diagram #2.



CODE SWITCH
DIAGRAM #2

Once the codes have been set, check operation and reassemble the transmitter case.

MICRO-TRANSMITTER INSTALLATION

This transmitter is completely self contained, including battery and can be operated while held in hand or while mounted in the car. It is supplied with "hook and loop" fabric for easy mounting or it may be added to your key chain using the slot provided.

TRANSMITTER BATTERY REPLACEMENT

Replacement battery - 12 volt alkaline lighter battery (Eveready A 23 or equivalent)

The transmitter battery can be checked or changed by opening the case using a small coin in the slot provided. A twisting motion of the coin will separate the case halves and provide access to the battery compartment. Simply slide out the old battery and slide in the new, remembering to observe the battery polarity molded on the case in the bottom of the battery compartment.

Note that if the red L.E.D. on your transmitter fails to light, you most likely have a weak or dead battery and it should be replaced. (see diagram #1)

OPERATIONAL CHECK

To check operation, move back a reasonable distance (about 50 ft.) and press the transmitter button.

Operation should be reliable at this distance but environment and location of both the transmitter and receiver will affect the range. If the transmitter is stowed well out of sight, it may be necessary to remove it from its mounting and hold near the windshield. Try different locations and positions. If operation is still unsatisfactory, the problem may be isolated by:

Checking the door operator: If the door will not open when the wall button is pressed, the problem is likely to be the operator. If the door will open by pressing the wall button, but not when the radio control button is pressed, the problem is probably in the radios.

Replacing the transmitter battery: If, after performing the above operational checks, the controls still do not function, they should be returned to your dealer for repair or replacement.

FCC & IC Notice

This device complies with Part 15 of the FCC Rules and Industry Canada license exempt standard(s). Operation is subject to the following two conditions:

- 1) This device may not cause harmful interference, and
- 2) This device must accept any interference received, including interference received that may cause undesired operation.

Le présent appareil est conforme aux CNR d'Industrie Canada applicables aux appareils radio exempts de licence. L'exploitation est autorisée aux deux conditions suivantes:

- 1) l'appareil ne doit pas produire de brouillage, et
- 2) l'utilisateur de l'appareil doit accepter tout brouillage radioélectrique subi, même si le brouillage est susceptible d'en compromettre le fonctionnement.