

Welcome to your

ADT Smoke Alarm

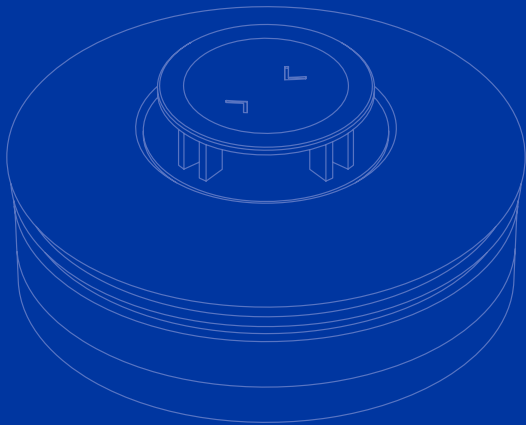

1 Setup

1. Take the ADT Smoke Alarm to where you intend to mount it after setup.
 - Make sure you are within 350 feet from the ADT Security Hub. (Exact range depends on your home's construction, environment, position of the ADT Security Hub, and the position and number of other connected devices.)
 - Make sure that your ADT Security Hub is disarmed before connecting a new device.
2. Use the SmartThings app on your smartphone to select the "My Home" tab. Select "Things", and then "Add a Thing".

3. Remove the tab on the smoke alarm marked "Pull This Tab". The red LED will blink once followed by a single blink of the yellow LED.

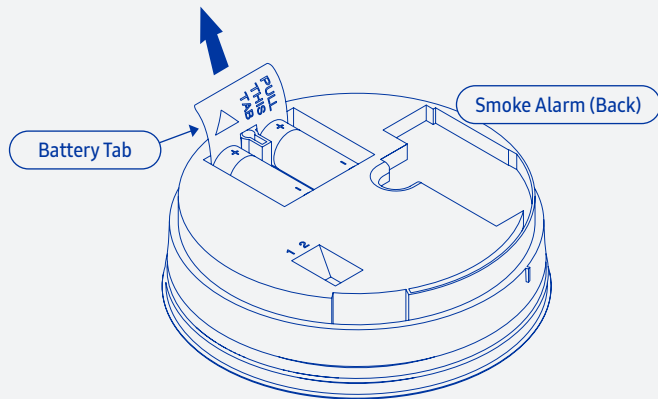

Setup

4. Use the SmartThings app to scan the QR code on the back of the alarm and then follow the on-screen instructions to complete setup.

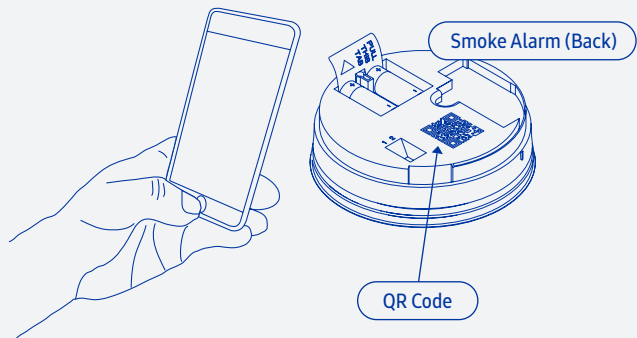

5. Remove the QR code from the back of the alarm and attach it to this guide for future reference.

2 Placement

Install the ADT Smoke Alarm in a place where the alarm can be heard easily. Ideally, per the National Fire Alarm Code (NFPA Standard 72), a smoke alarm should be installed:

- In all sleeping rooms and guest rooms.
- Outside of each separate dwelling unit sleeping area within 21 feet of any door to a sleeping room, the distance measured along a path of travel.
- On every level of a dwelling unit, including basements.

- On every level of a residential board and care occupancy (small facility), including basements and excluding crawl spaces and unfinished attics.
- In the living area(s) of a guest suite.
- In the living area(s) of a residential board and care occupancy (small facility).*

THIS EQUIPMENT SHOULD BE INSTALLED IN ACCORDANCE WITH THE NATIONAL FIRE PROTECTION ASSOCIATION'S STANDARD 72.**

* (Reprinted with permission from NFPA 72®, National Fire Alarm Code Copyright © 2007 National Fire Protection Association, Quincy, MA 02269. This reprinted material is not the complete and official position of the National Fire Protection Association, on the referenced subject which is represented only by the standard in its entirety.)

** (National Fire Alarm Code® and NFPA 72® are registered trademarks of the National Fire Protection Association, Inc., Quincy, MA 02269.)

The required number of smoke alarms might not provide reliable early warning protection for those areas separated by a door from the areas protected by the required smoke alarms.

For this reason, it is recommended that the householder consider the use of additional smoke alarms for those areas for increased protection. The additional areas include the basement, bedrooms, dining room, furnace room, utility room, and hallways not protected by the required smoke alarms.

The installation of smoke alarms in kitchens, attics (finished or unfinished), or garages is not normally recommended, as these locations occasionally experience conditions that can result in improper operation.

Important: Specific requirements for smoke alarm installation vary from state to state and from region to region. Check with your local Fire Department for current requirements in your area.

Sufficient smoke must enter your smoke alarm before it will respond. Your smoke alarm needs to be within 21 feet of the fire to respond quickly. Smoke alarms also need to be in positions where they can be heard throughout the property, so they can wake you and your family in time for everyone to escape.

A single smoke alarm will give some protection if it is properly installed, but most homes will require two or more to ensure that a reliable early warning is given. For recommended protection you should put individual smoke alarms in all rooms where fire is most likely to break out (apart from the kitchen and bathroom, where they should

be placed nearby). Your first smoke alarm should be located between the sleeping area and the most likely sources of fire (living room for example), but it should not be more than 21 feet from the door to any room where a fire may start and block your escape from the house.

Single-Story Dwellings: If the premises is one story, you should put your first smoke alarm in a corridor or hallway between the sleeping and living areas. Place it as near to the living area as possible, but make sure that it can be heard loudly enough in the bedroom to wake someone. In houses with more than one sleeping area, smoke alarms should be placed between each sleeping area and the living area.

Multiple-Story Dwellings: If your home has more than one floor, at least one smoke alarm should be fitted on each level. Suggested locations shown below:

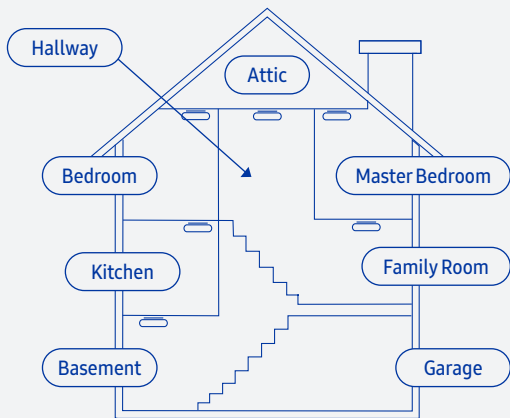

Recommended Protection: Fire authorities recommend you put individual smoke alarm in or near all rooms where fire is most likely to break out (apart from the locations to avoid e.g. bathrooms).

The living room is the most likely place for a fire to start at night, followed by the kitchen and then the dining room. Consideration should be given to installing smoke alarms in any bedrooms where fires might occur, for instance, where there is an electrical appliance such as an electric blanket or heater, or where the occupant is a smoker.

In addition, consideration should be also given to installing smoke alarms in any rooms where the occupant is unable to respond very well to a fire starting in that room, such as an elderly or sick person or a very young child. This device shall not be used with a detector guard.

For Ceiling Mounting:

Hot smoke rises and spreads out, so a central ceiling position is the recommended location. The air is “dead” and does not move in corners, therefore smoke alarms must be mounted away from corners. Keep at least 12 inches from walls and corners. Additionally, mount the unit at least 12 inches from any light fitting or decorative object which might prevent smoke entering the smoke alarm. Do not attach the detector to removable ceiling panels.

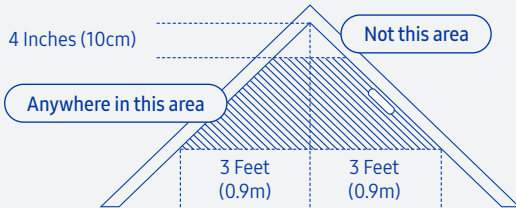

For Wall Mounting:

If ceiling mounting is impractical, smoke alarms may be mounted on a wall (if local ordinances permit), provided that:

- The top of the detection element is between 6 inches and 12 inches below the ceiling.
- The bottom of the detection element is above the level of any door openings.

Wall mounting should only be considered where close spaced beams or similar obstructions may preclude ceiling mounting. It is considered to be the responsibility of the installer or homeowner to determine if the presence of asbestos in the ceiling material would make ceiling mounting impractical.

Placement

On a sloping or peaked ceiling, install a smoke alarm within 24 inches of the peak (measured vertically). If this height is less than 24 inches the ceiling is regarded as being flat.

Smoke Alarms should face out in this position:

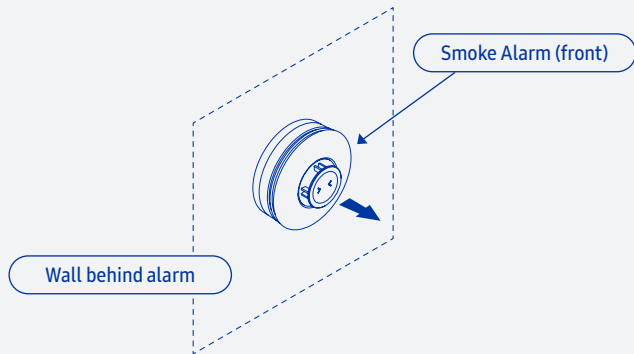

3 Mounting

1. Install the mounting base using the two screws and anchors provided.

Ceiling Mount

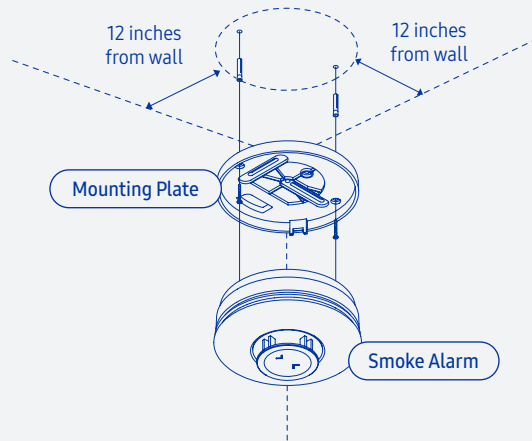

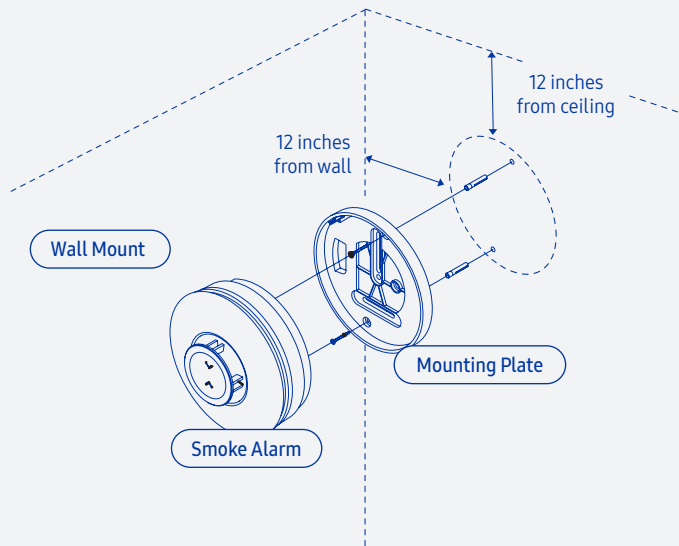

2. Fit the alarm inside the base by aligning it over the base, then turn the alarm in a clockwise direction until it clicks into place.

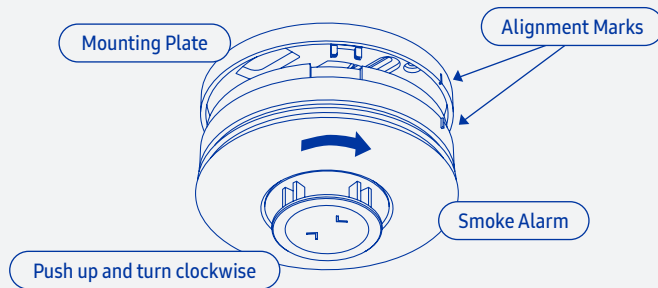

3. Test the alarm after completing the installation (see following section for details).

WARNING: please read carefully and thoroughly.

- NFPA 72 states: Fire-warning equipment for residential occupancies are capable of protecting about half of the occupants in potentially fatal fires. Victims are often intimate with the fire, too old or too young, or physically or mentally impaired such that they cannot escape even when warned early enough that escape should be possible. For these people, other strategies such as protection-in-place or assisted escape or rescue would be necessary.
- Although smoke alarms can help save lives by providing an early warning of a fire, they are not a substitute for an insurance policy. Homeowners and renters should have adequate insurance to protect their properties.

- A battery powered alarm must have a battery of the specified type, in good condition and installed properly.
- Smoke alarms cannot provide an alarm if smoke does not reach the detector. Therefore, smoke alarms may not sense fires starting in chimneys, walls, on roofs, on the other side of a closed door or on a different floor.
- Studies have shown that smoke and heat alarms may not awaken all sleeping individuals, and that it is the responsibility of individuals in the household that are capable of assisting others to provide assistance to those who may not be awakened by the alarm sound or those who may be incapable of safely evacuating the area unassisted.

- The use of alcohol or drugs may also impair one's ability to hear the smoke alarm. For maximum protection, a smoke alarm should be installed in each sleeping area on every level of a home.
- Smoke alarms must be tested regularly to make sure the batteries and the alarm circuits are in good operating condition.
- Family Escape Plan: According to National Fire Protection Association (NFPA) there often is very little time between the detection of a fire and the time it becomes deadly. This interval can be as little as 1 or 2 minutes. Planning and practicing for fire conditions with a focus on rapid exit from the residence are important. Drills should be held so that all family members know the action to be taken.

- If the alarm is located outside the sleeping room or on a different floor, it may not wake up a sound sleeper.

Safety Tips:

- Practice using different ways out.
- Make a home escape plan. Draw a map of your home showing all doors and windows. Discuss the plan with everyone in your home.
- Know at least two ways out of every room, if possible. Make sure all doors and windows leading outside open easily.
- Practice your home fire drill at night and during the day with everyone in your home, twice a year.

Mounting

- Have an outside meeting place (like a tree, light pole, or mailbox) a safe distance from the home where everyone should meet.
- Teach children how to escape on their own in case you can't help them.
- Close doors behind you as you leave.

4 Testing

Test the ADT Smoke Alarm after installation and then on a weekly basis.

Note: If you have an ADT professional monitoring service activated, make sure that your ADT Security Hub is in Test Mode to avoid triggering a false alarm. See the **ADT Security Hub User Guide** for more details.

Smoke Test: Hold a match or other smoldering stick near the alarm with caution and gently blow smoke through the alarm until it goes off.

Direct Heat Test: Direct heat toward the alarm, using a hair dryer. Be sure to hold the heat source about 12 inches from the alarm to avoid damaging the plastic. The alarm will reset once it cools down.

Alarm Operation Test: Push and hold the Test button on the alarm for a minimum of 5 seconds. The alarm will sound, and the red LED blink. The ADT Security Hub will display an alert for the smoke alarm.

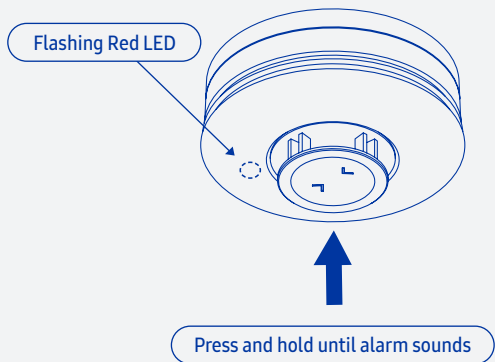

If the alarm fails to activate with any of these tests, clean it and repeat the tests. If cleaning does not restore the alarm to normal operation, it should be replaced. Check the date when the alarm should be replaced which is given on the sidewall of the alarm.

YOUR ALARM SHOULD BE CLEANED AT LEAST ONCE A YEAR.

To clean your alarm, remove it from the mounting base. You can clean the interior by using compressed air or a vacuum cleaner hose to blow or vacuum through the openings. The outside can be wiped with a dry cloth. After cleaning, reinstall and test your alarm as described above.

5 Troubleshooting

If the alarm emits 2 short beeps with the yellow LED blinking twice every 48 seconds, it indicates an issue with the alarm, which must then be replaced.

To silence the beeps and stop the yellow LED flashes, you can press the test button and repeat as required, but after 4 hours your alarm will no longer be supervised by the security system.

If the alarm sounds without any apparent smoke being present, press the test button to silence the alarm for 10 minutes. If the alarm sounds again, it may be dirty.

Pressing the test button again, within 4 minutes of the alarm resounding, will get the alarm to re-calibrate. If the alarm sounds again, follow the cleaning procedure described above.

6 Replacing Batteries

The alarm regularly checks for low batteries, and will alert you if a low battery is detected. The alarm will also beep and the yellow LED flash to warn you the batteries must be replaced.

Pressing the hush button will silence the beep and the flashing yellow LED for 12 hours, if no other trouble conditions exist.

WARNING: Use only batteries specified. Use of different batteries may have a detrimental effect on the smoke alarm. Removal of the batteries will render this alarm inoperative.

1. Remove the alarm from the mounting base by twisting it counterclockwise.

Replacing Batteries

2. Remove the old batteries and wait a minimum of 20 seconds before installing 2 new CR123A batteries. Be sure to install the battery correctly.

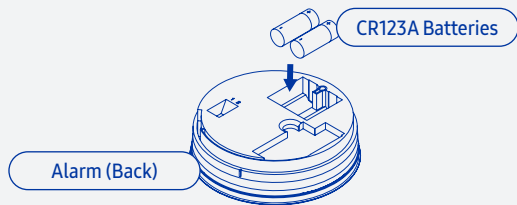

3. Attach the alarm onto the mounting base by matching up the alignment marks and then turning the alarm clockwise until it clicks into place.
4. Wait for a single blink of the red LED, followed by a single blink of the yellow LED. The alarm is now in Standby mode.

Using your ADT Smoke Alarm

7 Use

What You Hear / See

Siren at full volume,
red LED flashing.

No siren, red LED flash
every 8 seconds.

1 beep plus yellow LED flash
every 48 seconds.

2 beeps plus yellow LED flash
every 48 seconds.

3 beeps plus yellow LED flash
every 48 seconds.

What It Means

Sensing fire.

Smoke alarm hushed.

Batteries low.

Smoke and/or heat
sensor error.

Product expired
(10 year typical life).

What To Do

If safe, put out the source of the smoke. If unknown, get out of the house immediately. Follow appropriate fire safety guidelines at all times.

No action required.

Replace batteries.

Replace unit with same brand.

Replace unit with same brand.

8 Suggestions

The ADT Smoke Alarm monitors for smoke and extreme temperatures in your home (heat above 135°F, or freeze below 40°F).

When smoke or extreme temperatures are detected, the loud local alarm sounds and a notification is sent to your ADT Security Hub. Your ADT Security Hub can then send an alert to your smartphone, automate connected devices, or initiate optional ADT professional monitoring services (additional fees apply).

There are many ways you can use an ADT Smoke Alarm in your home:

- Put one in your living room and set it to initiate optional ADT professional monitoring service when smoke is detected in your home (additional fees apply).

- Put one in your bedroom and set it to turn on connected lights when smoke is detected.
- Put one in your hallway and set it to turn off a connected thermostat to avoid spreading smoke through your home if a fire is detected.
- Put one in your home and set a connected camera to record video when smoke is detected (additional fees may apply).

Note: To ensure proper functioning, all connected devices must be configured correctly. This alarm is not designed to be interconnected with other manufacturers' products unless otherwise specified

Visit [SmartThings.com/Welcome](https://www.smartthings.com/welcome) for more ideas, tips, and special offers.

9 Works With SmartThings

SmartThings works with a wide range of connected devices, including lights, cameras, locks, thermostats, and sensors. It also works with the **Google Assistant** and **Amazon Alexa** so you can control your smart home with voice commands.

Look for the **Works with SmartThings** label next time you're buying a connected device for your home, or visit **SmartThings.com** to see the full list of compatible devices.





Health, Safety and Regulatory Guide

Safety Instructions

- Read, keep, and follow these instructions. Heed all warnings.
- Clean only with a dry cloth.
- Do not install near any heat sources such as radiators, heat registers, stoves, or other apparatus (including amplifiers) that produce heat.
- Only use attachments and accessories specified by the Manufacturer.
- Read our Product Usage Guidelines at: www.SmartThings.com/Guidelines.

Safety Instructions: ADT Security Hub

Limitations of Alarm Products: This product should be tested periodically to make sure it is working properly. The product, if used properly, may reduce the risk of burglary, robbery, and other adverse events that have the potential to result in injury or loss of life; however, the manufacturer is not an insurer. This product is neither insurance nor a guarantee that such an event will be prevented, and users should protect themselves with proper insurance. The manufacturer makes no representation that this product cannot be compromised or circumvented, that it will provide an adequate warning, or that it will prevent any personal injuries, property damage, or other losses. Like any alarm product, it may be bypassed, it is subject to compromise, and it may fail to warn for a variety of reasons, including, but not limited to:

- improper installation or positioning; improper maintenance; tampering; dead or improperly installed batteries; sensing limitations; component failures; receivers;
- intrusions may be outside of a product's designated range and certain environmental conditions may impact performance, and audible alarm signals may be outside of hearing range, muted by doors, walls, and floors, unheard by deep sleepers or the hearing-impaired, or overwhelmed by other sounds.

Risk of Noise Induced Hearing Loss: The ADT Security Hub is equipped with a warning siren. Exposure to high sound levels or prolonged exposure to the warning siren can result in Noise Induced Hearing Loss (NIHL).

Avoid installing the SmartThings Hub near or inside sources of metal, radio or electromagnetic interference.



WARNING: No user-serviceable parts inside. Refer all servicing to qualified service personnel.
 IMPORTANT CONSUMER INFORMATION: Please read before activating or using the device.
 WARNING: This product contains chemicals known to the State of California to cause cancer and reproductive toxicity. For more information, please call 1-800-SAMSUNG (726-7864).



Safety Instructions: ADT Detectors

- Do not expose products to moisture or extreme temperature.
- Make sure that products are used in a dry location and within the recommended operating temperature:
 - ADT Security Hub: 32° to 120° F (0° to 49° C)
 - ADT Door and Window Detector: 32° to 120° F (0° to 49° C)
 - ADT Motion Detector: 32° to 120° F (0° to 49° C).
 - ADT Water Leak Detector: 32° to 104° F (0° to 40° C)
 - ADT Smoke Alarm: 32° to 100° F (0° to 40° C)
 - ADT Carbon Monoxide Alarm: 32° to 104° F (0° to 40° C)
 - ADT Keychain Remote: 32° to 120° F (0° to 49° C)
- Make sure that the ADT Door and Window Detector is not positioned near metal or metallic surfaces. Example: foil wallpaper.
- The ADT Water Leak Detector is water resistant but not waterproof; avoid submerging it in water or liquid to keep interior dry and to protect batteries. All other detectors should not be used near water or exposed to dripping or splashing of any water or liquid.

CAUTION: RISK OF EXPLOSION IF BATTERY IS REPLACED BY AN INCORRECT TYPE. DISPOSE OF USED BATTERIES ACCORDING TO THE INSTRUCTIONS.

Disclaimer

Some content and services accessible through this device belong to third parties and are protected by copyright, patent, trademark and/or other intellectual property laws. Such content and services are provided solely for your personal non-commercial use.

You may not use any content or services in a manner that has not been authorised by the content owner or service provider. Without limiting the foregoing, unless expressly authorised by the applicable content owner or service provider, you may not modify, copy, republish, upload, post, transmit, translate, sell, create derivative works, exploit, or distribute in any manner or medium any content or services displayed through this device.

US Certifications

Certified under FCC Part 15.



ADT Security Hub

Manufacturer Model : F-ADT-HUB-1

FCC ID : EF400150

Battery Type: Shenzhen Grepow Battery CO

LTD, MFG P/N: GLP823990

ADT Door and Window Detector

Manufacturer Model : F-ADT-DW-1

FCC ID : EF400151

Battery Type: 1 x CR2450 (Panasonic)

ADT Motion Detector

Manufacturer Model : F-ADT-PIR-1

FCC ID : EF400152

Battery Type: 1 x CR123A (Panasonic)

ADT Smoke Alarm

Manufacturer Model : F-ADT-SMK-1

FCC ID : EF400153

Battery Type: 2 x CR123A (Panasonic)

Battery can be purchased at any electronics store.

ADT Carbon Monoxide Alarm

Manufacturer Model : F-ADT-CO-1

FCC ID : EF400154

Battery Type: 2 x AAA / MN2400 (Duracell)

Battery can be purchased at any electronics store.

ADT Keychain Remote

Manufacturer Model : F-ADT-KEY-1

FCC ID : EF400155

Battery Type: 1 x CR2450 (Panasonic)

ADT Water Leak Detector

Manufacturer Model : F-ADT-WTR-1

FCC ID : EF400156

Battery Type: CR123A

Visit SmartThings.com/Support-ADT for instructions on battery replacement. All specifications subject to change without notice.

For each of the devices listed in the previous table, the following FCC statements and information apply:

FCC Statement

This device complies with Part 15 of the FCC rules. Operation is subject to the following conditions: (1) This device may not cause harmful interference, and (2) This device must accept any interference received, including interference that may cause undesired operation.

FCC Caution

Any changes or modifications not expressly approved by the party responsible for compliance could void the user's authority to operate this equipment.

Important Note: FCC Radiation Exposure Statement

To satisfy FCC radiation exposure safety requirements for the ADT Security Hub, keep the device at least 20cm from your body (excluding extremities: hands, wrists, feet, and ankles).



Information to the User

This equipment has been tested and found to comply with the limits for a Class B digital device, pursuant to Part 15 of the FCC Rules. These limits are designed to provide reasonable protection against harmful interference in a residential installation.

This equipment generates and can radiate radio frequency energy and, if not installed and used in accordance with the instructions, may cause harmful interference to radio communications. However, there is no guarantee that interference will not occur in a particular installation. If this equipment does cause harmful interference to radio or television reception, which can be determined by turning the equipment off and on, the user is encouraged to try to correct the interference by one or more of the following measures:

- Reorient or relocate the receiving antenna.
- Increase the separation between equipment and the receiver.
- Connect the equipment to an outlet on a circuit different from that to which the receiver is connected.
- Consult the dealer or an experienced radio/TV technician for help.

Covered by one or more claims of patents <http://sipcollc.com/patent-list/> and <http://intusiq.com/patent-list/>.

Correct disposal of batteries in this product

(Waste Electrical & Electronic Equipment)
(Applicable in countries with separate collection systems)



This marking on the product, accessories or literature indicates that the product, its electronic accessories (e.g. charger, headset, USB cable), and batteries should not be disposed of with other household waste.

To prevent possible harm to the environment or human health from uncontrolled waste disposal, please separate these items from other types of waste and recycle them responsibly to promote the sustainable reuse of material resources. Where marked, the chemical symbols Hg, Cd or Pb indicate that the battery contains mercury, cadmium or lead above the reference levels in EC Directive 2006/66. If batteries are not properly disposed of, these substances can cause harm to human health or the environment.

Household users should contact either the retailer or installer from which they purchased this product, or their local government office, for details of where and how they can take these items for environmentally safe recycling. Business users should contact their supplier and check the terms and conditions of the purchase contract. This product and its electronic accessories should not be mixed with other commercial wastes for disposal.

WARNING: Failure to follow these warnings and instructions can lead to heat generation, rupture, leakage, explosion, fire, or other injury, or damage. Do not insert the battery into the compartment in the wrong direction. Always replace the battery with the same or equivalent type. Never recharge or disassemble the battery. Never place the battery in fire or water. Always keep batteries away from small children. If batteries are swallowed, promptly see a doctor.

Always dispose and/or recycle used batteries in accordance with the hazardous waste recovery and recycling regulations for your location. Your city, state, or country may also require you to comply with additional handling, recycling, and disposal requirements.

CONSTANT EXPOSURES TO HIGH OR LOW TEMPERATURES OR HIGH HUMIDITY MAY REDUCE BATTERY LIFE.

One (1) Year Limited Warranty

SmartThings, Inc. warrants this product (the "Product") against defects in materials and/or workmanship under normal use for a period of ONE (1) YEAR from the date of purchase by the original purchaser ("Warranty Period"). If a defect arises and a valid claim is received within the Warranty Period, then as your sole remedy (and SmartThings' sole liability), SmartThings will at its option either 1) repair the defect at no charge, using new or refurbished replacement parts, or 2) replace the Product with a new product that is functionally equivalent to the original, in each case within 30 days following receipt of the returned Product. A replacement product or part, assumes the remaining warranty of the original Product. When a Product or part is exchanged, any replacement item becomes your property and the replaced Product or part becomes SmartThings' property.

Obtaining Service: To obtain warranty service, visit Support.SmartThings.com to speak with a service agent or open a service request. Please be prepared to describe the Product that needs service and the nature of the problem. A purchase receipt is required. The Product must be insured, and shipped freight prepaid and securely packaged. You must contact support for a Return Material Authorization Number ("RMA Number") before shipping any Product, and include the RMA Number,

a copy of your purchase receipt and a description of the problem you are experiencing with the Product. Any claim under this Limited Warranty must be submitted to SmartThings before the end of the Warranty Period. Exclusions: This warranty does not apply to: a) damage caused by failure to follow instructions relating to the Product's use or the installation of components; b) damage caused by accident, abuse, misuse, transport, neglect, fire, floods, earthquake or other external causes; c) damage caused by service performed by anyone who is not an authorized representative of SmartThings; d) accessories used in conjunction with a covered Product; e) a Product or part that has been modified to alter functionality or capability; f) items intended to be periodically replaced by the purchaser during the normal life of the Product, including, without limitation, batteries, bulbs or cables; g) a Product that is used commercially or for a commercial purpose, in each case as determined by SmartThings. EXCEPT FOR BODILY INJURY, SMARTTHINGS SHALL NOT BE LIABLE FOR (I) ANY LOST PROFITS, COST OF PROCUREMENT OF SUBSTITUTE PRODUCTS, OR ANY INCIDENTAL OR CONSEQUENTIAL DAMAGES, OR (II) ANY AMOUNTS IN EXCESS OF THE PURCHASE PRICE FOR THE PRODUCT, IN EACH CASE WHETHER RESULTING FROM THE USE OF OR INABILITY TO USE THIS PRODUCT, OR ARISING OUT OF ANY BREACH OF THIS WARRANTY, EVEN IF COMPANY HAS BEEN ADVISED OF THE POSSIBILITY OF SUCH DAMAGES. SOME STATES DO NOT ALLOW THE EXCLUSION OR LIMITATION OF INCIDENTAL OR CONSEQUENTIAL DAMAGES, SO THE ABOVE LIMITATION AND EXCLUSIONS MAY NOT APPLY TO YOU. TO THE EXTENT PERMITTED BY APPLICABLE LAW, SMARTTHINGS DISCLAIMS ANY AND ALL STATUTORY OR IMPLIED WARRANTIES, INCLUDING WITHOUT LIMITATION, WARRANTIES OF MERCHANTABILITY, FITNESS FOR A PARTICULAR PURPOSE AND WARRANTIES AGAINST HIDDEN OR LATENT DEFECTS. IF SMARTTHINGS CANNOT LAWFULLY DISCLAIM STATUTORY OR IMPLIED WARRANTIES, THEN TO THE EXTENT PERMITTED BY LAW, ALL SUCH WARRANTIES SHALL BE LIMITED IN DURATION TO THE WARRANTY PERIOD. SOME STATES DO NOT ALLOW LIMITATIONS ON HOW LONG AN IMPLIED WARRANTY LASTS, SO THE ABOVE LIMITATIONS MAY NOT APPLY TO YOU.

This warranty gives you specific legal rights and you may also have other rights, which vary from state to state. To exercise your rights under this warranty, please follow the instructions above under the heading "Obtaining Service", or contact SmartThings at SmartThings, Inc., 665 Clyde Ave, Mountain View, CA 94043, USA. Samsung is a registered trademark of Samsung Electronics Co., Ltd. Android is a trademark of Google Inc. Other marks are the property of their respective owners. Device purchase subject to additional SmartThings terms and conditions.

Samsung SmartThings Use of Free and Open-Source Software

This document contains licensing information relating to the use of free and open-source software (FOSS) with or within the Samsung SmartThings software. Any terms, conditions, or restrictions on

FOSS included within the Samsung SmartThings software that are not included within the original FOSS licenses are offered and imposed by Samsung SmartThings alone. The authors, licensors, and distributors of the FOSS disclaim all express or implied conditions, representations, and warranties relating to the FOSS and any liability arising from use and distribution of the FOSS. A document containing the complete and current list of FOSS packages used in Samsung SmartThings software and mobile applications can be found here: www.SmartThings.com/FOSS

The document at the URL above identifies the FOSS packages used in the Samsung SmartThings Hub software, the FOSS licenses that Samsung SmartThings believes govern those FOSS packages, and copyright and license notices associated with Samsung SmartThings' use of the FOSS. While Samsung SmartThings has sought to provide complete and accurate licensing information for each FOSS package, Samsung SmartThings does not represent or warrant that the licensing information provided herein is correct or error-free. Recipients of the product have the option to investigate the identified FOSS packages to confirm the accuracy of the licensing information provided herein. Recipients are also encouraged to notify Samsung SmartThings of any inaccurate information or errors found in these notices. Certain FOSS licenses, such as the GNU General Public License, GNU Lesser (or Library) General Public License, and Mozilla Public License, require Samsung SmartThings to make available to recipients the source code corresponding to FOSS binaries distributed under those licenses. Users who would like to download source code used by Samsung SmartThings under those licenses can do so by logging in with their Samsung SmartThings account here: https://graph.api.smartthings.com/foss_sources.

Users with questions or concerns regarding Samsung SmartThings use of Free or Open-Source Software can contact us via email at: foss@smartthings.com

Deleting a Location (Home, Office, etc) in the SmartThings app will cause all Z-Wave devices to be disconnected from the ADT Security Hub, requiring them to be excluded and re-included. Visit Support.SmartThings.com for more information. P/N 10015713

SmartThings, Inc., 665 Clyde Ave, Mountain View, CA 94043, USA. Revised 05/17. Copyright 2017 SmartThings, Inc. All rights reserved. ADT and the ADT logo are marks and/or registered marks of ADT. Unauthorized use is strictly prohibited. CA ACO7155, 974443, PPO17232; FL EF0001121; LA F1639, F1640, F1643, F1654; MA 172C; NC Licensed by the Alarm Systems Licensing Board of the State of North Carolina, 7535P2, 7561P2, 7562P10, 7563P7, 7565P1, 7566P9, 7564P4; NY 12000305615; PA 090797; MS 15019511.