

Wireless Controller/Receiver Users Manual

Getting Started

Thank you for choosing this 2.4G Wireless Controller product. It operates with digital radio technology to ensure no hinder communication between your computer without connecting cable.

The transmission and receiving of controller are free from angle restriction.

Package Content

1 x Remote Controller (TPC-C001RC)

1 x AAA Battery

Electrical Information

1. Frequency Range: 2403 MHz ~ 2480 MHz
2. Input Voltage / current:
Remote Controller (TPC-C001RC) : 1.5Vdc. 30mA
3. TPC-C001RC– Battery State: Cut off detect voltage : 0.9V +/- 0.1V
4. Operation Distance: 10 meter at free space

Note: The distance between the controller and PC system should not exceed 10 M.

Step 1: Insert battery

The controller requires one NiMH AAA batteries.

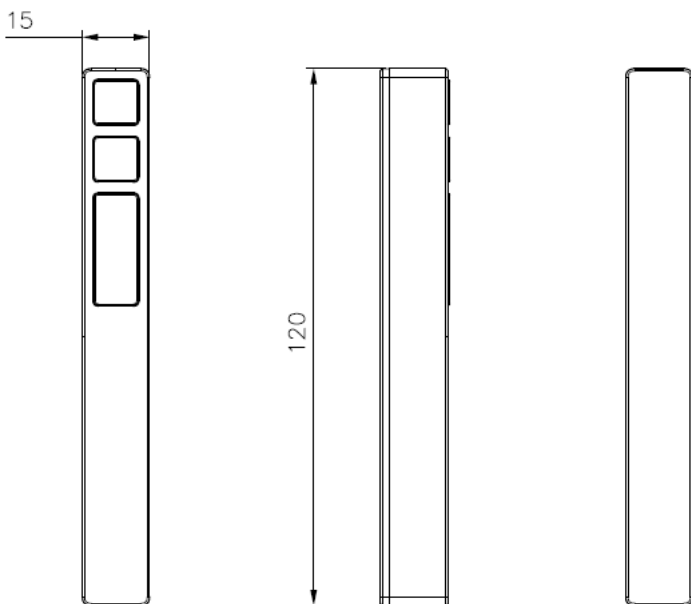

SCALE 1,000

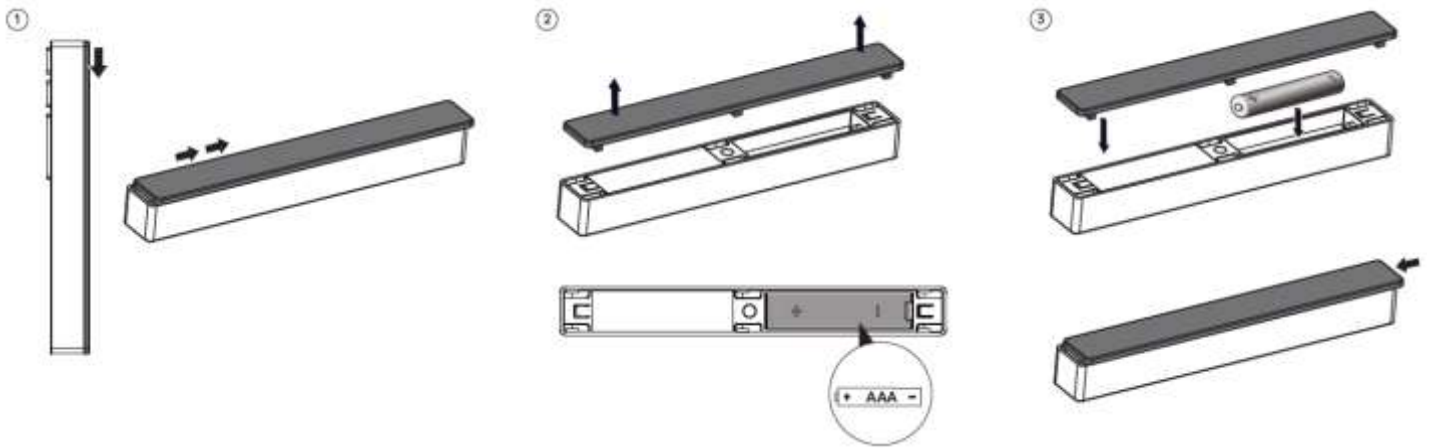

CAUTION: Risk of explosion if battery is replaced by an incorrect type.
 Dispose of used batteries according to instructions.
 Refer to "Important Battery Information" for disposal instructions.

Step 2: Install

- Press any buttons to work.

Cleaning the controller

- Use disinfectant wipes to clean the controller.
- Do not use any dissolvent, which may damage the surface of your controller.

FEDERAL COMMUNICATIONS COMMISSION (FCC) STATEMENT

This equipment has been tested and found to comply with the limits for a Class B digital device, Pursuant to Part 15 the FCC rules. These limits are designed to provide reasonable protection against harmful interference in a residential installation. This equipment generates, uses and can radiate radio frequency energy and, if not installed and used in accordance with the instructions, may cause harmful interference to radio communications. However, there is no guarantee that interference will not occur in a particular installation. If this equipment does cause harmful interference will not occur in a particular installation. If this equipment does cause harmful interference to radio or television reception, which can be determined by turning the equipment off and on, the user is encouraged to try to correct the interference by one or more of the following measures:

- Reorient or relocate the receiving antenna.
- Increase the separation between the equipment and receiver.
- Connect the equipment into an outlet on a circuit different from that to which the receiver is connected.
- Consult the dealer or an experienced radio/TV technician for help.

This device complies with part 15 of the FCC rules. Operation is subject to the following two conditions:

(1) This device may not cause harmful Interference, and (2) This device must accept any interference received, including interference that may cause undesired operation.

WARNING:

You are cautioned that changes or modifications not expressly approved by the party responsible for compliance could void your authority to operate the equipment.

CAUTION: AVOID PROLONGED USE OF THE KEYBOARD WITHOUT BREAKS.

Take regular breaks and keep a good posture. Consult your physician promptly if you notice any lost of motion or pain in your wrist when using the keyboard.

IMPORTANT BATTERY INFORMATION

- Keep batteries out of reach of children.
- Insert the batteries in the proper direction as indicated by the positive (+) and negative (-) markings in the battery chamber.
- Do not mix old and new batteries or batteries of different types (for example, carbon and alkaline batteries).
- Always remove old, weak, or worn-out batteries promptly and recycle or proper disposal of them in accordance with Local and National Disposal Regulations.
- If a battery leaks, remove all batteries and recycle or dispose of them in accordance with the battery manufacture's instructions and Local and National Disposal Regulations. Before inserting new batteries, thoroughly clean the compartment with a damp paper towel, or follow the battery manufacture's recommendations for cleanup. If fluid from the battery comes into contact with skin or clothes, flush skin with water immediately.
- Remove the batteries if your device is to be stored for an extended period of time without being used.