

Photographs of EUT Setup and Antenna Location

The photographs of EUT and setup for SAR testing are shown as follows.

<Front Face View> Tablet

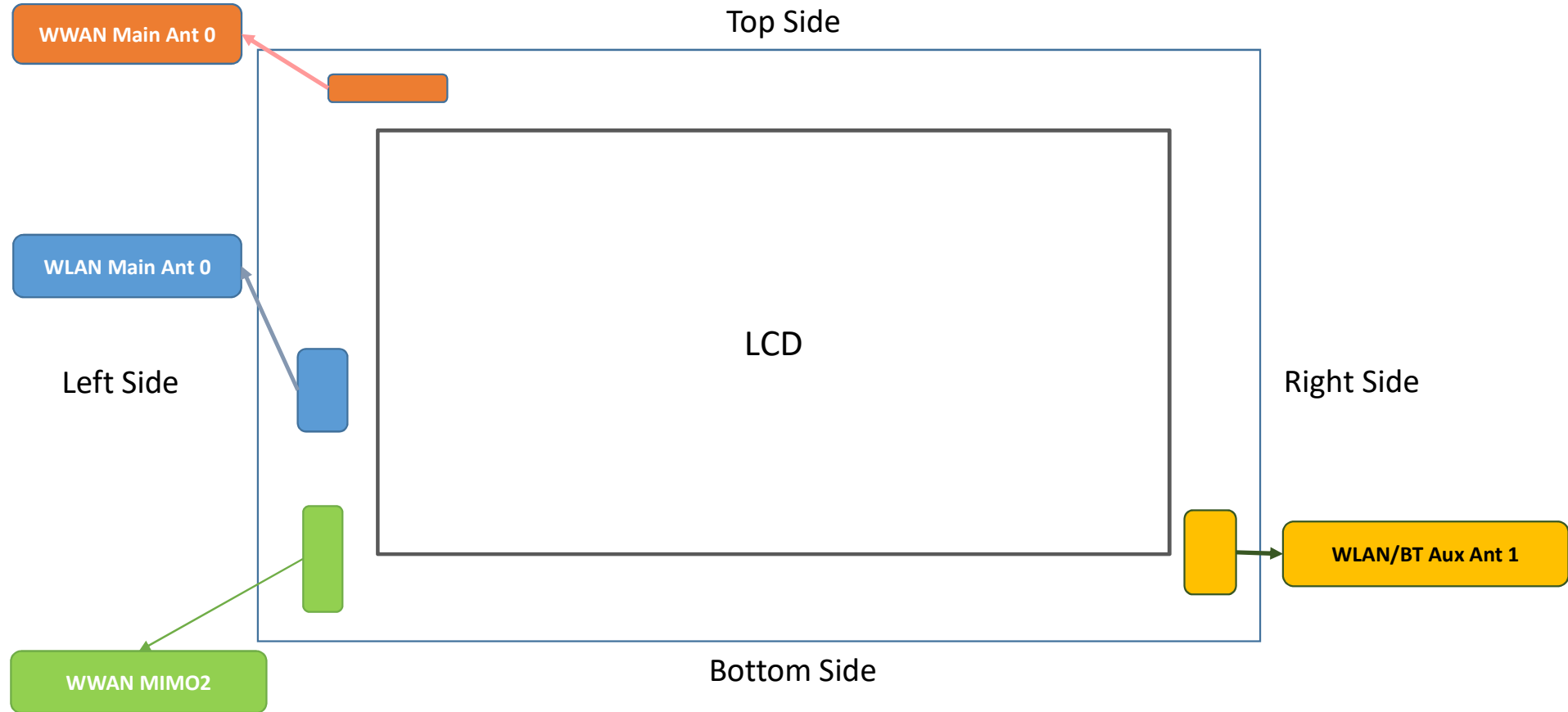

Antenna	To Top Side	To Bottom Side	To Left Side	To Right Side
	(mm)	(mm)	(mm)	(mm)
WWAN Main Ant 0	7.00	170.00	30.00	156.50
WWAN MIMO2	139.00	17.00	5.50	243.00
WLAN Main Ant 0	95.00	69.00	5.00	243.00
WLAN/BT Aux Ant 1	157.00	17.00	243.00	8.50

<Right Side View> Convertible PC Tablet Mode

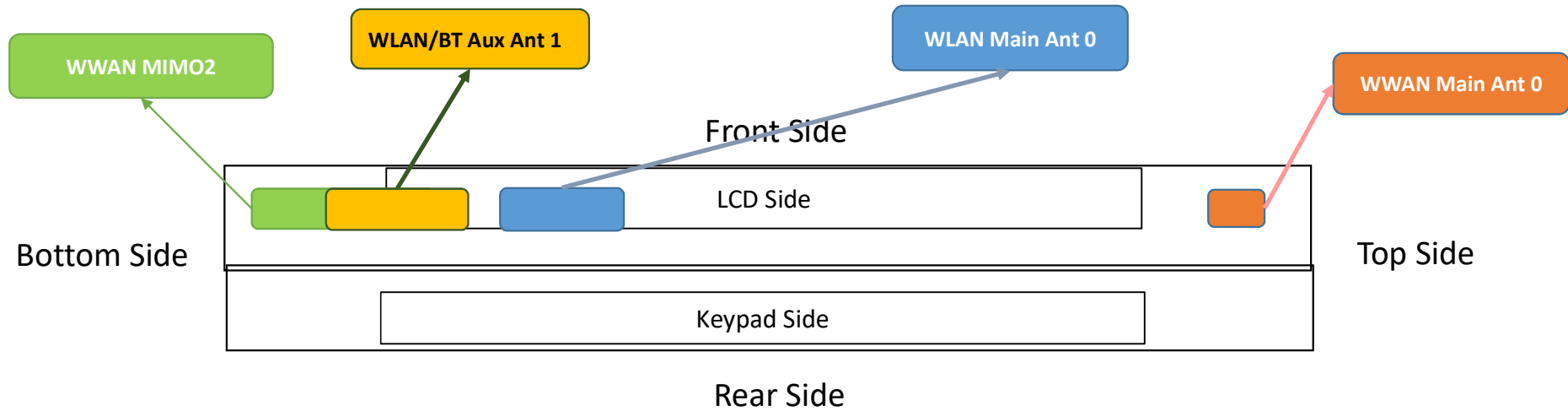

Antenna	To Front Side	To Rear Side
	(mm)	(mm)
WWAN Main Ant 0	6.90	2.10
WWAN MIMO2	7.29	2.15
WLAN Main Ant 0	7.29	2.15
WLAN/BT Aux Ant 1	7.26	2.18

<Front Face View> Laptop Mode (180°)

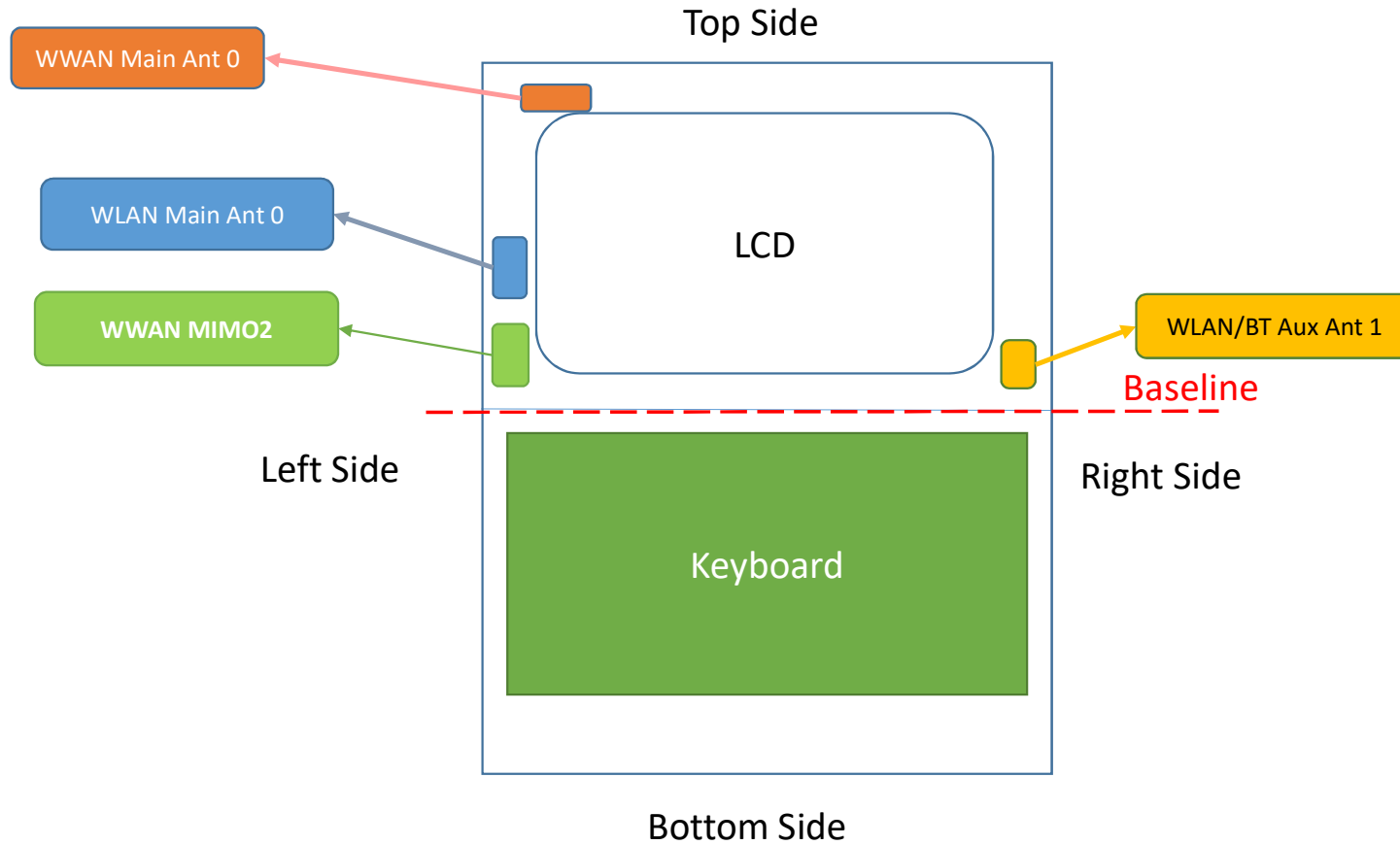

Antenna	To Top Side	To Baseline	To Left Side	To Right Side
	(mm)	(mm)	(mm)	(mm)
WWAN Main Ant 0	7.00	170.00	30.00	156.50
WWAN MIMO2	139.00	17.00	5.50	243.00
WLAN Main Ant 0	95.00	69.00	5.00	243.00
WLAN/BT Aux Ant 1	157.00	17.00	243.00	8.50

<Right Side View> Laptop Mode(90°)



Antenna	Rear Face
	(mm)
WWAN Main Ant 0	2.10
WWAN MIMO2	2.10
WLAN Main Ant 0	2.15
WLAN/BT Aux Ant 1	2.15

<Photographs of Body SAR Test Setup>

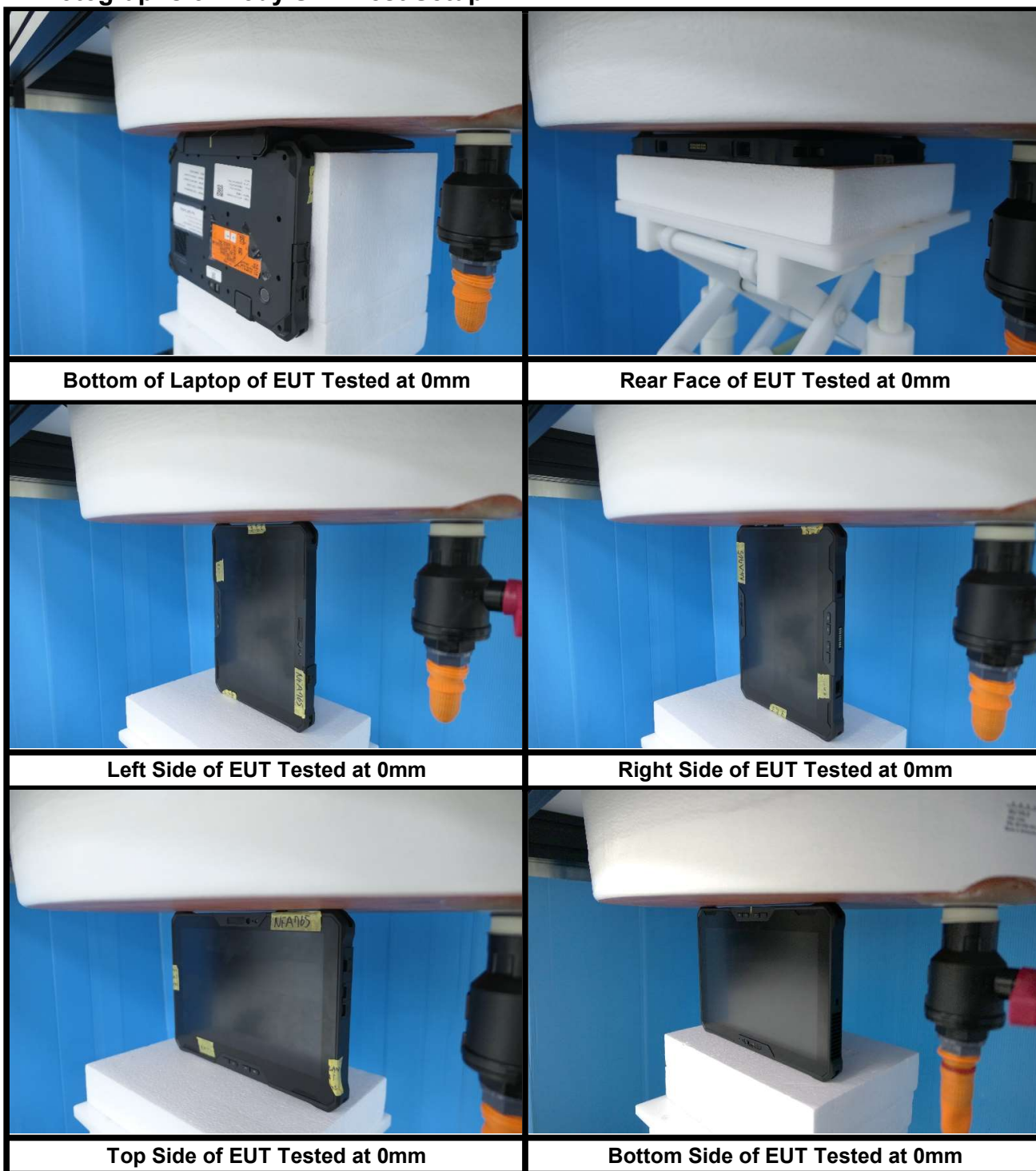

<Photographs of Body SAR Test Setup_P-Sensor>

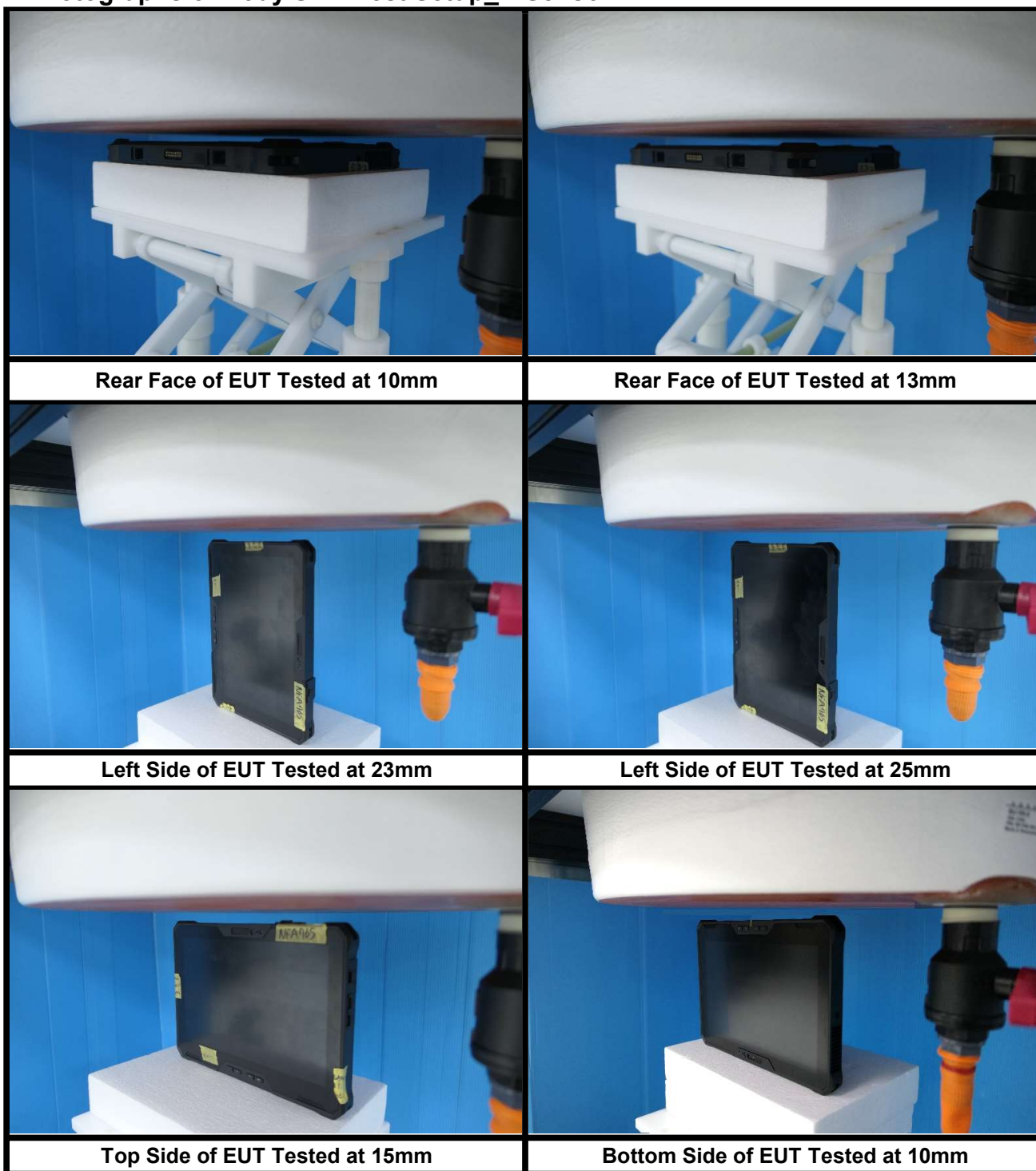

<Photographs of Power Density Test in Tablet Mode Setup>



Bottom of Laptop of EUT Tested at 0mm



Rear Face of EUT Tested at 0mm

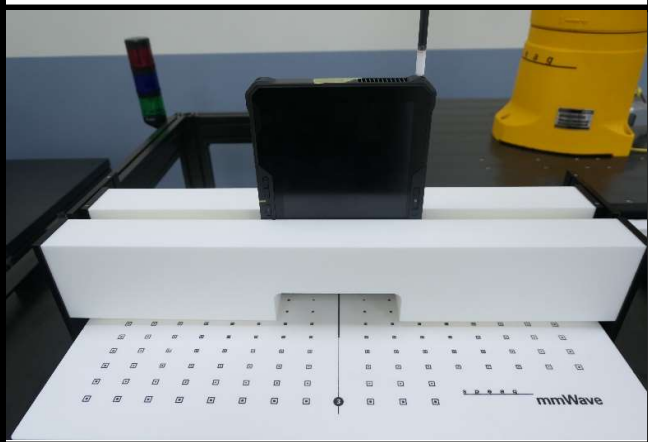

Left Side of EUT Tested at 0mm

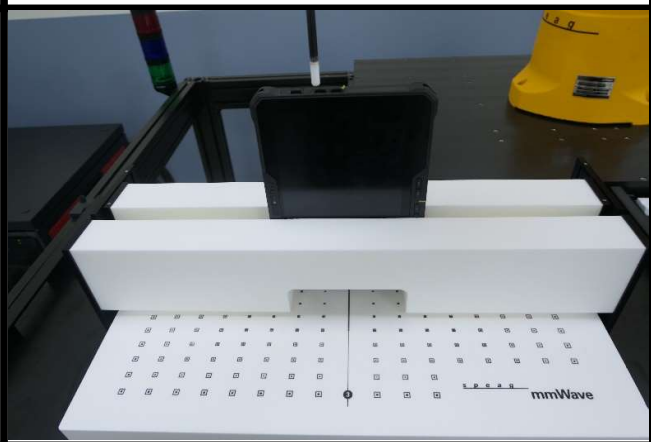

Right Side of EUT Tested at 0mm

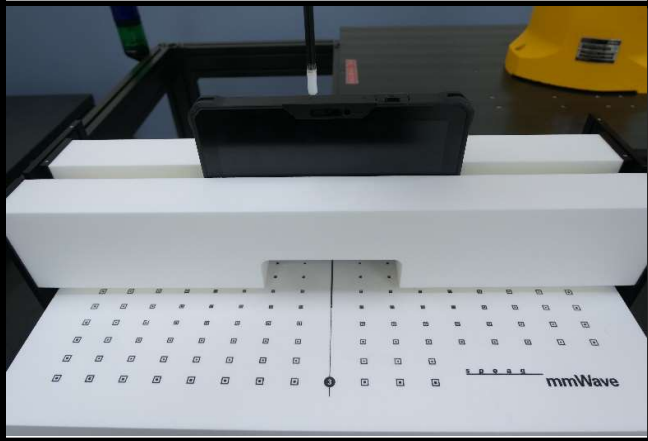

Top Side of EUT Tested at 0mm

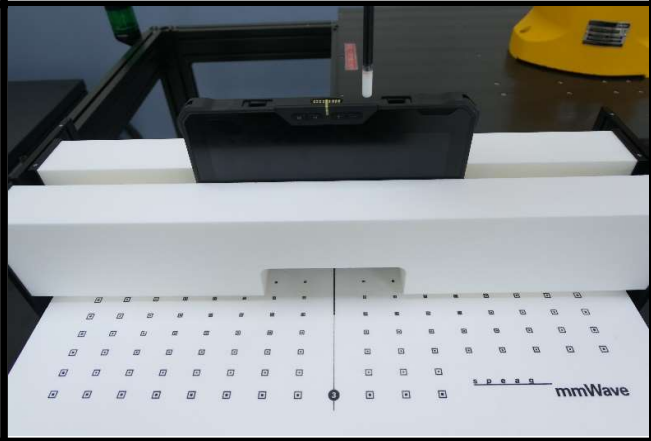

Bottom Side of EUT Tested at 0mm