

*Dell Venice Antenna
Specification for FCC
(Rev. A00)*

*Supplier Address: Hon Hai Precision Co., Ltd.
2 Tzu Yu St.
Tu-Chen Industrial Park District
Taipei Hsien, 23606
Taiwan
Tel: 886-2-2268-3466*

Antenna Specifications

Antenna Type (Material, Technology)	Phosphor Bronze, PIFA type
Antenna Model Number	WDAN-SEV01001 (Samsung p/n: BA42-00122A)
Operating Frequency Range(s)	2.4 ~ 2.5GHz, 4.9 ~ 5.9GHz
Peak Gain (802.11b/g / 2.4GHz Band) (dBi)	1.79dBi
Peak Gain (802.11a / 5GHz Band) (dBi)	2.29dBi
Radio Connector Type	IPEX 20351-111R-37, Foxconn SGX0003-2, HRS U-FL-088
Mid-Line Connector Type (If Applicable)	N/A

Note: Peak Gain should include all system losses (connector, cable, etc)

Cable Specifications

Cable Parameters	Main			Aux		
	LCD Side	Base Side	Total	LCD Side	Base Side	Total
Length (mm)	N/A	N/A	430	N/A	N/A	582
Loss (Including Connectors) (dB)			1.061dB => 2.4GHz 1.588dB => 5.15GHz 1.710dB => 5.8GHz			1.436dB => 2.4GHz 2.150dB => 5.15GHz 2.314dB => 5.8GHz
Description (Color, Diameter, Manufacturer)	Color => White, O.D. 1.37mm, Foxconn, Kurabe, Junkosha, or Nissei Coaxial cable			Color => Black, O.D. 1.37mm, Foxconn, Kurabe, Junkosha, or Nissei Coaxial cable		

Note: For single cable assembly (no mid-line connector), use the 'Total' column for each cable length and list N/A in the 'LCD' and 'Base' fields
Cable Loss should be reported for the total cable assembly (for both Main and Aux antennas)

Antenna Assembly Drawing

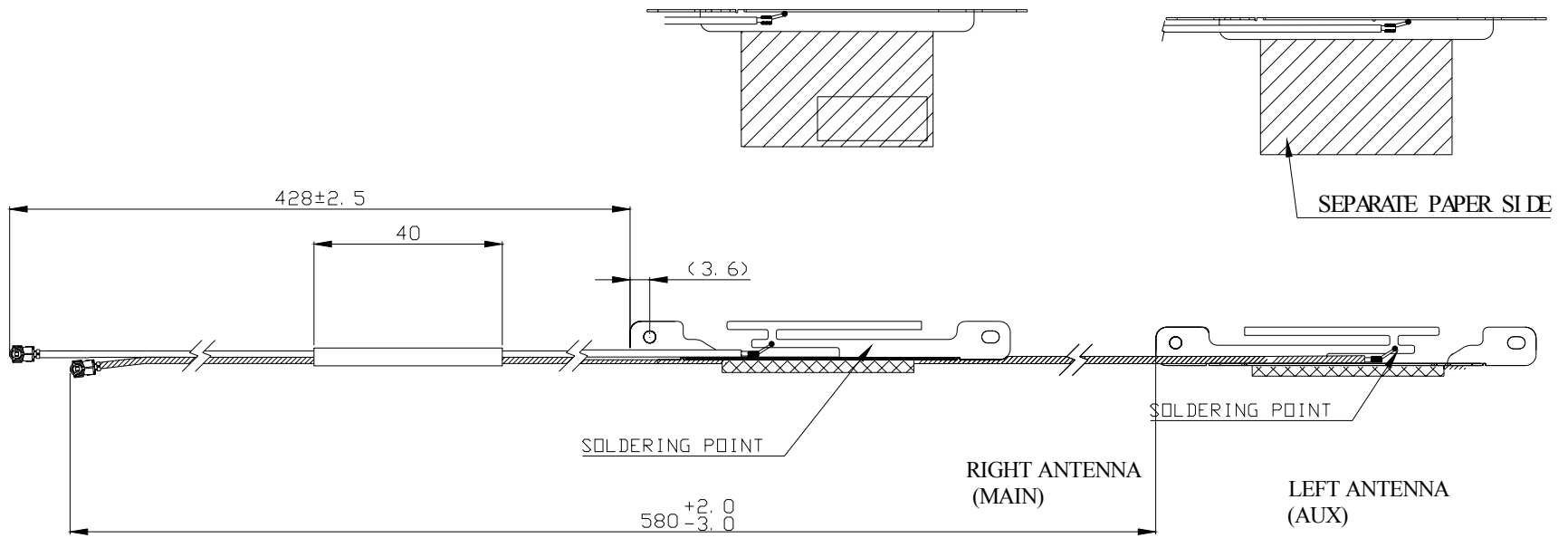

Antenna Body Drawing / Photo

(Left Antenna)

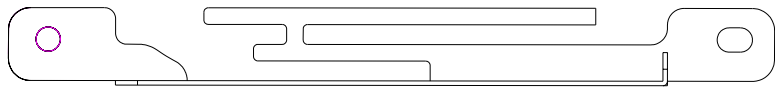

(Right Antenna)

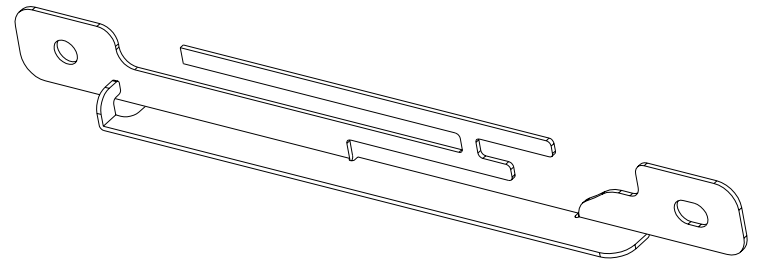
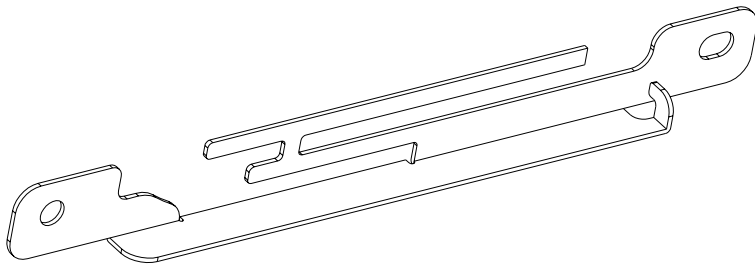
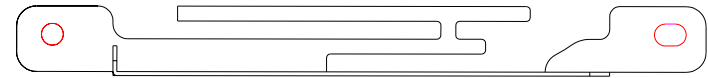

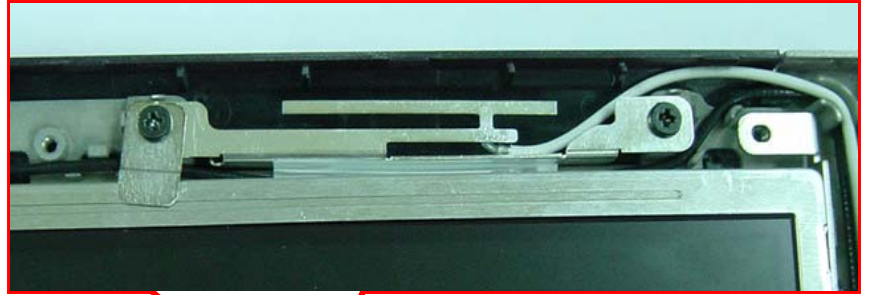
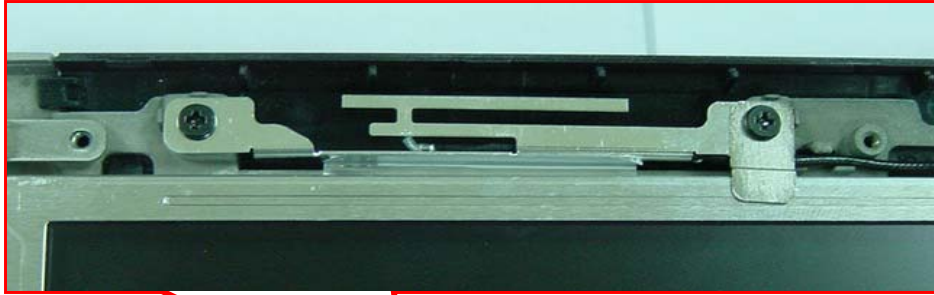

Antenna Assembly Photo



Antenna Location in NB

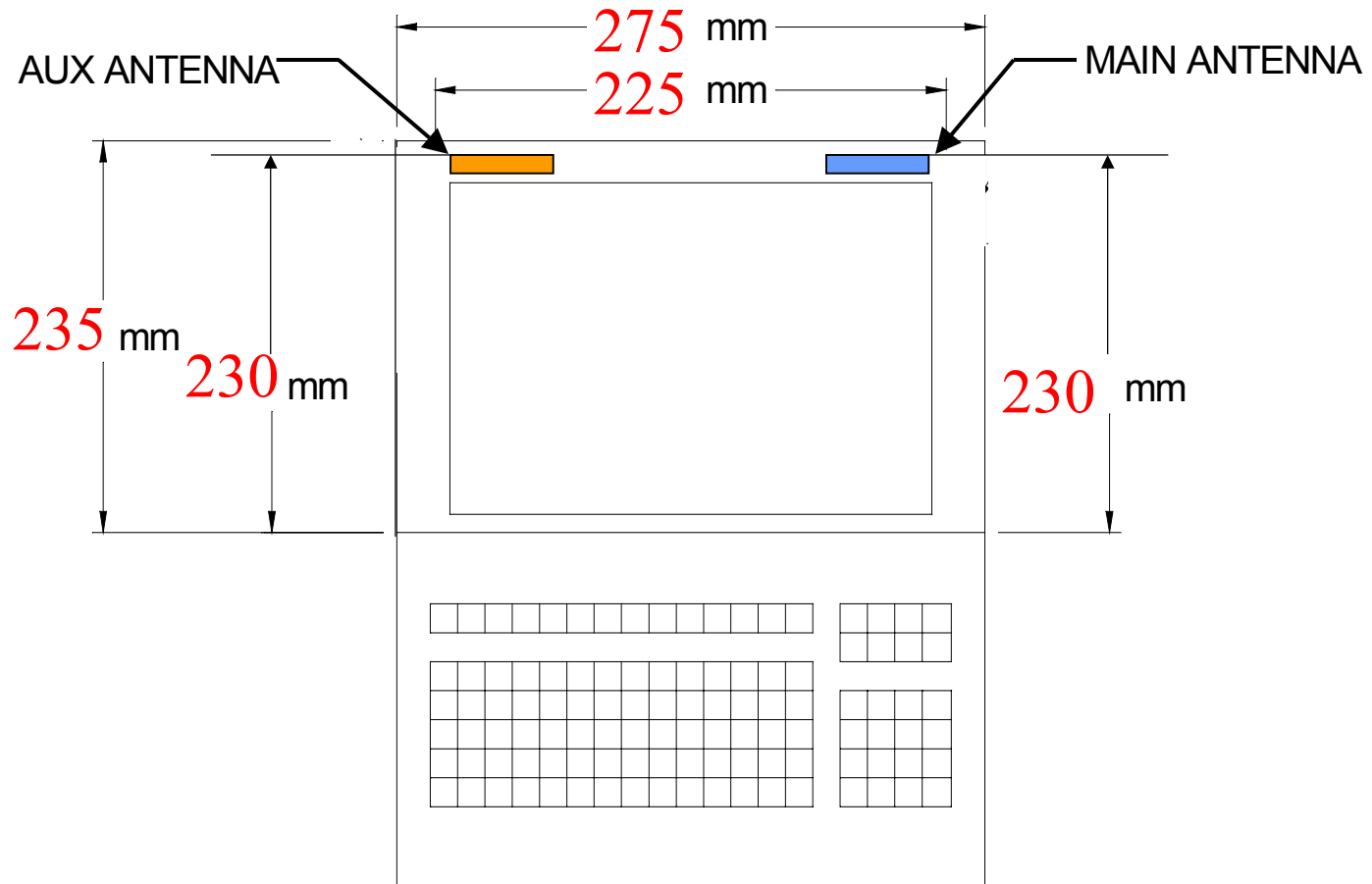

Main antenna: 2400 MHz

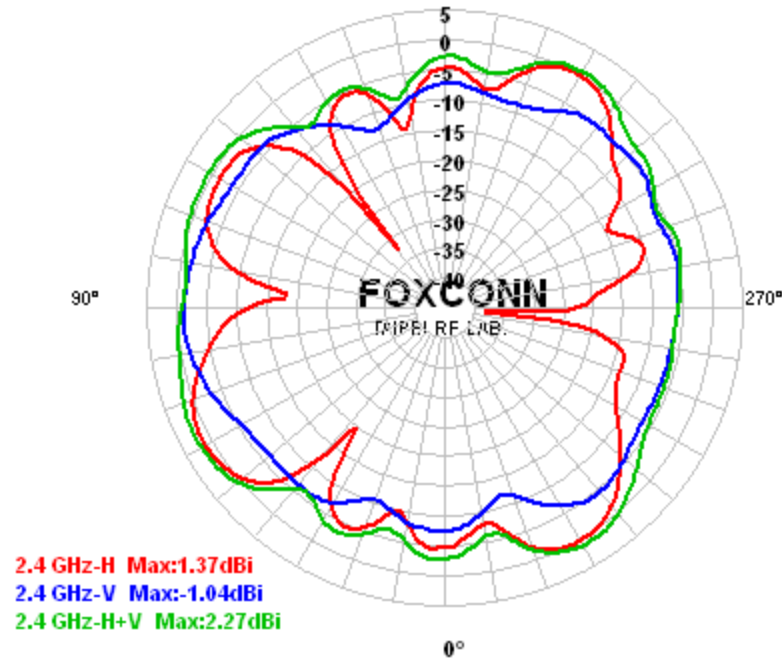

Center Frequency	2400 MHz
Horizontal peak gain (dBi)	1.37
Vertical peak gain (dBi)	-1.04
Horz +Vert peak gain(dBi)	2.27

Main antenna: 2442 MHz

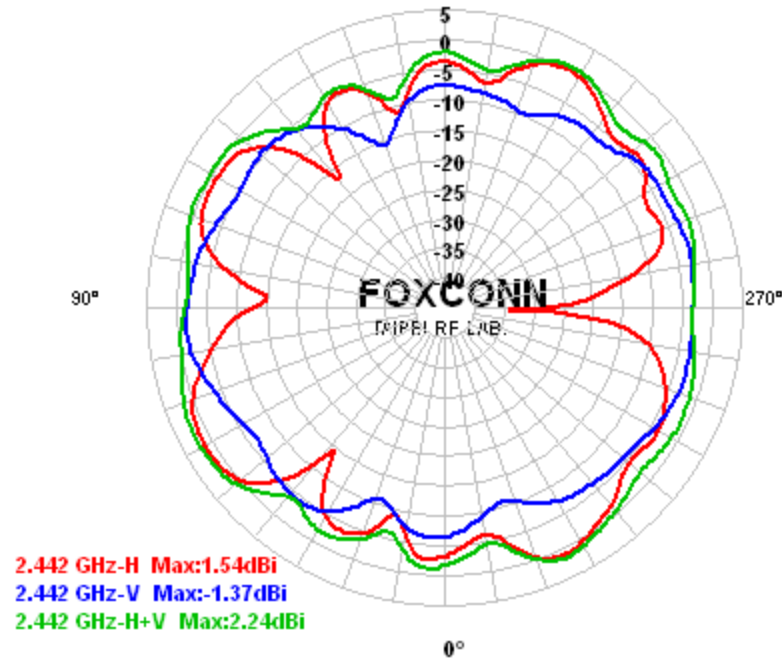

Center Frequency	2442 MHz
Horizontal peak gain (dBi)	1.54
Vertical peak gain (dBi)	-1.37
Horz +Vert peak gain(dBi)	2.24

Main antenna: 2484 MHz

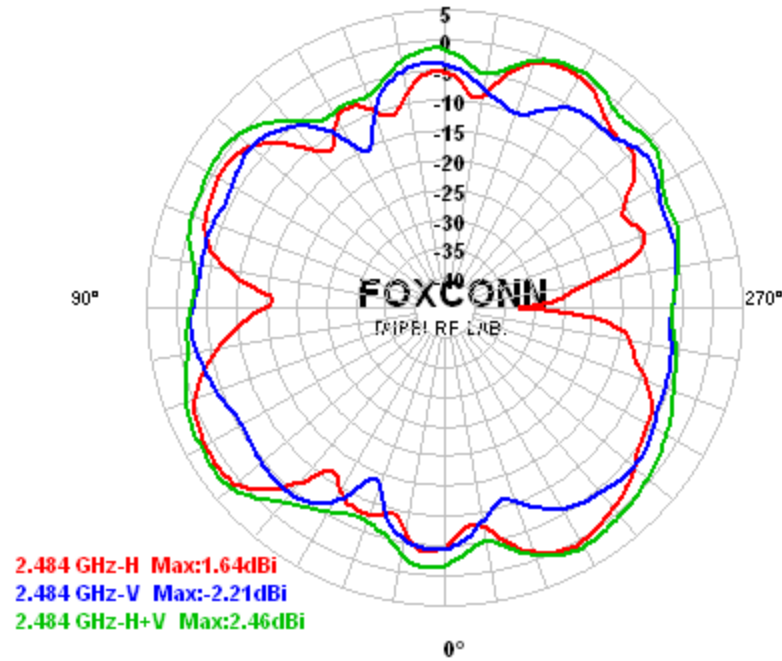

Center Frequency	2484 MHz
Horizontal peak gain (dBi)	1.64
Vertical peak gain (dBi)	-2.21
Horz +Vert peak gain(dBi)	2.46

Aux antenna: 2400 MHz

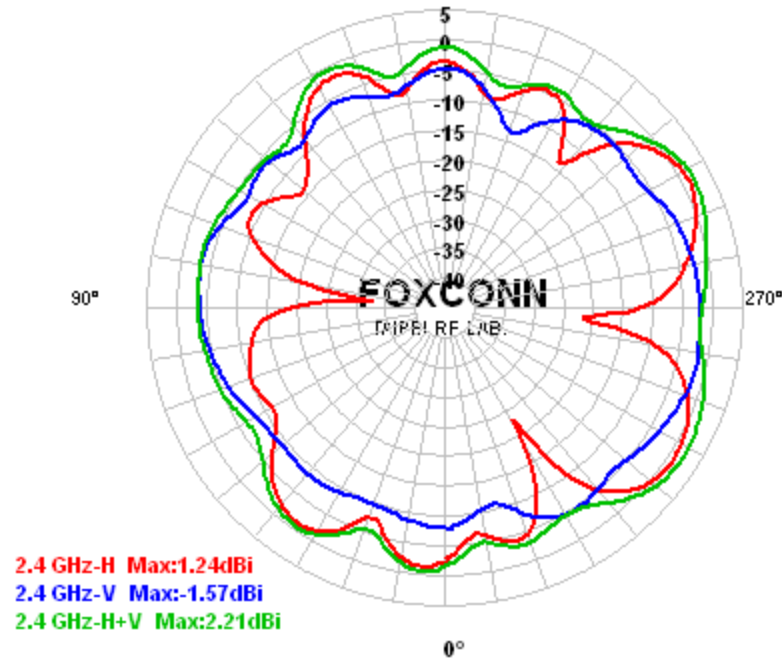

Center Frequency	2400 MHz
Horizontal peak gain (dBi)	1.24
Vertical peak gain (dBi)	-1.57
Horz +Vert peak gain(dBi)	2.21

Aux antenna: 2442 MHz

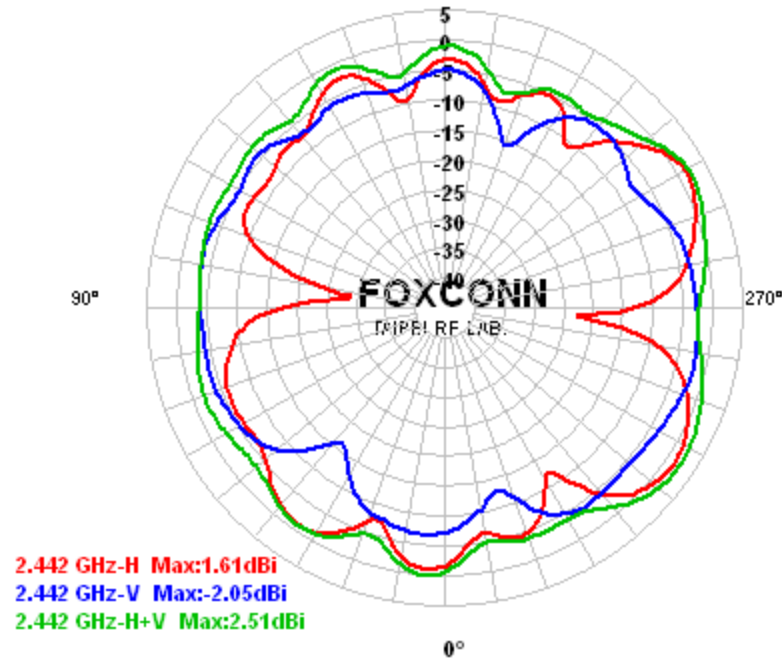

Center Frequency	2442 MHz
Horizontal peak gain (dBi)	1.61
Vertical peak gain (dBi)	-2.05
Horz +Vert peak gain(dBi)	2.51

Aux antenna: 2484 MHz

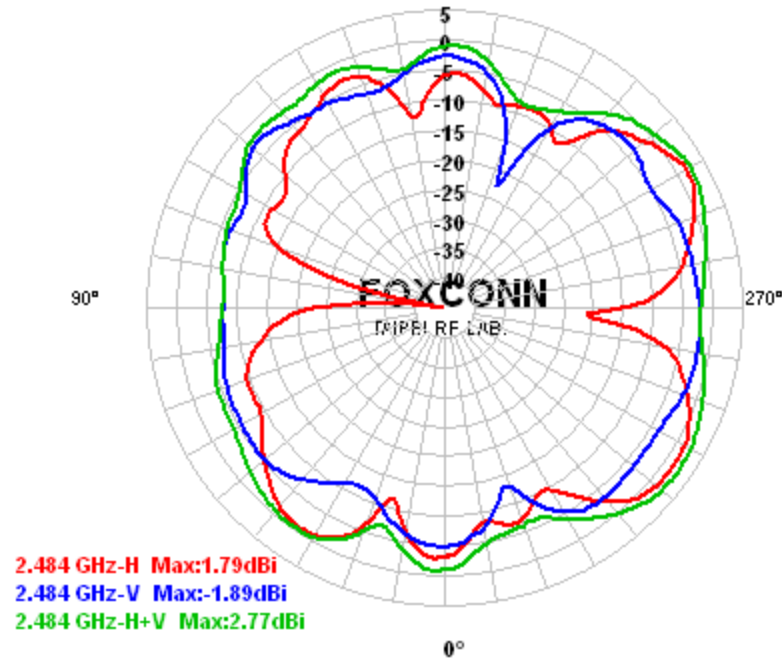

Center Frequency	2484 MHz
Horizontal peak gain (dBi)	1.79
Vertical peak gain (dBi)	-1.89
Horz +Vert peak gain(dBi)	2.77

Main antenna: 4900 MHz

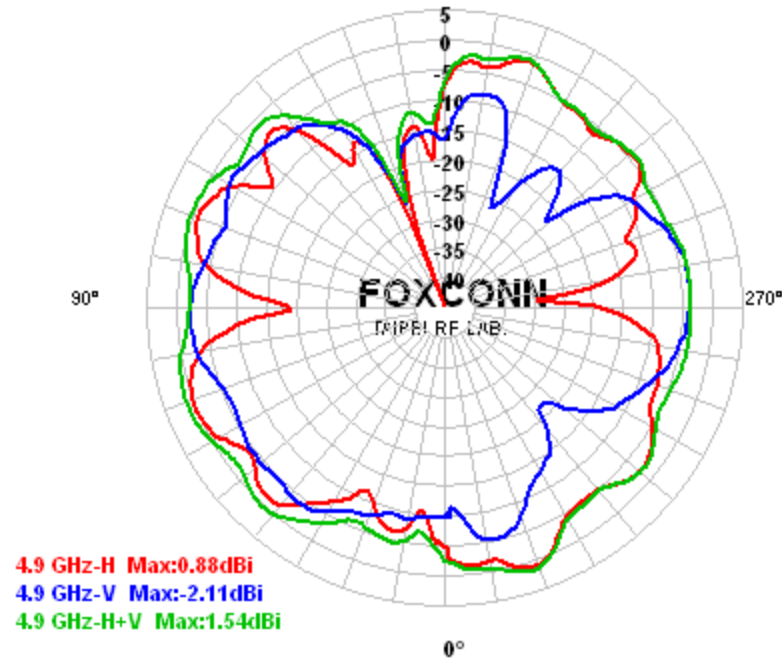

Center Frequency	4900 MHz
Horizontal peak gain (dBi)	0.88
Vertical peak gain (dBi)	-2.11
Horz +Vert peak gain(dBi)	1.54

Main antenna: 5150 MHz

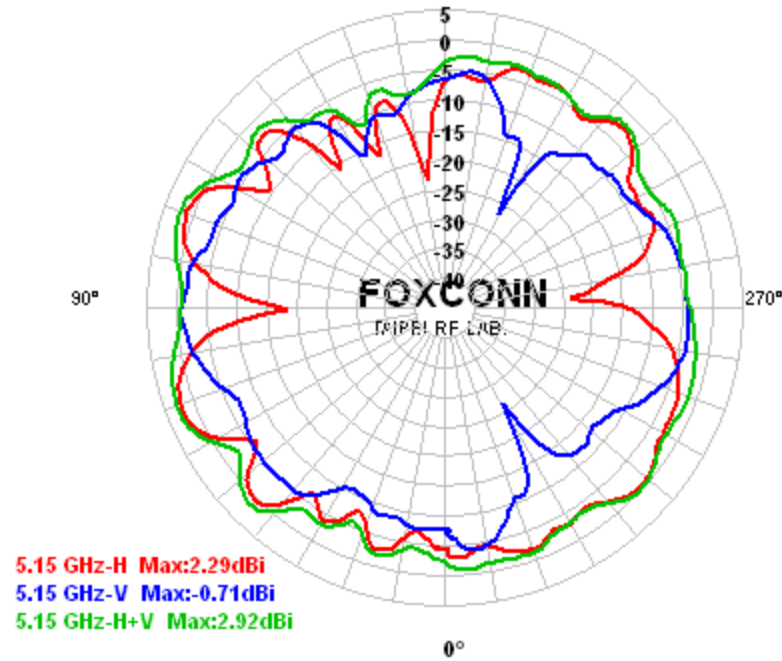

Center Frequency	5150 MHz
Horizontal peak gain (dBi)	2.29
Vertical peak gain (dBi)	-0.71
Horz +Vert peak gain(dBi)	2.92

Main antenna: 5350 MHz

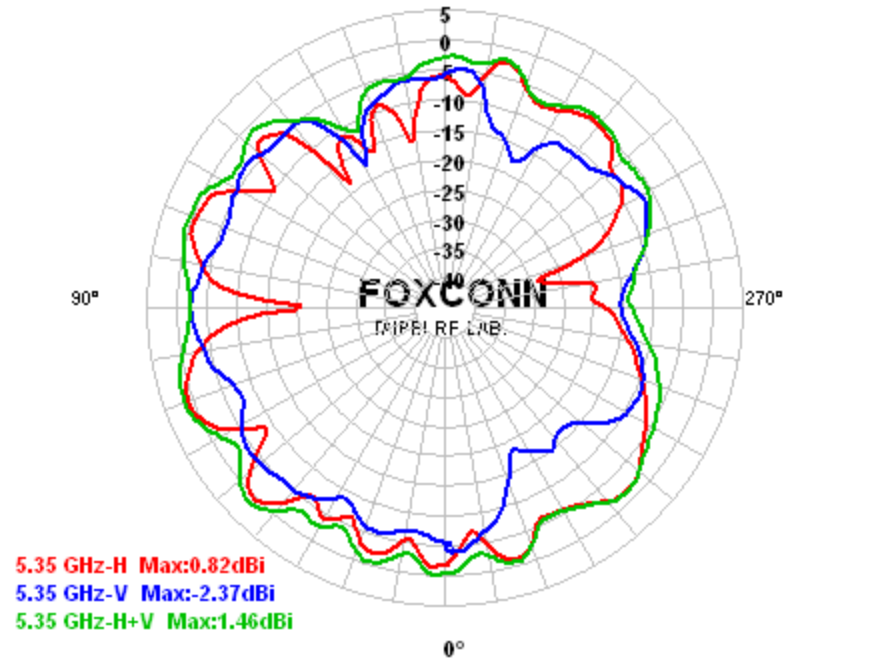

Center Frequency	5350 MHz
Horizontal peak gain (dBi)	0.82
Vertical peak gain (dBi)	-2.37
Horz +Vert peak gain(dBi)	1.46

Aux antenna: 4900 MHz

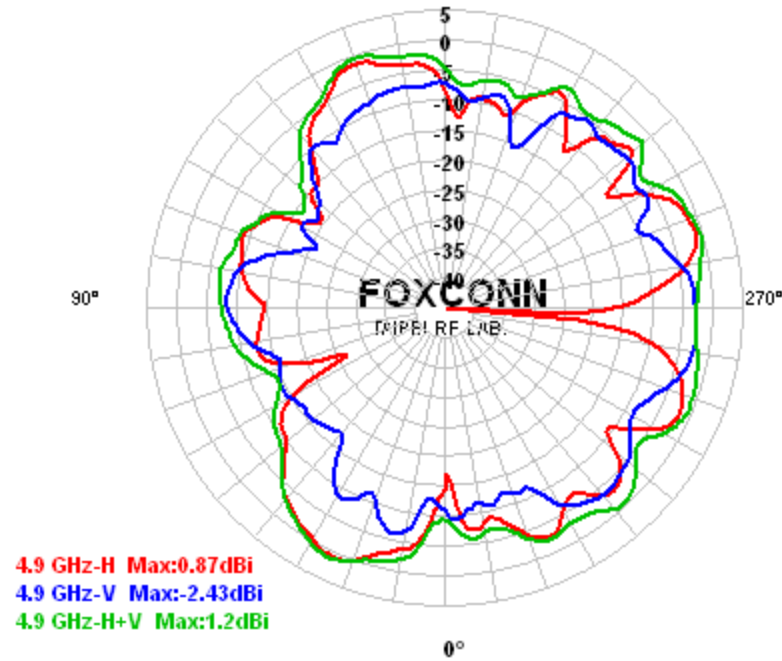

Center Frequency	4900 MHz
Horizontal peak gain (dBi)	0.87
Vertical peak gain (dBi)	-2.43
Horz +Vert peak gain(dBi)	1.20

Aux antenna: 5150 MHz

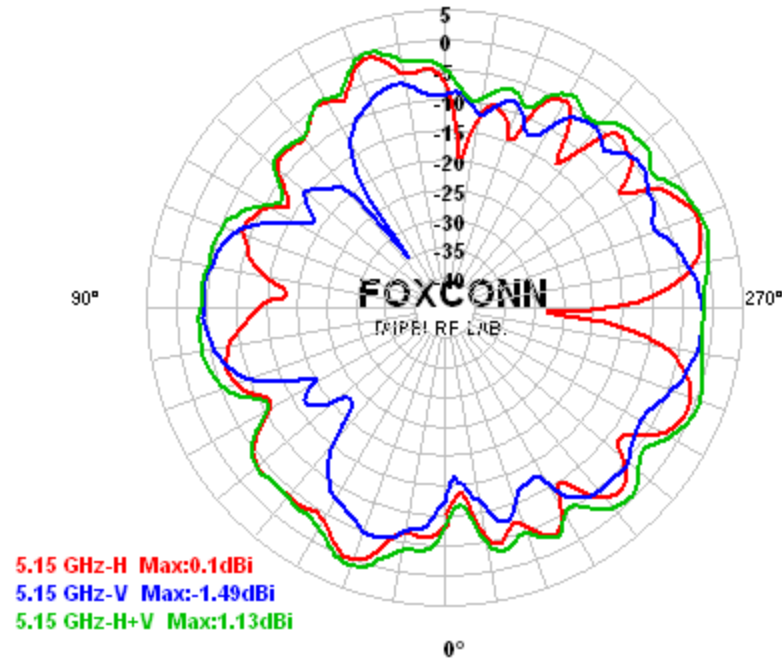

Center Frequency	5125 MHz
Horizontal peak gain (dBi)	0.10
Vertical peak gain (dBi)	-1.49
Horz +Vert peak gain(dBi)	1.13

Aux antenna: 5350 MHz

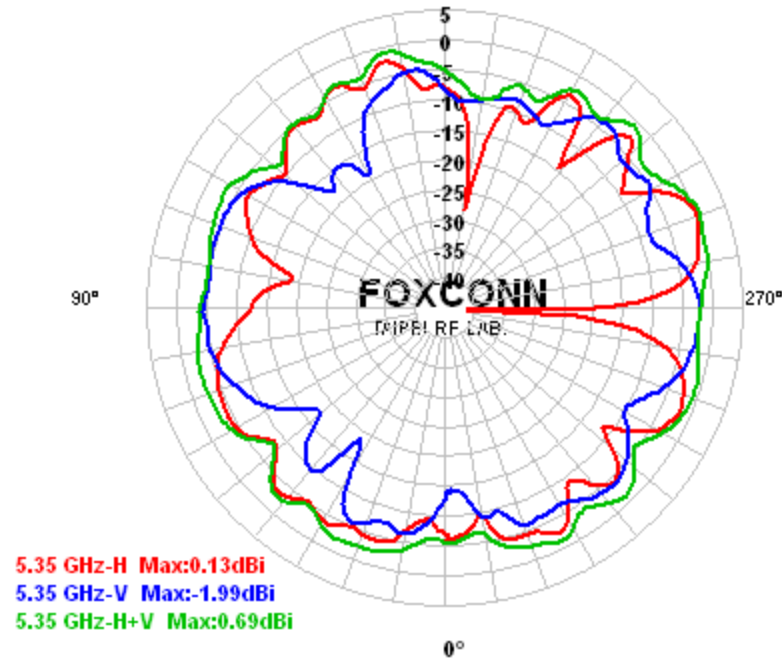

Center Frequency	5350 MHz
Horizontal peak gain (dBi)	0.13
Vertical peak gain (dBi)	-1.99
Horz +Vert peak gain(dBi)	0.69

Main antenna: 5470 MHz

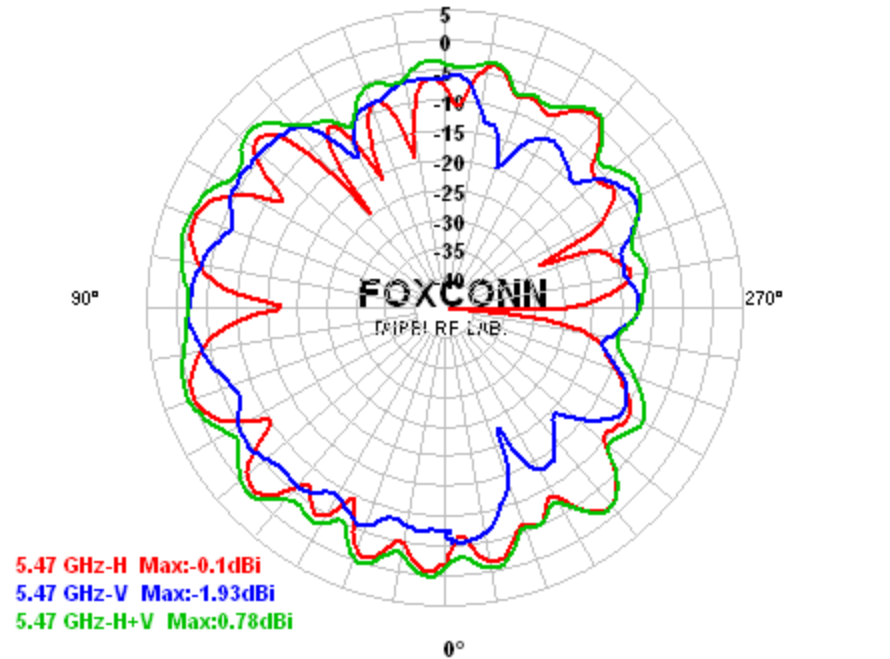

Center Frequency	5470 MHz
Horizontal peak gain (dBi)	-0.10
Vertical peak gain (dBi)	-1.93
Horz +Vert peak gain(dBi)	0.78

Main antenna: 5725 MHz

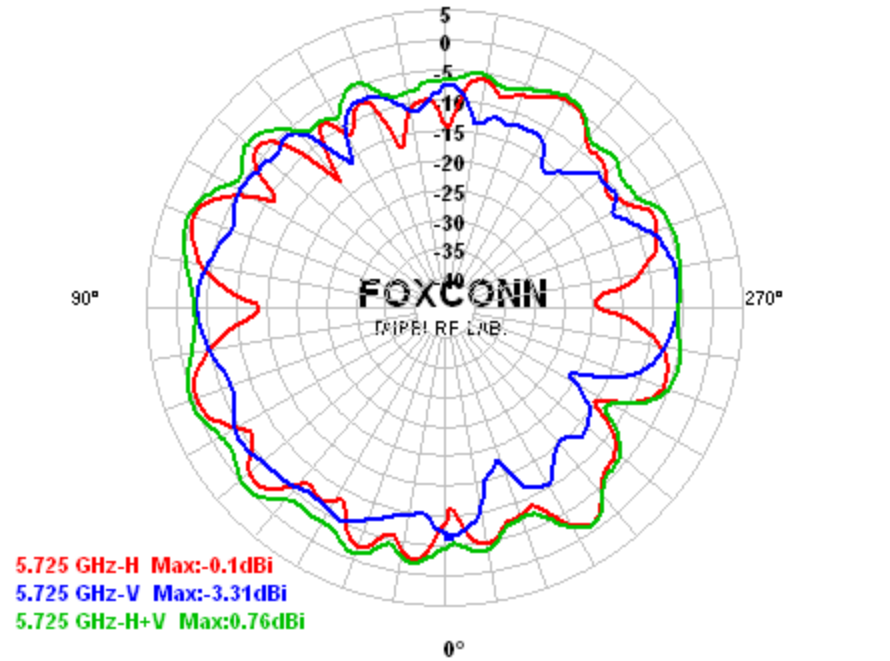

Center Frequency	5725 MHz
Horizontal peak gain (dBi)	-0.10
Vertical peak gain (dBi)	-3.31
Horz +Vert peak gain(dBi)	0.76

Main antenna: 5900 MHz

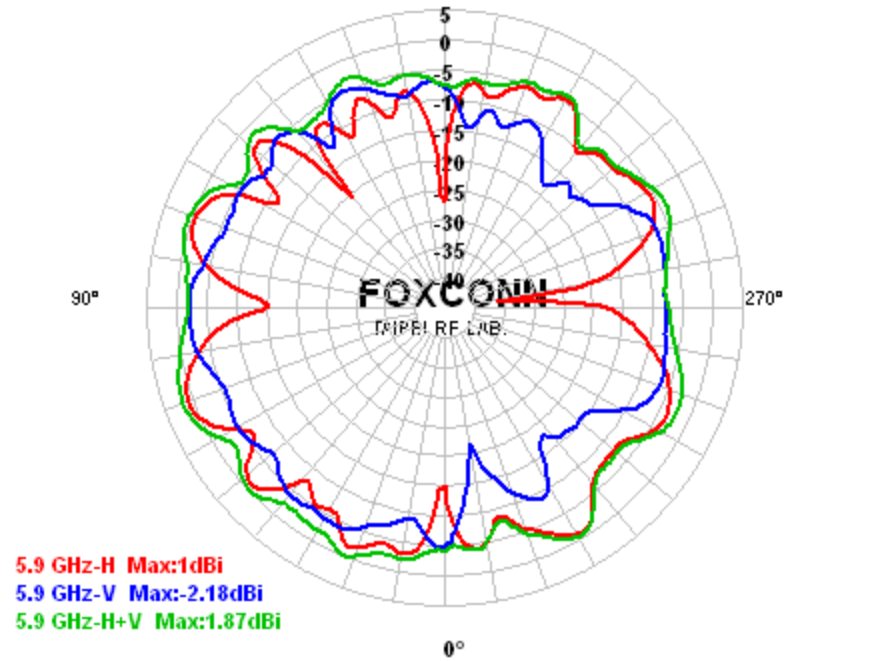

Center Frequency	5900 MHz
Horizontal peak gain (dBi)	1.00
Vertical peak gain (dBi)	-2.18
Horz +Vert peak gain(dBi)	1.87

Aux antenna: 5470 MHz

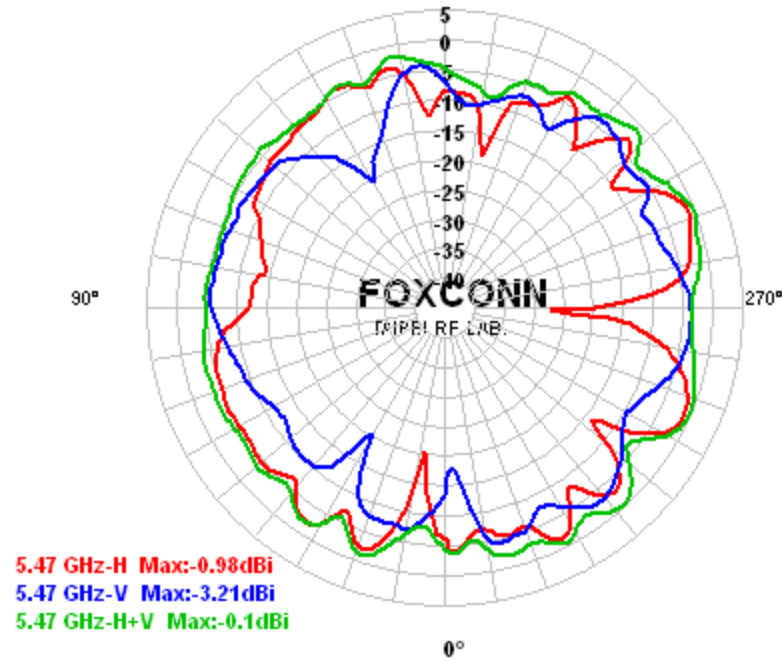

Center Frequency	5470 MHz
Horizontal peak gain (dBi)	-0.98
Vertical peak gain (dBi)	-3.21
Horz +Vert peak gain(dBi)	-0.10

Aux antenna: 5725 MHz

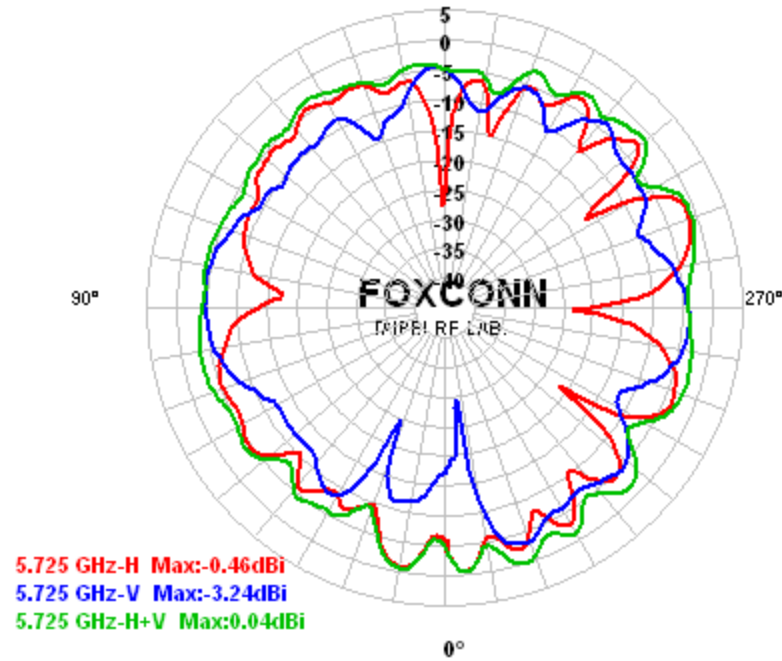

Center Frequency	5673 MHz
Horizontal peak gain (dBi)	-0.46
Vertical peak gain (dBi)	-3.24
Horz +Vert peak gain(dBi)	0.04

Aux antenna: 5900 MHz

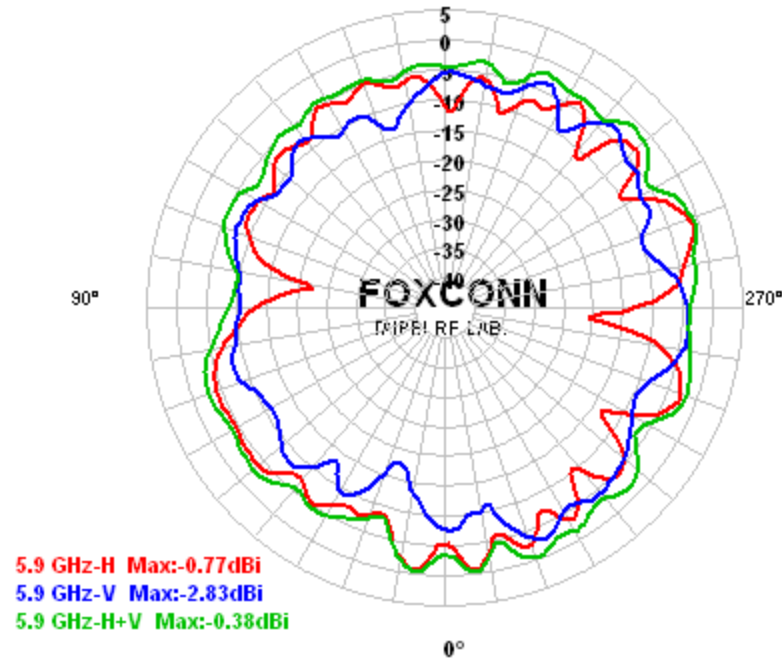

Center Frequency	5900 MHz
Horizontal peak gain (dBi)	-0.77
Vertical peak gain (dBi)	-2.83
Horz +Vert peak gain(dBi)	-0.38