

Dieline – do not print



FCC ID: DZLF0179A
IC: 1807D - F0179A
Model #: F-0179A
Input DC Rating: 6.5V $\overline{\text{---}}$ 200mA
P/N: 12-00261

The FCC ID is located on the charging station because the headset is only able to be paired with the charging station. Without it, no charging (thus operation) is possible.

NOTICE: LOGITECH CONFIDENTIAL INFORMATION
THIS DOCUMENT IS THE PROPERTY OF LOGITECH
AND MUST NOT BE COPIED, REPRODUCED OR USED
AS THE BASIS FOR SALE OR MANUFACTURE OF
APPARATUS OR DEVICES WITHOUT WRITTEN
PERMISSION FROM LOGITECH.

SEE DETAIL A

NOTE: NO TEXTURED REQUIRED
ON LABEL RECESS AREA

REV02: REDUCED SIZE OF RIB

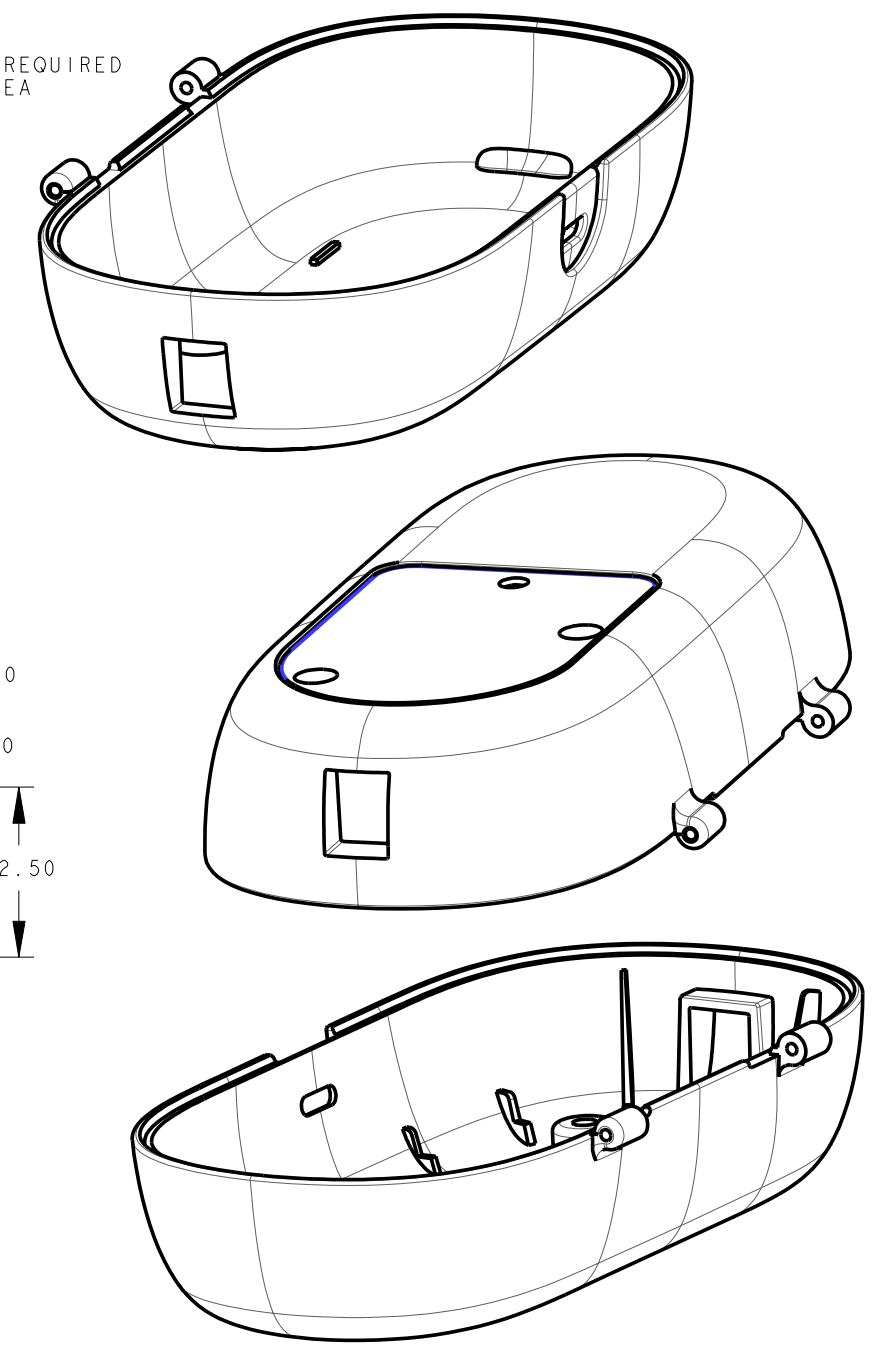
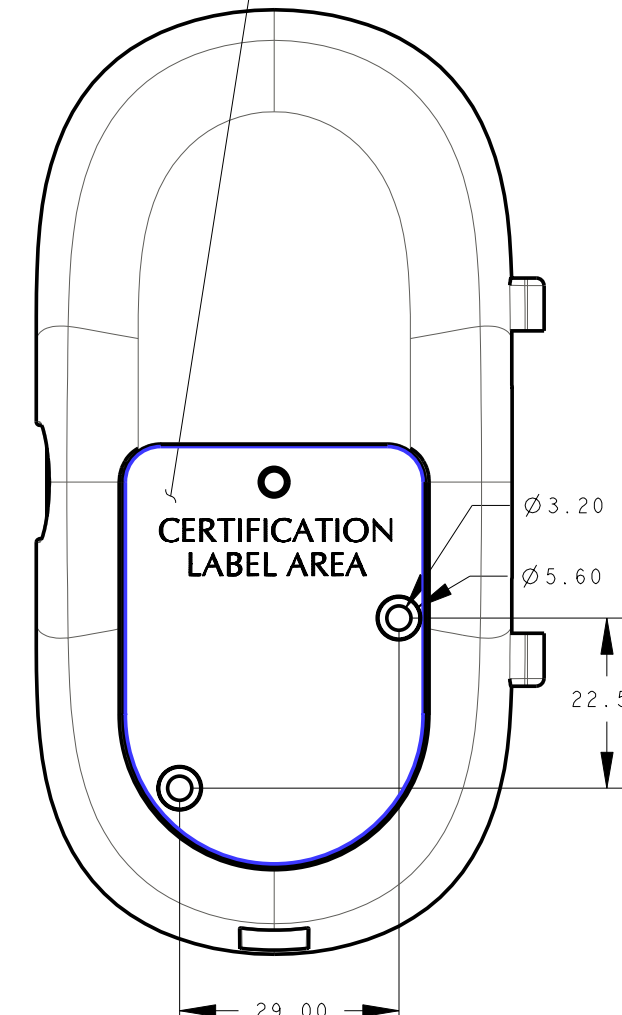
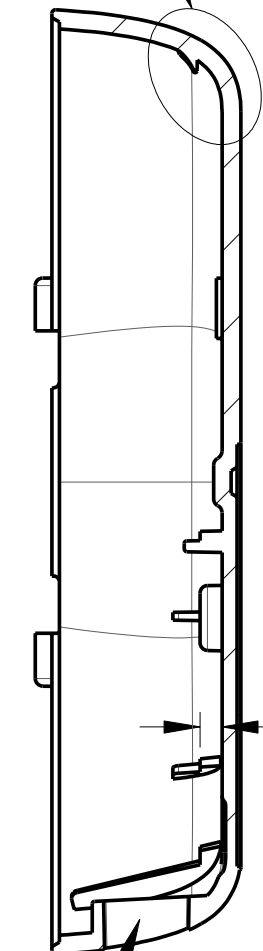
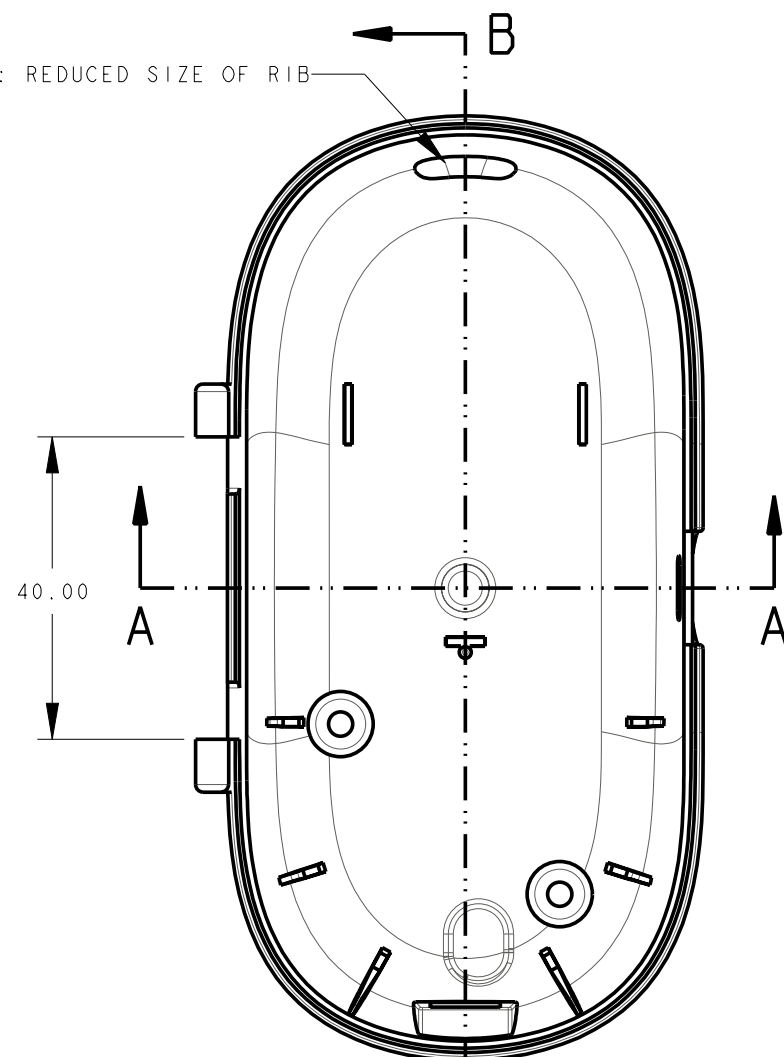
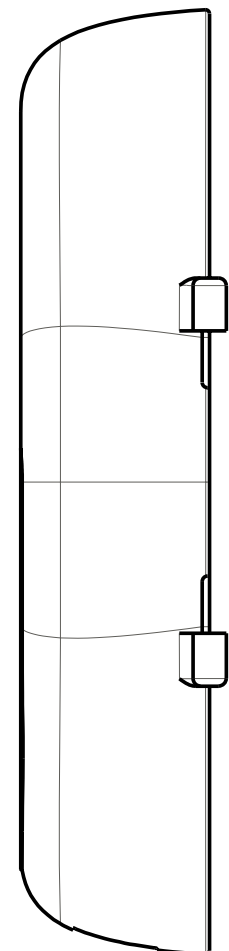

REV02: DRAFT DIRECTION
PULLS TO OUTSIDE

SECTION B - B

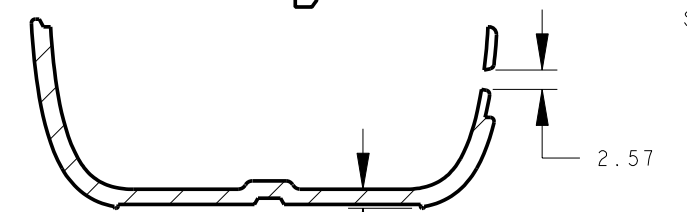

SECTION A - A

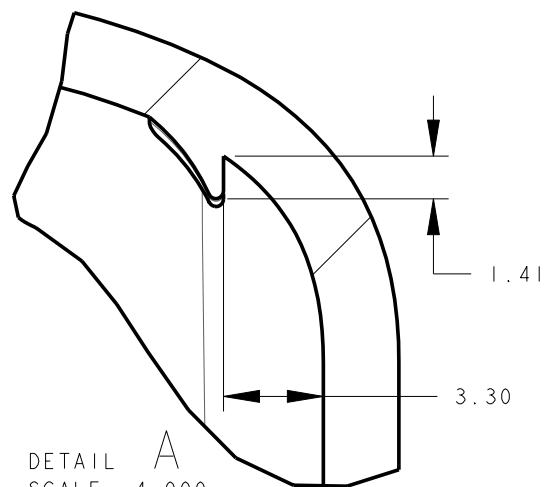
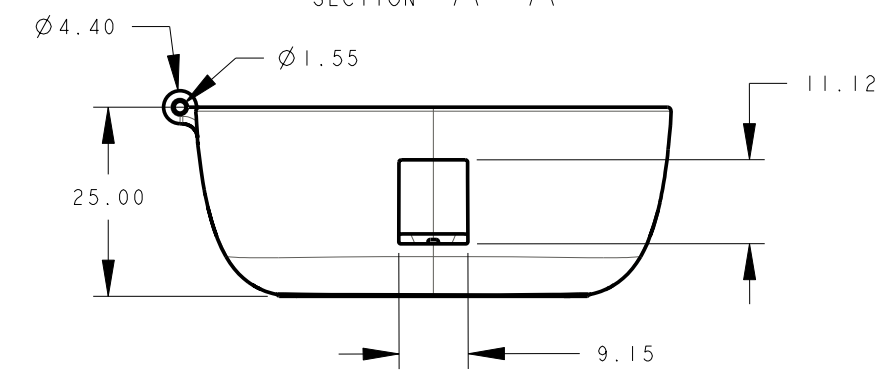

DETAIL A
SCALE 4.000

NOTES

1. PART IS ORIENTED IN THIS DRAWING TO SHOW PULL DIRECTION.
2. PART SHALL BE FREE OF ALL FOREIGN MATTER (OIL, DIRT, MOLD RELEASE, ETC.)
3. PART TO BE FREE OF NICKS, BURRS, AND SCRATCHES.
4. GATE VESTIGE TO BE +0.1/-0.2
5. ALL SHARPS TO BE R0.1 MIN.
6. APPROXIMATE PART VOLUME = 30519 mm³
7. ESTIMATED MATERIAL DENSITY = 0.00105g/mm³
8. ESTIMATED MASS: 32.05g

ALL UNDIMENSIONED SURFACES SHOULD BE TAKEN DIRECTLY FROM THE PRO/E MODEL.

DRW: ASD	DATE: 11-Jul-02		TITLE BASE																							
<table border="1" style="width: 100%; border-collapse: collapse;"> <thead> <tr> <th style="width: 10%;">REV</th> <th style="width: 40%;">DESCRIPTION</th> <th style="width: 10%;">ECO</th> <th style="width: 10%;">BY</th> <th style="width: 10%;">DATE</th> </tr> </thead> <tbody> <tr> <td>02</td> <td>REDUCED UNDERCUT RIB</td> <td>1344</td> <td>KJH</td> <td>29-OCT-02</td> </tr> <tr> <td>01a</td> <td>Revised Tooling Release</td> <td>1344</td> <td>KJH</td> <td>25-OCT-02</td> </tr> <tr> <td>00</td> <td>Tool Release</td> <td>1172</td> <td>ASD</td> <td>11-JUL-02</td> </tr> </tbody> </table>			REV	DESCRIPTION	ECO	BY	DATE	02	REDUCED UNDERCUT RIB	1344	KJH	29-OCT-02	01a	Revised Tooling Release	1344	KJH	25-OCT-02	00	Tool Release	1172	ASD	11-JUL-02	TOLERANCES: .X ± 0.5 .XX ± 0.2 .XXX ± 0.1	B	DWG SZ B	SCALE: 1.000:1
REV	DESCRIPTION	ECO	BY	DATE																						
02	REDUCED UNDERCUT RIB	1344	KJH	29-OCT-02																						
01a	Revised Tooling Release	1344	KJH	25-OCT-02																						
00	Tool Release	1172	ASD	11-JUL-02																						
REVISION		1499 SE Tech Center Pl., Suite 350 Vancouver, WA. 98683 PH: (360) 896-2000 Fax: (360) 896-2020 DO NOT SCALE DRAWING		PART NO 04-00394	REV 02																					