

LOGITECH TYPE OF DOCUMENT NO.	TYPE	REV.
644717-0000	DWS	A0

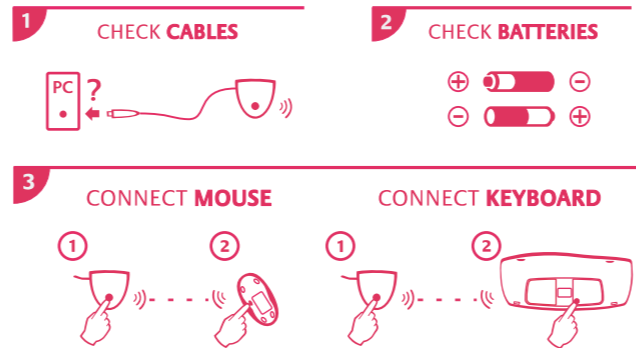

CMI ID: XXXXXXXXXX
 This device complies with part 15 of the FCC rules. Operation is subject to the following conditions:
 (1) This device may not cause harmful interference, and
 (2) this device must accept interference received, including interference that may cause undesired operation.

Logitech Cordless Keyboard
Connection Assistance



CONNECT

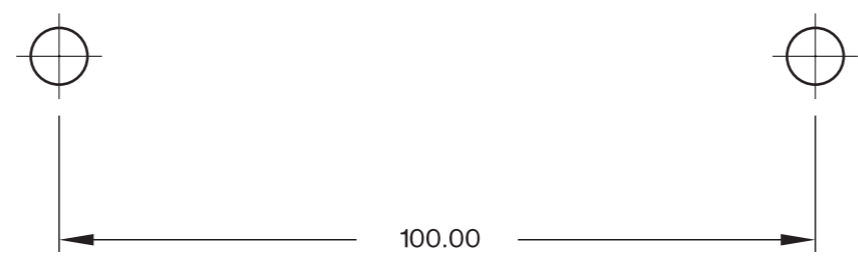

*COLOR IS USED FOR IDENTIFICATION ONLY.

						ミネベア株式会社 MINEBEA CO.,LTD. MECHATRONICS DIV.			作成日 DATE MAY/25/04 品名 DESCRIPTION A/W ,LABEL,KB ID LTTL	
04	JUN/02/04	CHANGE / KE-XXXX	Y.NSOK	N.UENO		APPROVED	CHECKED	DRAWN	品番 PART NO.(MODEL NO.)	葉番 SHEET
03	MAY/31/04	CHANGE / KE-XXXX	Y.NSOK	N.UENO						1/1
02	MAY/27/04	CHANGE / KE-XXXX	Y.NSOK	N.UENO						
01	MAY/25/04	NEW ISSUE / KE-XXXX	Y.NSOK	N.UENO						
符号 MARK	日付 DATE	変更事由 REASON	ECN.NO.	担当 ENGINEER	承認 APPROVED	N.UENO	T.NKNS	Y.NSOK	図番 DRAWING NO. 132255	改訂 REV. 04