

Basics

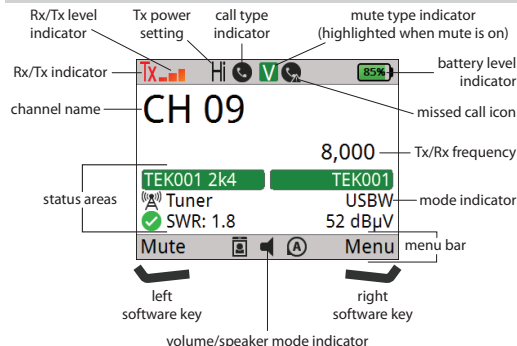

Fixed channel operation

To operate on a fixed channel:

- Go to the channel screen, stop scanning, then select a channel.
- Press **PTT** to tune the antenna, if required.

Discreet mode switch

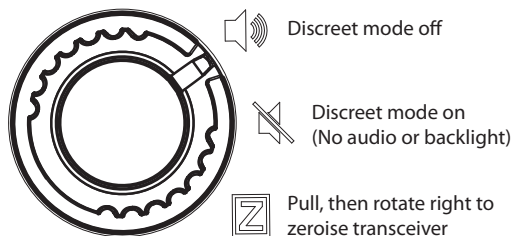

Keys

	Volume down/up (when is present)
	Select channel
	Scroll left/up/down/right
	Menu/action
	Selection
Press	Start call
Hold (for 2 sec)	Go to Stations list
	End call, start/stop scan
	Mute on/off
	Manual tune screen
	Next speaker mode
	Next Digital Voice Rate
	Free tune receive
	Set transmit power level
	Select mute type
	Toggle between Analogue and Secure/DV
	Go to GPS screen
	Toggle Channel/Station screens
	Go to Adjust Display Brightness screen
	Function Select: Self Tests Screen/Macros Screen

Calling

Call Types

- Selective
- Get Status
- Message
- Channel Test
- Send Position
- Phone
- Get Position
- Alert
- ALE Sounding
- SMS
- Voice Message
- TOD Request
- TOD Broadcast

Making a Station Call

To make a call using one of your pre-defined stations:

- Go to the channel screen, then **hold CALL** or press Key **0**.

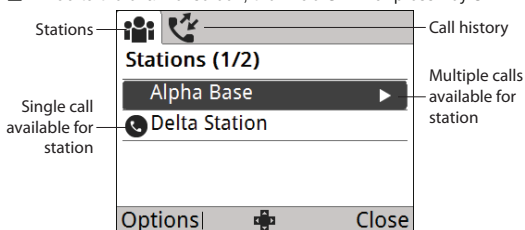

- Scroll to the station that you want to call.
- If there are multiple calls available for the station, press or **CALL**, then scroll to the desired call type.
- Press **CALL**.
- Respond to any prompts, then press **CALL**.

Making a call from the Channel screen

To make a call:

- Go to the channel screen, then press **CALL**.

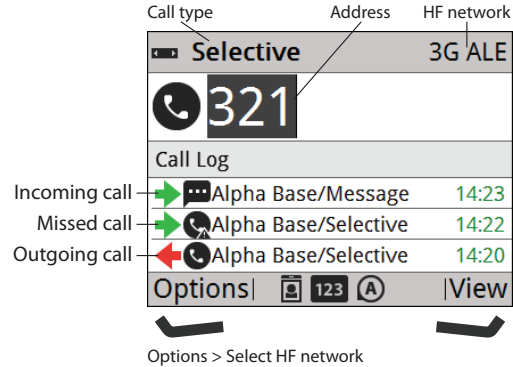

- Press **◀** or **▶** to scroll to the call type that you want to use.
- Enter a Station ID to call.
- If you want to return or repeat a call from the Call Log, press **▼** to scroll to the entry.
- Press **CALL**.

Making a call from the Call History

To make a call from the call History:

- Go to the channel screen, *hold* **CALL** or press key **0**.
- Ensure that the top tab is selected, then press **▶** to see the Call History.
- Scroll to the call that you want to return or repeat, then press **CALL**.

Making an alert call

CAUTION: Ensure that all information required is set up for the alert station.

To make an alert call:

- Hold* **▲** for 2 sec, then follow any prompts.

Viewing missed calls

To view a missed call:

- Go to the channel screen, *hold* **CALL**, or press key **0**, then press **▶** to see the Call History.
- Scroll to the missed call that you want to view, then press **OK**.

Navigating

Navigating the menu structure

To navigate the menu structure:

- To move through the menu structure, press **▲**, **▼**, **◀** or **▶** to highlight the icon that you want to select, then press **OK**.
- To move through a list of entries at the lowest level of the menu structure, press **▲** or **▼**.
- To go to the top level in the menu structure, do one of the following:
 - Press **◀** (**Close**) to return to the top level of the menu structure, one level at a time.
 - Press PTT to exit to the channel screen, then press **☰** (**Menu**) to enter the top level of the menu structure.

Finding a word or value

NOTE: Find is available for selected icons.

To find a word or value:

- Highlight the icon in which you want to search, then press **☰** (**Find**).
- Start entering the letter and/or number on which you want to search.
- Enter more characters to refine your search.

- Scroll to the entry or value that you want, then press **OK**. You are taken to the entry or name level of the user data containing the character.

Text editing functions

- SCAN** Press to delete a single character of *hold* to clear all the text in the field
- # FUNC 2** Change character-entry mode
- * LIGHT** Select special character (*press/hold*)
- 0 VIEW** Enter a space
- PTT** Abort editing/exit

Shortcuts

- ⏻** + 0 Adjust Display Brightness
- ⏻** + 1 Toggle next available theme
- ⏻** + 2 Toggle advanced view
- ⏻** + 3 Select language
- ⏻** + **▲** Abandon mode

References

Sentry®-H 6110-MP Transceiver Operator Guide (Codan part number 15-04200-EN)