

TELIS SOLIRIS TRANSMITTER

DESCRIPTION

The Telis Soliris Transmitter is a single channel hand-held transmitter compatible with the Universal Receiver, Altus motor and Soliris RTS Sensor. It will operate window coverings at a distance as well as switch between Wind-Only or Sun & Wind Modes.



MECHANICAL SPECIFICATIONS

Overall Dimensions: L: 4 ³/₄ in. W: 1 ³/₄ in. D: ³/₄ in.

Operating Temperature: 41°F to 104°F

Frequency Range (optimal conditions): 65 ft.

ELECTRICAL SPECIFICATIONS

Power: 3V Lithium batter, Cr2430

Frequency: 433.42 Mhz

GENERAL OPERATING INSTRUCTIONS

NOTE: Please Consult Altus Motor, Soliris Sensor RTS or Universal Receiver Instructions for Specific Product Details.

1. Place the Altus Motor or Universal Receiver in Programming Mode as described in the Operating Instructions.
2. Press the programming button on the back of the Telis Soliris to program it into the memory of the Altus Motor or Universal Receiver.
3. Pressing the UP button will raise the window covering, while pressing the DOWN button will lower it. To stop the window covering, simply press the STOP button.
4. Pressing the Mode Selector button will switch between Wind-Only and Sun & Wind Modes. The corresponding LED will light to indicate the mode selected.

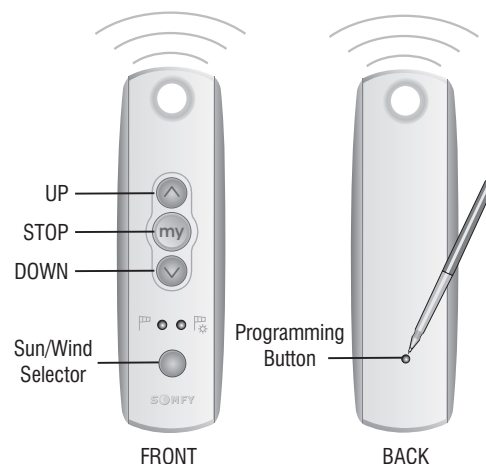

ORDERING INFORMATION

Description	Part Number
Telis Soliris Pure	1810635
Telis Soliris Patio	1810647

FCC INFORMATION

This device complies with Part 15 of the FCC rules. Operation is subject to the following two conditions:

1. This device may not cause harmful interference, and
2. This device must accept any interference received, including interference that may cause undesired operation.

NOTE: This equipment has been tested and found to comply with the limits for a CLASS B digital device, pursuant to Part 15 of the FCC rules. These limits are designed to provide reasonable protection against harmful interference when the equipment is operated in a commercial environment. This equipment generates uses and can radiate radio frequency energy and, if not installed and used in accordance with the instructions, may cause harmful interference to radio communications. However, there is no guarantee that interference will not occur in a particular installation. If this equipment does cause harmful interference to radio or television reception, which can be determined by turning the equipment off and on, the user is encouraged to try and correct the interference by one or more of the following measures:

1. Reorient or relocate the receiving antenna
2. Increase the separation between the equipment and receiver
3. Connect the equipment into an outlet on a circuit different from that to which the receiver is connected
4. Consult the dealer or experienced radio/TV technician for help.

WARNING: Changes or modifications not expressly approved by the manufacturer could void the user's authority to operate this equipment.

SOMFY CANADA

6315 Shawson Drive, Unit #1
Mississauga, Ontario L5T1J2

SOMFY SYSTEMS, INC.

47 Commerce Drive
Cranbury, NJ 08512

SOMFY MEXICO S.A. De C.V.

Temazcal 19-B, La Loma
Tlalnepantla, Edo de Mex.
Mexico 54130

SOMFY SYSTEMS, INC. reserves the right to change, update or improve this document without prior notice.

Ref. No. 2500017

© SOMFY SYSTEMS, INC. 10/07